

Archaeological Resources Inventory Report for the Maple Property

San Bernardino County, California

Prepared For:

Nolan Leggio
Diversified Pacific
10621 Civic Center Drive
Rancho Cucamonga, California 91730

Prepared By:



ECORP Consulting, Inc.
ENVIRONMENTAL CONSULTANTS

215 North 5th Street
Redlands, California 92374

November 2023

MANAGEMENT SUMMARY

Diversified Pacific retained ECORP Consulting, Inc. in 2023 to conduct an archaeological resources inventory for the Fontana Maple Property in San Bernardino County, California. Diversified Pacific proposes the construction of an 8.38-acre housing development east of Locust Avenue, west of North Maple Avenue, north of West Foothill Boulevard, and south of Barbee Street in the City of Fontana. The proposed development would be located within Assessor's Parcel Numbers 02-431-4201, 02-431-4202, 02-431-4203, 02-431-4204, 02-431-4205, and 02-431-4206.

The inventory included a records search, literature review, and field survey. The records search results indicated that two previous cultural resources studies have been conducted within the Project Area. As a result of those studies, no sites or isolates have previously been recorded within the Project Area.

As a result of the field survey, ECORP did not record any cultural resources within the Project Area. Recommendations for the management of unanticipated discoveries are provided.

TABLE OF CONTENTS

1.0	INTRODUCTION	1
1.1	Project Location and Description.....	1
1.2	Area of Potential Effects.....	1
1.3	Regulatory Context.....	3
	1.3.1 National Environmental Policy Act.....	3
	1.3.2 National Historic Preservation Act.....	3
	1.3.3 California Environmental Quality Act.....	5
1.4	Report Organization	6
2.0	SETTING.....	6
2.1	Environmental Setting.....	6
2.2	Geology and Soils	6
2.3	Vegetation and Wildlife.....	7
3.0	CULTURAL CONTEXT.....	7
3.1	Regional Pre-Contact History.....	7
	3.1.1 Paleo-Indian Period/Terminal Pleistocene (12,000 to 10,000 BP).....	7
	3.1.2 Early Archaic Period/Early Holocene (10,000 to 8,500 BP).....	7
	3.1.3 Encinitas Tradition or Milling Stone Period/Middle Holocene (8,500 to 1,250 BP)	8
	3.1.4 Palomar Tradition (1,250 to 150 BP).....	9
3.2	Ethnohistory	10
3.3	Regional History	10
3.4	Fontana Area History.....	12
4.0	METHODS.....	13
4.1	Personnel Qualifications.....	13
4.2	Records Search Methods	14
4.3	Sacred Lands File Coordination Methods	15
4.4	Other Interested Party Consultation Methods.....	15
4.5	Field Methods.....	15
5.0	RESULTS.....	16
5.1	Records Search.....	16
	5.1.1 Previous Research	16
	5.1.2 Records.....	17
	5.1.3 Map Review and Aerial Photographs.....	18
5.2	Sacred Lands File Results	19

5.3 Other Interested Party Consultation Results..... 19

5.4 Field Survey Results..... 19

6.0 MANAGEMENT CONSIDERATIONS..... 21

6.1 Conclusions 21

6.2 Likelihood for Subsurface Cultural Resources 21

6.3 Recommendations..... 21

6.3.1 Contractor Awareness Training..... 21

6.3.2 Archaeological Monitoring..... 21

6.3.3 Post-Review Discoveries 22

7.0 REFERENCES CITED 24

LIST OF FIGURES

Figure 1. Project Location and Vicinity..... 2

Figure 2. Project Area Overview (view southwest; September 14, 2023)..... 20

LIST OF TABLES

Table 1. Previously Recorded Cultural Resources within 1 mile of the Project Area..... 16

LIST OF APPENDICES

- Appendix A – Records Search Confirmation and Historical Society Coordination
- Appendix B – Sacred Lands File Coordination
- Appendix C – Project Area Photographs

LIST OF ACRONYMS AND ABBREVIATIONS

Term	Definition
AB	Assembly Bill
ACHP	Advisory Council on Historic Preservation
APE	Area of Potential Effect
BERD	Built Environment Resource Directory
BLM	Bureau of Land Management
BP	Years Before Present
Caltrans	California Department of Transportation
CCR	California Code of Regulations
CEQA	California Environmental Quality Act
CFR	Code of Federal Regulations
CHL	California Historical Landmarks
CHRIS	California Historical Resources Information System
CRHR	California Register of Historical Resources
DPR	Department of Parks and Recreation
GLO	General Land Office
MLD	Most Likely Descendant
NAHC	Native American Heritage Commission
NEPA	National Environmental Policy Act
NHPA	National Historic Preservation Act
NPS	National Park Service
NRCS	Natural Resources Conservation Service
NRHP	National Register of Historic Places
OHP	California Office of Historic Preservation
PRC	Public Resources Code
RPA	Registered Professional Archaeologist
SCCIC	South Central Coastal Information Center
SHPO	State Historic Preservation Officer
TCR	Tribal Cultural Resource
USGS	U.S. Geological Survey

1.0 INTRODUCTION

Diversified Pacific retained ECORP Consulting, Inc. in 2023 to conduct an archaeological resources inventory for the Fontana Maple Property in the City of Fontana, San Bernardino County, California. A survey of the Project Area was required to identify potentially eligible cultural resources (i.e., archaeological sites and historic buildings, structures, and objects) that could be affected by the Project.

1.1 Project Location and Description

The Project Area consists of approximately 8.38 acres of property located in the southwestern quarter of the southeastern quarter of Section 4 of Township 1 South, Range 5 West, San Bernardino Base and Meridian as depicted on the 1967 (photorevised 1980) Fontana, California U.S. Geological Survey (USGS) 7.5-minute topographic quadrangle map (Figure 1). It is located northwest of the intersection of West Foothill Boulevard and North Maple Avenue. The Proposed Project entails the construction of a gated residential community consisting of six buildings, each of which is either a three-story or four-story apartment building. The Proposed Project will also include a pool, a dog park, landscaped open space, and a combined clubhouse and leasing office, in addition to roadways, necessary utilities, and a covered garage and open parking.

1.2 Area of Potential Effects

The Area of Potential Effects (APE) consists of the horizontal and vertical limits of a project and includes the area within which significant impacts or adverse effects to Historical Resources or Historic Properties could occur as a result of the project. The APE is defined for projects subject to regulations implementing Section 106 (federal law and regulations). For projects subject to the California Environmental Quality Act (CEQA) review, the term Project Area is used rather than APE. The terms Project Area and APE are interchangeable for the purpose of this document.

The horizontal APE consists of all areas where activities associated with a project are proposed and, in the case of this Project, equals the Project Area subject to environmental review under the National Environmental Policy Act (NEPA) and CEQA. This includes areas proposed for construction, vegetation removal, grading, trenching, stockpiling, staging, paving, and other elements in the official Project description. The horizontal APE is illustrated in Figure 1 and represents the survey coverage area.

The vertical APE is described as the maximum depth below the surface to which excavations for project foundations and facilities will extend. Therefore, the vertical APE for this Project includes all subsurface areas where archaeological deposits could be affected. The subsurface vertical APE varies across the Project Area; this study assumes that this subsurface ground disturbance will not exceed 20 feet below the current surface, and therefore, a review of geologic and soils maps was necessary to determine the potential for buried archaeological sites that cannot be seen on the surface.

The vertical APE also is described as the maximum height of structures that could impact the physical integrity and integrity of setting of cultural resources, including districts and traditional cultural properties. For this Project, this study assumes that the above-surface vertical APE will not exceed 50 feet above the surface, which is the height of the tallest building.

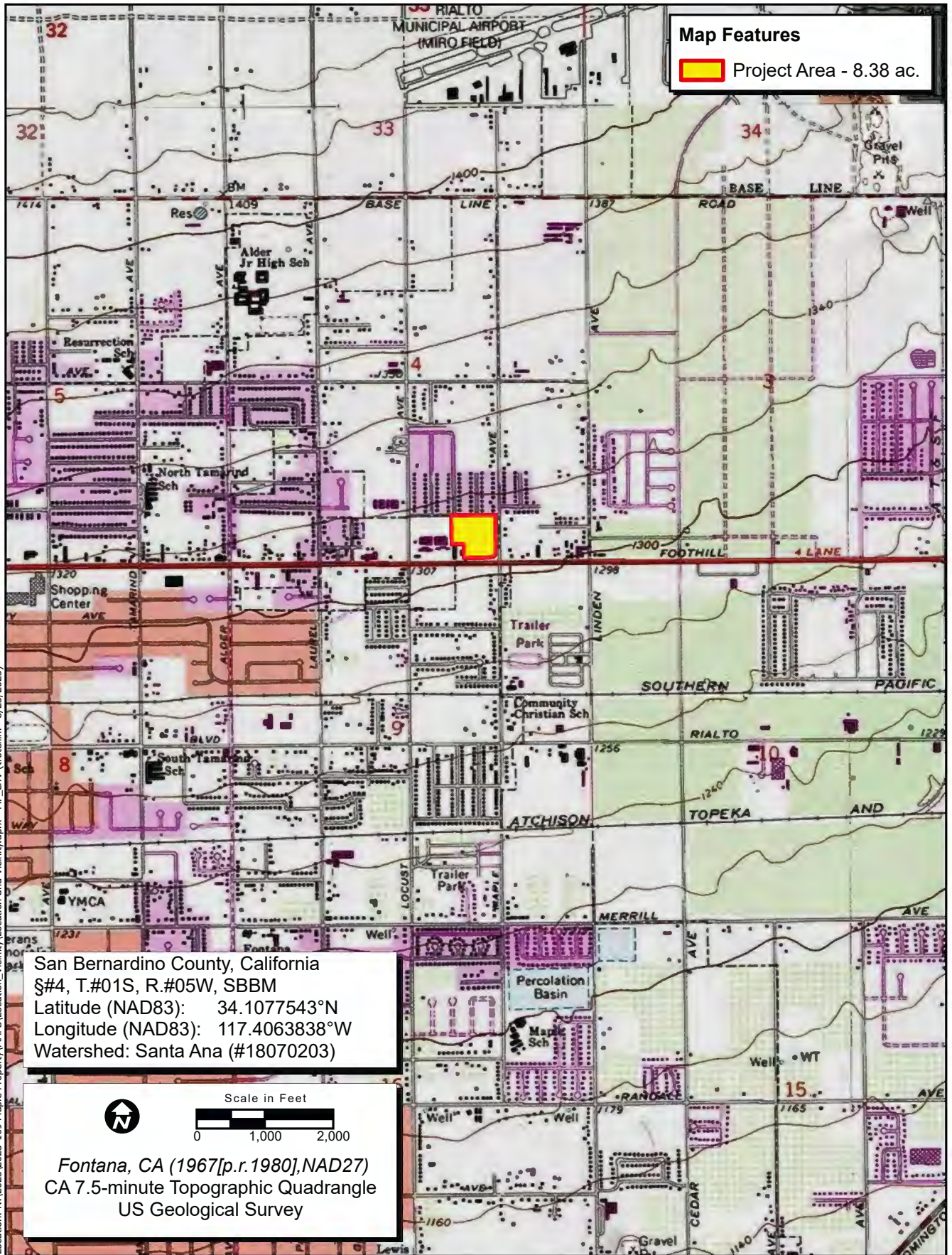

Location: N:\2023\2023-169 Maple Property\MAPS\Location_Vicinity.aprx - MP_Lrv (trotellini - 8/23/2023)

Map Date: 8/23/2023
 Sources: ESRI, USGS

Figure 1. Project Location and Vicinity

1.3 Regulatory Context

The CEQA lead agency for this Project is the City of Fontana. There is currently no known federal lead agency.

A review of the regulatory context is provided below; however, the inclusion of any of these laws and regulations in this report does not make a law or regulation apply when it otherwise would not. Similarly, the omission of any other laws and regulations from this section does not mean that they do not apply. Rather, the purpose of this section is to provide context in explaining why the study was carried out in the manner documented herein.

1.3.1 National Environmental Policy Act

NEPA establishes national policy for the protection and enhancement of the environment. Part of the function of the federal government in protecting the environment is to “preserve important historic, cultural, and natural aspects of our national heritage.” Cultural resources need not be determined eligible for the National Register of Historic Places (NRHP) through the National Historic Preservation Act (NHPA) of 1966 (as amended) to receive consideration under NEPA. NEPA is implemented by regulations of the Council on Environmental Quality (40 Code of Federal Regulations [CFR] 1500-1508).

The definition of *effects* in the NEPA regulations includes adverse and beneficial effects on historic and cultural resources (40 CFR 1508.8). Therefore, the *Environmental Consequences* section of an Environmental Impact Statement [see 40 CFR 1502.16(f)] must analyze potential effects to historic or cultural resources that could result from the proposed action and each alternative. In considering whether an alternative may “significantly affect the quality of the human environment,” a federal agency must consider, among other things:

- Unique characteristics of the geographic area, such as proximity to historic or cultural resources (40 CFR 1508.27(b)(3)), and
- The degree to which the action may adversely affect districts, sites, highways, structures, or objects listed in or eligible for listing in the NRHP (40 CFR 1508.27(b)(8)).

Therefore, because historic properties are a subset of *cultural resources*, they are one aspect of the *human environment* defined by NEPA regulations.

1.3.2 National Historic Preservation Act

The federal law that covers cultural resources that could be affected by federal undertakings is the NHPA of 1966, as amended. Section 106 of the NHPA requires that federal agencies take into account the effects of a federal undertaking on properties listed in or eligible for the NRHP. The agencies must afford the Advisory Council on Historic Preservation (ACHP) a reasonable opportunity to comment on the undertaking. A federal undertaking is defined in 36 CFR 800.16(y):

A federal undertaking means a project, activity, or program funded in whole or in part under the direct or indirect jurisdiction of a federal agency, including those carried out by

or on behalf of a federal agency; those carried out with Federal financial assistance; and those requiring a federal permit, license, or approval.

The regulations that stipulate the procedures for complying with Section 106 are in 36 CFR 800. The Section 106 regulations require:

- definition of the APE.
- identification of cultural resources within the APE.
- evaluation of the identified resources in the APE using NRHP eligibility criteria.
- determination of whether the effects of the undertaking or project on eligible resources will be adverse; and
- agreement on and implementation of efforts to resolve adverse effects, if necessary.

The federal agency must seek comment from the State Historic Preservation Officer (SHPO) and, in some cases, the ACHP, for its determinations of eligibility, effects, and proposed mitigation measures. Section 106 procedures for a specific project can be modified by negotiation of a Memorandum of Agreement or Programmatic Agreement between the federal agency, the SHPO, and, in some cases, the project proponent.

Effects to a cultural resource are potentially adverse if the lead federal agency, with the SHPO's concurrence, determines the resource eligible for the NRHP, making it a Historic Property, and if application of the Criteria of Adverse Effects (36 CFR 800.5[a][2] et seq.) results in the conclusion that the effects will be adverse. The NRHP eligibility criteria, contained in 36 CFR 60.4, are as follows:

The quality of significance in American history, architecture, archaeology, and culture is present in districts, sites, buildings, structures, and objects of state and local importance that possess aspects of integrity of location, design, setting, materials, workmanship, feeling, association, and

- A. that are associated with events that have made a significant contribution to the broad patterns of our history; or
- B. that are associated with the lives of persons significant in our past; or
- C. that embody the distinctive characteristics of a type, period, or method of construction, or that represent the work of a master, or that possess high artistic values, or that represent a significant and distinguishable entity whose components may lack individual distinction; or
- D. that have yielded, or may be likely to yield, information important in prehistory.

In addition, the resource must be at least 50 years old, barring exceptional circumstances (36 CFR 60.4). Resources that are eligible for, or listed on, the NRHP are *historic properties*.

Regulations implementing Section 106 of the NHPA (36 CFR 800.5) require that the federal agency, in consultation with the SHPO, apply the Criteria of Adverse Effect to historic properties within the APE. According to 36 CFR 800.5(a)(1):

An adverse effect is found when an undertaking may alter, directly or indirectly, any of the characteristics of a historic property that qualify the property for inclusion in the National Register in a manner that would diminish the integrity of the property's location, design, setting, materials, workmanship, feeling or association.

1.3.3 California Environmental Quality Act

CEQA is the state law that applies to a project's impacts on cultural resources. A project is an activity that may cause a direct or indirect physical change in the environment and that is undertaken or funded by a state or local agency, or requires a permit, license, or lease from a state or local agency. CEQA requires that impacts to Historical Resources be identified and, if the impacts will be significant, then apply mitigation measures to reduce the impacts.

A Historical Resource is a resource that 1) is listed in or has been determined eligible for listing in the California Register of Historical Resources (CRHR) by the State Historical Resources Commission, or has been determined historically significant by the CEQA lead agency because it meets the eligibility criteria for the CRHR, 2) is included in a local register of historical resources, as defined in Public Resources Code (PRC) 5020.1(k), or 3), and has been identified as significant in a historical resources survey, as defined in PRC 5024.1(g) (California Code of Regulations [CCR] Title 14, Section 15064.5(a)).

The eligibility criteria for the CRHR are as follows (CCR Title 14, Section 4852(b)):

- (1) It is associated with events that have made a significant contribution to the broad patterns of local or regional history, or the cultural heritage of California or the United States.
- (2) It is associated with the lives of persons important to local, California, or national history.
- (3) It embodies the distinctive characteristics of a type, period, region, or method of construction, or represents the work of a master or possesses high artistic values; or
- (4) It has yielded, or has the potential to yield, information important to the prehistory or history of the local area, California, or the nation.

In addition, the resource must retain integrity, which is evaluated with regard to the retention of location, design, setting, materials, workmanship, feeling, and association (CCR Title 14, Section 4852(c)). Resources that have been determined eligible for the NRHP are automatically eligible for the CRHR.

Impacts to a Historical Resource, as defined by CEQA (listed in an official historic inventory or survey or eligible for the CRHR), are significant if the resource is demolished or destroyed or if the characteristics that made the resource eligible are materially impaired (CCR Title 14, Section 15064.5(b)). Demolition or alteration of eligible buildings, structures, and features that they would no longer be eligible would result in a significant impact. Whole or partial destruction of eligible archaeological sites would result in a

significant impact. In addition to impacts from construction resulting in destruction or physical alteration of an eligible resource, impacts to the integrity of setting (sometimes termed *visual impacts*) of physical features in the Project Area could also result in significant impacts.

Tribal Cultural Resources (TCRs) are defined in Section 21074 of the California PRC as sites, features, places, cultural landscapes (geographically defined in terms of the size and scope), sacred places, and objects with cultural value to a California Native American tribe that are either included in or determined to be eligible for inclusion in the CRHR, or are included in a local register of historical resources as defined in subdivision (k) of Section 5020.1, or are a resource determined by the lead agency, in its discretion and supported by substantial evidence, to be significant pursuant to criteria set forth in subdivision (c) of Section 5024.1. Section 1(b)(4) of Assembly Bill (AB) 52 established that only California Native American tribes, as defined in Section 21073 of the California PRC, are experts in the identification of TCRs and impacts thereto. Because ECORP does not meet the definition of a California Native American tribe, it only addresses information in this report for which it is qualified to identify and evaluate, and that which is needed to inform the cultural resources section of CEQA documents. This report, therefore, does not identify or evaluate TCRs. Should California Native American tribes ascribe additional importance to, or interpretation of archaeological resources described herein, or provide information about non-archeological TCRs, that information is documented separately in the AB 52 tribal consultation record between the tribe(s) and lead agency and summarized in the TCRs section of the CEQA document, if applicable.

1.4 Report Organization

The following report documents the study and its findings and was prepared in conformance with the California Office of Historic Preservation's (OHP) *Archaeological Resource Management Reports: Recommended Contents and Format*. Appendix A includes records search information from the California Historical Resources Information System (CHRIS) and historical society coordination. Appendix B contains documentation of a search of the Sacred Lands File. Appendix C presents photographs of the Project Area.

2.0 SETTING

2.1 Environmental Setting

Elevations within the Project Area range from 1,307 to 1,318 feet above mean sea level. The Project is located approximately 3.6 miles southwest of Lytle Creek Wash, 5 miles south of Cajon Wash, and 4.5 miles northeast of Mount Jurupa.

2.2 Geology and Soils

The Project Area is located between Lytle Creek Wash and Cajon Wash, which are the sources of alluvial soils within the Project Area. Morton (2003) shows that the Project Area soils consist of quaternary alluvium dating to the Holocene. The Natural Resources Conservation Service (NRCS) Web Soil Survey maps the Project Area as approximately 89 percent TuB—Tujunga loamy sand, 0 to 5 percent slopes and 11 percent TvC—Tujunga gravelly loamy sand, 0 to 9 percent slopes. Both soil types are classified as

alluvium derived from granite and are mapped as being typically 80 inches to a restrictive feature (NRCS 2023).

2.3 Vegetation and Wildlife

The dominant plant community within the Project Area includes, but is not limited to, California buckwheat (*Erigonium fasciculatum*), California sagebrush (*Artemisia californica*), and common sunflower (*Heliathus annus*; iNaturalist 2023).

Wildlife species that may occur within the Project Area include crow and raven (*Corvus* spp.), rabbit (*Sylvilagus* spp.), hare (*Lepus* spp.), coyote (*Canus latrans*), and common raccoon (*Procyon lotor*; Booth 1968; iNaturalist 2023).

3.0 CULTURAL CONTEXT

3.1 Regional Pre-Contact History

3.1.1 Paleo-Indian Period/Terminal Pleistocene (12,000 to 10,000 BP)

The first inhabitants of southern California were big game hunters and gatherers exploiting extinct species of Pleistocene megafauna (e.g., mammoth and other Rancholabrean fauna). Local "fluted point" assemblages comprised of large spear points or knives are stylistically and technologically similar to the Clovis Paleo-Indian cultural tradition dated to this period elsewhere in North America (Moratto 1984). Archaeological evidence for this period in southern California is limited to a few small temporary camps with fluted points found around late Pleistocene Lake margins in the Mojave Desert and around Tulare Lake in the southern San Joaquin Valley. Single points are reported from Ocotillo Wells and Cuyamaca Pass in eastern San Diego County and from the Yuha Desert in Imperial County (Rondeau et al. 2007).

3.1.2 Early Archaic Period/Early Holocene (10,000 to 8,500 BP)

Approximately 10,000 years ago, at the beginning of the Holocene, warming temperatures, and the extinction of the megafauna resulted in changing subsistence strategies with an emphasis hunting smaller game and increasing reliance on plant gathering. Previously, Early Holocene sites were represented by only a few sites and isolates from the Lake Mojave and San Dieguito complexes found along former lakebeds and grasslands of the Mojave Desert and in inland San Diego County. More recently, southern California Early Holocene sites have been found along the Santa Barbara Channel (Erlandson 1994), in western Riverside County (Goldberg 2001; Grenda 1997), and along the San Diego County coast (Gallegos 1991; Koerper et al. 1991; Warren 1967).

The San Dieguito Complex was defined based on material found at the Harris site (CA-SDI-149) on the San Dieguito River near Lake Hodges in San Diego County. San Dieguito artifacts include large leaf-shaped points; leaf-shaped knives; large ovoid, domed, and rectangular end and side scrapers; engraving tools; and crescentics (Koerper et al. 1991). The San Dieguito Complex at the Harris site dates to 9,000 to 7,500 years before present (BP; Gallegos 1991). However, sites from this time period in coastal San Diego

County have yielded artifacts and subsistence remains characteristic of the succeeding Encinitas Tradition, including manos, metates, core-cobble tools, and marine shell (Gallegos 1991; Koerper et al. 1991).

3.1.3 Encinitas Tradition or Milling Stone Period/Middle Holocene (8,500 to 1,250 BP)

The Encinitas Tradition (Warren 1968) and the Milling Stone Period (Wallace 1955) refer to a long period of time during which small mobile bands of people who spoke an early Hokan language foraged for a wide variety of resources including hard seeds, berries, and roots/tubers (yucca in inland areas), rabbits and other small animals, and shellfish and fish in coastal areas. Sites from the Encinitas Tradition consist of residential bases and resource acquisition locations with no evidence for overnight stays. Residential bases have hearths and fire-affected rock indicating overnight stays and food preparation. Residential bases along the coast have large amounts of shell and are often termed shell middens.

The Encinitas Tradition as originally defined (Warren 1968) applied to all of the non-desert areas of southern California. Recently, four patterns within the Encinitas Tradition have been proposed which apply to different regions of southern California (Sutton and Gardner 2010). The Topanga Pattern includes archaeological material from the Los Angeles Basin and Orange County. The Greven Knoll Pattern pertains to southwestern San Bernardino County and western Riverside County (Sutton and Gardner 2010). Each of the patterns is divided into temporal phases. The Topanga Pattern included the Los Angeles Basin and Orange County. The Topanga I phase extends from 8,500 to 5,000 BP and Topanga II runs from 5,000 to 3,500 BP. The Topanga Pattern ended about 3,500 BP with the arrival of Takic speakers, except in the Santa Monica Mountains where the Topanga III phase lasted until about 2,000 BP.

The Encinitas Tradition in inland areas east of the Topanga Pattern (southwestern San Bernardino County and western Riverside County) is the Greven Knoll Pattern (Sutton and Gardner 2010). Greven Knoll I (9,400 to 4,000 BP) has abundant manos and metates. Projectile points are few and are mostly Pinto points. Greven Knoll II (4,000 to 3,000 BP) has abundant manos and metates and core tools. Projectile points are mostly Elko points. The Elsinore site on the east shore of Lake Elsinore was occupied during Greven Knoll I and Greven Knoll II. During Greven Knoll I faunal processing (butchering) took place at the lakeshore and floral processing (seed grinding), cooking, and eating took place farther from the shore. The primary foods were rabbit meat and seeds from grasses, sage, and ragweed. A few deer, waterfowl, and reptiles were consumed. The recovered archaeological material suggests that a highly mobile population visited the site at a specific time each year. It is possible that their seasonal round included the ocean coast at other times of the year. These people had an unspecialized technology as exemplified by the numerous crescents, a multi-purpose tool. The few projectile points suggest that most of the small game was trapped using nets and snares (Grenda 1997). During Greven Knoll II, which included a warmer drier climatic episode known as the Altithermal, it is thought that populations in interior southern California concentrated at oases and that Lake Elsinore was one of them. The Elsinore site (CA-RIV-2798) is one of five known Middle Holocene residential sites around Lake Elsinore. Tools were mostly manos, metates, and hammerstones. Scraper planes were absent. Flaked-stone tools consisted mostly of utilized flakes used as scrapers. The Elsinore site during the Middle Holocene was a "recurrent extended encampment" which could have been occupied during much of the year.

The Encinitas Tradition lasted longer in inland areas because Takic speakers did not move east into these areas until circa 1,000 BP. Greven Knoll III (3,000 to 1,000 BP) is present at the Liberty Grove site in Cucamonga (Salls 1983) and at sites in Cajon Pass that were defined as part of the Sayles Complex (Kowta 1969). Greven Knoll III sites have a large proportion of manos and metates and core tools as well as scraper planes. Kowta (1969) suggested the scraper planes may have been used to process yucca and agave. The faunal assemblage consists of large quantities of lagomorphs (rabbits and hares) and lesser quantities of deer, rodents, birds, carnivores, and reptiles.

3.1.4 Palomar Tradition (1,250 to 150 BP)

The native people of southern California (north of a line from Agua Hedionda to Lake Henshaw in San Diego County) spoke Takic languages which form a branch or subfamily of the Uto-Aztecan language family. The Takic languages are divided into the Gabrielino-Fernandeño language, the Serrano-Kitanemuk group (the Serrano [includes the Vanyume dialect] and Kitanemuk languages), the Tataviam language, and the Cupan group (the Luiseño-Juaneño language, the Cahuilla Language, and the Cupeño language) (Golla 2011). According to Sutton (2009), Takic speakers occupied the southern San Joaquin Valley before 3,500 BP. Perhaps as a result of the arrival of Yokutsan speakers (a language in the Penutian language family) from the north, Takic speakers moved southeast. The ancestors of the Kitanemuk moved into the Tehachapi Mountains and the ancestors of the Tataviam moved into the upper Santa Clara River drainage. The ancestors of the Gabrielino (Tongva) moved into the Los Angeles Basin about 3,500 BP, replacing the native Hokan speakers. Speakers of proto-Gabrielino reached the southern Channel Islands by 3,200 BP (Sutton 2009) and moved as far south as Aliso Creek in Orange County by 3,000 BP.

Takic people moved south into southern Orange County after 1,250 BP and became the ancestors of the Juaneño. Takic people moved inland from southern Orange County about 1,000 BP, becoming the ancestors of the Luiseño, Cupeño, and Cahuilla. Takic people from the Kitanemuk area moved east along the northern slopes of the San Gabriel Mountains and spread into the San Bernardino Mountains and along the Mojave River becoming the ancestors of the Serrano and the Vanyume.

The material culture of the inland areas where Takic languages were spoken at the time of Spanish contact is part of the Palomar Tradition (Sutton 2011). San Luis Rey I Phase (1,000 to 500 BP) and San Luis Rey II Phase (500 to 150 BP) pertain to the area occupied by the Luiseño at the time of Spanish contact. The Peninsular I (1,000 to 750 BP), II (750 to 300 BP), and III (300 to 150 BP) Phases are used in the areas occupied by the Cahuilla and Serrano (Sutton 2011).

San Luis Rey I is characterized by Cottonwood Triangular arrow points, use of bedrock mortars, stone pendants, shell beads, quartz crystals, and bone tools. San Luis Rey II sees the addition of ceramics, including ceramic cremation urns, red pictographs on boulders in village sites, and steatite arrow straighteners. San Luis Rey II represents the archaeological manifestation of the antecedents of the historically known Luiseño (Goldberg 2001). During San Luis Rey I there were a series of small permanent residential bases at water sources, each occupied by a kin group (probably a lineage). During San Luis Rey II people from several related residential bases moved into a large village located at the most reliable water source (Waugh 1986). Each village had a territory that included acorn harvesting camps at higher

elevations. Villages have numerous bedrock mortars, large dense midden areas with a full range of flaked and ground stone tools, rock art, and a cemetery.

3.2 Ethnohistory

Ethnographic accounts of Native Americans indicate that the Gabrieliño (also known as Gabrieleno, or Tongva) once occupied the region that encompasses the Project Area. At the time of contact with Europeans, the Gabrieliño were the main occupants of the southern Channel Islands, the Los Angeles Basin, much of Orange County, and extended as far east as the western San Bernardino Valley. The term "Gabrieliño" came from the group's association with Mission San Gabriel Arcángel, established in 1771. The Gabrieliño are believed to have been one of the most populous and wealthy Native American tribes in southern California prior to European contact, (Bean and Smith 1978; McCawley 1996; Moratto 1984) and spoke a Takic language. The Takic group of languages is part of the Uto-Aztecan language family.

The Gabrieliño occupied villages located along rivers and at the mouths of canyons. Populations ranged from 50 to 200 inhabitants. Residential structures within the villages were domed, circular, and made from thatched tule or other available wood. Gabrieliño society was organized by kinship groups, with each group composed of several related families who together owned hunting and gathering territories. Settlement patterns varied according to the availability of floral and faunal resources (Bean and Smith 1978; McCawley 1996; Miller 1991).

Vegetal staples consisted of acorns, chia, seeds, piñon nuts, sage, cacti, roots, and bulbs. Animals hunted included deer, antelope, coyote, rabbits, squirrels, rodents, birds, and snakes. The Gabrieliño also fished and collected marine shellfish (Bean and Smith 1978; McCawley 1996; Miller 1991).

By the late 18th century, Gabrieliño population had significantly dwindled due to introduced European diseases and dietary deficiencies. Gabrieliño communities disintegrated as families were taken to the missions (Bean and Smith 1978; McCawley 1996; Miller 1991). However, current descendants of the Gabrieliño are preserving Gabrieliño culture.

3.3 Regional History

The first European to visit California was Spanish maritime explorer Juan Rodriguez Cabrillo in 1542. Cabrillo was sent north by the Viceroy of New Spain (Mexico) to look for the Northwest Passage. Cabrillo visited San Diego Bay, Catalina Island, San Pedro Bay, and the northern Channel Islands. The English adventurer Francis Drake visited the Miwok Native American group at Drake's Bay or Bodega Bay in 1579. Sebastian Vizcaíno explored the coast as far north as Monterey in 1602. He reported that Monterey was an excellent location for a port (Castillo 1978). Vizcaíno also named San Diego Bay to commemorate Saint Didacus. The name began to appear on European maps of the New World by 1624 (Gudde 1998).

Colonization of California began with the Spanish Portolá land expedition. The expedition, led by Captain Gaspar de Portolá of the Spanish army and Father Junipero Serra, a Franciscan missionary, explored the California coast from San Diego to the Monterey Bay Area in 1769. As a result of this expedition, Spanish missions to convert the native population, *presidios* (forts), and towns were established. The Franciscan missionary friars established 21 missions in Alta California (the area north of Baja California) beginning

with Mission San Diego in 1769 and ending with the mission in Sonoma established in 1823. The purpose of the missions and presidios was to establish Spanish economic, military, political, and religious control over the Alta California territory. Mission San Diego was established to convert the Native Americans that lived in the area, known as the *Kumeyaay* or Diegueño. Mission San Gabriel Archangel was founded in 1771 east of what is now Los Angeles to convert the *Tongva* or Gabrielino. Mission San Fernando, also in *Tongva*/Gabrielino territory, was established in 1797. Mission San Juan Capistrano was established in 1776 on San Juan Creek (in what is now southern Orange County) to convert the *Ajchamen* or Juaneño. Mission San Luis Rey was established in 1798 on the San Luis Rey River (in what is now northern San Diego County) to convert the Luiseño. Missions San Buenaventura and Santa Barbara were founded in Chumash territory in 1782 and 1786, respectively (Castillo 1978).

Some missions later established outposts in inland areas. An *asistencia* (mission outpost) of Mission San Luis Rey, known as San Antonio de Pala, was built in Luiseño territory along the upper San Luis Rey River near Mount Palomar in 1810 (Pourade 1961). A chapel administered by Mission San Gabriel Archangel was established in the San Bernardino area in 1819 (Bean and Smith 1978). The present *asistencia* within the western outskirts of present-day Redlands was built circa 1830 (Haenszel and Reynolds 1975). The missions sustained themselves through cattle ranching and traded hides and tallow for supplies brought by ship. Large cattle ranches were established by Mission San Luis Rey at Temecula and San Jacinto (Gunther 1984). The Spanish also constructed *presidios*, or forts, at San Diego and Santa Barbara, and a *pueblo*, or town, was established at Los Angeles. The Spanish period in California began in 1769 with the Portolá expedition and ended in 1821 with Mexican independence.

After Mexico became independent from Spain in 1821, what is now California became the Mexican province of Alta California. The Mexican government closed the missions in the 1830s and former mission lands were granted to retired soldiers and other Mexican citizens for use as cattle ranches. Much of the land along the coast and in the interior valleys became part of Mexican land grants or “ranchos” (Robinson 1948). During the Mexican period there were small towns at San Diego (near the presidio), San Juan Capistrano (around the mission), and Los Angeles. The rancho owners lived in one of the towns or in an adobe house on the rancho. The Mexican Period includes the years 1821 to 1848.

The American period began when the Treaty of Guadalupe Hidalgo was signed between Mexico and the United States in 1848. As a result of the treaty, Alta California became part of the United States as the territory of California. Rapid population increase occasioned by the Gold Rush of 1849 allowed California to become a state in 1850. Most Mexican land grants were confirmed to the grantees by U.S. courts, but usually with more restricted boundaries which were surveyed by the U.S. Surveyor General’s office. Land that was not part of a land grant was owned by the U.S. government until it was acquired by individuals through purchase or homesteading. Floods and drought in the 1860s greatly reduced the cattle herds on the ranchos, making it difficult to pay the new American taxes on the thousands of acres they owned. Many Mexican-American cattle ranchers borrowed money at usurious rates from newly arrived Anglo-Americans. The resulting foreclosures and land sales transferred most of the land grants into the hands of Anglo-Americans (Cleland 1941).

3.4 Fontana Area History

The Semi-Tropic Land and Water Company purchased 28,500 acres west of Lytle Creek in 1887 and planned three townsites, the third of which they called Rosena. Rosena was planned where Fontana is now. Streets for Rosena were laid out, but Lytle Creek proved unable to bring a reliable water supply this far west, and the company went bankrupt before Rosena could be developed. In 1905, Azariel Blanchard (A.B.) Miller and associates leased 17,000 acres of former Semi-Tropic land that had been intended for development as Rosena from the Fontana Development Company. Using animal-drawn plows and scrapers, Miller created farms, installed irrigation, raised grain, and finally planted in 1910. By 1913, Miller subdivided the area into smaller plots, and the community of Fontana was thus founded in 1913 as an agricultural community. By 1913, the National Old Trails Association established a portion of unpaved highway next to the railroad tracks from Rialto to Rancho Cucamonga. They made a map of the new roadway but did not label Fontana. By 1926, Route 66 had followed the National Old Trails Highway, giving Fontana a new economic corridor (City of Fontana n.d.a; Fontana Historical Society 2015; Schuiling 1984).

Fontana became a popular location for livestock. By 1819, ten families were raising chickens, which became five hundred families by 1926. The United States Department of Agriculture selected Fontana for the only Experimental Rabbit Breeding Station in 1928, and later, food scraps from Los Angeles were shipped by train to feed hogs. At the start of WWII, Fontana was the home of 50,000 hogs, the largest hog ranch in the world at that time (Schuiling 1984).

During WWII, Henry Kaiser began steel mill operations in Fontana. By 1942, Fontana was the first town on the west coast to provide rolled steel plates which were used for Victory and Liberty class military ships. The steel mill transformed Fontana from an agricultural to an industrial city and was a major employer for many years after World War II (City of Fontana n.d.a; Schuiling 1984).

On June 25, 1952, Fontana was incorporated as a city. By 1968, they had established the Downtown Redevelopment Project Area, and the Fontana Redevelopment Agency, which continues to design long-range revitalization projects in Fontana (City of Fontana n.d.a., n.d.b.). In 1965, Caltrans completed Interstate 10, connecting Fontana with Los Angeles to the west, and San Bernardino and Arizona to the east by car. The interstate provided more traffic, but also diverted travelers away from the downtown businesses along Route 66 (City of Fontana n.d.a.; Road Trip Journeys 2019). This was likely an unintended consequence of design, since Route 66 was a roadway with businesses at its side, where travelers can pull over at any time; the interstate system is a closed system, where no businesses are at the roadside, and the roadway is entered and exited at controlled points.

Today, Fontana is the second most-populous city in San Bernardino County, with retail, health care, and manufacturing as its biggest employers. Fontana's focus from 1983 to 2006 on transforming into a bedroom community has let it to now begin attracting professional businesses and enliven its downtown district (City of Fontana City Council 2018; City of Fontana n.d.a.; Road Trip Journeys 2019; Sperling's Best Places n.d.). This has been facilitated by Interstates 10, 15, and 210 traversing the city, which allows for travel to the north, south, east, and west of the city for its residents to work elsewhere.

4.0 METHODS

4.1 Personnel Qualifications

Registered Professional Archaeologist (RPA) Sonia Sifuentes, who meets the Secretary of the Interior's Professional Qualifications Standards for prehistoric and historical archaeology, was responsible for this archaeological resource investigation. Staff Archaeologist Casey LeJeune, RPA conducted the fieldwork. Staff Archaeologist Robert J. Cunningham conducted the in-house records search review. Ms. LeJeune and Associate Archaeologists Nick Bizzell, Evelyn Hildebrand, RPA, and Steve Wintergerst prepared the technical report. Lisa Westwood, RPA provided technical report review and quality assurance.

Sonia Sifuentes is a Senior Archaeologist and the Southern California Cultural Resources Manager at ECORP and has more than 15 years of experience in cultural resources management, primarily in southern California. Ms. Sifuentes holds a M.S. in Archaeology of the North. She has participated in and supervised numerous surveys, test programs, and data recovery excavations for both prehistoric and historical sites; and has cataloged, identified, and curated thousands of artifacts. She has conducted evaluations of cultural resources for eligibility for the NRHP and CRHR. Ms. Sifuentes is experienced in the organization and execution of field projects in compliance with Section 106 of the NHPA and CEQA. She has contributed to and authored numerous cultural resources technical reports, research designs, and cultural resources management plans.

Casey LeJeune is a Staff Archaeologist who has worked in cultural resource management since 2020, with experience in the southeast and southern California. She holds an M.A. in anthropology with focus in forensic anthropology and bioarchaeology. She meets the Secretary of the Interior's Professional Qualifications Standards for prehistoric and historic archaeology. She has participated in fieldwork on forensic and historic burials, survey, large-scale data recovery, monitoring, and in-field lithic analysis. Ms. LeJeune also has extensive lab experience in human osteology and analysis of historic and prehistoric artifacts.

Robert J. Cunningham has 17 years of experience in cultural resources management, with an emphasis on the recordation, analysis, and evaluation of historic-period resources. He has participated in all aspects of archaeological fieldwork, including survey, test excavation, and construction monitoring. He has served as Field Director for archaeological inventories and site evaluation projects and has worked on San Diego County projects under ECORP's blanket purchase order since 2010. He has recorded and mapped numerous prehistoric and historic-period archaeological sites and has identified and documented hundreds of prehistoric and historic artifacts. Mr. Cunningham has prepared numerous archaeological site records and has authored and contributed to a variety of cultural resources technical reports.

Nicholas Bizzell is an Associate Archaeologist with ECORP and has more than 12 years of experience in cultural resources management. He holds a B.A. in Anthropology from Sonoma State University in Rohnert Park, California. Mr. Bizzell has participated in numerous archaeological projects throughout California, experience that includes working with clients in both public and private sectors. Mr. Bizzell has substantial archaeological experience with cultural resources monitoring, inventory surveys, excavation and subsurface testing, and laboratory analysis for projects in northern and southern California. Additionally,

Mr. Bizzell is cross trained as a paleontological monitor for projects requiring both archaeological and paleontological monitoring.

Evelyn Hildebrand is an Associate Archaeologist with more than five years of experience working in cultural resource management across California. She holds an M.A. in Applied Archaeology and a B.A. in Anthropology with a focused curriculum in archaeology. She meets the Secretary of the Interior's Professional Qualifications Standards for prehistoric and historic archaeology. She has participated in various aspects of archaeological fieldwork including survey, test excavation, data recovery, artifact analysis, construction monitoring, both as an archaeological monitor and field lead, and the recording and recovery of pre-contact and historic-period archaeological sites. She has contributed to and authored multiple cultural resources reports.

Steve Wintergerst is an Associate Archaeologist with 15 years of experience in cultural resources management. He holds a B.A. in Anthropology. Mr. Wintergerst has participated in all aspects of archaeological fieldwork and laboratory process, with extensive experience throughout California and western Arizona. His experience has involved working as an archaeological crew chief, archaeological technician, archaeological monitor, paleontological monitor, and paleontological preparator. He is experienced in the organization and execution of field projects in compliance with CEQA and Section 106 of the NHPA. He has contributed to multiple cultural resource reports.

Lisa Westwood has 28 years of experience and meets the Secretary of the Interior's Professional Qualifications Standards for prehistoric and historical archaeology. She holds a B.A. in Anthropology and an M.A. in Anthropology (Archaeology). She is the Director of Cultural Resources for ECORP.

4.2 Records Search Methods

ECORP conducted an in-house records search for the Project Area at the South-Central Coastal Information Center (SCCIC) of the CHRIS at California State University, Fullerton on September 5, 2023 (Appendix A). The purpose of the records search was to determine the extent of previous surveys within a 1-mile (1,600-meter) radius of the Proposed Project Area, and whether previously documented pre-contact or historic archaeological sites, architectural resources, or traditional cultural properties exist within this area.

In addition to the official records and maps for archaeological sites and surveys in San Bernardino County, the following historic references were also reviewed: Built Environment Resource Directory (OHP 2022); Historic Property Data File for San Bernardino County (OHP 2012); the National Register Information System (National Park Service [NPS] 2023); Office of Historic Preservation, California Historical Landmarks (CHL; OHP 2023a); CHL (OHP 1996 and updates); California Points of Historical Interest (OHP 1992 and updates); Directory of Properties in the Historical Resources Inventory (1999); Caltrans Local Bridge Survey (Caltrans 2020); Caltrans State Bridge Survey (Caltrans 2023); and *Historic Spots in California* (Kyle 2002).

Other references examined include a RealQuest Property Search and historic General Land Office (GLO) land patent records (Bureau of Land Management [BLM] 2023). Historic maps reviewed include the:

- 1856 BLM GLO Plat map for Township 1 South, Range 5 West;

- 1873 BLM GLO Plat map for Township 1 South, Range 5 West;
- 1889 BLM GLO Plat map for Township 1 South, Range 5 West;
- 1898 USGS San Bernardino, California topographic quadrangle map (1:62,500 scale);
- 1901 USGS San Bernardino, California topographic quadrangle map (1:62,500 scale);
- 1942 USGS San Bernardino, California topographic quadrangle map (1:62,500 scale);
- 1943 USGS Fontana California topographic quadrangle map (1:31,680 scale);
- 1953 USGS Fontana, California topographic quadrangle map (1:24,000 scale);
- 1954 USGS San Bernardino, California topographic quadrangle map (1:62,500 scale); and
- 1967 USGS Fontana, California topographic quadrangle map (1:24,000 scale).

ECORP reviewed historic aerial photographs taken in 1938, 1948, 1959, 1966, 1985, and 1994 for any indications of property usage and built environment.

4.3 Sacred Lands File Coordination Methods

In addition to the records search, ECORP contacted the California Native American Heritage Commission (NAHC) on August 25, 2023 to request a search of the Sacred Lands File for the Project Area (Appendix B). This search determines whether the California Native American tribes within the Project Area have recorded Sacred Lands, because the Sacred Lands File is populated by members of the Native American community with knowledge about the locations of tribal resources. In requesting a search of the Sacred Lands File, ECORP solicited information from the Native American community regarding TCRs, but the responsibility to formally consult with the Native American community lies exclusively with the federal and local agencies under applicable state and federal laws. The lead agencies do not delegate government-to-government authority to any private entity to conduct tribal consultation.

4.4 Other Interested Party Consultation Methods

ECORP emailed the Fontana Historical Society on August 25, 2023 to solicit comments or obtain historical information that the repository might have regarding events, people, or resources of historical significance in the area (Appendix A).

4.5 Field Methods

ECORP subjected the Project Area to an intensive pedestrian survey on September 14, 2023 under the guidance of the *Secretary of the Interior's Standards for the Identification of Historic Properties* (NPS 1983) using 15-meter-spaced transects. ECORP expended 0.25 person-day in the field. At the time, ECORP examined the ground surface for indications of surface or subsurface cultural resources and inspected the general morphological characteristics of the ground surface for indications of subsurface deposits that may be manifested on the surface, such as circular depressions or ditches. Whenever possible, ECORP examined the locations of subsurface exposures caused by such factors as rodent activity, water or soil

erosion, or vegetation disturbances for artifacts or for indications of buried deposits. ECORP did not conduct subsurface investigations or artifact collections during the pedestrian survey.

Standard professional practice requires that all cultural resources encountered during the survey be recorded using Department of Parks and Recreation (DPR) 523-series forms approved by the California OHP. The resources are usually photographed, mapped using a handheld Global Positioning System receiver, and sketched as necessary to document their presence using appropriate DPR forms.

5.0 RESULTS

5.1 Records Search

The records search consisted of a review of previous research and literature, records on file with the SCCIC for previously recorded resources, and historical aerial photographs and maps of the vicinity.

5.1.1 Previous Research

Twenty-six previous cultural resource investigations have been conducted within 1 mile of the Project Area, covering approximately 10 percent of the total area surrounding the Project Area within the records search radius (Appendix A). Of the 26 studies within the 1-mile radius, 2 were conducted within the Project Area. Alexandrowicz et al. (1992) and McKenna (2004) conducted studies that included the current Project Area, but no cultural resources were recorded. Appendix A lists the reports located within 1 mile of the Project Area. These studies revealed the presence of pre-contact sites, including stone circles, tools, and Millingstone Horizon sites, and historical sites, including architecture associated with ranching activities, residences and other buildings, and avenues and streets. The previous studies were conducted between 1973 and 2015 and vary in size from 8 to 12,800 acres.

The results of the records search indicate that more than half of the Project Area has been previously surveyed for cultural resources; however, these studies were conducted in smaller segments, at different times, by different consultants, as many as 50 years ago, or under obsolete standards. Therefore, ECORP conducted a pedestrian survey of the Project Area for the Project under current protocols.

The records search also determined that three previously recorded pre-contact and historic-era cultural resources are located within 1 mile of the Project Area (Table 1). All three are believed to be associated with early historic-period privies/trash scatters and a religious building. There are no previously recorded cultural resources within or adjacent to the Project Area.

Site Number CA-SBR-	Primary Number P-36-	Recorder and Year	Age/ Period	Site Description
8040H	8040	Grenda 1994	Historic	Historic privy
10659H	10659	Shepard 2002	Historic	Refuse scatter and concrete foundation

Table 1. Previously Recorded Cultural Resources within 1 mile of the Project Area				
Site Number CA-SBR-	Primary Number P-36-	Recorder and Year	Age/ Period	Site Description
–	24867	Crawford 2011	Historic	Religious building

5.1.2 Records

The OHP’s Built Environment Resource Directory (BERD) for San Bernardino County (dated September 2, 2022) included five resources within 1 mile of the Project Area (OHP 2022):

- 8287 Alder Avenue;
- 8534 Laurel Avenue;
- 7789 Locust Avenue;
- 7887 Locust Avenue; and
- 8057 Locust Avenue, located immediately adjacent to the Project Area.

None of the resources listed on the BERD within 1 mile of the Project Area have been found eligible for the NRHP.

The National Register Information System (NPS 2023) failed to reveal any eligible or listed properties within the Project Area. The nearest National Register property is Bono’s Restaurant, approximately 2.5 miles west of the Project Area.

ECORP reviewed resources listed as *California Historical Landmarks* (OHP 1996) by the OHP (2023a) on August 15, 2023. The nearest listed landmark is #950, United States Rabbit Experimental Station; the plaque is located 2.19 miles west of the Project Area (OHP 2023b).

Historic Spots in California (Kyle 2002) mentions CHL #950, which was the only experimental rabbit breeding station in the United States.

Historic GLO land patent records from the BLM’s patent information database (BLM 2023) revealed that the entirety of Township 1 South, Range 5 West was patented to Andrew J. Pope on June 10, 1870 (BLM Serial Number CACAAA 084020) under the Sale-Cash entry authority (April 24, 1820: Sale-Cash Entry 3 Stat. 566).

A RealQuest online property search for APNs 02-431-4201, 02-431-4202, 02-431-4203, 02-431-4204, 02-431-4205, and 02-431-4206 revealed that the Project Area had been previously used for school district purposes. The APN results indicate that structures have been present since 1948 with no further details regarding their presence currently.

The Caltrans Bridge Local and State Inventories (Caltrans 2020, 2023) did not list any historic bridges within 1 mile of the Project Area. The nearest bridges are 1.9 miles north of the Project Area and were built for SR 210 around 2004 to 2005.

The *Handbook of North American Indians* (Bean and Smith 1978) lists the nearest Native American villages as being located on Jurupa Rancho, approximately 6 miles south of the Project Area.

5.1.3 Map Review and Aerial Photographs

A review of historical aerial photographs and maps of the Project Area provides information on the past land uses of the Project Area and potential for buried archaeological sites. This information shows that the Project Area was initially used for agriculture. Following is a summary of the review of historical maps and photographs:

- The 1856 BLM GLO Plat map for Township 1 South, Range 5 West depicts the Project Area as undeveloped and the Los Angeles & San Bernardino Road in the top half of Section 4.
- The 1873 BLM GLO Plat map for Township 1 South, Range 5 West depicts the Project Area as undeveloped and does not depict the Los Angeles & San Bernardino Road.
- The 1889 BLM GLO Plat map for Township 1 South, Range 5 West depicts the Project Area as undeveloped and again depicts the Los Angeles & San Bernardino Road in the top half of Section 4.
- The 1898 USGS San Bernardino, California topographic quadrangle map (1:62,500 scale) depicts the Project Area as undeveloped and houses in the immediate vicinity.
- The 1901 USGS San Bernardino, California topographic quadrangle map (1:62,500 scale) does not depict any further development.
- Aerial photographs from 1938 show that the Project Area is being used for agriculture.
- The 1942 USGS San Bernardino, California topographic quadrangle map (1:62,500 scale) depicts a residence as within the Project Area.
- The 1943 USGS Fontana California topographic quadrangle map (1:31,680 scale) depicts residences to the north and west of Foothill Boulevard and Maple Avenue, one of which is in the Project Area.
- Aerial photographs from 1948 show structures north and west of Maple Avenue and Foothill Boulevard, one of which is located within the Project Area.
- The 1953 USGS Fontana, California topographic quadrangle map (1:24,000 scale) depicts the Project Area as having one main structure and three ancillary structures.
- The 1954 USGS San Bernardino, California topographic quadrangle map (1:62,500 scale) map depicts agricultural use within the Project Area and homes immediately to the south.
- Aerial photographs from 1959 and 1966 show five structures within the Project Area.
- The 1967 USGS Fontana, California topographic quadrangle map (1:24,000 scale) depicts further development along Maple Avenue and Foothill Boulevard outside of the Project Area.

- Aerial photographs from 1985 are unclear due to limited resolution, however, it appears that one of the northern buildings is no longer present.
- Aerial photographs from 1994 are also limited in resolution, but the buildings are no longer present.

In sum, the Project Area had been used for agricultural or school district purposes and was vacant until 1948; the buildings were removed by 1994.

5.2 Sacred Lands File Results

The results of the NAHC search of the Sacred Lands File were received on October 20, 2023. The search was positive, indicating the presence of sacred lands within the Project Area. A record of all correspondence to date is provided in Appendix B.

5.3 Other Interested Party Consultation Results

ECORP has not received any responses to the email sent to the Fontana Historical Society as of the date of the preparation of this document.

5.4 Field Survey Results

ECORP surveyed the Project Area for cultural resources on September 14, 2023. The ground surface visibility throughout the Project Area varied from good to poor. Areas with good visibility (i.e., between 60 and 90 percent) included the entire western half of the Project Area and large sections of the eastern half. Areas with fair and poor visibility (i.e., between 0 and 50 percent) included portions of the eastern half of the Project Area with dense vegetation and the areas beneath a trailer and a storage container, which were centered in the northern portion of the Project Area. Most of the Project Area was covered in moderately dense vegetation consisting of Russian thistle, ragweed, crabgrass, and other species. The entire Project Area appeared to have been disced, and the soil was loose and contained numerous animal burrows. The Project Area was also surrounded by a chain-link fence, which was down in one corner of the Project Area. Disturbances present included animal tracks, animal burrows, foot traffic, and a substantial amount of modern refuse throughout the Project Area. As a result of the field survey, ECORP did not locate any cultural resources within the Project Area.



Figure 2. Project Area Overview (view southwest; September 14, 2023).

6.0 MANAGEMENT CONSIDERATIONS

6.1 Conclusions

The records search and 2023 field survey did not yield any historic-period or pre-contact cultural resources within the Project Area. Therefore, no known Historic Properties under Section 106 of the NHPA or Historical Resources under CEQA will be affected by the Proposed Project.

6.2 Likelihood for Subsurface Cultural Resources

The Project Area and surrounding areas have not been studied extensively to determine the presence of cultural resources. Therefore, previous investigations are not sufficient to indicate the likelihood for subsurface cultural resources in the Project Area. Due to the presence of quaternary alluvial soils dating to the Holocene, the positive indication of sacred lands within the Project Area, and the likelihood of precontact sites along perennial waterways such as nearby Lytle Creek, there exists a moderate potential for buried pre-contact archaeological sites within the Project Area. Due to the presence of historic-period homes as shown in historic maps and historic aerial photograph reviews, but a lack of surface evidence to support their current presence, there exists a moderate potential for intact buried historic-period archaeological sites within the Project Area.

6.3 Recommendations

6.3.1 Contractor Awareness Training

The lead agency shall ensure that a Contractor Awareness Training Program is delivered to train equipment operators about cultural resources. The program shall be designed to inform construction personnel about: federal and state regulations pertaining to cultural resources and tribal cultural resources; the subsurface indicators of resources that shall require a work stoppage; procedures for notifying the lead agency of any occurrences; Project-specific requirements and mitigation measures; and enforcement of penalties and repercussions for non-compliance with the program.

The training shall be prepared by a qualified professional archaeologist and may be provided either through a brochure, video, or in-person tailgate meeting, as determined appropriate by the archaeologist. The training shall be provided to all construction supervisors, forepersons, and operators of ground-disturbing equipment. All personnel shall be required to sign a training roster. The construction manager is responsible for ensuring that all required personnel receive the training. The Construction Manager shall provide a copy of the signed training roster to the lead agency as proof of compliance.

6.3.2 Archaeological Monitoring

A qualified professional archaeologist, meeting or working under the direction of someone meeting the Secretary of the Interior's Professional Qualifications Standards, should be retained to monitor all ground-disturbing activities associated with Project construction, including vegetation removal, clearing, grading, trenching, excavation, or other activities that will disturb original (pre-Project) ground. The monitor must have the authority to temporarily pause activity at the location in the event of an unanticipated discovery,

so that they can direct the procedures in the following section. Initially, one monitor may be assigned to the Project who circulates throughout all areas of active ground disturbance. In the event of an unanticipated discovery, the lead agency should reconsider the number of monitors to ensure that future discoveries are managed in accordance with state law and federal laws.

6.3.3 Post-Review Discoveries

There always remains the potential for ground-disturbing activities to expose previously unrecorded cultural resources. Both CEQA and Section 106 of the NHPA require the lead agency to address any unanticipated cultural resource discoveries during Project construction. Therefore, ECORP recommends the following procedures.

- If subsurface deposits believed to be cultural or human in origin are discovered during construction, all work must halt within a 100-foot radius of the discovery. A qualified professional archaeologist, meeting the Secretary of the Interior’s Professional Qualification Standards for prehistoric and historic archaeology, shall be retained to evaluate the significance of the find, and shall have the authority to modify the no-work radius as appropriate, using professional judgment. The following notifications shall apply, depending on the nature of the find:
- If the professional archaeologist determines that the find does not represent a cultural resource, work may resume immediately, and no agency notifications are required.
- If the professional archaeologist determines that the find does represent a cultural resource from any time period or cultural affiliation, the archaeologist shall immediately notify the lead agencies. The agencies shall consult on a finding of eligibility and implement appropriate treatment measures, if the find is determined to be a Historical Resource under CEQA, as defined by CEQA or a historic property under Section 106 NHPA, if applicable. Work may not resume within the no-work radius until the lead agencies, through consultation as appropriate, determine that the site either: 1) is not a Historical Resource under CEQA or a Historic Property under Section 106; or 2) that the treatment measures have been completed to their satisfaction.
- If the find includes human remains, or remains that are potentially human, they shall ensure reasonable protection measures are taken to protect the discovery from disturbance (AB 2641). The archaeologist shall notify the San Bernardino County Coroner (per Section 7050.5 of the Health and Safety Code). The provisions of Section 7050.5 of the California Health and Safety Code, Section 5097.98 of the California PRC, and AB 2641 will be implemented. If the coroner determines the remains are Native American and not the result of a crime scene, the coroner will notify the NAHC, which then will designate a Native American Most Likely Descendant (MLD) for the Project (Section 5097.98 of the PRC). The designated MLD will have 48 hours from the time access to the property is granted to make recommendations concerning treatment of the remains. If the landowner does not agree with the recommendations of the MLD, the NAHC can mediate (Section 5097.94 of the PRC). If no agreement is reached, the landowner must rebury the remains where they will not be further disturbed (Section 5097.98 of the PRC). This will also include either recording the site with the NAHC or the appropriate Information Center; using an open space or conservation zoning designation or easement; or recording a reinternment

document with the county in which the property is located (AB 2641). Work may not resume within the no-work radius until the lead agencies, through consultation as appropriate, determine that the treatment measures have been completed to their satisfaction.

7.0 REFERENCES CITED

- Alexandrowicz, J. Steven, Anne Q. Duffield-Stoll, Jeanette A. McKenna, Susan R. Alexandrowicz, Arthur A. Kuhner, and Eric Scott. 1992. *Cultural and Paleontological Resources Investigations within the North Fontana Infrastructure Area, City of Fontana, San Bernardino County, California*. Prepared for the City of Fontana.
- Bean, Lowell J. and Charles R. Smith. 1978. Gabrielino. In *Handbook of North American Indians, Volume 8, California*, edited by R. F. Heizer, pp. 538-549. Smithsonian Institution, Washington, D.C.
- Booth, Ernest Sheldon. 1968. *Mammals of Southern California*. University of California Press. Berkeley.
- Bureau of Land Management (BLM). 2023 Bureau of Land Management, General Land Office Records, Records Automation website. <http://www.glorerecords.blm.gov/>. Accessed September 19, 2023.
- California Department of Transportation (Caltrans). 2020. Local Bridges. Caltrans GIS data (Last updated March 26, 2020). https://gisdata-caltrans.opendata.arcgis.com/datasets/989216729fdd41b3beb73029e000deda_0/explore?location=34.113891%2C-117.404990%2C13.84. Accessed September 20, 2023.
- _____. 2023. State Highway Brides. Caltrans GIS data (Last Updated February 13, 2023). https://gisdata-caltrans.opendata.arcgis.com/datasets/ea685fd702f840a7a751b12373d6249c_0/explore?location=34.123943%2C-117.372792%2C12.12. Accessed September 20, 2023.
- Castillo, Edward D. 1978. The Impact of Euro-American Exploration and Settlement. In *Handbook of North American Indians, Volume 8, California*, edited by R. F. Heizer, pp. 99-127. Smithsonian Institution, Washington D.C.
- City of Fontana. n.d.a. About the City of Fontana. <https://www.fontanaca.gov/31/About-Us>. Accessed July 31, 2023.
- _____. n.d.b. History. <https://www.fontanaca.gov/75/History>. Accessed July 31, 2023.
- City of Fontana City Council. 2018. Trends for Fontana's Future. <https://www.fontanaca.gov/DocumentCenter/View/26757/Chapter-2---Trends-for-Fontanas-Future>. Accessed July 31, 2023.
- Cleland, Robert Glass. 1941. *The Cattle on a Thousand Hills: Southern California, 1850-1970*. The Huntington Library Press, San Marino.
- Erlandson, J. M. 1994. *Early Hunter-Gatherers of the California Coast*. Plenum Press, New York.
- Fontana Historical Society. 2015. Historical Sites. <http://www.fontanahistoricalsociety.com/historical-sites.html>. Accessed September 19, 2023.
- Gallegos, D. 1991. Antiquity and Adaptation at Agua Hedionda, Carlsbad, California. In *Hunter-Gatherers of Early Holocene Coastal California*, edited by J. M. Erlandson and R. H. Colten, pp. 19-41.

- Perspectives in California Archaeology, Volume 1. Institute of Archaeology, University of California, Los Angeles.
- Goldberg, S. 2001. *Eastside Reservoir Project: Final Report of Archaeological Investigations* (Five volumes). Applied Earthworks, Inc., Hemet, California.
- Golla, V. 2011. *California Indian Languages*. University of California Press, Berkeley.
- Grenda, D. R. 1997. *Continuity and Change: 8,500 Years of Lacustrine Adaptation on the Shores of Lake Elsinore: Archaeological Investigations at a Stratified Site in Southern California*. Statistical Research Technical Series No 59. Statistical Research, Inc., Tucson, Arizona.
- Gudde, E. G. 1998. *California Place Names: The Origin and Etymology of Current Geographical Names*. Revised from the first edition, 1949. University of California Press, Berkeley.
- Gunther 1984. *Riverside County, California, Place Names: Their Origins and Their Stories*. JD Gunther.
- Haenszel, Arda M. and Jennifer Reynolds. 1975. *The Historic San Bernardino Mission District*. San Bernardino County Museum Association, Redlands, California.
- iNaturalist 2023. https://www.inaturalist.org/observations?place_id=156196. Accessed September 29, 2023.
- Koerper, H. C., P. Langenwalter II, and A. Schroth. 1991. Early Holocene Adaptations and the Transition Problem: Evidence from the Allan O. Kelly Site, Agua Hedionda Lagoon. In *Hunter-Gatherers of Early Holocene Coastal California*, edited by J. M. Erlandson and R. H. Colten, pp. 81-88. Perspectives in California Archaeology, Volume 1. Institute of Archaeology, University of California, Los Angeles.
- Kowta, M. 1969. *The Sayles Complex: A Late Milling Stone Assemblage from Cajon Pass and the Ecological Implications of Its Scaper Planes*. University of California Publications in Anthropology 6. Berkeley.
- Kyle, Douglas. 2002. *Historic Spots in California*. Stanford University Press. Stanford, California.
- McCawley, William. 1996. *The First Angelinos: The Gabrielino Indians of Los Angeles*. Malki Museum Press, Ballena Press, Banning, California.
- McKenna, Jeanette A. 2004. *A Phase I Cultural Resource Investigation of the Fontana Unified School District Elementary School #32 (8.43 Acres), in the City of Fontana, San Bernardino County, California*. Prepared for THE PLANNING CENTER.
- Miller, Bruce W. 1991. *The Gabrielino*. Sand River Press, Los Osos, California.
- Moratto, Michael J. 1984. *California Archaeology*. Academic Press, Inc. (Harcourt, Brace, Jovanovich, Publishers), Orlando, Florida.
- Morton, D. M. 2003. Preliminary Geologic Map of the Fontana 7.5' Quadrangle, Riverside and San Bernardino Counties, California, U.S. Geological Survey. Open File Report OF-2003-418, 1:24,000. https://ngmdb.usgs.gov/Prodesc/proddesc_61860.htm. Accessed September 19, 2023.

- National Park Service (NPS). 2023 National Register of Historic Places, Digital Archive on NPGallery. <https://www.nps.gov/subjects/nationalregister/database-research.htm>. Accessed September 18, 2023.
- _____. 1983. Archaeology and Historic Preservation: Secretary of the Interior's Standards and Guidelines. 48 Federal Register 44716-68.
- Natural Resources Conservation Service (NRCS). 2023. Natural Resources Conservation Service Web Soil Survey. <http://websoilsurvey.sc.egov.usda.gov/App/HomePage.htm>. Accessed September 18, 2023.
- Office of Historic Preservation (OHP). 2023a. *Office of Historic Preservation California Historical Landmarks Website*. http://ohp.parks.ca.gov/?page_id=21387. Accessed August 15, 2023.
- _____. 2023b. United States Rabbit Experimental Station Historical Landmark. <https://ohp.parks.ca.gov/ListedResources/Detail/950>. Accessed June 20, 2023.
- _____. 2022. Office of Historic Preservation's Built Environment Resource Directory (BERD), dated September 2, 2022 for San Bernardino County. https://ohp.parks.ca.gov/?page_id=30338. Accessed September 19, 2023.
- _____. 2012. Directory of Properties in the Historic Property Data File for San Bernardino County.
- _____. 1996. California Historical Landmarks. California Department of Parks and Recreation, Sacramento, California.
- _____. 1992. California Points of Historical Interest. California Department of Parks and Recreation, Sacramento, California.
- Pourade, Richard. 1961. *The History of San Diego: Time of the Bells*. San Diego Historical Society. <https://web.archive.org/web/20020221082220/http://www.sandiegohistory.org/books/pourade/time/timechapter9.htm>. Accessed August 15, 2023.
- Road trip Journeys. 2019. Fontana "City of Action". <https://www.theroute-66.com/fontana.html>. Accessed July 28, 2023.
- Robinson, W. W. 1948. *Land in California: The Story of Mission Lands, Ranchos, Squatters, Mining Claims, Railroad Grants, Land Scrip, Homesteads*. University of California Press, Berkeley.
- Rondeau, M. F., J. Cassidy, and T. L. Jones. 2007. Colonization Technologies: Fluted Projectile Points and the San Clemente Island Woodworking/Microblade Complex. In *California Prehistory: Colonization, Culture, and Complexity*, edited by T. L. Jones and K. A. Klar, pp. 299-315. Altamira Press, Lanham, Maryland.
- Salls, R. A. 1983. *The Liberty Grove Site: Archaeological Interpretation of a Late Milling Stone Horizon Site on the Cucamonga Plain*. M.A. Thesis, Department of Anthropology, University of California, Los Angeles.
- Schuling, Walter C. 1984. *San Bernardino County: Land of Contrasts*. Windsor Publications, Woodland Hills.

- Sperling's Best Places. n.d. Economy in Fontana, California.
<https://www.bestplaces.net/economy/city/california/fontana>. Accessed July 31, 2023.
- Sutton, M. Q. 2011. The Palomar Tradition and Its Place in the Prehistory of Southern California. *Pacific Coast Archaeological Society Quarterly* 44(4):1-74.
- _____. 2009. People and Language: Defining the Takic Expansion into Southern California. *Pacific Coast Archaeological Society Quarterly* 41(2 and 3):31-93.
- Sutton, M. Q. and J. K. Gardner. 2010. Reconceptualizing the Encinitas Tradition of Southern California. *Pacific Coast Archaeological Society Quarterly* 42(4):1-64.
- Wallace, W. J. 1955. A Suggested Chronology for Southern California Coastal Archaeology. *Southwestern Journal of Anthropology* 11:214-230.
- Warren, C. N. 1968. Cultural Tradition and Ecological Adaptation on the Southern California Coast. In *Archaic Prehistory in the Western United States*, edited by Cynthia Irwin-Williams, pp. 1-14. Eastern New Mexico University Contributions in Anthropology 1. Portales, New Mexico.
- _____. 1967. The San Dieguito Complex: a Review and Hypothesis. *American Antiquity* 32:168-185.
- Waugh, M. G. 1986. *Intensification and Land-Use: Archaeological Indication of Transition and Transformation in a Late Prehistoric Complex in Southern California*. Ph.D. dissertation, Department of Anthropology, University of California, Davis. UMI Dissertation Services, ProQuest, Ann Arbor.

LIST OF APPENDICES

Appendix A – Records Search Confirmation and Historical Society Coordination

Appendix B – Sacred Lands File Coordination

Appendix C – Project Area Photographs

Records Search Confirmation and Historical Society Coordination

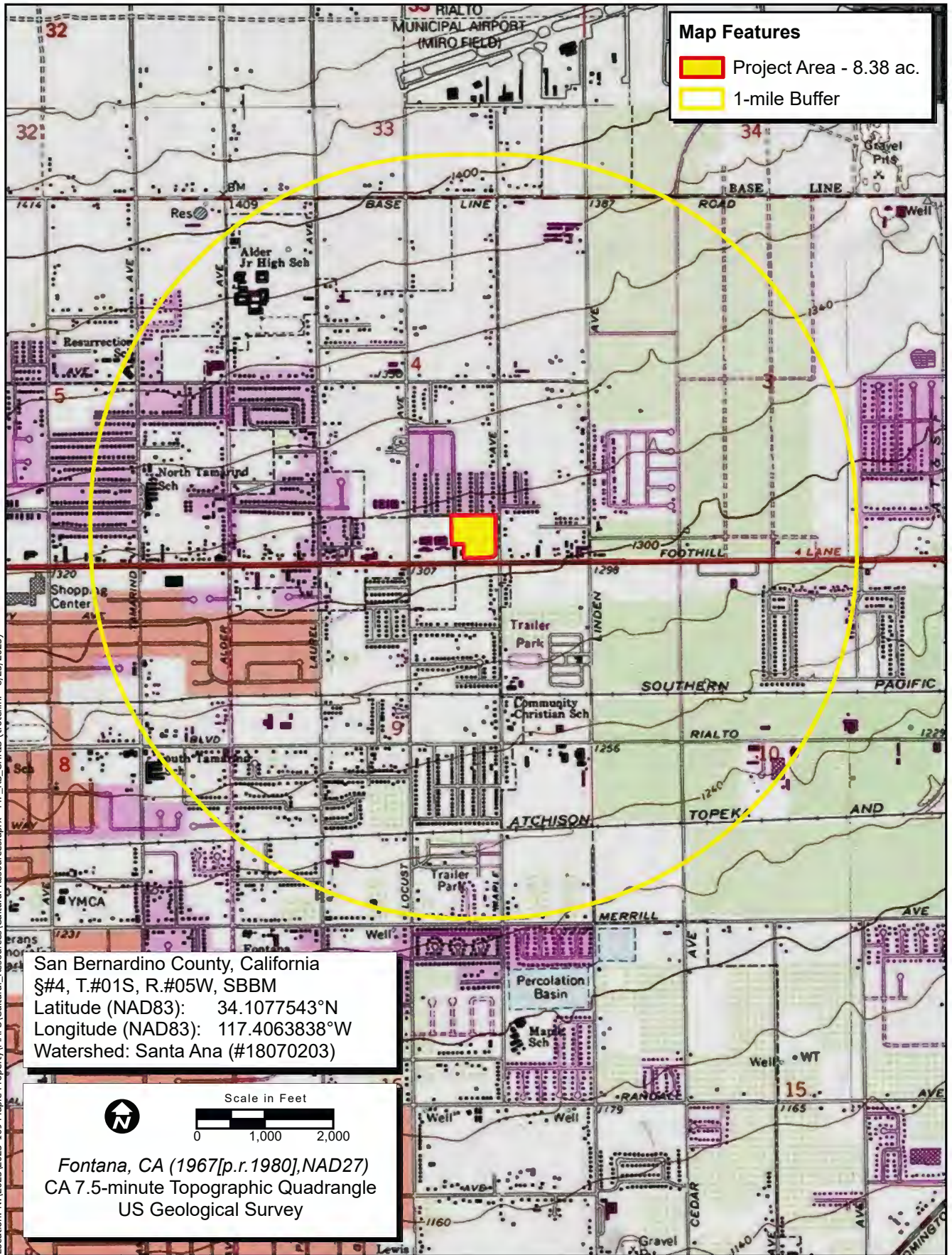

Map Features

- Project Area - 8.38 ac.
- 1-mile Buffer

San Bernardino County, Fontana
 §#4, T.#01S, R.#05W, SBBM
 Latitude (NAD83): 34.1077543°N
 Longitude (NAD83): 117.4063838°W
 Watershed: Santa Ana (#18070203)

Scale in Feet

Fontana, CA (1967[p.r.1980],NAD27)
 CA 7.5-minute Topographic Quadrangle
 US Geological Survey

Location: N:\2023\2023-169 Maple Property\MAPS\Cultural_Resources.aprx - MP_RS_CHRIS (trotellini) - 8/23/2023

Map Date: 8/23/2023
 Sources: ESRI, USGS

Records Search



2023-169 Maple Property

Report List

Maple Property 2023-169

Report No.	Other IDs	Year	Author(s)	Title	Affiliation	Resources
SB-00760	NADB-R - 1060760; Voided - 73-12.7	1973	WADE, M.P.M.	ARTIFACTS OF EARLY MAN IN THE NEW WORLD	SCIENCE 182 (4119):1371-1371	36-002102
SB-02621	NADB-R - 1062621; Voided - 92-2.20A-B	1992	ALEXANDROWICZ, J. STEVEN, ANNE Q. DUFFIELD-STOLL, JEANETTE A. MCKENNA, SUSAN R. ALEXANDROWICZ, ARTHUR A. KUHNER, and ERIC SCOTT	CULTURAL AND PALEONTOLOGICAL RESOURCES INVESTIGATIONS WITHIN THE NORTH FONTANA INFRASTRUCTURE AREA, CITY OF FONTANA, SAN BERNARDINO COUNTY, CALIFORNIA	ARCHAEOLOGICAL CONSULTING SERVICES	36-004296, 36-006110, 36-006111, 36-006251, 36-006583, 36-006584, 36-006585, 36-006586, 36-006587, 36-006588, 36-006589, 36-006807, 36-006808, 36-006809, 36-006810, 36-006811, 36-006812, 36-006813, 36-006814, 36-006815, 36-006816
SB-02942	NADB-R - 1062942	1994	GREENDA, DONN R.	ARCHAEOLOGICAL MONITORING AND ARCHIVAL RESEARCH OF PARCEL 246-121-01, SAN BERNARDINO COUNTY, CALIFORNIA	STATISTICAL RESEARCH	36-008040
SB-03538	NADB-R - 1063538	1995	WHITE, LAURIE and ROBERT S. WHITE	CULTURAL RESOURCES INVESTIGATION FLRO THE 3000 +/- ACRE CITY OF RIALTO AIRPORT AREA SPECIFIC PLAN, NORTH RIALTO, CA. 29PP	ARCHAEOLOGICAL ASSOCIATES	36-006110, 36-006250, 36-006329, 36-006780, 36-006781
SB-03598	NADB-R - 1063598	1998	BRECHBEIL, BRANT	CULTURAL RESOURCE RECORD SEARCH AND SURVEY REPORT FOR A PBMS TELECOMMUNICATIONS FACILITY: CM 190-01 IN THE CITY OF FONTANA, CA. 5PP	LSA	
SB-03896	NADB-R - 1063896	2003	MCKENNA, JEANETTE A.	A PHASE I CULTURAL RESOURCE INVENTORY OF THE FONTANA UNIFIED SCHOOL DISTRICT, ERIC BIRCH HIGH SCHOOL PROJECT, IN THE CITY OF FONTANA, SAN BERNARDINO COUNTY, CA. 41PP	MCKENNA ET AL	
SB-03897	NADB-R - 1063897	2003	MCKENNA, JEANETTE A.	A PHASE I CULTURAL RESOURCE INVESTIGATION OF THE FONTANA UNIFIED SCHOOL DISTRICT ELEMENTARY SCHOOL #29 IN THE CITY OF RIALTO, SAN BERNARDINO COUNTY, CA. 40PP	MCKENNA ET AL	
SB-04254	NADB-R - 1064254	2004	MCKENNA, JEANETTE A.	A PHASE I CULTURAL RESOURCES INVESTIGATION OF TEH FONTANA UNIFIED SCHOOL DISTRICT ELEMENTARY SCHOOL #32 (8.43 ACRES), IN THE CITY OF FONTANA, SAN BERNARDINO COUNTY, CA. 34PP	MCKENNA ET AL	

Report List

Maple Property 2023-169

Report No.	Other IDs	Year	Author(s)	Title	Affiliation	Resources
SB-04259	NADB-R - 1064259	2003	ROMANI, JOHN	NEGATIVE ARCHAEOLOGICAL SURVEY & SUPPLEMENTAL REPORT: YARD 3, ARROW ROUTE AT LOCUST AVE, FONTANA, SAN BERNARDINO COUNTY, CA. 11PP	COMPASS ROSE	
SB-04373	NADB-R - 1064373	2004	THAL, ERIKA	TAMARIND PARK/CA-5697-A	EARTH TOUCH	
SB-04536	NADB-R - 1064536	2005	THAL, SEAN M.	TAMARIND PARK/CA-5697B. 9PP	EARTHTOUCH, INC	
SB-04557	NADB-R - 1064557	2002	DICE, MICHAEL	AN ARCHAEOLOGICAL & PALEONTOLOGICAL RESOURCES ASSESSMENT OF 13,700' NAVAJO ROAD SEWER PROJECT, TOWN OF APPLE VALLEY, CA. 39PP	MICHAEL BRANDMAN ASSOCIATES	36-010860
SB-05498	Caltrans - ; NADB-R - 1065498	2003	Hammond, Christie	Historical Resources Compliance Report for Relinquishment of State Route 66 (Foothill Boulevard), City of Fontana, San Bernardino County, California.	Caltrans District 8	36-002910
SB-05498A		2003	Christie Hammond	Historical Resources Evaluation Report for the Relinquishment of State Route 66 (Foothill Boulevard) Between East Avenue/ Ilex Street and Maple Avenue city of Fontana San Bernardino, CA	Caltrans District 8	
SB-06128		2008	Wlodarski, Robert J.	Bechtel Wireless Telecommunications Site LA8064 (Solomon Colors II), 1251 West Durst Drive, Rialto, California	Cellular Archaeological Resource Evaluations	
SB-06814	NADB-R - 1066814	2010	Wlodarski, Robert J. and Bonner, Diane F.	Cultural Resources Record Search and Archaeological Survey Results for the Proposed Royal Street Communications, California, LLC, Site LA5150A (Schen Steel) Located at 8830 Vineyard Avenue, Rancho Cucamonga, San Bernardino County, California.	HEART	
SB-06913	NADB-R - 1066913	2011	Bonner, Wayne H. and Sarah A. Williams	Cultural Resource Records Search and Site Visit Results for T-Mobile USA Candidate IE 24319A (Eitwanda), 1424 West Foothill Boulevard, Rialto, San Bernardino County, California.		
SB-06916		2010	Hudson, Jonathan	Rialto CA 3, 150 South Larch Avenue, Rialto, CA		
SB-06969		2011	Puckett, Heather	Reed, 18150 Foothill Boulevard, Fontana, California	Tetra Tech, Inc	36-002910, 36-020137

Report List

Maple Property 2023-169

Report No.	Other IDs	Year	Author(s)	Title	Affiliation	Resources
SB-07084	NADB-R - 1067084	2010	Tang, Bai "Tom"	Preliminary Historical/Archaeological Resources Study, San Bernardino Line Positive Train Control Project, Southern California Regional Rail Authority, Counties of Los Angeles and San Bernardino.	CRM TECH	
SB-07086	NADB-R - 1067086	2011	Crawford, Kathleen	Direct APE Historic Architectural Assessment for T-Mobile USA Candidate IE24143-A (Blessed John XXIII), 17434 Miller Avenue, Fontana, San Bernardino County, California.		
SB-07515	NADB-R - 1067515	2012	Supernowicz, Dana E.	Archaeological Survey Report of the Arts Furniture Project, AT&T Mobility Site No. LA8063, 10828 Foothill Boulevard, Fontana, San Bernardino County, California 92376.	Historic Resource Consultants	
SB-07807	NADB-R - 1067807	2013	Puckett, Heather	Cultural Resources Assessment for the Proposed Verizon Wireless, Inc., Property at the Reed-Candidate B Site, Unaddressed Parcel Along Locust Avenue, Fontana, San Bernardino County, California 92335.	Tetra Tech, Inc	
SB-07809	NADB-R - 1067809	2012	Wlodarski, Robert J.	Records Search Results for the Proposed AT&T Wireless Telecommunications Site LA8063 (Art's Furniture), 18028 Foothill Blvd, Fontana, California 92376.	CARE	
SB-07867	NADB-R - 1067867	2014	Fulton, Phil	Cultural Resource Assessment Class I Inventory: Verizon Wireless Services Alder-New Candidate Facility, City of Fontana, County of San Bernardino, California.	LSA	36-024867
SB-08190		2015	McKenna, Jeanette A.	CULTURAL RESOURCES INVESTIGATIONS OF THE PROPOSED PROJECT AREA LOCATED AT BASELINE ROAD AND LAUREL AVENUE, ASSESSOR PARCEL NO. 0240-241-52, RIALTO, SAN BERNARDINO COUNTY, CALIFORNIA	McKENNA et al.	36-029057

Resource List

Maple Property 2023-169

Primary No.	Trinomial	Other IDs	Type	Age	Attribute codes	Recorded by	Reports
P-36-008040	CA-SBR-008040H	APN 246-121-01			AH04; AH16	1994 (GRENDA, DONN)	SB-02942
P-36-010659	CA-SBR-010659H	Resource Name - CG/SB-2	Site	Historic	AH04	2002 (Richard Shepard, Chambers Group); 2003	
P-36-024867							SB-07867



August 25, 2023

Fontana Historical Society
16830 Spring St, Fontana, California 92335,
Sent via email: fontanahistoricalsociety1906@gmail.com

RE: *Cultural Resources Identification Effort for the Maple Property Development Project, San Bernardino County, California*

Dear Fontana Historical Society:

ECORP Consulting, Inc. has been retained to assist in the planning of the development on the project indicated above. The proposed project area consists of a roughly square area comprising a total of approximately 8.5 acres located in the City of Fontana, This area is located east of Locus Avenue and west of North Maple Avenue, north of West Foothill Boulevard and south of Barbee Street in APNs: 02-431-4202, 02-431-4202, 02-431-4203, 02-431-4204, 02-431-4205, and 02-431-4206 in the Southeast quarter of the southwest quarter of section 4 in Township 1 South, Range 5 West; San Bernardino Base and Meridian as depicted on the 1980 Photo revised version of the 1969 Fontana, California 7.5 minute topographical map, as shown on the attached map. As part of the identification effort, we are seeking information from all parties that may have knowledge of or concerns with historic properties or cultural resources in the area of potential effect.

Included is a map showing the project area outlined. We would appreciate input on this undertaking from the historical society with concerns about possible cultural properties or potential impacts within or adjacent to the area of potential effect. If you have any questions, please contact me at (909) 307-0046 or ssifuentes@ecorpconsulting.com.

Thank you in advance for your assistance in our cultural resource management study.

Sincerely,

Sonia Sifuentes

Southern California Cultural
Resources Manager/Senior
Archaeologist

Attachment:
Project Location and Vicinity Map

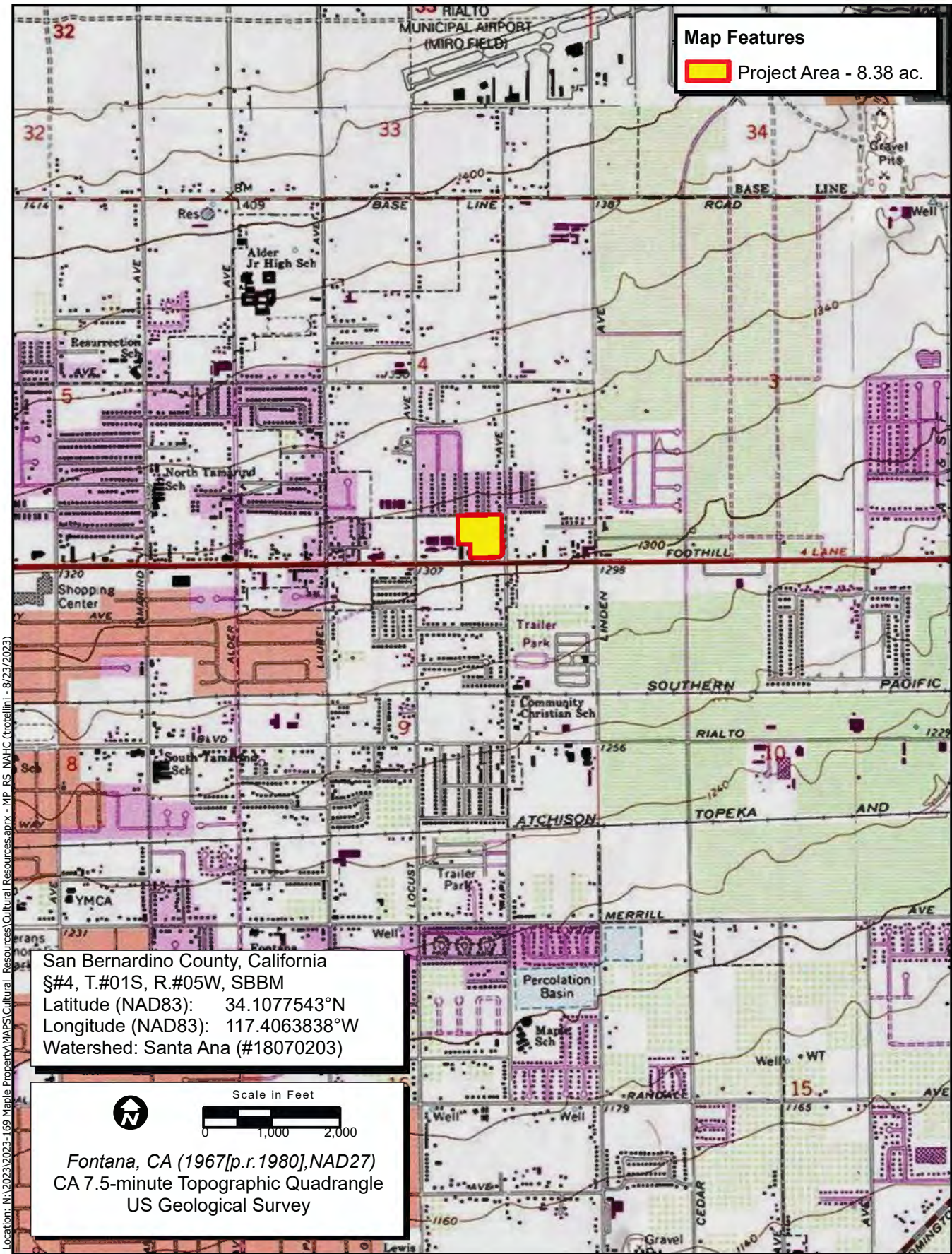

Map Features

Project Area - 8.38 ac.

San Bernardino County, California
 §#4, T.#01S, R.#05W, SBBM
 Latitude (NAD83): 34.1077543°N
 Longitude (NAD83): 117.4063838°W
 Watershed: Santa Ana (#18070203)

Scale in Feet
 0 1,000 2,000

Fontana, CA (1967[p.r.1980],NAD27)
 CA 7.5-minute Topographic Quadrangle
 US Geological Survey

Location: N:\2023\2023-169 Maple Property\MAPS\Cultural_Resources.aprx - MP_RS_NAHC (trotellini) - 8/23/2023

Map Date: 8/23/2023
 Sources: ESRI, USGS

Records Search

From: [Nick Bizzell](#)
To: fontanahistoricalsociety1906@gmail.com
Cc: [Sonia Sifuentes](#)
Subject: RE: Cultural Resources Identification Effort for the Maple Property Development Project, San Bernardino County
Date: Friday, August 25, 2023 1:18:00 PM
Attachments: [ECORP_Fontana Maple Property_08.25.2023.pdf](#)

My Apologies as I did not include the attached letter with map to the previous email. Please find here a copy of the letter and that attached location map. Thank you.

Nick Bizzell

Associate Archaeologist ♦ ECORP Consulting, Inc.



2861 Pullman St, Santa Ana, CA 92705

Ph: 714.648.0630 ♦ Fax: 714.648.0935 ♦

nbizzell@ecorpconsulting.com ♦ www.ecorpconsulting.com

Rocklin ♦ Redlands ♦ Santa Ana ♦ San Diego ♦ Chico ♦ Flagstaff, AZ ♦ Santa Fe, NM

From: Nick Bizzell
Sent: Friday, August 25, 2023 1:15 PM
To: fontanahistoricalsociety1906@gmail.com
Cc: Sonia Sifuentes <ssifuentes@ecorpconsulting.com>
Subject: Cultural Resources Identification Effort for the Maple Property Development Project, San Bernardino County

Dear Fontana Historical Society,

ECORP Consulting, Inc. has been retained to assist in the planning of the development on the project indicated above. The proposed Project Area consists of a roughly square area comprising a total of approximately 8.38 acres located in the City of Fontana. This area is located east of Locus Avenue and

west of North Maple Avenue, north of West Foothill Boulevard and south of Barbee Street in APNs: 02-

431-4201, 02-431-4202, 02-431-4203, 02-431-4204, 02-431-4205, and 02-431-4206 in the southeastern

quarter of the southwestern quarter of Section 4 in Township 1 South, Range 5 West, San Bernardino Base

and Meridian as depicted on the 1967 USGS Fontana, California (photorevised 1980) 7.5-minute topographical map, as attached. As part of the identification effort, we are seeking information from all

parties that may have knowledge of or concerns with historic properties or cultural resources in the

Project Area.

Included is a map showing the outlined Project Area. We would appreciate input on this undertaking from the historical society with concerns about possible cultural properties or potential impacts within or adjacent to the area of potential effect. If you have any questions, please contact Sonia Sifuentes at (909) 307-0046 or ssifuentes@ecorpconsulting.com.

Sincerely,

Nick Bizzell

Associate Archaeologist ♦ ECORP Consulting, Inc.



2861 Pullman St, Santa Ana, CA 92705

Ph: 714.648.0630 ♦ Fax: 714.648.0935 ♦

nbizzell@ecorpconsulting.com ♦ www.ecorpconsulting.com

Rocklin ♦ Redlands ♦ Santa Ana ♦ San Diego ♦ Chico ♦ Flagstaff, AZ ♦ Santa Fe, NM

Steven Wintergerst

From: Nick Bizzell
Sent: Friday, August 25, 2023 12:49 PM
To: NAHC@NAHC
Cc: Sonia Sifuentes
Subject: Requesting Sacred Lands File Search for the Maple Property Project 2023-169
Attachments: 2023-169_SLF_Maple_Property.pdf; MP_RS_NAHC(draft01).pdf

Good Afternoon,

ECORP is requesting a Sacred Lands file search for a planned 8.38 acre development project located within the APNs: 02-431-4201,02-431-4202,02-431-4203,02-431-4204,02-431-4205,and 02-431-4206. Attached is a copy of the Sacred Lands File search request and a location map. Please refer to the project number 2023-169 and CC ssifuentes@ecorpconsulting.com on all correspondence.

Thank you,

Nick Bizzell

Associate Archaeologist ♦ ECORP Consulting, Inc.



ECORP Consulting, Inc.
ENVIRONMENTAL CONSULTANTS

2861 Pullman St, Santa Ana, CA 92705

Ph: 714.648.0630 ♦ Fax: 714.648.0935 ♦

nbizzell@ecorpconsulting.com ♦ www.ecorpconsulting.com

Rocklin ♦ Redlands ♦ Santa Ana ♦ San Diego ♦ Chico ♦ Flagstaff, AZ ♦ Santa Fe, NM

Sacred Lands File & Native American Contacts List Request

Native American Heritage Commission

1550 Harbor Blvd, Suite 100

West Sacramento, CA 95691

916-373-3710

916-373-5471 – Fax

nahc@nahc.ca.gov

Information Below is Required for a Sacred Lands File Search

Project: Diversified Pacific-Fontana Maple Property

County: San Bernardino Date: Aug.25,2023

USGS Quadrangle Name: 1967 Fontana, CA (1980 Photo Revised)

Township: 1 south Range: 5 west Section(s): 4

Company/Firm/Agency: ECORP Consulting Inc.

Street Address: 215 North 5th Street

City: Redlands Zip: 92374

Phone: 909-307-0046

Fax: 909-307-0056

Email: ssifuentes@ecorpconsulting.com

Project Description:

Client Proposes the development of an 8.38 acre site located within the APNs: 02-431-4201,02-431-4202,02-431-4203,02-431-4204,02-431-4205,and 02-431-4206. Please refer to the project number 2023-169 and CC ssifuentes@ecorpconsulting.com on all correspondence.

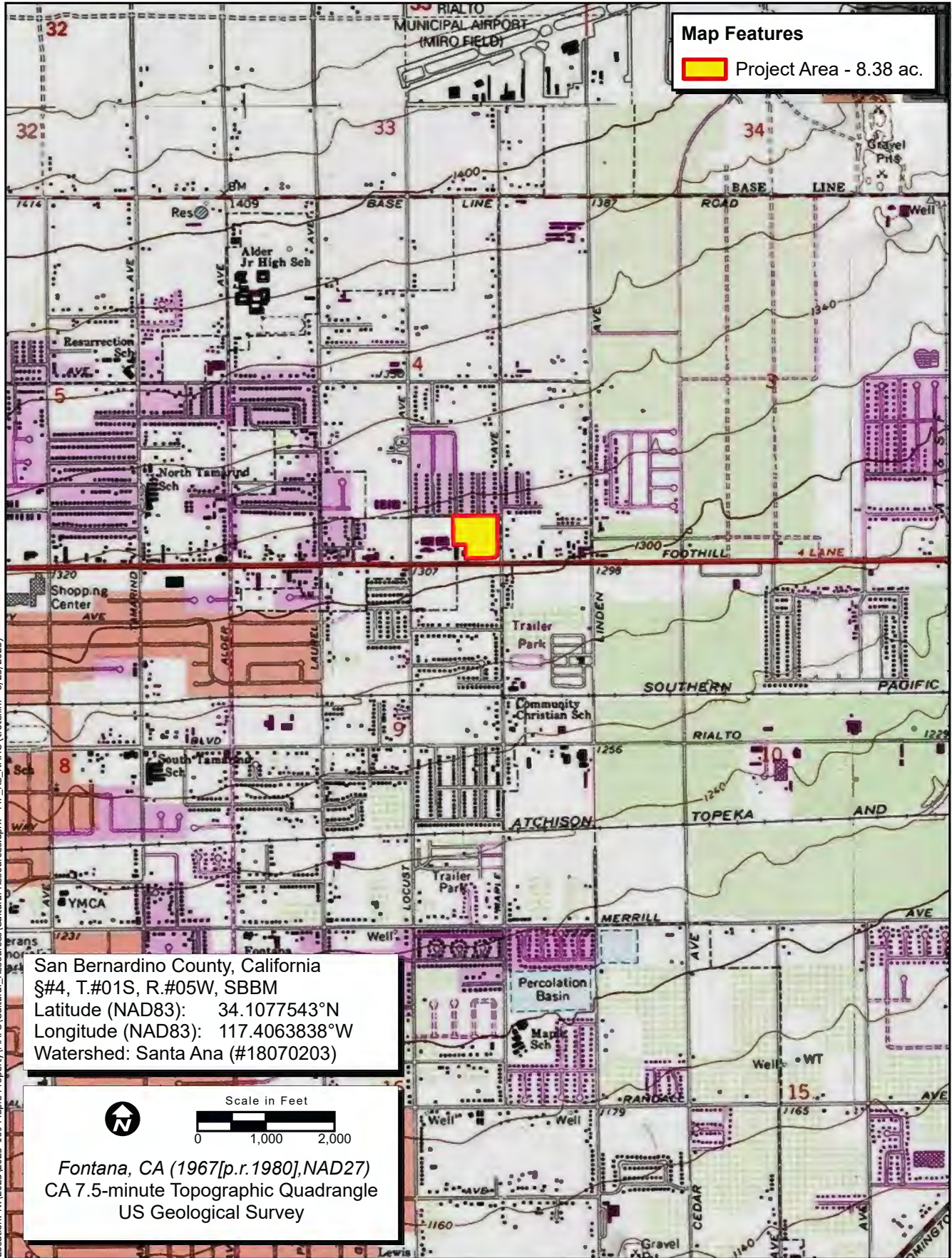

Map Features

Project Area - 8.38 ac.

San Bernardino County, Fontana
 §#4, T.#01S, R.#05W, SBBM
 Latitude (NAD83): 34.1077543°N
 Longitude (NAD83): 117.4063838°W
 Watershed: Santa Ana (#18070203)

Scale in Feet
 0 1,000 2,000

Fontana, CA (1967[p.r.1980], NAD27)
 CA 7.5-minute Topographic Quadrangle
 US Geological Survey

Location: N:\2023\2023-169 Maple Property\MAPS\Cultural_Resources\Cultural_Resources.aprx - MP_RS_NAHC (trotellini) - 8/23/2023

Map Date: 8/23/2023
 Sources: ESRI, USGS

Records Search

From: NAHC@NAHC
To: [Nick Bizzell](#)
Cc: [Vela, Cameron@NAHC](mailto:Vela,Cameron@NAHC)
Subject: RE: Requesting Sacred Lands File Search for the Maple Property Project 2023-169
Date: Monday, August 28, 2023 3:39:50 PM
Attachments: [2023-169 SLF Maple Property.pdf](#)
[MP_RS_NAHC\(draft01\).pdf](#)

Hello,

Thank you for your message. We're in receipt of your request. We have recently hired new staff, and this change in our office is creating some delays. We estimate a turn-around time of 4 weeks and don't anticipate responding sooner than the end of that time frame. Please let us know if you have any questions.

Kind regards,

Native American Heritage Commission

1550 Harbor Blvd, Suite 100
West Sacramento, CA 95691
(916) 373-3710

From: Nick Bizzell <nbizzell@ecorpconsulting.com>
Sent: Friday, August 25, 2023 12:49 PM
To: NAHC@NAHC <NAHC@nahc.ca.gov>
Cc: Sonia Sifuentes <ssifuentes@ecorpconsulting.com>
Subject: Requesting Sacred Lands File Search for the Maple Property Project 2023-169

You don't often get email from nbizzell@ecorpconsulting.com. [Learn why this is important](#)

Good Afternoon,

ECORP is requesting a Sacred Lands file search for a planned 8.38 acre development project located within the APNs: 02-431-4201,02-431-4202,02-431-4203,02-431-4204,02-431-4205,and 02-431-4206. Attached is a copy of the Sacred Lands File search request and a location map. Please refer to the project number 2023-169 and CC ssifuentes@ecorpconsulting.com on all correspondence. Thank you,

Nick Bizzell

Associate Archaeologist ♦ ECORP Consulting, Inc.



2861 Pullman St, Santa Ana, CA 92705

Ph: 714.648.0630 ♦ Fax: 714.648.0935 ♦

nbizzell@ecorpconsulting.com ♦ www.ecorpconsulting.com

Rocklin ♦ Redlands ♦ Santa Ana ♦ San Diego ♦ Chico ♦ Flagstaff, AZ ♦ Santa Fe, NM

NATIVE AMERICAN HERITAGE COMMISSION

October 20, 2023

Nick Bizzell
ECORP Consulting Inc.

Via Email to: nbizzell@ecorpconsulting.com

Re: Diversified Pacific-Fontana Maple Property Project , San Bernardino County

Dear Mr. Bizzell:

A record search of the Native American Heritage Commission (NAHC) Sacred Lands File (SLF) was completed for the information submitted for the above referenced project. The results were positive. Please contact the Gabrieleno Band of Mission Indians / Kizh Nation on the attached list for information. Please note that tribes do not always record their sacred sites in the SLF, nor are they required to do so. A SLF search is not a substitute for consultation with tribes that are traditionally and culturally affiliated with a project's geographic area. Other sources of cultural resources should also be contacted for information regarding known and recorded sites, such as the appropriate regional California Historical Research Information System (CHRIS) archaeological Information Center for the presence of recorded archaeological sites.

Attached is a list of Native American tribes who may also have knowledge of cultural resources in the project area. This list should provide a starting place in locating areas of potential adverse impact within the proposed project area. Please contact all of those listed; if they cannot supply information, they may recommend others with specific knowledge. By contacting all those listed, your organization will be better able to respond to claims of failure to consult with the appropriate tribe. If a response has not been received within two weeks of notification, the Commission requests that you follow-up with a telephone call or email to ensure that the project information has been received.

If you receive notification of change of addresses and phone numbers from tribes, please notify the NAHC. With your assistance, we can assure that our lists contain current information.

If you have any questions or need additional information, please contact me at my email address: Cameron.vela@nahc.ca.gov.

Sincerely,

Cameron Vela

Cameron Vela
Cultural Resources Analyst

Attachment



CHAIRPERSON
Reginald Pagaling
Chumash

VICE-CHAIRPERSON
Buffy McQuillen
Yokayo Pomo, Yuki,
Nomlaki

SECRETARY
Sara Dutschke
Miwok

PARLIAMENTARIAN
Wayne Nelson
Luiseño

COMMISSIONER
Isaac Bojorquez
Ohlone-Costanoan

COMMISSIONER
Stanley Rodriguez
Kumeyaay

COMMISSIONER
Laurena Bolden
Serrano

COMMISSIONER
Reid Milanovich
Cahuilla

COMMISSIONER
Vacant

EXECUTIVE SECRETARY
Raymond C. Hitchcock
Miwok, Nisenan

NAHC HEADQUARTERS
1550 Harbor Boulevard
Suite 100
West Sacramento,
California 95691
(916) 373-3710
nahc@nahc.ca.gov
NAHC.ca.gov

Native American Heritage Commission
Native American Contact List
San Bernardino County
10/20/2023

County	Tribal Name	Fed (F) Non-Fed (N)	Contact Person	Contact Address	Phone #	Fax #	Email Address	Cultural Affiliation	Counties	Last Updated
San Bernardino	Agua Caliente Band of Cahuilla Indians	F	Patricia Garcia, Director of Historic Preservation	5401 Dinah Shore Drive Palm Springs, CA, 92264	(760) 699-6907	(760) 699-6919	pagarcia@aguacaliente.net	Cahuilla	Imperial,Riverside,San Bernardino,San Diego	7/20/2023
	Augustine Band of Cahuilla Mission Indians	F	Amanda Vance, Chairperson	84-001 Avenue 54 Coachella, CA 92228	(760) 398-4722	(760) 399-7161	haines@augustinetribe.com	Cahuilla	Imperial,Riverside,San Bernardino,San Diego	
	Cabazon Band of Mission Indians	F	Doug Weimas, Chairperson	84-245 Indio Springs Parkway Indio, CA 92231	(760) 942-2593	(760) 347-7880	jsapp@cabazonindians-nsn.gov	Cahuilla	Imperial,Riverside,San Bernardino,San Diego	
	Cahuilla Band of Indians	F	Anthony Madrigal, Tribal Historic Preservation Officer	52701 CA Highway 371 Anza, CA, 92539	(951) 763-5549		anthonymad2002@gmail.com	Cahuilla	Imperial,Riverside,San Bernardino,San Diego	6/28/2023
	Cahuilla Band of Indians	F	Daniel Salgado, Chairperson	52701 CA Highway 371 Anza, CA, 92539	(951) 972-2568	(951) 763-2808	chairman@cahuilla-nsn.gov	Cahuilla	Imperial,Riverside,San Bernardino,San Diego	6/28/2023
	Cahuilla Band of Indians	F	BobbyRay Esapira, Cultural Director	52701 CA Highway 371 Anza, CA, 92539	(951) 763-5549		besparza@cahuilla-nsn.gov	Cahuilla	Imperial,Riverside,San Bernardino,San Diego	6/28/2023
	Gabrielino Band of Mission Indians - Kizh Nation	N	Christina Swindall Martinez, Secretary	P.O. Box 393 Covina, CA 91723	(844) 390-0787		admin@gabrielinoindians.org	Gabrielino	Los Angeles,Orange,Riverside,San Bernardino,Santa Barbara,Ventura	8/18/2023
	Gabrielino Band of Mission Indians - Kizh Nation	N	Andrew Salas, Chairperson	P.O. Box 393 Covina, CA 91723	(844) 390-0787		admin@gabrielinoindians.org	Gabrielino	Los Angeles,Orange,Riverside,San Bernardino,Santa Barbara,Ventura	8/18/2023
	Gabrielino/Tongva San Gabriel Band of Mission Indians	N	Anthony Morales, Chairperson	P.O. Box 693 San Gabriel, CA 91778	(626) 483-3564	(626) 286-1262	GTTribalCouncil@swi.com	Gabrielino	Los Angeles,Orange,Riverside,San Bernardino,Ventura	
	Gabrielino/Tongva Nation	N	Sandonne Good, Chairperson	106 1/2 Judge John Also St., #231 Los Angeles, CA, 90012	(951) 807-0479		sgood@gabrielino-tongva.com	Gabrielino	Los Angeles,Orange,Riverside,San Bernardino,Ventura	3/28/2023
	Gabrielino/Tongva Indians of California Tribal Council	N	Christina Conroy, Cultural Resource Administrator	P.O. Box 841078 Sunny Valley, CA, 93004	(626) 407-8761		christina.marsden@salumni.usc.edu	Gabrielino	Los Angeles,Orange,Riverside,San Bernardino,Santa Barbara,Ventura	3/16/2023
	Gabrielino/Tongva Indians of California Tribal Council	N	Robert Dorame, Chairperson	P.O. Box 490 Bellflower, CA, 90707	(562) 761-6417	(562) 761-6417	rtongva@gmail.com	Gabrielino	Los Angeles,Orange,Riverside,San Bernardino,Santa Barbara,Ventura	3/16/2023
	Gabrielino-Tongva Tribe	N	Sam Dunlap, Cultural Resource Director	P.O. Box 3919 Seal Beach, CA, 90740	(909) 262-9351		tongvator@gmail.com	Gabrielino	Los Angeles,Orange,Riverside,San Bernardino,Ventura	5/30/2023
	Gabrielino-Tongva Tribe	N	Charles Alvarez, Chairperson	23454 Vanowen Street West Hills, CA, 91307	(310) 403-6048		Chavez1986metro@gmail.com	Gabrielino	Los Angeles,Orange,Riverside,San Bernardino,Ventura	5/30/2023
	Los Coyotes Band of Cahuilla and Cupeno Indians	F	Ray Chapparro, Chairperson	P.O. Box 189 Warner Springs, CA, 92086-0189	(760) 782-0711	(760) 782-0712		Cahuilla	Imperial,Riverside,San Bernardino,San Diego	
	Morongo Band of Mission Indians	F	Robert Martin, Chairperson	12700 Pumara Road Banning, CA, 92220	(951) 755-5110	(951) 755-5177	abrierty@morongo-nsn.gov	Cahuilla Serrano	Imperial,Los Angeles,Riverside,San Bernardino,San Diego	
	Morongo Band of Mission Indians	F	Ann Brierty, THPO	12700 Pumara Road Banning, CA, 92220	(951) 755-5259	(951) 572-6004	abrierty@morongo-nsn.gov	Cahuilla Serrano	Imperial,Los Angeles,Riverside,San Bernardino,San Diego	
	Pala Band of Mission Indians	F	Shasta Gaughen, Tribal Historic Preservation Officer	PMB 50, 35008 Pala Temecula Road Pala, CA, 92059	(760) 891-3515	(760) 742-3189	sgaughen@pala-tribe.com	Cupeno Luiseno	Orange,Riverside,San Bernardino,San Diego	3/23/2023
	Pala Band of Mission Indians	F	Alexis Walick, Assistant THPO	PMB 50, 35008 Pala Temecula Road Pala, CA, 92059	(760) 891-3537		awalick@pala-tribe.com	Cupeno Luiseno	Orange,Riverside,San Bernardino,San Diego	3/23/2023
	Pechanga Band of Indians	F	Silve Bodmer, General Counsel for Pechanga Band of Indians	P.O. Box 1477 Temecula, CA, 92593	(951) 770-6171	(951) 695-1778	sbodmer@pechanga-nsn.gov	Luiseno	Los Angeles,Orange,Riverside,San Bernardino,San Diego,Santa Barbara,Ventura	8/22/2023
	Pechanga Band of Indians	F	Tuba Ebru Oztil, Pechanga Cultural Analyst	P.O. Box 2183 Temecula, CA, 92593	(951) 770-6313	(951) 695-1778	oztil@pechanga-nsn.gov	Luiseno	Los Angeles,Orange,Riverside,San Bernardino,San Diego,Santa Barbara,Ventura	8/22/2023
	Quechan Tribe of the Fort Yuma Reservation	F	Jordan Joaquin, President, Quechan Tribal Council	P.O. Box 1899 Yuma, AZ, 85366	(760) 918-3600		executive@quechantribe.com	Quechan	Imperial,Kern,Los Angeles,Riverside,San Bernardino,San Diego	5/16/2023
	Quechan Tribe of the Fort Yuma Reservation	F	Manfred Scott, Acting Chairman-Ku'tan Cultural Committee	P.O. Box 1899 Yuma, AZ, 85366	(928) 210-8739		culturalcommittee@quechantribe.com	Quechan	Imperial,Kern,Los Angeles,Riverside,San Bernardino,San Diego	5/16/2023
	Quechan Tribe of the Fort Yuma Reservation	F	Jill McCormick, Historic Preservation Officer	P.O. Box 1899 Yuma, AZ, 85366	(928) 261-0254		historikpreservation@quechantribe.com	Quechan	Imperial,Kern,Los Angeles,Riverside,San Bernardino,San Diego	5/16/2023
	Ramona Band of Cahuilla	F	John Gomez, Environmental Coordinator	P.O. Box 381670 Anza, CA, 92539	(951) 763-4105	(951) 763-4325	gomez@ramona-nsn.gov	Cahuilla	Imperial,Riverside,San Bernardino,San Diego	8/16/2016
	Ramona Band of Cahuilla	F	Joseph Hamilton, Chairperson	P.O. Box 381670 Anza, CA, 92539	(951) 763-4105	(951) 763-4325	admin@ramona-nsn.gov	Cahuilla	Imperial,Riverside,San Bernardino,San Diego	
	Rincon Band of Luiseno Indians	F	Laure Gonzalez, Tribal Council/Culture Committee Member	One Government Center Lane Valley Center, CA, 92082	(760) 484-4835		lgonzalez@rincon-nsn.gov	Luiseno	Los Angeles,Orange,Riverside,San Bernardino,San Diego,Santa Barbara,Ventura	5/31/2023
	Rincon Band of Luiseno Indians	F	Denise Turner Walsh, Attorney General	One Government Center Lane Valley Center, CA, 92082	(760) 689-5727		dwalsh@rincon-nsn.gov	Luiseno	Los Angeles,Orange,Riverside,San Bernardino,San Diego,Santa Barbara,Ventura	7/7/2023
	Rincon Band of Luiseno Indians	F	Cheryl Madrigal, Cultural Resources Manager/Tribal Historic Preservation Officer	One Government Center Lane Valley Center, CA, 92082	(760) 648-3000		cmadrigal@rincon-nsn.gov	Luiseno	Los Angeles,Orange,Riverside,San Bernardino,San Diego,Santa Barbara,Ventura	5/31/2023
	Rincon Band of Luiseno Indians	F	Joseph Linton, Tribal Council/Culture Committee Member	One Government Center Lane Valley Center, CA, 92082	(760) 803-3548		jlinton@rincon-nsn.gov	Luiseno	Los Angeles,Orange,Riverside,San Bernardino,San Diego,Santa Barbara,Ventura	5/31/2023
	San Manuel Band of Mission Indians	F	Alexandra McCleary, Cultural Lands Manager	26669 Community Center Drive Highland, CA, 92346	(909) 633-0054		Alexandra.mccleary@sanmanuel-nsn.gov	Serrano	Kern,Los Angeles,Riverside,San Bernardino	3/27/2023
	Santa Rosa Band of Cahuilla Indians	F	Lovina Redner, Tribal Chair	P.O. Box 381820 Anza, CA, 92539	(951) 659-2700	(951) 659-2228	lsaul@santarosa-nsn.gov	Cahuilla	Imperial,Los Angeles,Orange,Riverside,San Bernardino,San Diego	
	Serrano Nation of Mission Indians	N	Mark Cochrane, Co-Chairperson	P.O. Box 343 Patton, CA, 92369	(909) 578-2598		serranonation@gmail.com	Serrano	Los Angeles,Riverside,San Bernardino	10/10/2023
	Serrano Nation of Mission Indians	N	Wayne Walker, Co-Chairperson	P.O. Box 343 Patton, CA, 92369	(253) 370-0167		serranonation@gmail.com	Serrano	Los Angeles,Riverside,San Bernardino	10/10/2023
	Soboba Band of Luiseno Indians	F	Joseph Orliveros, Tribal Historic Preservation Officer	P.O. Box 487 San Jacinto, CA, 92581	(951) 663-5279	(951) 654-4198	jooriveros@soboba-nsn.gov	Cahuilla Luiseno	Imperial,Los Angeles,Orange,Riverside,San Bernardino,San Diego	7/14/2023
	Soboba Band of Luiseno Indians	F	Jessica Valdez, Cultural Resource Specialist	P.O. Box 487 San Jacinto, CA, 92581	(951) 663-6261	(951) 654-4198	jvaldez@soboba-nsn.gov	Cahuilla Luiseno	Imperial,Los Angeles,Orange,Riverside,San Bernardino,San Diego	7/14/2023
	Torres-Martinez Desert Cahuilla Indians	F	Cultural Committee	P.O. Box 1160 Thermal, CA, 92274	(760) 397-0300	(760) 397-8146	Cultural-Committee@torresmartinez-nsn.gov	Cahuilla	Imperial,Riverside,San Bernardino,San Diego	

This list is current only as of the date of this document. Distribution of this list does not relieve any person of statutory responsibility as defined in Section 7050.5 of the Health and Safety Code, Section 5097.94 of the Public Resource Code, or Section 5097.98 of the Public Resources Code.

This list is only applicable for contacting local Native Americans with regard to cultural resources assessment for the proposed Diversified Pacific-Fontana Maple Property Project, San Bernardino County.

Record: PR03-2023-094022
Report Type: List of Tribes
County: San Bernardino
MMC Group: All

APPENDIX C

Project Area Photographs



IMG_0398



IMG_0399



IMG_0400



IMG_0401



IMG_0402



IMG_0403



IMG_0404



IMG_0405



IMG_0406





