



Ventura County

Michelle Ascencion , County Clerk-Recorder & Registrar of Voters
800 S. Victoria Ave.
Ventura, CA 93009
(805) 654-2263 (Clerk/Vitals)
(805) 654-3665 (Recorder)

Receipt: 26-32571

Product	Name	Extended
FISH	FISH AND WILDLIFE FILING	\$50.00
	# Pages	6
	Document #	2026100003976
	Document Info:	VENTURA COUNTY PWA - WATERSHED PROTECTION
	Filing Type	NOE
	State Fee Prev Charged	false
	No Handling Fee	false
Total		\$50.00
Tender (On Account)		\$50.00
Account #	800	
Account Name	VITAL CHECK RECORDER	
Balance	\$2,594.00	
Name for Return Address	VENTURA COUNTY PWA WATERSHED PROTECTION	
Comments	219218623	

04/15/2026 04:04 PM PDT

VENTURA COUNTY RECORDER
800 SOUTH VICTORIA AVENUE
VENTURA, CA 93009

TERMINAL NAME: E2530707

ORDER# 219218623

PAYMENT

RECORDING FEES \$50.00
AGENCY SUBTOTAL: \$50.00
LEXISNEXIS SERVICE FEE: \$2.50
TOTAL USD: \$52.50

CARD #: 2941 VISA
PAYMENT: CREDITCHIP READ-CONTACT
MODE: ISSUER
AUTH CODE: 070192
APP LABEL: VISA CREDIT
CVM: NO SIG REQUIRED
AID: A0000000031010
ARQC: 1C73C71F37A8E552
AMOUNT: \$52.50
*** CARD APPROVED ***

Thank you for your order.

Note: If payment was by credit card with Vital Check, balance shown is for internal purposes c

4/15/26, 4:05 PM PST QUELLRA
VENTURA

AMOUNT PAID:
\$52.50

CUSTOMER COPY



2026 ENVIRONMENTAL DOCUMENT FILING FEE CASH RECEIPT

DFW 753.5a (REV. 01/01/26) Previously DFG 753.5a

RECEIPT NUMBER:
56-04152026-068

STATE CLEARINGHOUSE NUMBER (If applicable)

SEE INSTRUCTIONS ON REVERSE. TYPE OR PRINT CLEARLY.

LEAD AGENCY VENTURA COUNTY PWA - WATERSHED PROTECTION	LEAD AGENCY EMAIL EMILY.MEDLER@VENTURACOUNTY.ORG	DATE 04/15/2026
--	---	--------------------

COUNTY/STATE AGENCY OF FILING VENTURA	DOCUMENT NUMBER 2026100003976
--	----------------------------------

PROJECT TITLE
ADAMS BARRANCA DEBRIS BASIN SEDIMENT CLEANOUT (SPECIFICATION NO WP26-14 PROJECT NO.F60F3906)

PROJECT APPLICANT NAME VENTURA COUNTY PWA-WATERSHED PROTECTION	PROJECT APPLICANT EMAIL EMILY.MEDLER@VENTURACOUNTY.	PHONE NUMBER (805) 654-5142
---	--	--------------------------------

PROJECT APPLICANT ADDRESS 800 S VICTORIA AVENUE	CITY VENTURA	STATE CA	ZIP CODE 93009
--	-----------------	-------------	-------------------

PROJECT APPLICANT (Check appropriate box)

Local Public Agency School District Other Special District State Agency Private Entity

CHECK APPLICABLE FEES:

<input type="checkbox"/> Environmental Impact Report (EIR)	\$4,227.50	\$ _____
<input type="checkbox"/> Mitigated/Negative Declaration (MND)(ND)	\$3,043.75	\$ _____
<input type="checkbox"/> Certified Regulatory Program (CRP) document - payment due directly to CDFW	\$1,437.25	\$ _____

Exempt from fee

Notice of Exemption (attach)

CDFW No Effect Determination (attach)

Fee previously paid (attach previously issued cash receipt copy)

<input type="checkbox"/> Water Right Application or Petition Fee (State Water Resources Control Board only)	\$850.00	\$ _____
<input checked="" type="checkbox"/> County documentary handling fee		\$ _____ \$50.00
<input type="checkbox"/> Other		\$ _____

PAYMENT METHOD:

Cash Credit Check Other

TOTAL RECEIVED \$ _____ \$50.00

SIGNATURE 	AGENCY OF FILING PRINTED NAME AND TITLE VENTURA COUNTY CLERK, RAYLENE QUELL, DEPUTY
---------------	--

Filed in County Clerk's Office
Michelle Ascencion
Ventura County Clerk-Recorder

2026100003976

04/15/2026 Pages: 6
04:05 PM
VEN Fees: \$50.00
DocType: FISH
QUELLRA

POSTED
APR 15 2025

MICHELLE ASCENCION
Ventura County Clerk and Recorder
By: _____, Deputy





NOTICE OF EXEMPTION

TO: COUNTY CLERK
COUNTY OF VENTURA

FROM: Director, Watershed Protection District
800 South Victoria Avenue / #1600
Ventura, CA 93009-1600

OFFICE OF PLANNING AND
RESEARCH
P.O. Box 3044, Room 113
Sacramento, CA 95812-3044

Project Title: Adams Barranca Debris Basin Sediment Cleanout (Specification No. WP26-14, Project No. P60F3906)
Project Location: Unincorporated Ventura County (34.350908, -119.104337)
Description of Nature, Purpose and Beneficiaries of the Project: Watershed Protection is proposing to remove 80,000 cubic yards of accumulated sediment and debris in the 3.3-acre Adams Barranca Debris Basin. Sediment and debris removal last occurred in 2017. Much of the sediment was captured during the 2023 and 2024 storm seasons. Access to the work area will be from Adams Canyon Rd and County-owned Right-of-Way. Work is scheduled to begin in May 2026 and shall take approximately 75 working days to complete. Work is scheduled to begin during nesting bird season, therefore, biological surveys will be performed prior to and periodically during work to identify and avoid sensitive biological resources. No mature trees will be removed during work.
A Final Program Environmental Impact Report (EIR) on Environmental Protection Measures for the Ongoing Routine Operations and Maintenance Program was prepared in May 2008 (State Clearinghouse No. 2002091107). All applicable Best Management Practices described in the EIR and subsequent regulatory permits will be used for the proposed project. Debris excavated from this facility will be disposed of at a site approved by the County of Ventura Integrated Waste Management Division. The proposed actions are necessary to maintain public safety and protection of downstream properties.
Name of Public Agency Approving Project: Ventura County Watershed Protection District
Name of Person or Agency Carrying Out Project: Gregg Strakaluse, PE, CFM, Director, Public Works Agency; Interim Director, Watershed Protection District

Exempt Status:

Categorical Exemption. State Type and section number:
Class 1 Existing Facilities, Section 15301

Reasons why project is exempt: The Project consists of sediment removal work within an existing detention basin facility involving no expansion of its existing or former use (Sec. 15301 (b), (d), (i)). Exceptions to the exemption do not apply to the project (Section 15300.2)

Lead Agency Contact Person: Gregg Strakaluse, PE, Director, Public Works Agency; Interim Director, Watershed Protection District	Area Code/Telephone/Extension (805) 654-2073
---	--

Date Received for Filing

[Empty box for Date Received for Filing]



Director

04/14/2026

Date



VCWPD FACILITY INVESTIGATION
ZONE 2

**2.4. Adams Barranca Debris Basin Cleanout-2024-2025,
Unincorporated Ventura County**

P Code(s): 411 **PT Code(s):** 36 **Reach #:** 43906 **Project #:** P60F3609 ~~P6043906~~

Facility Type: Debris Basin

Area of Impact: Approximately **3.5** ~~3-3~~ acres of temporary impact within the basin. No permanent impact.

WORK DESCRIPTION: The project will remove approximately **80,000** ~~20,000~~ cubic yards of sediment and debris from Adams Barranca Debris Basin.

APPROXIMATE QUANTITIES: Approximately **80,000** ~~20,000~~ cubic yards of sediment and debris to be removed.

DISPOSAL SITE: Debris excavated from this facility will be disposed of at a site approved by the County of Ventura Integrated Waste Management Division.

EQUIPMENT USED: Wheel loaders, bulldozers, excavators, dump trucks, water truck, and street sweeper.

WATER DIVERSION: The work area is anticipated to be dry. Any surface water present during the course of work will be directed around the active excavation areas to the bleeder pipe per the Water Diversion Guide and Best Management Practices.

BMPs APPLIED: 1, 3, 4, 10, 18, 21, 24, and 28.

DURATION/TIMING: **Start: April 21, 2026** ~~December 15, 2024,~~ **End: August 2, 2026**
~~June 30, 2025~~

Approximately 75 working days. ~~Working days not calculated.~~

SPECIES IMPACTED: No adverse impacts to species anticipated.

MITIGATION: Mitigation is not required or proposed.

COORDINATES: **NE:** 34.351738, -119.104231 **SE:** 34.350175, -119.103176
NW: 34.351722, -119.105278 **SW:** 34.349861, -119.104500

NOTES:

1. TEMPORARY WORK AREA LIMITS SHALL BE STAKED AND ALL EQUIPMENT SHALL BE OPERATED WITHIN THE TEMPORARY WORK AREA LIMITS.
2. EXISTING IMPROVEMENTS WITHIN THE RIGHT OF WAY AND WORK AREAS SHALL REMAIN AND SHALL BE PROTECTED UNLESS OTHERWISE NOTED. DAMAGED IMPROVEMENTS SHALL BE REPLACED IN KIND TO A CONDITION EQUAL OR BETTER THAN THAT WHICH EXISTED PRIOR TO CONSTRUCTION AT CONTRACTOR'S OWN EXPENSE, AND TO THE SATISFACTION OF THE ENGINEER. EXTRA SPECIAL CARE SHALL BE TAKEN TO PROTECT ALL RC STRUCTURES WHILE EXCAVATING AROUND THEM.
3. MISURPAD: ALL CMB ACCESS PAVES IN ACCORDANCE WITH 1007 (8)
4. INSTALL 6" THICK OF CMB ON THE ACCESS ROAD IN ACCORDANCE WITH 1007 (9)
5. RESURFACE ALL AC ACCESS ROADS IN ACCORDANCE WITH 1008 (10)



LEGEND

	2" THICK CMB ACCESS ROAD RESURFACING
	6" THICK CMB ACCESS RAMP
	AC ACCESS ROAD



AERIAL PHOTOGRAPH PLAN

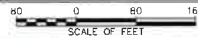

11			
10			
9			
8			
7			
6			
5			
4			
3			
2			
1			

REVISION	DESCRIPTION	DATE

R. PLINDO / J. VALDEZ	10/22/2025
BY/ONS	5/8
JV / AR	11/02/2025
SEAL	
S. DIAZ-RUBIN	11/24/2025
SEAL	

**COUNTY OF VENTURA
PUBLIC WORKS AGENCY
WATERSHED PROTECTION**

PROJECT NO.	WP26-14
SCALE	
PROJECT NO.	P60F3906

**ADAMS BARRANCA DEBRIS BASIN
SEDIMENT CLEANOUT**
AERIAL PHOTOGRAPH PLAN

SHEET	2
OF	2
DRAWING NO.	WPD-2-395

NOTES:

1. TEMPORARY WORK AREA LIMITS SHALL BE STAKED AND ALL EQUIPMENT SHALL BE OPERATED WITHIN THE TEMPORARY WORK AREA LIMITS.
2. EXISTING IMPROVEMENTS WITHIN THE RIGHT OF WAY AND WORK AREA'S SHALL REMAIN AND SHALL BE PROTECTED UNLESS OTHERWISE NOTICED. DAMAGED IMPROVEMENTS SHALL BE REPLACED IN KIND TO A CONDITION EQUAL OR BETTER THAN THAT WHICH EXISTED PRIOR TO CONSTRUCTION AT CONTRACTOR'S OWN EXPENSE, AND TO THE SATISFACTION OF THE ENGINEER. EXTRA SPECIAL CARE SHALL BE TAKEN TO PROTECT ALL RC STRUCTURES WHILE EXCAVATING AROUND THEM.
3. FISHING RC HARDENED SPILLWAY, RC BOX CULVERTS, AND RC TRANSITION STRUCTURES SHALL BE IN PLACE PER NOT. 2, HEREON.
4. CLEAR, GRUB, REMOVE, AND DISPOSE OF ALL EXISTING VEGETATION WITHIN THE SEGMENT REMOVAL LIMITS AND ALL ACCESS ROADS AND RAMPS INCLUDING BUT NOT LIMITED TO TREES, SHRUBS AND BRUSH.
5. REMOVE AND DISPOSE OF ALL SEDIMENT WITHIN THE EXCAVATION LIMITS AS SHOWN ON SHEETS 1, 4, 5, 6, 7, 8 AND 9.
6. RESURFACE ALL CMB ACCESS ROADS IN ACCORDANCE WITH 1007.
7. INSTALL 6" THICK OF CMB ON THE ACCESS ROAD IN ACCORDANCE WITH 1007.
8. RESURFACE ALL AC ACCESS ROADS IN ACCORDANCE WITH 1008.
9. THE CONTRACTOR SHALL EXERCISE EXTRA CAUTION WHILE REMOVING THE SEDIMENT AND DEBRIS IN ORDER TO AVOID ANY DAMAGE TO EXISTING FACILITIES. DAMAGED STRUCTURES SHALL BE REPAIRED IN ACCORDANCE WITH NOTE 2.
10. REMOVE, CLEAN, AND DISPOSE OF ALL SEDIMENT AND DEBRIS, INCLUDING BUT NOT LIMITED TO 10-TON, 10-T BRANCHES AND LOGS, AND FLASH INSUR AND AROUND THE LOW-FLOW RISER, CATWALK, REINFORCED CONCRETE (RC) EMERGENCY SPILLWAY CHANNEL, AND RC BOX.

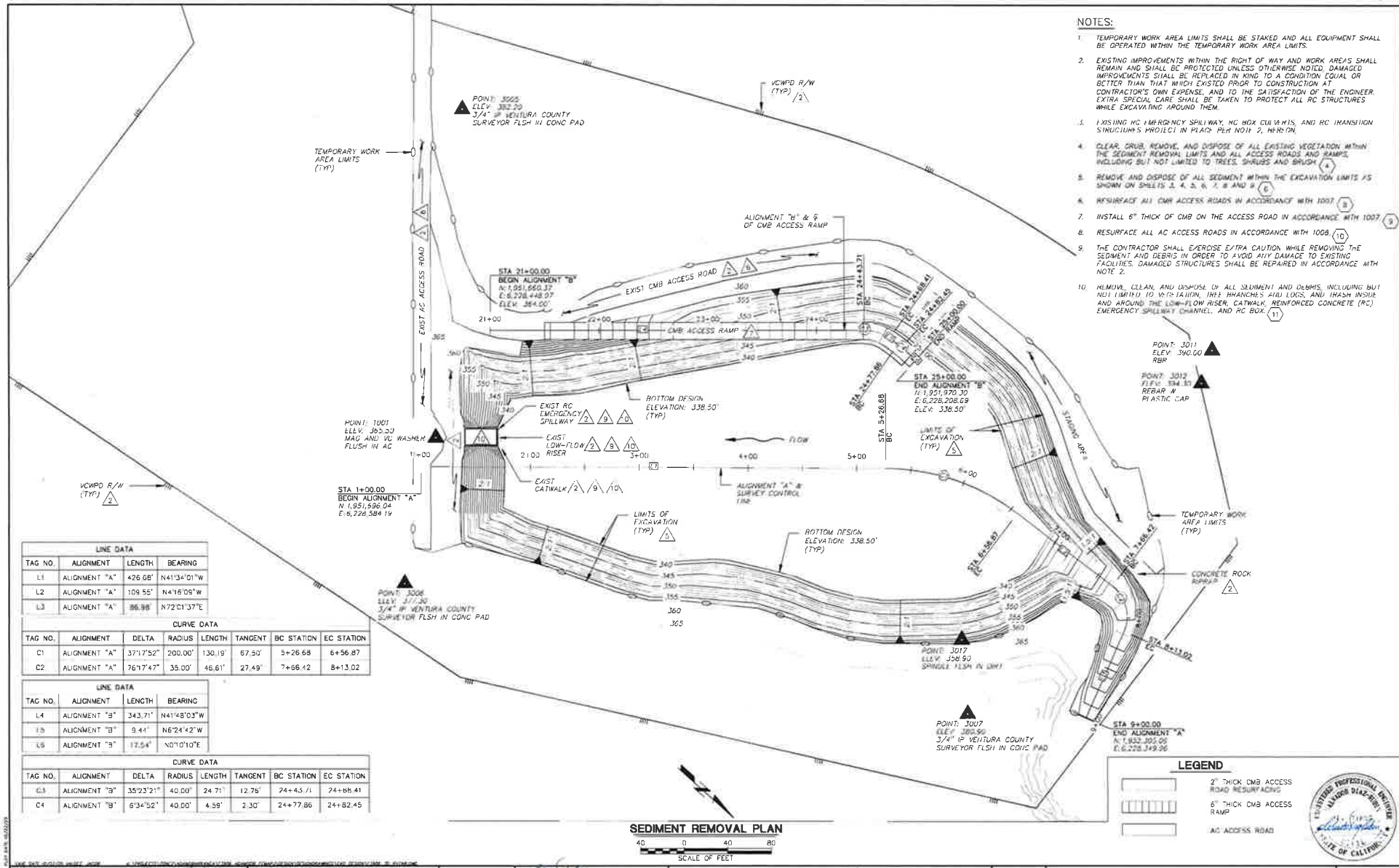

LINE DATA

TAG NO.	ALIGNMENT	LENGTH	BEARING
L1	ALIGNMENT "A"	426.08'	N41°34'01"W
L2	ALIGNMENT "A"	109.55'	N41°16'09"W
L3	ALIGNMENT "A"	86.88'	N72°01'37"E

CURVE DATA

TAG NO.	ALIGNMENT	DELTA	RADIUS	LENGTH	TANGENT	BC STATION	EC STATION
C1	ALIGNMENT "A"	37°17'52"	200.00'	130.19'	67.50'	5+26.68	6+56.87
C2	ALIGNMENT "A"	76°17'47"	35.00'	46.61'	27.49'	7+56.42	8+13.02

LINE DATA

TAG NO.	ALIGNMENT	LENGTH	BEARING
L4	ALIGNMENT "B"	343.71'	N41°48'03"W
L5	ALIGNMENT "B"	9.44'	N6°24'42"W
L6	ALIGNMENT "B"	17.54'	N01°10'10"E

CURVE DATA

TAG NO.	ALIGNMENT	DELTA	RADIUS	LENGTH	TANGENT	BC STATION	EC STATION
C3	ALIGNMENT "B"	35°22'21"	40.00'	24.71'	12.75'	24+43.11	24+68.41
C4	ALIGNMENT "B"	63°52'	40.00'	4.99'	2.30'	24+77.86	24+82.45

LEGEND

- 2" THICK CMB ACCESS ROAD RESURFACING
- 6" THICK CMB ACCESS RAMP
- AC ACCESS ROAD

SEDIMENT REMOVAL PLAN
SCALE OF FEET

REV.	DESCRIPTION	DATE

R. PUNO/J. VALDEZ
INSORER
J.V./AR
S. DIAZ-RUBIN
DATE: 10/22/2025
DATE: 11/20/2025
DATE: 11/21/2025

**COUNTY OF VENTURA
PUBLIC WORKS AGENCY
WATERSHED PROTECTION**

**ADAMS BARRANCA DEBRIS BASIN
SEDIMENT CLEANOUT**
SEDIMENT REMOVAL PLAN

PROJECT NO: WP26-14
SHEET NO: 3
DRAWING NO: WPD-2-365

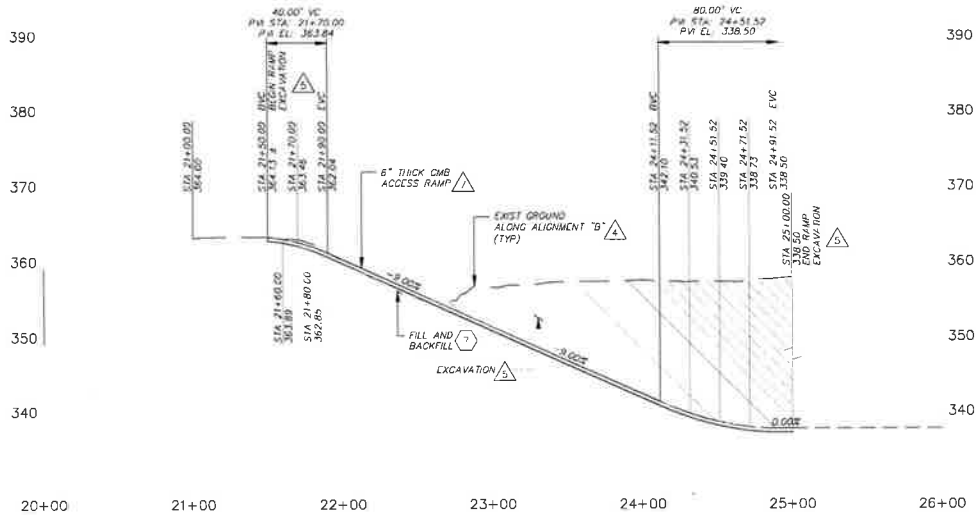

ACCESS RAMP PROFILE

SCALE: HORIZ: 1" = 40'
VERT: 1" = 8'

NOTES:

1. TEMPORARY WORK AREA LIMITS SHALL BE STAKED AND ALL EQUIPMENT SHALL BE OPERATED WITHIN THE TEMPORARY WORK AREA LIMITS.
2. EXISTING IMPROVEMENTS WITHIN THE RIGHT OF WAY AND WORK AREAS SHALL REMAIN AND SHALL BE PROTECTED UNLESS OTHERWISE NOTED. DAMAGED IMPROVEMENTS SHALL BE REPLACED IN KIND TO A CONDITION EQUAL OR BETTER THAN THAT WHICH EXISTED PRIOR TO CONSTRUCTION AT CONTRACTOR'S OWN EXPENSE, AND TO THE SATISFACTION OF THE ENGINEER. EXTRA SPECIAL CARE SHALL BE TAKEN TO PROTECT ALL RC STRUCTURES WHILE EXCAVATING AROUND THEM.
3. EXISTING RC EMERGENCY WALKWAY, RC BOX CULVERTS, AND RC TRANSITION STRUCTURES SHALL BE IN PLACE WITH NO. 7, REINFORC.
4. CLEAR, GRUB, REMOVE, AND DISPOSE OF ALL EXISTING VEGETATION WITHIN THE SEDIMENT REMOVAL LIMITS AND ALL ACCESS ROADS AND RAMP, INCLUDING BUT NOT LIMITED TO TREES, SHRUBS AND BRUSH. (4)
5. REMOVE AND DISPOSE OF ALL SEDIMENT WITHIN THE EXCAVATION LIMITS AS SHOWN ON SHEETS 3, 4, 5, 6, 7, 8 AND 9. (5)
6. RESURFACE ALL CMB ACCESS ROADS IN ACCORDANCE WITH 1007. (6)
7. INSTALL 6" THICK CMB ON THE ACCESS ROAD IN ACCORDANCE WITH 1007. (7)
8. RESURFACE ALL AC ACCESS ROADS IN ACCORDANCE WITH 1008. (8)
9. THE CONTRACTOR SHALL EXERCISE EXTRA CAUTION WHILE REMOVING THE SEDIMENT AND DEBRIS IN ORDER TO AVOID ANY DAMAGE TO EXISTING FACILITIES. (9)

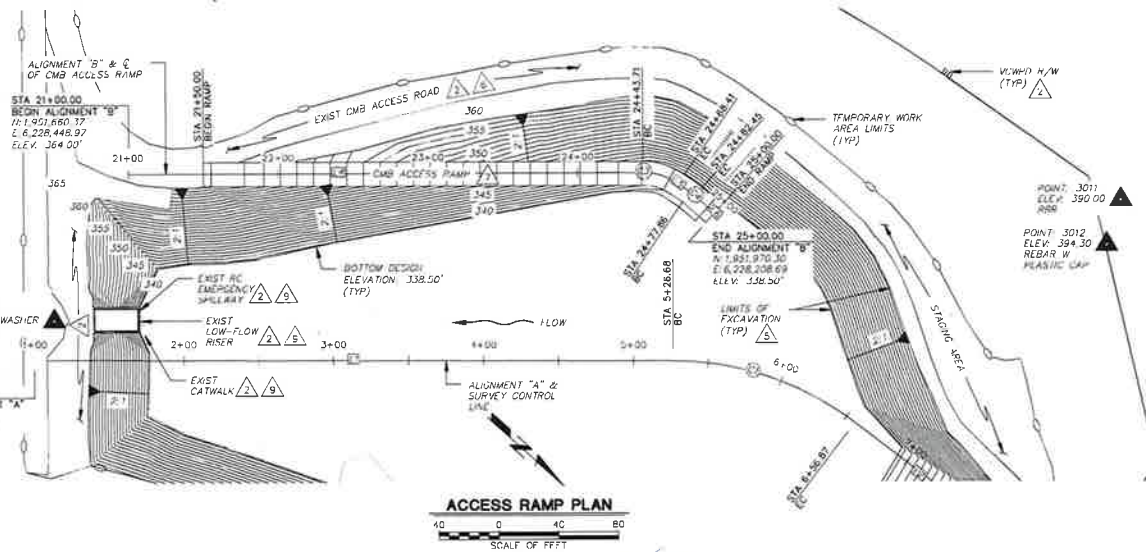

ACCESS RAMP PLAN

SCALE OF FEET
0 40 80

LINE DATA		
TAG NO.	ALIGNMENT	BEARING
L1	ALIGNMENT "A"	N41°34'01"W
L2	ALIGNMENT "A"	N41°15'09"W
L3	ALIGNMENT "A"	86°9'

CURVE DATA						
TAG NO.	ALIGNMENT	DELTA	RADIUS	LENGTH	TANGENT	BC STATION EC STATION
C1	ALIGNMENT "A"	37°17'52"	200.00'	130.19'	67.50'	5+25.68 6+56.87
C2	ALIGNMENT "A"	76°17'47"	35.00'	46.61'	27.49'	7+86.42 8+13.02

LINE DATA		
TAG NO.	ALIGNMENT	BEARING
L4	ALIGNMENT "B"	N41°48'03"W
L5	ALIGNMENT "B"	N6°24'42"W
L6	ALIGNMENT "B"	N07°01'07"E

CURVE DATA						
TAG NO.	ALIGNMENT	DELTA	RADIUS	LENGTH	TANGENT	BC STATION EC STATION
C3	ALIGNMENT "B"	35°23'21"	40.00'	24.71'	12.76'	24+4.3 / 1 24+68.41
C4	ALIGNMENT "B"	6°34'52"	40.00'	4.59'	2.30'	24+77.86 24+82.45



11 C B A A	REVISION REVISION REVISION REVISION	R. PUNO / J. VALDES IN CHARGE J.V. / A.R. DESIGNER S. CHAZ-RUBIN CHECKER		11/22/2025 DATE 11/20/2025 DATE	COUNTY OF VENTURA PUBLIC WORKS AGENCY WATERSHED PROTECTION	SHEET NO. WP26-14	ADAMS BARRANCA DEBRIS BASIN SEDIMENT CLEANOUT ACCESS RAMP PLAN AND PROFILE	SHEET 4 OF 9
						PROJECT NO. =60F3906		DRAWING NO. WP26-2-285