



ORANGE COUNTY
CLERK-RECORDER
CEQA FILING COVER SHEET

202685000420

FILED

April 16, 2026
HUGH NGUYEN
CLERK - RECORDER

By [Signature]
Deputy clerk

30-04/16/2026-0295

THIS SPACE FOR CLERK'S USE ONLY

Complete and attach this form to each CEQA Notice filed with the County Clerk-Recorder

TYPE OR PRINT CLEARLY

Project Title

ASPHALT OVERLAY FOR DALE STREET, MAGNOLIA STREET AND RUSTIC LANE, AND AMERICANS WITH DISABILITIES ACT (ADA) CURB RAMP IMPROVEMENTS PROJECT

Check Document being Filed:

- Environmental Impact Report (EIR)
- Mitigated Negative Declaration (MND) or Negative Declaration (ND)
- Notice of Exemption (NOE)
- Other (Please fill in type):

**FILED IN THE OFFICE OF THE ORANGE
COUNTY CLERK-RECORDER ON 04/16/2026**
Posted 04/16/2026 Removed _____
Returned to agency on _____
DEPUTY 464

Filing fees are due at the time a Notice of Determination/Exemption is filed with our office. For more information on filing fees and No Effect Determinations, please refer to California Code of Regulations, Title 14, section 753.5.

CEQA NOTICE OF EXEMPTION

To: County Clerk, County of Orange

From: County of Orange
OC Public Works, Development Services/Planning

Public Project Number (PP): PP-26-0059

Project Title: Asphalt Overlay for Dale Street, Magnolia Street and Rustic Lane, and Americans with Disabilities Act (ADA) Curb Ramp Improvements Project

Project Location(s): Various Streets in Garden Grove and Mac Islands, Unincorporated Area, Orange County, CA

Project Description: The proposed project consists of asphalt overlay and ADA Curb Ramp Improvements (Project) on various streets (Dale Street, Magnolia Street, and Rustic Lane) in the Garden Grove Island and Mac Island unincorporated areas of the County of Orange. The proposed Project scope of work includes roadway concrete repairs, asphalt concrete replacement, removal of existing striping, slurry seal, restriping traffic lines and pavement markings, and removing and replacing cement concrete and asphalt concrete on curb ramps to upgrade the curbs to meet the current ADA standards for access requirements. In addition, the proposed Project will perform as-needed utility adjustments and implement Best Management Practices to control pollutant discharges from construction. The project anticipates approximately 203 truck trips, and implementation of traffic control measures for the project area with temporary detours or lane closures as required. The proposed Project will take 20 working days for construction commencing in Summer of 2026.

Name of Public Agency Approving Project: OCPW/OC Construction

Name of County Agency Carrying-Out Project: OCPW/OC Construction

Address of County Agency: 601 North Ross Street, Santa Ana, CA 92701

Exempt Status:

- Ministerial (Guidelines Section No. 15268)
- Emergency Project (Guidelines Section No. 15269)
- Common Sense (Guidelines Section No. 15061(b)(3))
- Statutory Exemption: State Code number:
- Categorical Exemption: Section: 15301 – Class 1 – Existing Facilities
15302 – Class 2 – Replacement and Reconstruction
- Other Exemption:

FILED

APR 16 2026

HUGH NGUYEN, CLERK-RECORDER

BY:  DEPUTY

Reason(s) why project is exempt: The exemptions provide for maintenance and repair of existing public facilities (streets and ramps) involving no expansion of existing use, and replacement or reconstruction of existing facilities (streets and ramps) where the new facilities (streets and ramps) will be located on the same site as the facilities (streets and ramps) replaced and will have substantially the same purpose and capacity as the facilities (streets and ramps) replaced.

Date of Decision: 4/16/26

CEQA Contact Person: Virginia Gomez, Senior Planner Phone: 714-667-1614

Project Manager Signature: 

Name: Stephen R. Clayton

Title: Project Manager



 County Administration South
601 North Ross Street
Santa Ana, California 92701

 P.O. Box 4048
Santa Ana, CA 92702-4048

 info@ocpw.ocgov.com

 (714) 667-8800

 OCPublicWorks.com

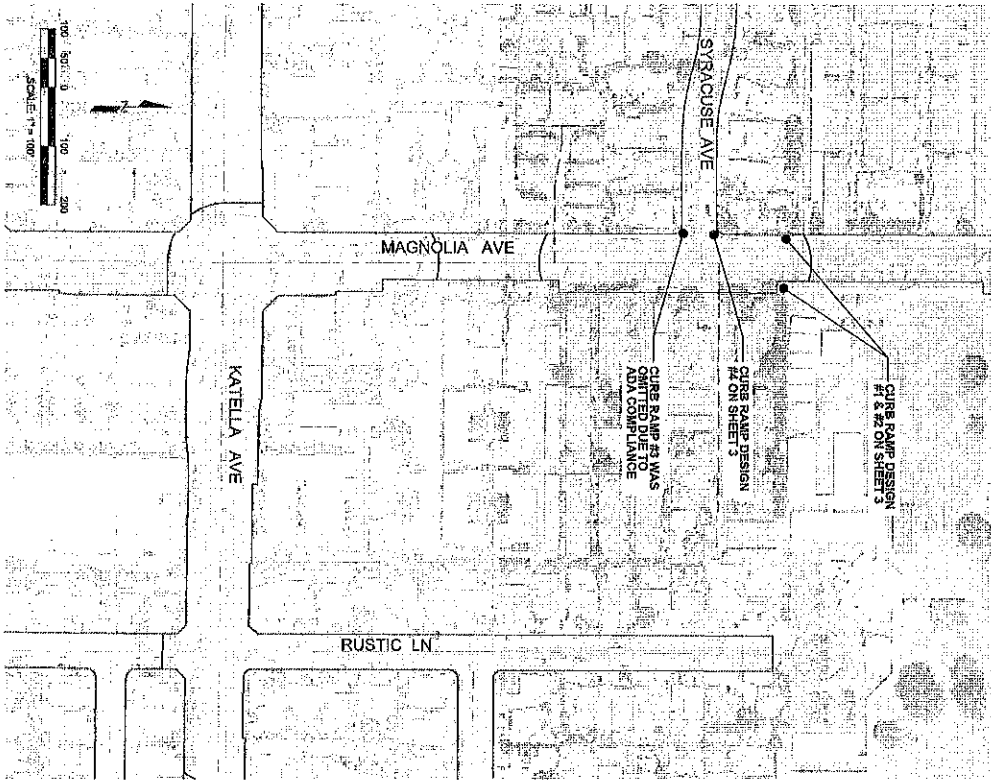

VICINITY MAP

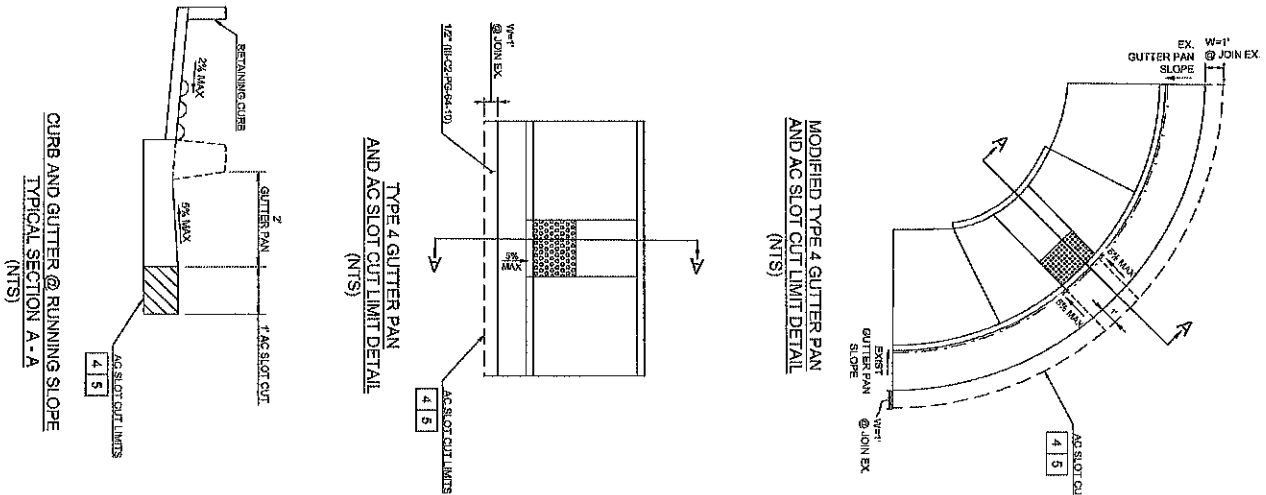

CURB AND GUTTER @ RUNNING SLOPE
TYPICAL SECTION A-A
(NTS)

MODIFIED TYPE 4 GUTTER PAN
AND AC SLOT CUT LIMIT DETAIL
(NTS)

TYPE 4 GUTTER PAN
AND AC SLOT CUT LIMIT DETAIL
(NTS)

ABBREVIATIONS & LEGEND

- A.C. = ASPHALT CONCRETE
- EX. = EXISTING
- TC = TOP OF CURB
- FS = FINISH SURFACE
- FL = FLOWLINE
- BOR = BEGINNING OF CURB RETURN
- ECR = END OF CURB RETURN
- CF = CURB FACE
- RET = RETAINING
- 12.24' TO = EXISTING ELEVATION
- 12.24' TO = PROPOSED ELEVATION
- ADA = AMERICANS WITH DISABILITIES ACT
- NTS = NOT TO SCALE
- PCC = PORTLAND CEMENT CONCRETE
- R/W = RIGHT-OF-WAY

GENERAL NOTES:

1. LANDING AREAS FOR ALL TYPE 4 RAMPS SHALL NOT EXCEED 24" IN ANY DIRECTION.
2. LANDING AREAS FOR ALL TYPE 4 RAMPS SHALL BE A MINIMUM OF 4' X 4'.
3. REMOVE & RECONSTRUCT PCC RAMPS PER CURB RAMP DETAIL HEREON & DETAIL AND TYPICAL SECTION ON SHEET 3 & 2. OCPW STD PLAN NO. 1118 TYPE 4.
4. REMOVE & RECONSTRUCT PCC SIDEWALK PER OCPW STD PLAN NO. 1026.
5. PROTECT IN PLACE.
6. SAW CUT AND JOIN EXISTING.
7. REMOVE & CONSTRUCT FULL DEPTH AC SLOT CUT PATCH WITH (IRC-P99-10).

CONSTRUCTION NOTES:

1. REMOVE & RECONSTRUCT PCC RAMPS PER CURB RAMP DETAIL HEREON & DETAIL AND TYPICAL SECTION ON SHEET 3 & 2. OCPW STD PLAN NO. 1118 TYPE 4.
2. REMOVE & RECONSTRUCT PCC SIDEWALK PER OCPW STD PLAN NO. 1026.
3. PROTECT IN PLACE.
4. SAW CUT AND JOIN EXISTING.
5. REMOVE & CONSTRUCT FULL DEPTH AC SLOT CUT PATCH WITH (IRC-P99-10).

FILED

APR 16 2026

HUGH NGUYEN, CLERK-RECORDER

BY:  DEPUTY

<p>2</p> <p>OF 3</p>	<p>SHEET TITLE: INDEX MAP, TYPICAL SECTION AND DETAILS</p> <p>PROJECT: MAC ISLANDS SERVICE AREA FY 2025-26 ADA (AMERICANS WITH DISABILITIES ACT) UPGRADES - MAC ISLANDS</p> <p>PROJ. NO.: EC20250360</p>	<p>DESIGNED BY: AM</p> <p>DRAWN BY: AM & L.O.</p> <p>CHECKED BY: NG</p> <p>DATE: 03-08-2025</p> <p>SCALE: AS SHOWN</p>	<p>PROFESSIONAL SEAL:</p> <p>County of Orange Public Works</p> <p>PREPARED BY: OC CONSTRUCTION PAVEMENT MAINTENANCE ENGINEERING</p>	<table border="1" style="width: 100%; border-collapse: collapse;"> <thead> <tr> <th>NO.</th> <th>DESCRIPTION</th> <th>SHT.</th> <th>APPROVED</th> <th>DATE</th> </tr> </thead> <tbody> <tr><td> </td><td> </td><td> </td><td> </td><td> </td></tr> <tr><td> </td><td> </td><td> </td><td> </td><td> </td></tr> <tr><td> </td><td> </td><td> </td><td> </td><td> </td></tr> <tr><td> </td><td> </td><td> </td><td> </td><td> </td></tr> </tbody> </table>	NO.	DESCRIPTION	SHT.	APPROVED	DATE																				
NO.	DESCRIPTION	SHT.	APPROVED	DATE																									



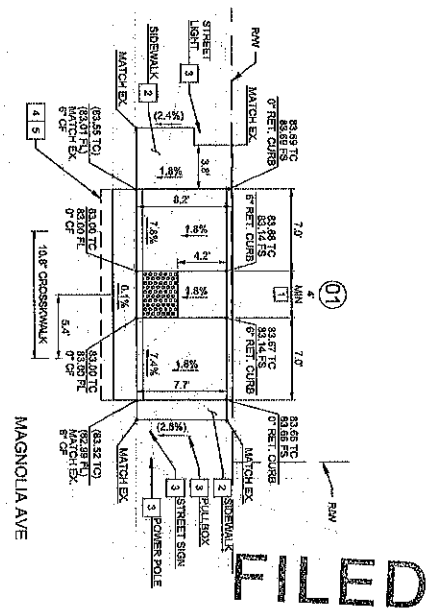

CURB RAMP NO. 01 DETAIL (TYPE 4 RAMP)

FILED
 APR 16 2026
 HIGH NGUYEN, CLERK RECORDER
 DEPUTY

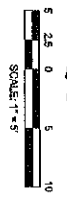
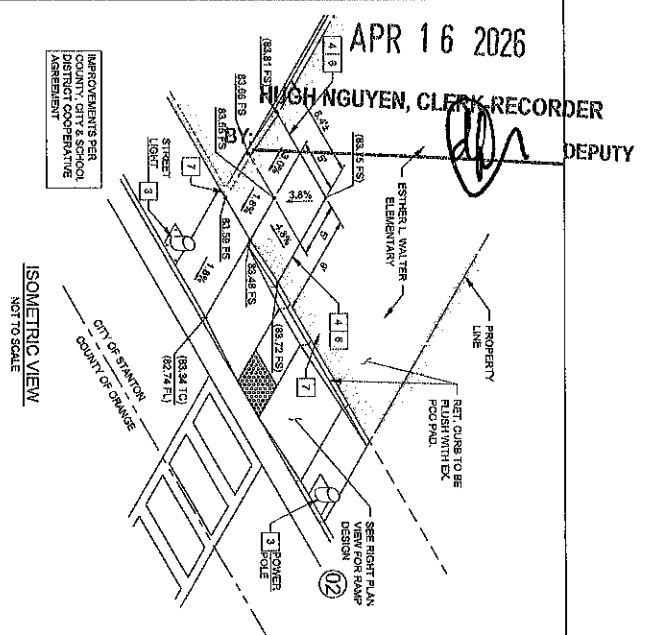

CURB RAMP NO. 02 DETAIL & ISOMETRIC VIEW (TYPE 4 RAMP)

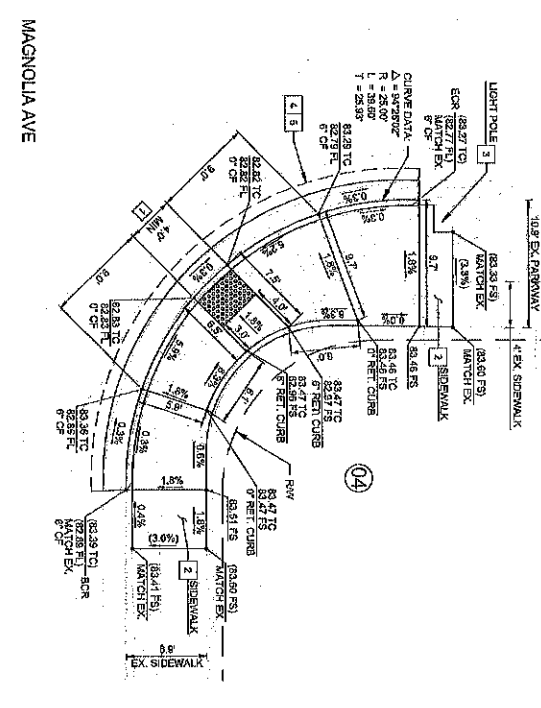
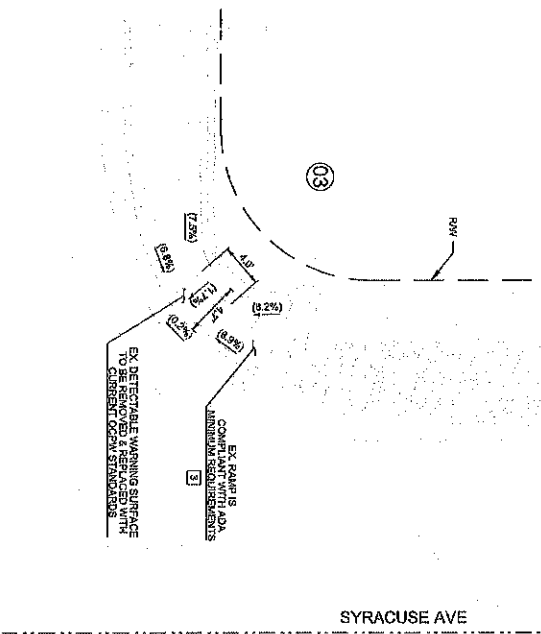

CURB RAMP NO. 03 DETAIL (OMITTED) & NO. 04 DETAIL (MODIFIED TYPE 4 RAMP)

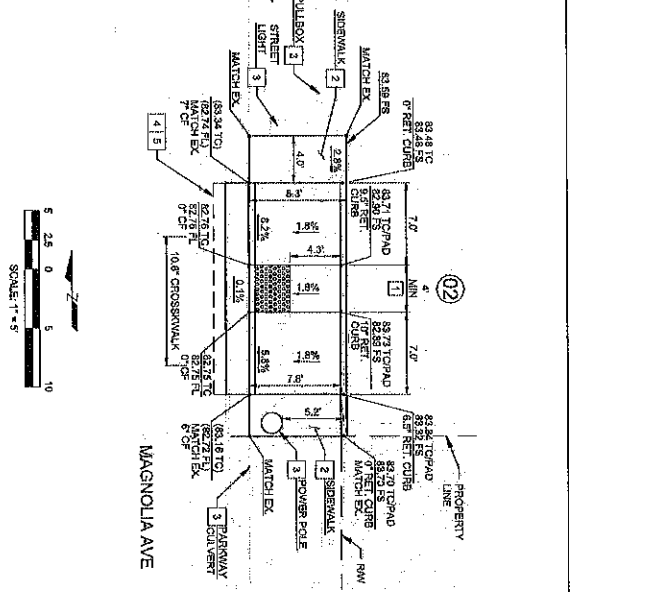

CONSTRUCTION NOTES:

- REMOVE & RECONSTRUCT POC RAMP PER CURB RAMP DETAIL HEREIN & DETAIL AND TYPICAL SECTION ON SHEET 3 & COPY STD PLAN NO. 1115 TYPE 4.
- REMOVE & RECONSTRUCT POC SIDEWALK PER COPY STD PLAN NO. 1205.
- PROTECT IN PLACE.
- SAVE CUT AND JOIN EXISTING.
- REMOVE & RECONSTRUCT FULL DEPTH AC SLOT CUT PATCH WITH (1)C&PG&H.
- REMOVE & RECONSTRUCT FULL DEPTH POC PER ISOMETRIC VIEW SLOPE RATES AND ELEVATIONS.
- REMOVE & REPLACE PORTION OF THE CHAIN LINK FENCE TO ACCOMMODATE DRIVE AND CONSTRUCTION.

GENERAL NOTES:

- LANDING AREAS FOR ALL TYPE 4 RAMP SHALL NOT EXCEED 2% IN ANY DIRECTION.
- LANDING AREAS FOR ALL TYPE 4 RAMP SHALL BE A MINIMUM OF 6' X 6'.

ABBREVIATIONS & LEGEND

- AC = ASPHALT CONCRETE
- EX = EXISTING
- ADA = AMERICANS WITH DISABILITIES ACT
- N/S = NOT TO SCALE
- FC = FINISH SURFACE
- FL = FLOWLINE
- BCR = BEGINNING OF CURB RETURN
- BCR = END OF CURB RETURN
- RT = RETAINING
- 12.34 TO = EXISTING ELEVATION
- 12.34 TO = PROPOSED ELEVATION

<p>3</p> <p>OF 3</p>	<p>DATE TITLE</p> <p>ADA RAMP DESIGN</p> <p>PROJECT: MAC ISLANDS SERVICE AREA FY 2025-26 ADA (AMERICANS WITH DISABILITIES ACT) UPGRADES - MAC ISLANDS</p> <p>PROJ. NO.: EQ2020350</p>	<p>DESIGNED BY:</p> <p>AM</p> <p>CHECKED BY:</p> <p>AM/JC</p> <p>DATE:</p> <p>12/10/2024</p>	<p>County of Orange Public Works</p> <p>PREPARED BY: OC CONSTRUCTION PAVEMENT MAINTENANCE ENGINEERING</p>	<p>NO. DESCRIPTION</p> <p>SHT. APPROVED</p> <p>DATE</p>	<p>SEAL</p> <p>REGISTERED PROFESSIONAL ENGINEER</p>
----------------------	---	--	--	---	---

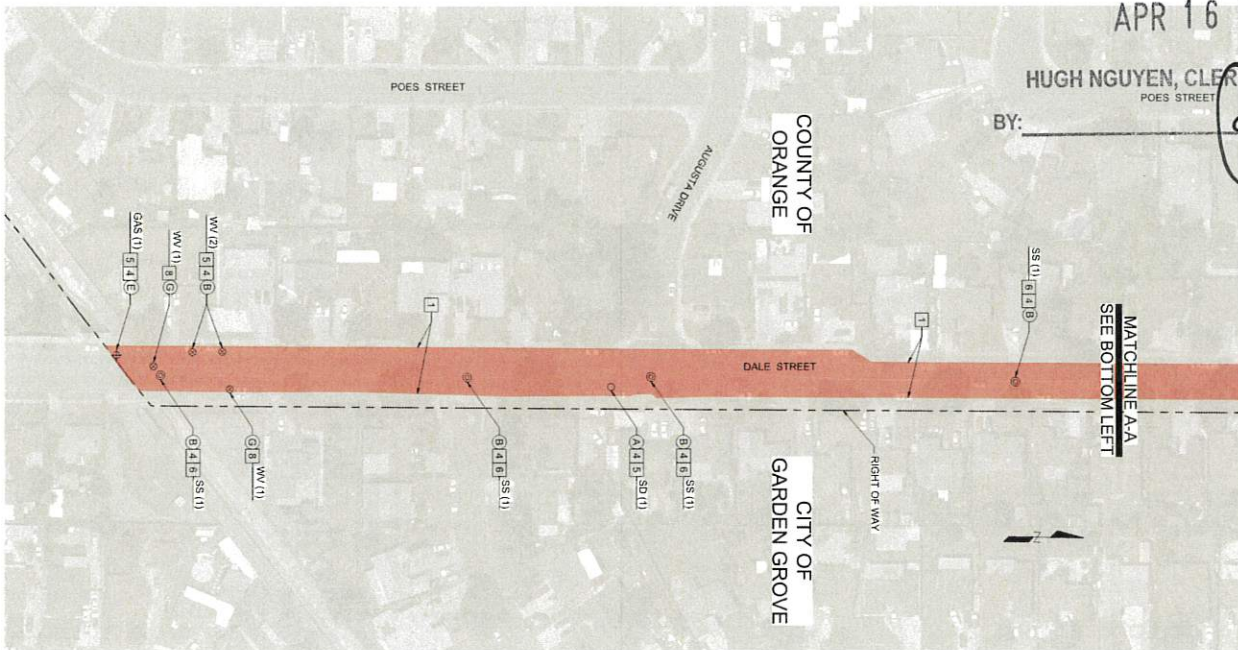

FILED

APR 16 2026

HUGH NGUYEN, CLERK RECORDER

BY: _____ DEPUTY

[Handwritten Signature]

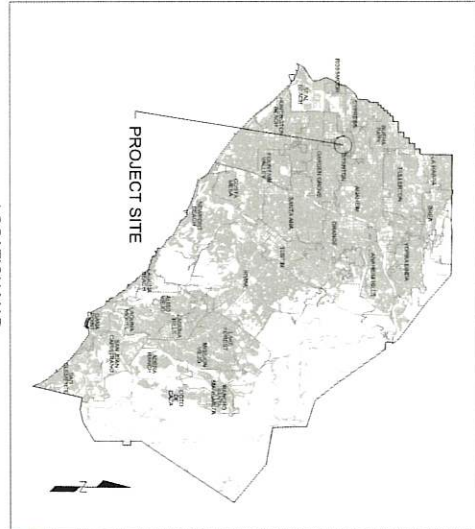

CONSTRUCTION NOTES

- 1 AC COLD MILL & OVERLAY PER DETAIL A ON SHEET 3
- 2 AC COLD MILL & OVERLAY PER DETAIL B ON SHEET 3
- 3 AC COLD MILL & OVERLAY PER DETAIL C ON SHEET 3
- 4 LOWER PAVEMENT TO COLD MILLING BY COUNTY CONTRACTOR
- 5 ADJUST TO GRADE AFTER PAVING BY COUNTY CONTRACTOR
- 6 ADJUST TO GRADE AFTER PAVING BY OTHERS (UTILITY OWNERS)
- 7 REPLACE TRAFFIC LOOPS AFTER PAVING
- 8 PROJECT IN PLACE

UTILITY OWNER

- A COUNTY OF ORANGE
- B CITY OF GARDEN GROVE
- C CITY OF STANTON
- D ORANGE COUNTY SANITATION DISTRICT
- E SO CAL GAS
- F GOLDEN STATE WATER COMPANY
- G UNKNOWN

LEGEND

- ⊙ MANHOLE / CLEANOUT
- ⊕ VALVE
- ⊕ GAS VALVE
- ⊙ TRAFFIC LOOPS
- ⊙ STORM DRAIN
- COUNTY / CITY RIGHT-OF-WAY = _____
- WV = WATER VALVE
- SS = SANITARY SEWER
- SD = STORM DRAIN
- GAS = SO CAL GAS
- TL = TRAFFIC LOOPS



County of Orange
Public Works

OC CONSTRUCTION
PAVEMENT
MAINTENANCE
ENGINEERING

PROJECT
ASPHALT OVERLAY - DALE STREET
GARDEN GROVE ISLAND SERVICE AREA
FY 2025-2026

DATE 3/13/2026 SHEET 1 OF 3

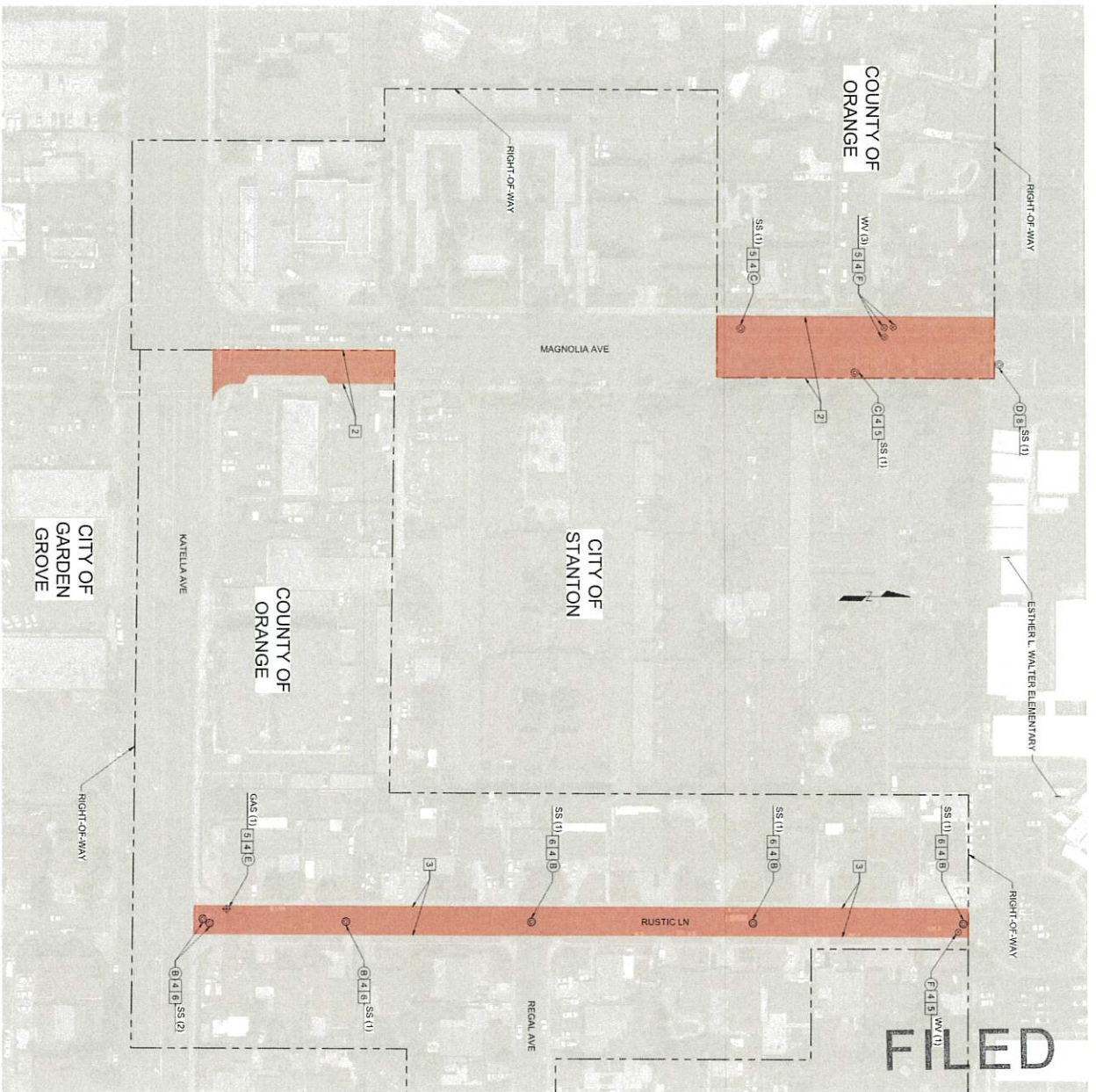

FILED

APR 16 2026

HUGH NGUYEN, CLERK-RECORDER

BY: *[Signature]* DEPUTY

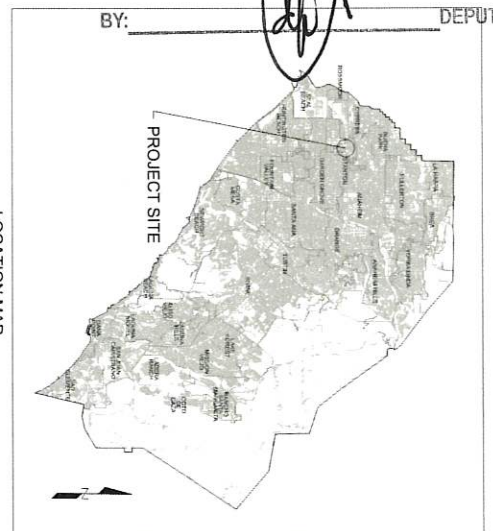

LOCATION MAP

CONSTRUCTION NOTES

- 1 AC COLD MILL & OVERLAY PER DETAIL A ON SHEET 3
- 2 AC COLD MILL & OVERLAY PER DETAIL B ON SHEET 3
- 3 AC COLD MILL & OVERLAY PER DETAIL C ON SHEET 3
- 4 LOWER PAVEMENT TO COLD MILLING BY COUNTY CONTRACTOR
- 5 ADJUST TO GRADE AFTER PAVING BY COUNTY CONTRACTOR
- 6 ADJUST TO GRADE AFTER PAVING BY OTHERS (UTILITY OWNERS)
- 7 REPLACE TRAFFIC LOOPS AFTER PAVING
- 8 PROTECT IN PLACE

UTILITY OWNER

- (A) COUNTY OF ORANGE
- (B) CITY OF GARDEN GROVE
- (C) CITY OF STANTON
- (D) ORANGE COUNTY SANITATION DISTRICT
- (E) SO CAL GAS
- (F) GOLDEN STATE WATER COMPANY
- (G) UNKNOWN

LEGEND

- ⊗ MANHOLE / CLEANOUT
- ⊕ VALVE
- ⊕ GAS VALVE
- ⊙ TRAFFIC LOOPS
- ⊙ STORM DRAIN
- COUNTY / CITY RIGHT-OF-WAY
- WV = WATER VALVE
- SS = SANITARY SEWER
- SD = STORM DRAIN
- GAS = SO CAL GAS
- TL = TRAFFIC LOOPS



County of Orange
Public Works

OC CONSTRUCTION
PAVEMENT
MAINTENANCE
ENGINEERING

PROJECT: **ASPHALT OVERLAY - MAGNOLIA & RUSTIC STREET
MAC ISLANDS SERVICE AREA
FY 2025-2026**

DATE DIVISION: SHEET 7 OF 3

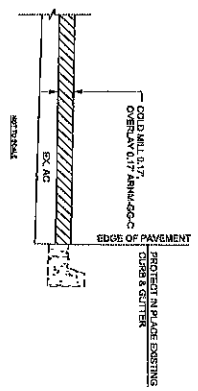

1. COLD MILL ENTIRE STREET 0.17'. COLD MILL SHALL EXTEND TO THE EDGE OF EXISTING PAVEMENT, PCC GUTTER, DRIVEWAY & CURB & GUTTER.
2. OVERLAY 0.17' WITH (ARMA-GG-C) OR AS DETERMINED BY ENGINEER.

1 COLD MILL & OVERLAY CROSS SECTION DETAIL FOR DALE STREET NTS

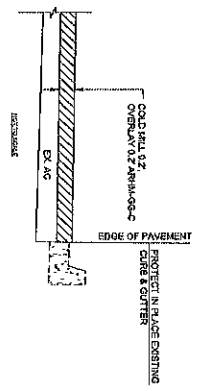

1. COLD MILL ENTIRE STREET 0.2'. COLD MILL SHALL EXTEND TO THE EDGE OF EXISTING PAVEMENT, PCC GUTTER, DRIVEWAY & CURB & GUTTER.
2. OVERLAY 0.2' WITH (ARMA-GG-C) OR AS DETERMINED BY ENGINEER.

2 COLD MILL & OVERLAY CROSS SECTION DETAIL FOR MAGNOLIA AVENUE NTS

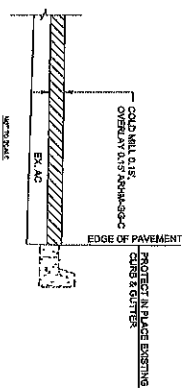

1. COLD MILL ENTIRE STREET 0.15'. COLD MILL SHALL EXTEND TO THE EDGE OF EXISTING PAVEMENT, PCC GUTTER, DRIVEWAY & CURB & GUTTER.
2. OVERLAY 0.15' WITH (ARMA-GG-C) OR AS DETERMINED BY ENGINEER.

3 COLD MILL & OVERLAY CROSS SECTION DETAIL FOR RUSTIC LANE NTS

FILED

APR 16 2026

HUGH NGUYEN, CLERK-RECORDER

BY:  DEPUTY

CONSTRUCTION NOTES

1. AC COLD MILL & OVERLAY PER DETAIL A ON SHEET 3.
2. AC COLD MILL & OVERLAY PER DETAIL B ON SHEET 3.
3. AC COLD MILL & OVERLAY PER DETAIL C ON SHEET 3.
4. LOWER PAVEMENT TO COLD MILLING BY COUNTY CONTRACTOR.
5. ADJUST TO GRADE AFTER PAVING BY COUNTY CONTRACTOR.
6. ADJUST TO GRADE AFTER PAVING BY OTHERS (UTILITY OWNERS).
7. REPLACE TRAFFIC LOOPS AFTER PAVING.
8. PROTECT IN PLACE.

LEGEND

- ⊙ MANHOLE / CLEANOUT
 - ⊙ VALVE
 - ⊙ GAS VALVE
 - ⊙ TRAFFIC LOOPS
 - STORM DRAIN
 - COUNTY / CITY RIGHT-OF-WAY = _____
- WV = WATER VALVE
 SS = SANITARY SEWER
 SD = STORM DRAIN
 GAS = SO. CAL. GAS
 TL = TRAFFIC LOOPS

UTILITY OWNER

- Ⓐ COUNTY OF ORANGE
- Ⓑ SO. CAL. GAS
- Ⓒ CITY OF GARDEN GROVE
- Ⓓ GOLDEN STATE WATER COMPANY
- Ⓔ CITY OF STANTON
- Ⓕ UNKNOWN
- Ⓖ ORANGE COUNTY SANITATION DISTRICT

GENERAL NOTES:

1. UTILITY LOCATIONS SHOWN ARE APPROXIMATE.
2. UNLESS OTHERWISE INDICATED ON PLANS SURFACE FACILITIES SHALL BE PROTECTED IN PLACE.
3. TRAFFIC LOOPS ARE SHOWN FOR INFORMATION ONLY. ALL TRAFFIC LOOPS IMPACTED DURING COLD MILLING SHALL BE REPLACED.

PAVING NOTES:

1. WHEN DOING THE PAVING, THE SURFACE SHALL BE SMOOTH UP TO THE DEPTH THAT ALLOWS FOR AN EVEN OVERLAY.
2. THE MILLED SURFACE SHALL BE SMOOTH, OR HAVE SMOOTH UNDOULATING GROOVES, OR GROOVES/VERTICAL SPINDLES NO GREATER THAN 1/4".
3. THE MILLER SPACE SHALL BE REASONABLY FREE OF DIRT, VEGETATION, AND OTHER LOOSE DEBRIS.
4. PAVING LIMITS WILL BE MARKED IN FIELD BY INSPECTOR.

PROJECT CONTACTS

UTILITY OWNER	CONTACT	PHONE NO.
CITY OF GARDEN GROVE	JOHN SUZ	(714) 779-1288
CITY OF STANTON	MANNY PERLA	(957) 281-0518
GOLDEN STATE WATER	ANGEL MASTROLO	(857) 281-7465
ORANGE COUNTY SANITATION DISTRICT	MYRALE SHAMMA	(714) 892-7082
SO. CAL. GAS COMPANY	JERRY WARENE	213-231-1134
SOUTHERN CALIFORNIA Edison	EMERGENCY	(800) 662-4238
SCHOOL DISTRICT	CONTACT	PHONE NO.
MAGNOLIA SCHOOL DISTRICT	MATT BLUMER	(714) 367-4838

County of Orange
 Public Works
 OC CONSTRUCTION
 PAVEMENT
 MAINTENANCE
 ENGINEERING

PROJECT: ASPHALT OVERLAY - MAC ISLANDS & GARDEN GROVE ISLAND SERVICE AREA
 FY 2025-2028

PROJECT NO.: 2025-0111
 DATE: 03/28/2025
 SHEET 3 OF 3



State of California - Department of Fish and Wildlife
2026 ENVIRONMENTAL DOCUMENT FILING FEE CASH RECEIPT
 DFW 753.5a (REV. 01/01/26) Previously DFG 753.5a

Print **EX-111** **Save**

RECEIPT NUMBER:
 30-04/16/2026-0295
 STATE CLEARINGHOUSE NUMBER (if applicable)

SEE INSTRUCTIONS ON REVERSE. TYPE OR PRINT CLEARLY.

LEAD AGENCY OCPW/OC CONSTRUCTION	LEAD AGENCY EMAIL	DATE 04/16/2026
COUNTY/STATE AGENCY OF FILING ORANGE COUNTY	DOCUMENT NUMBER 202685000420	

PROJECT TITLE
 ASPHALT OVERLAY FOR DALE STREET, MAGNOLIA STREET AND RUSTIC LANE, AND AMERICANS WITH DISABILITIES ACT (ADA) CURB RAMP IMPROVEMENTS PROJECT

PROJECT APPLICANT NAME OCPW/OC CONSTRUCTION	PROJECT APPLICANT EMAIL	PHONE NUMBER (714) 667-1614
PROJECT APPLICANT ADDRESS 601 NORTH ROSS STREET	CITY SANTA ANA	STATE CA
		ZIP CODE 92701

PROJECT APPLICANT (Check appropriate box)

Local Public Agency
 School District
 Other Special District
 State Agency
 Private Entity

CHECK APPLICABLE FEES:

- Environmental Impact Report (EIR) \$ 4,227.50 \$ _____
- Mitigated/Negative Declaration (MND)(ND) \$ 3,043.75 \$ _____
- Certified Regulatory Program (CRP) document - payment due directly to CDFW \$ 1,437.25 \$ _____

- Exempt from fee
 - Notice of Exemption (attach)
 - CDFW No Effect Determination (attach)
- Fee previously paid (attach previously issued cash receipt copy)

- Water Right Application or Petition Fee (State Water Resources Control Board only) \$ 850.00 \$ _____
- County documentary handling fee \$ 50.00 \$ _____
- Other \$ _____

PAYMENT METHOD:

Cash Credit Check Other
 TOTAL RECEIVED \$ _____ 0.00

SIGNATURE X	AGENCY OF FILING PRINTED NAME AND TITLE Daniela Florido Deputy Clerk
--------------------	--