

**NOTICE OF EXEMPTION  
(CALIFORNIA ENVIRONMENTAL QUALITY ACT OF 1970- CEQA)**

TO WHOM IT MAY CONCERN:

1. The Board of Supervisors of the County of Kern has approved the following project in the County of Kern, State of California:
  - a. Applicant or sponsoring Agency or Department: Sagebrush C, LLC by Mark Turner (PP26120) ;
  - b. Name of Project: General Plan Amendment Case No. 19, Map 197;
  - c. Street Address/Cross-Street of Project: North side of Oak Creek Road, east of Tehachapi-Willow Springs Road and west of State Route 14, approximately six (6) miles west of the community of Mojave in unincorporated Kern County (APNs: 237-031-08 and 237-031-38)  
  
Map of Project (if no street address): Attached
  - d. Description of Project: Amendment to the Circulation Element of the Kern County General Plan to: (a) Remove east-west midsection line of Section 16, Township 11 North, Range 13 West, S.B.B.&M.; and (b) Remove north-south midsection line of Section 16, Township 11 North, Range 13 West, S.B.B.&M.
2. Approval – Summary of Proceedings:  
  
Adoption date March 24, 2026, Item No. CA 11 2:00 p.m.
3. The Board of Supervisors has determined that it can be seen with certainty that there is no possibility that the action taken may have a significant effect on the environment and that, under the provisions of Section 15061(b)(3) of the State CEQA Guidelines, the action is exempt from the requirements of CEQA and the State CEQA Guidelines concerning the evaluation of projects, further environmental review, and the preparation and review of environmental documents. Therefore, no environmental documents were required for consideration of the action taken.

Craig M. Murphy, Director  
Planning and Natural Resources Department  
County of Kern, State of California

  
\_\_\_\_\_

Contact: Andrea Calderon, Planner II, at (661) 862-5029 or by email at [CalderonA@kerncounty.com](mailto:CalderonA@kerncounty.com)

Common Sense Exemption 15061(b)(3)

AC:an

# GPA 19, Map 197

## Vicinity Map

Sagebrush C, LLC  
by Terra-Gen

-  Site
-  Named Road
-  State Hwy
-  Arterials
-  Township/Range
-  Sections
-  Unincorporated Cities

APN: 237-031-08, 237-031-38  
Sec. 16 - T11N/R13W  
Created on: 9/16/2025

0 6,250 12,500 ft

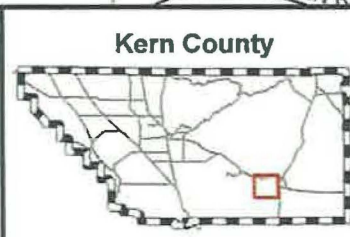
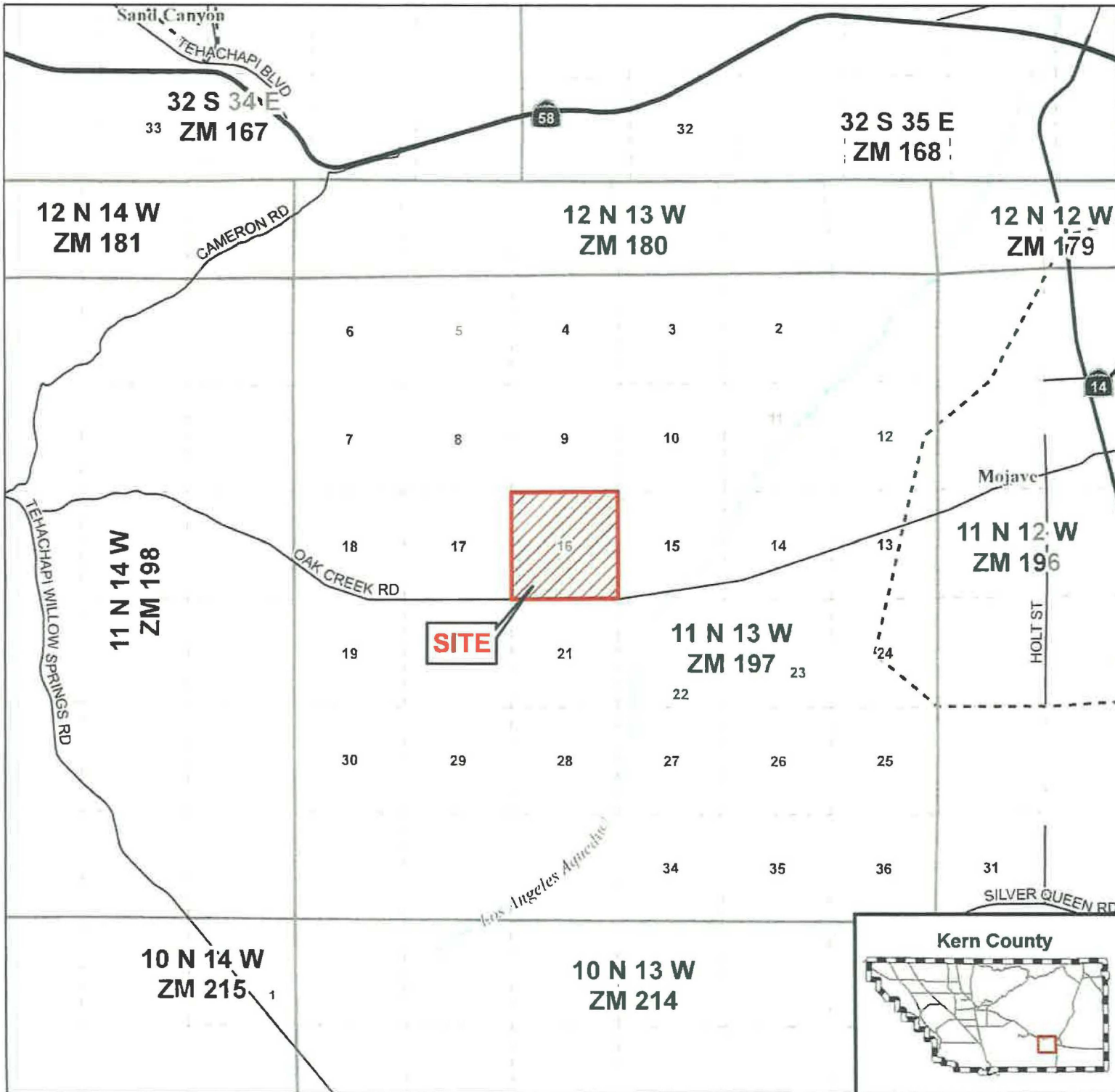

# GPA 19, Map 197

## Existing Zone Classifications

Sagebrush C, LLC  
by Terra-Gen

-  Site
-  Arterials
-  Locals
-  Dirt Roads
- KERN COUNTY ZONING DESIGNATIONS**
-  A - Exclusive Agriculture
-  A-1 - Limited Agriculture
-  FPP - Floodplain Primary
-  M-3 - Heavy Industrial
-  OS - Open Space
-  PL - Platted Lands
-  FP - Floodplain Combining
-  RS - Residential Suburban Combining
-  WE - Wind Energy Combining
-  WE - Wind Energy Combining

APN: 237-031-08, 237-031-38  
Sec. 16 - T11N/R13W  
Created on: 9/16/2025

0 2,750 5,500 ft



**Kern County**  
Planning & Natural  
Resources Department

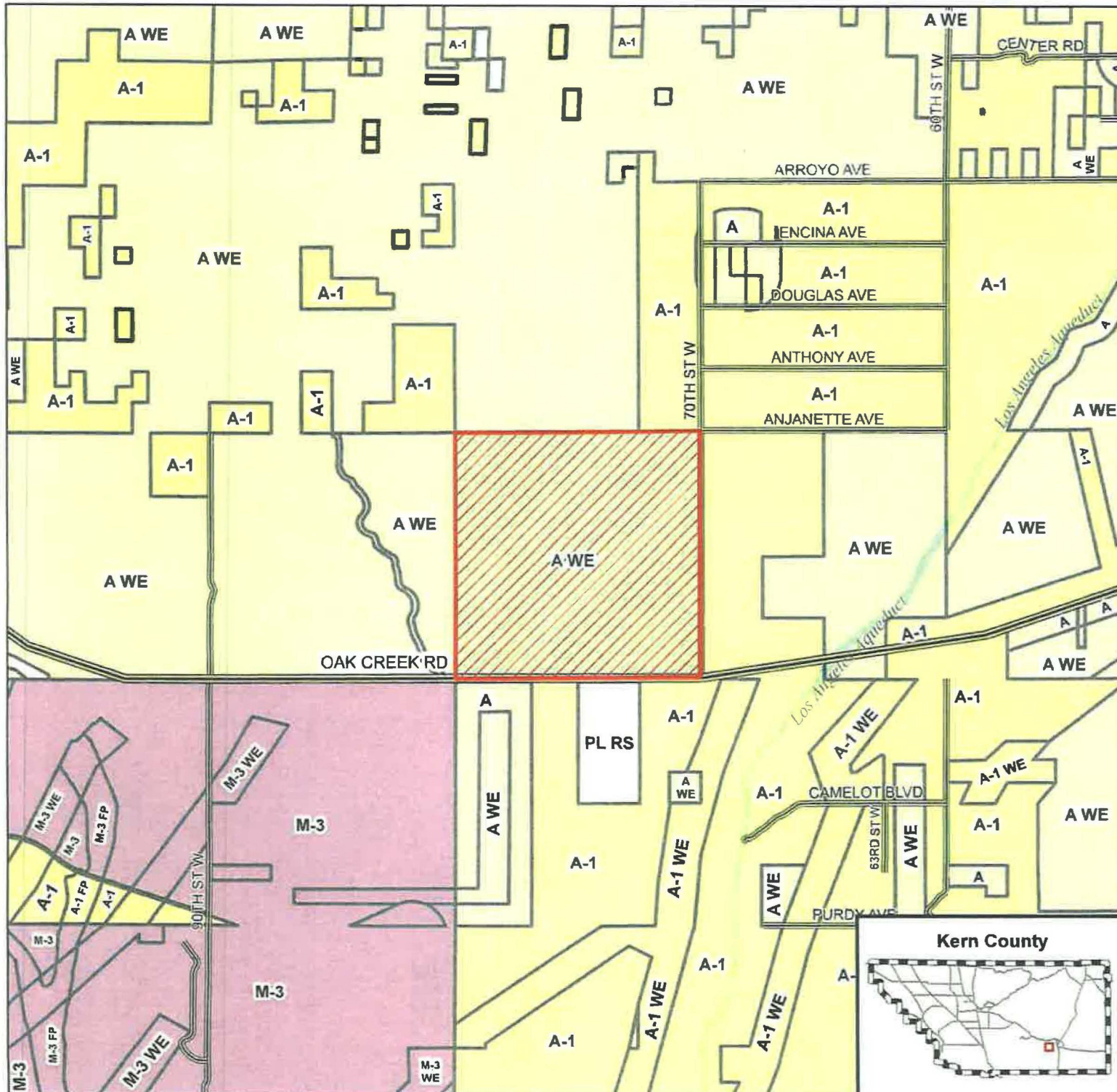



**Kern County Public Works  
Public Services BLDG**

2700 M Street  
Bakersfield, CA 93301  
Phone: 661-862-8648

Thursday Sep 04 2025 04:20:53 PM

**PLN25-00095**

477065 Notice to Process	125.00
477065 County Clerk CEQA Posti ng	50.00
477065 EH Land Development	595.00
477065 Legal Description Revie w	104.00
477065 Electronic Permit Maint enance Fee	350.00
477065 General/Specific Plan A mendment	1,409.00
477065 Fire Review and Consult ation	218.00
477065 Policy and Legal Confor mance Fee	192.00

---

**Total** **3,043.00**

Check 22677 3,043.00

Thank you for your payment.  
Have a great day!

Received From: MARK TURNER  
Receipt #: 1801BSA-20250904-18