

NOTICE OF EXEMPTION

Fee Exempt per Government Code Section 6103

To: Office of Land Use and Climate Innovation
1400 Tenth Street, Room 121
Sacramento, CA 95814

Tulare County Clerk
Room 105, Courthouse
221 South Mooney Blvd.
Visalia, CA 93291

Lead Agency: County of Tulare c/o Resource Management Agency
5961 S. Mooney Blvd.
Visalia, CA 93277(559) 624-7000
Attn: gmills@tularecounty.ca.gov and jwillis@tularecounty.ca.gov

Applicant(s): Tulare County Public Works
5961 South Mooney Blvd.
Visalia, CA 93277 (559) 624-7000

Project Title: Accepting Lot 62 of Tract No. 404 at the South End of Kramer Drive as a Public Right-of-Way

Project Location - Specific: Located at 57165 Kramer Drive, Springville, CA 93265 (APN: 223-140-009). The project site is located in the Unincorporated community of Ponderosa, beginning at the intersection of Avenue 336 and Road 204/Blair Road, within unincorporated Tulare County.

Project Location- Section, Township, Range: Section 16, Township 21S, Range 32E, MDBM

Project Location - City: Ponderosa, CA

Project Location - County: Tulare

Description of Nature, Purpose, and Beneficiaries of Project:

The proposed action is the acceptance of Lot 62 of Tract No. 404 as County public road right-of-way. The need for this action was identified following the conditional approval of Tentative Parcel Map No. PPM 24-046, which authorized division of a 76.77-acre parcel into four parcels and a remainder. The map relied in part on an apparent access point at the south end of Kramer Drive, originally dedicated by Tract No. 404, to serve Parcel 4 and the remainder.

Lot 62 is a one-foot reserve strip at the south end of Kramer Drive, conveyed to the County by grant deed recorded January 16, 1964, in Volume 2471, Page 365 of Official Records. Under the County ordinance in effect at the time, the strip was established to control access to adjoining properties for 21 years. That restriction period has expired. Acceptance of Lot 62 will formally establish access from Kramer Drive to the PPM 24-046 parcels. No improvements or construction are proposed or required. The project benefits the County and the subdivider by clarifying right-of-way limits and confirming legal access from a public road.

Exempt Status: (check one)

- Ministerial (Sec. 21080(b)(1); 15268);
- Declared Emergency (Sec. 21080(b)(3); 15269(a));
- Emergency Project (Sec. 21080(b)(4); 15269(b)(c));
- Common Sense Exemption: CEQA Guidelines 15061(b)(3)
- Categorical Exemption: CEQA Guidelines Class 2 Section 15302 Replacement or Reconstruction (c)
- Statutory Exemptions:

| |
|--|
| FILED TULARE COUNTY |
| MAR 25 2026 |
| ASSESSOR / CLERK-RECORDER BY: |
| DATE RECEIVED FOR FILING AT TULARE COUNTY CLERK'S OFFICE |

Reasons why project is exempt: The project is exempt, consistent with the California Environmental Quality Act of 1970 (CEQA) and the State CEQA Guidelines, pursuant to Title 14, Cal. Code Regulations Section 15061(b)(3), pertaining to the Common Sense Exemption. Section 15061(b)(3) is applicable and appropriate as the activity itself is only a change in title. This activity will not create significant traffic or vehicle miles traveled, nor will it create any significant effects regarding cumulative impacts, hazardous materials, cultural or biological resources. The project is an administrative acceptance of an existing one-foot reserve strip as public road right-of-way, with no physical change to the environment and no construction or improvements authorized. Therefore, the County as lead agency can say with certainty there is sufficient evidence, logically and by the mere nature of the activity, to conclude that there will not be a significant effect on the environment as defined under State CEQA Guidelines §15061(b)(3).

Environmental Assessment Officer: Reed Schenke, P.E., RMA Director/EAO

Name of Public Agency Approving Project: County of Tulare

Project Planner/Representative: Robert Abrahamian, County Surveyor **Telephone:** 559-624-7150

Signature:  Date: 3/24/2026 Title: Chief Planner
Gary A. Mills Environmental Planning Division

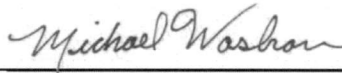
Signature:  Date: 3/24/2026 Title: Associate RMA Director, Designee
Michael G. Washam, A.C.E.

Signed by Lead Agency

Date submitted to LCI: _____



Location Map

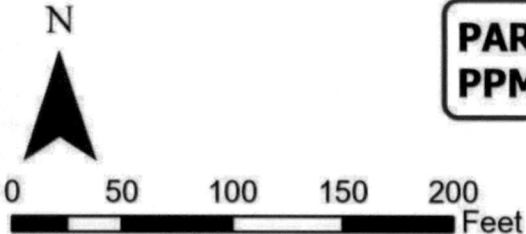
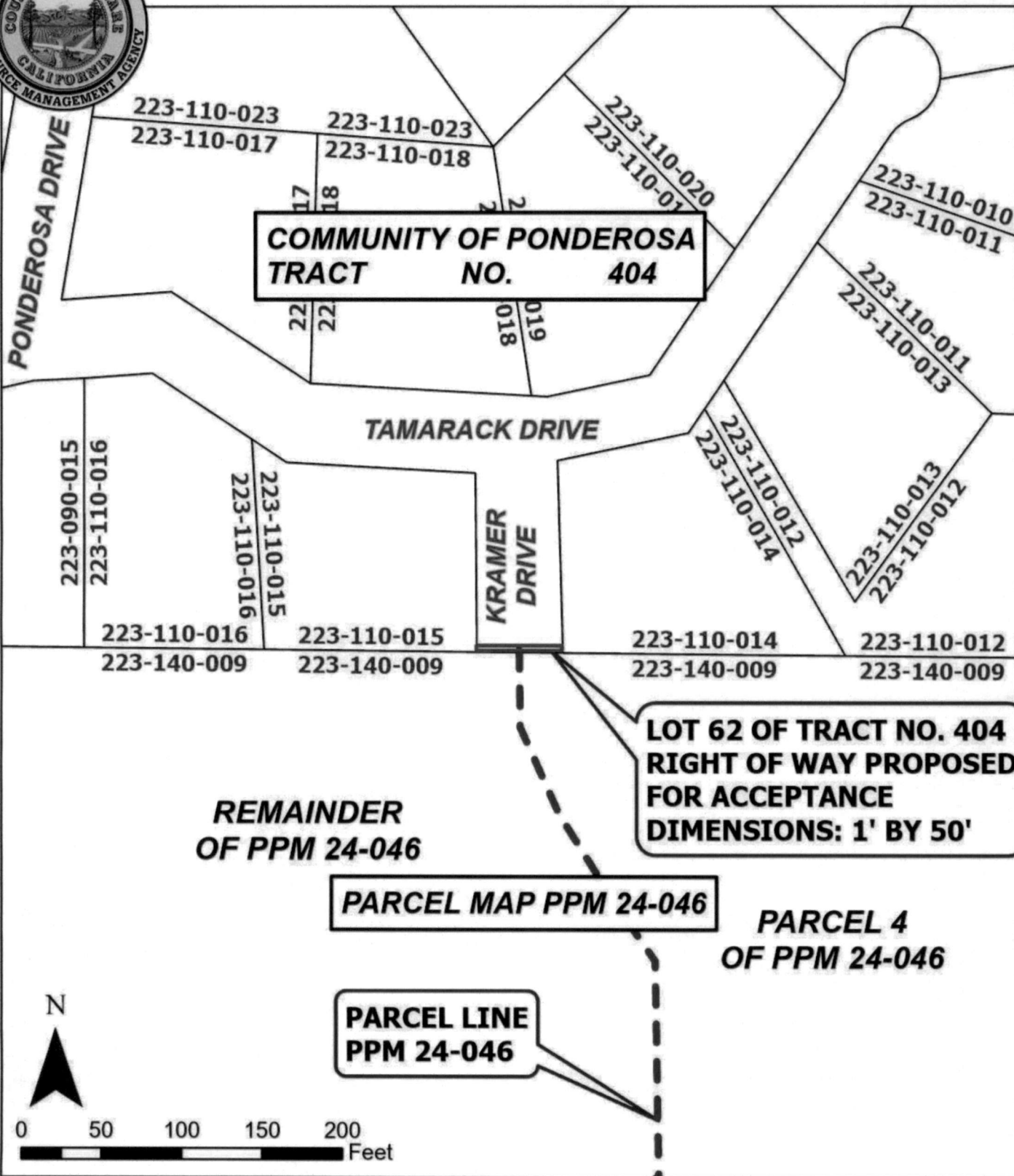

ACCEPT TRACT NO. 404 LOT 62 AS PUBLIC RIGHT-OF-WAY