

VERDEMONT HEIGHTS

CITY OF SAN BERNARDINO, CA / TRACT 20707

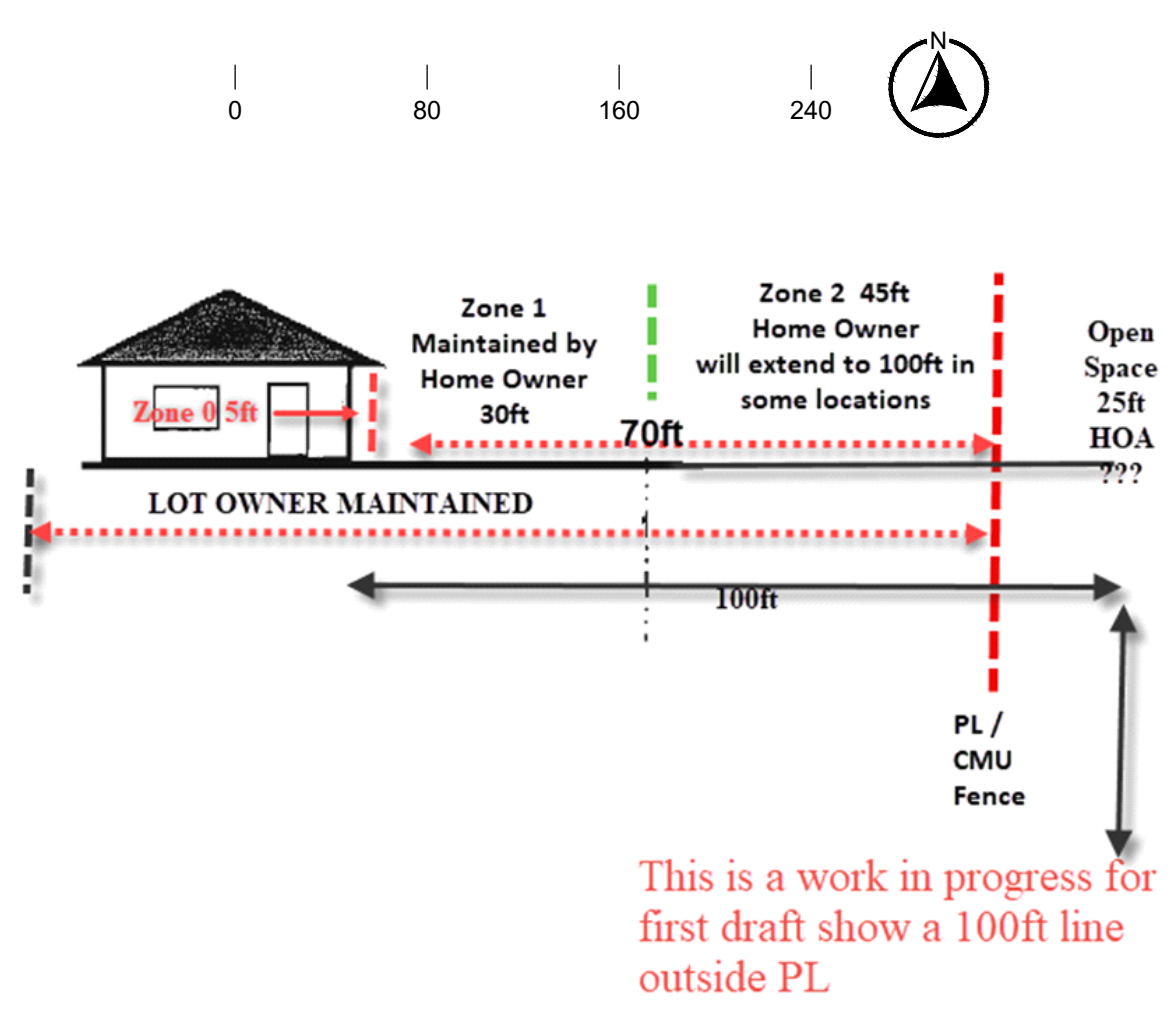

Fuel Modification Zone Location Exhibit	
Vermont Heights I TTM 20707 San Bernardino, CA County of San Bernardino, CA	
Symbol	Description
	IRRIGATED ZONE 0 (OWNER MAINTAINED) An area starting at the structure envelope extending 5 feet outward. This zone includes the area under and around all attached decks, and requires the most stringent wildfire fuel reduction. This area shall be kept clear of combustibles. Zone 0 has not been fully defined by the Board of Forestry and should not contain vegetation until further guidance is provided. Combustible fencing material shall not be attached to the structure. <i>Zone 0 is applicable to each home in the entire Tract.</i>
	IRRIGATED ZONE 1 (OWNER MAINTAINED) Starts following Zone 0 extending to 30 feet or to the Parcel Line. Irrigation required, plant species must be drought tolerant and fire resistive. Further defined as lean, clean and green. Any amount of hardscape or parking is acceptable. See Fire Protection Plan Section 5 for details.
	IRRIGATED ZONE 2 (OWNER MAINTAINED) Reduced Fuel Zone - Starts following Zone 1 extending to 75 ft or the Parcel line. For some lots extends to 100ft. Irrigation required, plant species must be drought tolerant and fire resistive. Streets, hardscape or parking is acceptable. See Fire Protection Plan Section 5 for details.
	6ft Non-Combustible Fire Barrier Mitigation Measure As Necessary
	Water Quality Basins Shall be kept free and clear of dead and dying vegetation.
	Emergency/Fire Access Way Entrance - From cross street
<p>Prepared For: Vermont Heights I, LLC 434 N 2nd Ave. Upland, CA 91786</p> <p>Prepared By: FIREWISE2000, LLC PO Box 339 Lower Lake, CA 95457 Phone: (760) 745-3947 info@firewise2000.com</p> <p>Construction shall comply with CBC Chapter 7A required for development in areas subject to VHFHSZ designations</p>	



***Verdemont Heights I* Zone Location Exhibit**

Note 1

The entire property is within a Very High Fire Hazard Severity Zones (VHFHSZ), (LRA) San Bernadino City, County of San Bernardino.

Note2

2022 Fire Code Chapter 49, additions to Landscape Plans for plant species, spacing etc.

Zone 0 Ember Resistant Zone as required not a part of CFC49.

An area starting at the structure envelope extending 5 feet outward. This zone includes the area under and around all attached decks, and requires the most stringent wildfire fuel reduction. This area shall be kept clear. **Zone 0 has not been fully defined by the Board of Forestry and should not contain vegetation until further guidance is provided**

Sec 4906.3 Exhibit

Landscape plans shall contain the following:

1. Delineation of the 100-foot (30.5 m) fuel management zones from all structures.
2. Identification of existing vegetation to remain if any and proposed new vegetation.
3. Identification of irrigated areas.
4. A plant legend with both botanical and common names, and identification of all plant material symbols.
5. Identification of ground coverings within the 30-foot (9144 mm) zone.

Sec 4906.4 Vegetation.

All new vegetation shall be fire-resistant vegetation in accordance with this section.

Exception: Trees classified as non-fire-resistant vegetation complying with Section 4906.4.2.1.

To be considered fire-resistant vegetation, it must meet at least one of the following:

1. Be identified as fire-resistant vegetation in an approved book, journal or listing from an approved organization.
2. Be identified as fire-resistant vegetation by a licensed landscape architect with supporting justification.
3. Plants considered fire-resistant vegetation and approved by the local enforcing agency.

Zone 1; 0 to 30 feet from the Structure

Sec 4906.4. Shrubs.

All new plantings of shrubs shall comply with the following:

1. Shrubs shall not exceed 6 feet (1829 mm) in height.
2. Groupings of shrubs are limited to a maximum aggregate diameter of 10 feet (3048 mm).
3. Shrub groupings shall be separated from other groupings a minimum of 15 feet (4572 mm).
4. Shrub groupings shall be separated from structures a minimum of 30 feet (9144 mm).
5. Where shrubs are located below or within a tree's drip line, the lowest tree branch shall be a minimum of three times the height of the understory shrubs or 10 feet (3048 mm), whichever is greater.

Sec 4906.4. Trees.

Trees shall be managed as follows within the Zone 1, 0 to 30-foot area of a structure:

1. New trees shall be planted and maintained so that the tree's drip line at maturity is a minimum of 10 feet (3048 mm) from any combustible structure.
2. The horizontal distance between crowns of new trees and crowns of adjacent trees shall not be less than 10 feet (3048 mm).
3. Existing trees shall be trimmed to provide a minimum separation of 10 feet (3048 mm) away from chimney and stovepipe outlets per Title 14, Section 1299.03.

Sec 4906.4.2 Non-fire-resistant vegetation.

New trees not classified as fire-resistant vegetation, such as conifers, palms, pepper trees and eucalyptus species, shall be permitted provided the tree is planted and maintained so that the tree's drip line at maturity is a minimum 30 feet (9144 mm) from any combustible structure.

Zone 2 30 to 100 feet, is a reduced fuel zone and is designed to reduce the potential behavior of an oncoming fire by reducing the flame heights, and the potential for ember generation and radiant heat exposure to the structure.

Verdemont Heights I Zone Location Exhibit

