



CHRONICLE™
HERITAGE

T: (626) 408-8006

F: (602) 254-6280

info@chronicleheritage.com

LOS ANGELES, CALIFORNIA

55 East Huntington Drive, Suite 238
Arcadia, California 91006

October 23, 2025

Michael Levi
Project Manager
Meridian Consultants, LLC
Transmitted via email to: MLevi@meridianconsultantsllc.com

RE: Cultural Resources Desktop Study for the 8144 Haskell Avenue Project, Los Angeles, Los Angeles County, California

Dear Michael Levi,

At the request of Meridian Consultants, Chronicle Heritage conducted a desktop cultural resource inventory for the 8144 Haskell Avenue Project (Project) in the city of Los Angeles, Los Angeles County, California. This inventory consisted of a records search of the California Historical Resources Information System (CHRIS) at the South Central Coastal Information Center (SCCIC). Additionally, review of historical maps, aerial photographs, and General Land Office (GLO) plats was completed. This memorandum summarizes the results of the cultural resource inventory efforts for the Project.

Project Location and Description

The proposed Project is located on a developed commercial lot on Assessor Parcel Numbers 2673-022-048 and 2673-022-038. The lot is fully paved and contains the foundations of a previous development.

CHRIS Records Search

Chronicle Heritage conducted an in-person records search at the SCCIC housed at California State University, Fullerton on October 6, 2025. This records search included the Project area and a 0.5-mile (mi) buffer search area (Exhibit A, Figure 1). The purpose of the records search was to identify any known cultural resources in the immediate vicinity of the Project area. The search also included a review of the Office of Historic Preservation (OHP) Archaeological Determination of Eligibility (ADOE) and the OHP Built Environment Resources Directory (BERD).

The records search indicated that 16 cultural resources studies have been conducted within 0.5 mi of the Project area since 1988 (Table 1). Of the 16 previous studies, none intersect or include the Project area.

Table 1. Previous Cultural Studies Recorded Within 1 Mile of the Project Area

Report No.	Date	Author(s)	Title
LA-00160	1988	Dames & Moore	Phase I Cultural Resources Survey Fiber Optic Cable Project



Cultural Resource Desktop Review for the 8144 Haskell Avenue Project, Los Angeles, Los Angeles County, California

LA-03289	1990	Gene Davis	Mobil M-70 Pipeline Replacement Project Cultural Resource Survey Report
LA-02645	1991	Peak & Associates, Inc.	Class 3 Cultural Resource Assessment of The Proposed Carpinteria and Southern Reroutes
LA-02950	1992	Peak & Associates, Inc.	Consolidated Report: Cultural Resource Studies for The Proposed Pacific Pipeline Project
LA-13119	1999	Wayne H. Bonner, C. Phil	Cultural Resources Survey Monroe New Elementary School No. 2 North Hills, City and Country of Los Angeles, California
LA-05595	2000	Curt Duke.	Cultural Resource Assessment for Pacific Bell Mobile Services Facility LA 140-02, County of Los Angeles, California
LA-05606	2000	Curt Duke.	Cultural Resource Assessment for AT&T Wireless Services Facility Number C925.1, County of Los Angeles, California
LA-06599	2002	John M. Foster	HISTORIC RESOURCE EVALUATION REPORT: Mason Avenue At-Grade Crossing and Safety Improvements Project Los Angeles City, California
LA-07931	2006	Wayne H. Bonner	Cultural Resources Records Search Results and Site Visit for T-Mobile Candidate SV00945 (Global Signal), 8000 Haskell Avenue, Van Nuys, Los Angeles County, California.
LA-08255	2006	SWCA Environmental Consultants	Cultural Resources Final Report of Monitoring and Findings for The Qwest Network Construction Project, State of California
LA-08875	2006	Kathleen Crawford.	Cultural Resources Records Search and Site Visit Results for T-Mobile Candidate SV00945C (Cabrito), 15520 Cabrito Road, Van Nuys, Los Angeles County, California
LA-10300	2009	Wayne H. Bonner, Sarah A. Williams	Cultural Resources Records Search and Site Visit Results for T-Mobile USA Candidate SV11849A (Sepulveda Chung), 8449 Sepulveda Boulevard, North Hills, Los Angeles County, California
LA-10756	2010	Jeanette A. McKenna	A Cultural Resources Overview and Preliminary Assessment of The Pacoima/Panorama City Redevelopment Plan Amendment/Expansion Project Area, Los Angeles County, California
LA-12357	2012	Deborah Roberts	Mission City Community Network Medical and Dental Facility Project- Azusa, California
LA-12505	2012	James R. Wallace, Sara Dietler, Linda Kry	Draft Phase I Cultural Resources Assessment San Fernando Valley Water Recycling Project City of Los Angeles,
LA-13016	2014	David Brunzell	Archaeological Monitoring Results for 8527 Sepulveda Boulevard, Los Angeles, California (BCR Consulting Project No. MCN1401)

The records search indicated that no cultural resources have been previously documented within 0.5 mi of the Project area.

Historic Map and Aerial Imagery Review

A review of historical topographic maps and aerial photographs of the Project area and vicinity was conducted. Historical topographic maps reviewed included Los Angeles, California (1894, 1900) 15-minute; Santa Monica, California (1896, 1898, 1902, 1920, 1921) 15-minute; Pacoima, California (1927) 7.5-minute; and Van Nuys, California (1953, 1966, 1976) 7.5-minute USGS quadrangle. Aerial images from 1947, 1952, 1959, 1964, 1967, 1972, 1977, 1980, 1985, 1989, 1992, 1993, 1994, 1995, 1996, 1997, 1998, 1999, 2000, 2003, 2004, 2005, 2009, 2010, 2012, 2014, 2016, 2018, 2020, and 2022 were reviewed (Nationwide Environmental Title Research Online 2025).

The review of the historical topographic maps and aerial imagery indicates a history of repeated development within the Project Area. As of 1927, no commercial or transportation development had been conducted, but by 1966 there had been repeated development within the Project Area. In 1947, when aerial imagery is available, there had been no development until 1967 the Project Area was commercially developed and the San Diego Freeway immediately adjacent to the east was completed. All adjacent parcels were developed with commercial buildings and parking lots by 1980. There were no significant changes within the Project area until 2016 with the removal of the buildings on the parcels, 2673-022-048 and 2673-022-038, of the Project Area.

To more exactly establish the ages of buildings currently present in the Project area, records from the Los Angeles County Assessor's website were reviewed (Los Angeles County Assessor 2025). Records indicate that what appears to be the first commercial building within the Project area was constructed in 1964 on parcel 2673-022-048, and by 1975, parcel 2673-022-038 was similarly developed.

A review of BLM GLO records do not indicate any land patents or USGS survey plats associated with the parcels that comprise the Project area (BLM GLO 2025).

Summary

There are no previously documented cultural resources within the Project area. Based on a review of historical topographic maps and aerial images, the Project area has undergone commercial development as early as 1967. The surrounding the area has also been subject to continuous commercial development. The San Diego Freeway, just east of the Project area, has provided access to northwest Los Angeles since at least 1961.

In the unlikely event that cultural resources are encountered during construction activities associated with the Project, a qualified archaeologist should be retained to assess the significance of the find in accordance with the criteria set forth in the CRHR and NRHP, as appropriate. In addition, Health and Safety Code 7050.5, California Environmental Quality Act 15064.5(e), and Public Resources Code 5097.98 mandate the process to be followed in the unlikely event of an accidental discovery of any human remains in a location other than a dedicated cemetery.

It has been a pleasure working with you on this Project. If you have any questions, please do not hesitate to contact the Principal Investigator at cmahan@chronicleheritage.com.

Sincerely,
Chronicle Heritage



Diana M. Cleveland, B.S. | Associate
Archaeologist/Archaeological Field Technician



Chase M. Mahan, M.A., RPA | Senior Archaeologist/
Principal Investigator

Cultural Resource Desktop Review for the 8144 Haskell Avenue Project, Los Angeles, Los Angeles County, California

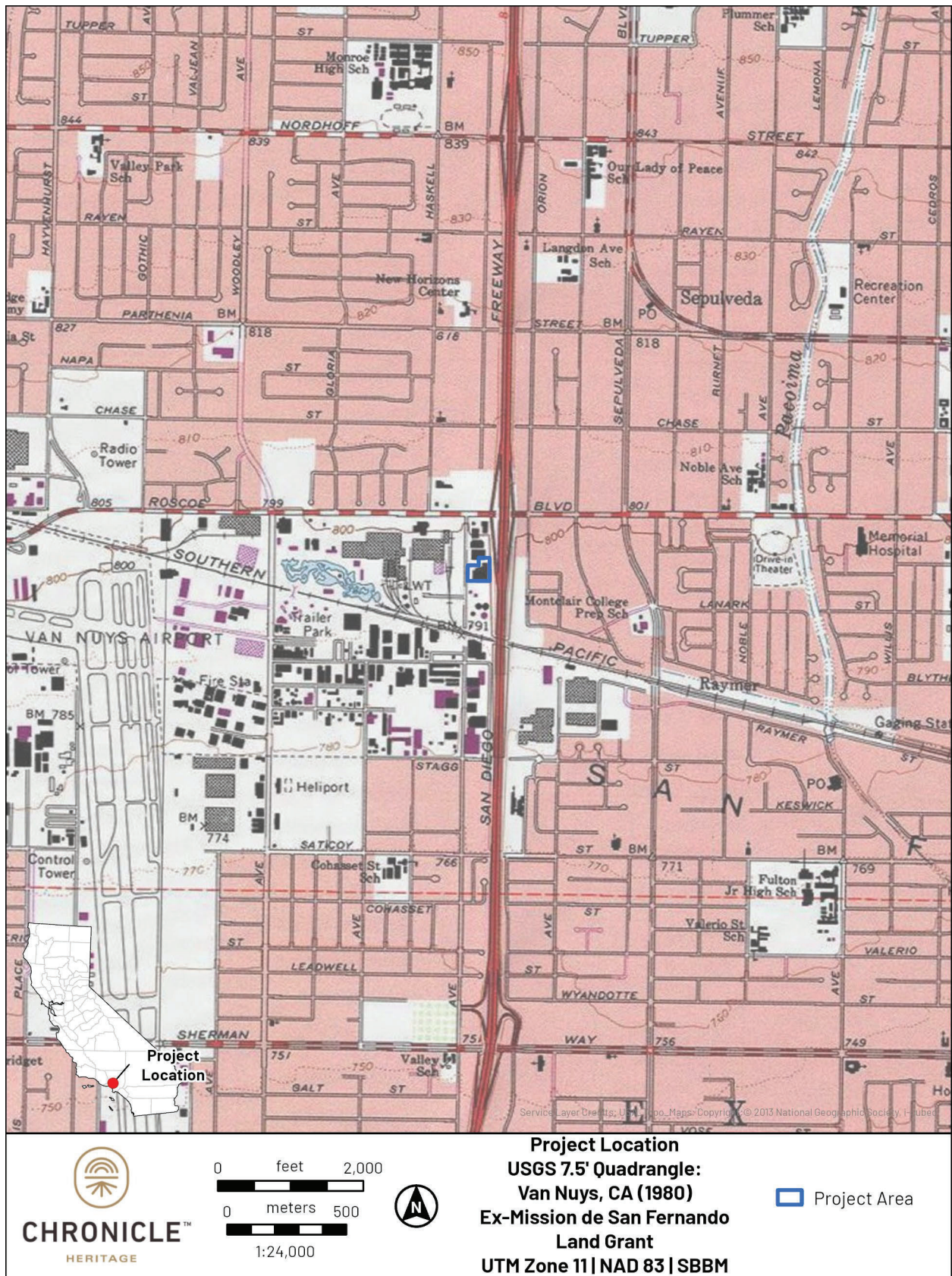

Figure 1: Project location map

References

Bureau of Land Management General Land Office [BLM GLO]

2025 Official Federal Lands Records Site. Electronic document, <https://glorerecords.blm.gov/default.aspx>, accessed October 15, 2025.

Los Angeles County Assessor

2025 Parcel details for AINs 2673-022-048 and 2673-022-038. Electronic document, <https://portal.assessor.lacounty.gov>, accessed October 15, 2025.

Nationwide Environmental Title Research Online [NETROnline]

2025 Historic Aerials. Electronic document, <https://www.historicaerials.com/viewer>, accessed October 15, 2025.