



**NOTICE OF INTENT TO ADOPT A
MITIGATED NEGATIVE DECLARATION**

Project: Peterson Elementary School Field Lighting Project

Lead Agency: Huntington Beach City School District

Review Period: February 16, 2026 to March 18, 2026 (30 days)

NOTICE IS HEREBY GIVEN that Huntington Beach City School District (District) has prepared an Initial Study (IS)/Mitigated Negative Declaration (MND) for the Peterson Elementary School Field Lighting Project (project) to address the potential environmental effects associated with implementation of the project. Pursuant to Public Resources Code Section 21165 and the California Environmental Quality Act (CEQA) Guidelines Section 15050, the District is the lead agency for the project. The purpose of this notice is to 1) serve as a Notice of Intent (NOI) to adopt an IS/MND and 2) advise and solicit comments regarding the content of the IS/MND.

PUBLIC REVIEW AND COMMENT: The District invites you to comment on the IS/MND. The IS/MND will be available for a 30-day public review from **February 16, 2026**, to **March 18, 2026**. We ask that any person wishing to comment on the IS/MND provide written comments by the end of the public review period at 5:00 p.m., **March 18, 2026**.

Copies of the IS/MND are available for review at the following locations:

Huntington Beach City School District
8750 Dorsett Drive
Huntington Beach, California 92646

The document can also be accessed online at: <https://www.hbcasd.k12.ca.us/petersonlightingproject>

You may send comments by email or mail to the addresses below:

Huntington Beach City School District
Mark Manstof, Executive Director, Operations
8750 Dorsett Drive
Huntington Beach, California 92646
mmanstof@hbcasd.us

PROJECT LOCATION: The project site is located at the existing Peterson Elementary School (Peterson ES) campus at 20661 Farnsworth Lane (Assessor's Parcel Number 151-331-12), in the City of Huntington Beach in Orange County. The project site consists of 2.81 acres located within the northwest portion of the Peterson

ES campus on an existing multi-use playfield (project site). The project site is exclusively surrounded by residential uses, with Talbert Channel to the west of the campus and project site. All surrounding residential uses consist of single-family residences. See Figure 1, *Regional Location*, and Figure 2, *Aerial Photograph*.

PROJECT DESCRIPTION: The proposed project would remove two existing unlit soccer fields, install one new lit soccer field with three field lighting poles with field lights, and restripe the existing soccer fields. The new field would be lit by three lighting poles. P1 would be located along the east side and oriented west, P2 would be located along the west side and oriented east, and Pole P3 would be installed along the north side of the project site. Poles P1 and P3 would each support six light fixtures, while pole P2 would support ten fixtures. All lighting poles would be approximately 62 feet tall. See Figure 3, *Conceptual Site Plan*.

All field light fixtures would be aimed toward the soccer field and away from the surrounding area to minimize light spill. The lighting system would be manually turned off when the field is not in use and would also include an automatic timer to ensure lights shut off by 9:00 p.m. Associated improvements would include trenching for an electrical utility line to connect the new lighting to existing on-site utilities. Additional project elements include restriping the soccer field lines. No off-site improvements are proposed, parking would continue to be provided on campus, and the project would not increase campus capacity or enrollment.

Programming on the proposed soccer field would be similar to existing multi-use playfield activities and would continue to serve Peterson ES students, the Peterson ES PTA, the YMCA program, and AYSO players, coaches, and spectators. The addition of field lighting would allow evening use during winter months, similar to current summer uses. The Peterson ES PTA and YMCA programs would use the field for after-school and special events.

PTA events such as the Fall Festival and Spring Fling would typically occur between 3:00 p.m. and 7:30 p.m. The YMCA program would use the field from the end of the school day until approximately 6:00 p.m., Monday through Friday. With the addition of lighting, these activities could continue consistently during shorter daylight periods in winter months.

AYSO practices, which currently occur in summer months, would extend into evening hours during winter, generally between 4:00 p.m. and 8:30 p.m., Monday through Friday, with lights turned off no later than 9:00 p.m. Evening events are expected to have minimal spectators, with primary attendance limited to players and coaches, totaling about 60 people. Saturday AYSO activities would continue during daytime between approximately 8:30 a.m. and 5:00 p.m. The proposed project would not include, and would not authorize, additional fields, additional lighting poles, increased light levels, or extension of operating hours beyond those described in this section.

The construction of the proposed project would occur in one phase and would take approximately three months during the summer. Construction activities would include site preparation, construction of light poles, and utility trenching.

The discretionary actions and approvals required for project implementation are 1) the adoption of the MND, 2) the adoption of the Mitigation Monitoring and Reporting Program, and 3) project approval by the District.

ENVIRONMENTAL DETERMINATION: The District has prepared an IS to determine the proposed project's potential impact on the environment. The District has determined that the proposed project may have significant impacts to biological resources, cultural resources, geology and soils, and tribal cultural resources, but by implementing the identified mitigation measures, the proposed project's impacts would be reduced to less-than-significant levels. Accordingly, the District intends to adopt an IS/MND.

Applicant: Huntington Beach City School District
Lead Agency: Huntington Beach City School District
Consulting Firm: PlaceWorks

Date: February 16, 2026

Signature: 

Mark Manstof, Executive Director, Operations
Huntington Beach City School District

Figure 1 - Regional Location



- City of Huntington Beach Boundary
- - - County Boundary

Note: Unincorporated county areas are shown in white.
Source: Generated Using ArcMap, 2025.

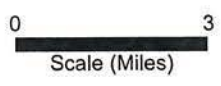

Figure 2 - Aerial Photograph



- School Boundary
- Project Boundary

0 240
Scale (Feet)



Source: Nearmap 2025.

Figure 3 - Conceptual Site Plan

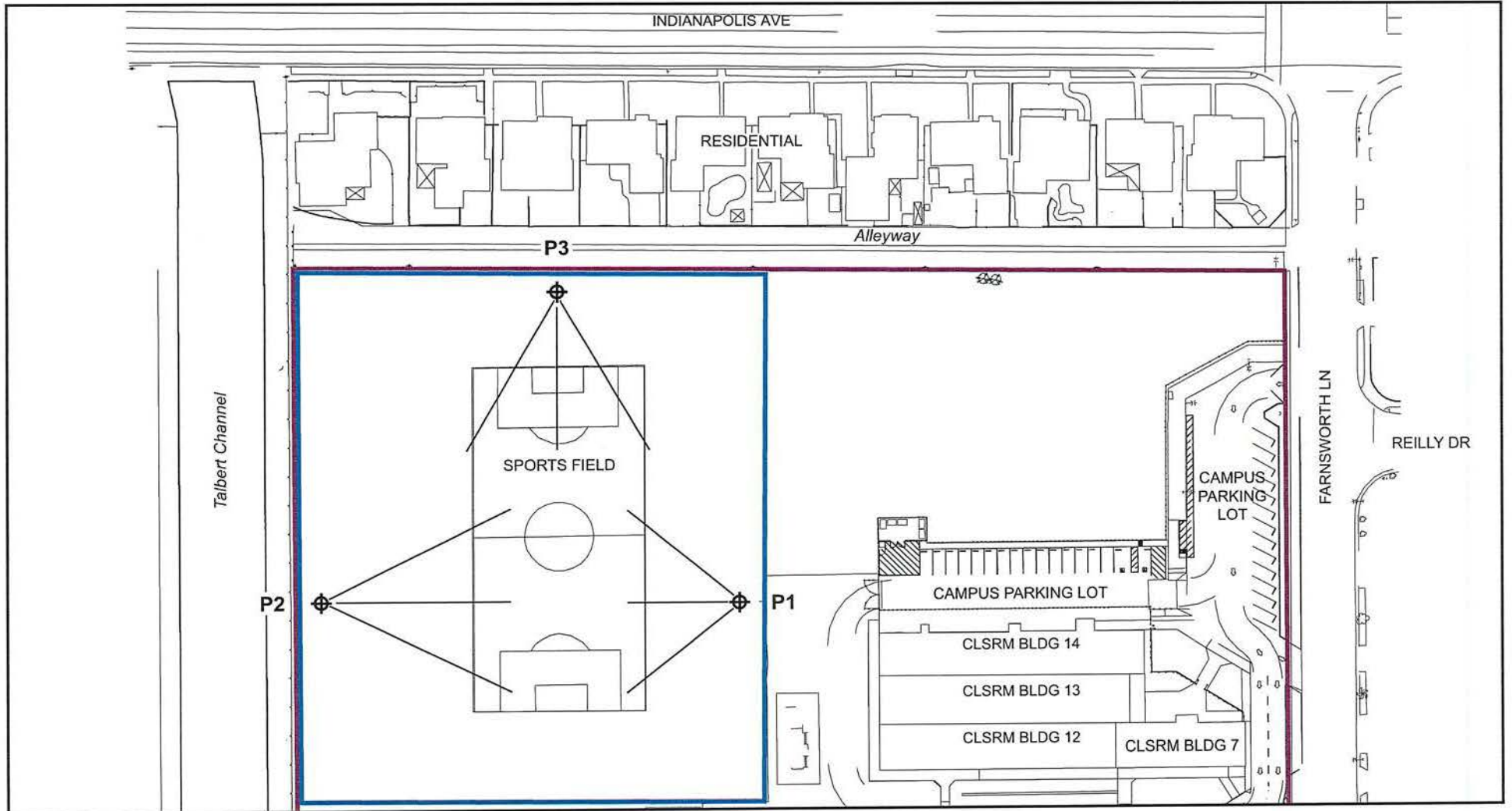

- School Boundary
- Project Boundary

0 100
Scale (Feet)



Source: Studio + 2025.