Appendix C

Cultural Resources Report



18 October 2021

Brian Bargemann
Investment Building Group
Via email: BrianB@ibg-usa.com

Cultural Resources Records Search for the 280 West Valley Boulevard Project, Rialto, San Bernardino County, California

Dear Mr. Bargemann:

This memo summarizes a cultural resources records search for the 280 West Valley Boulevard Project (Project) in Rialto, San Bernardino County, California. ASM Affiliates, Inc. (ASM) requested a search of existing records held by the South Central Coastal Information Center (SCCIC), part of the California Historical Resources Information System (CHRIS), which encompassed the Project area and a radius of 1 mi. around it. In addition, historic aerial photographs and historic USGS topographic maps of the Project area were analyzed. A request was also made for a search of the Native American Heritage Commission's (NAHC) Sacred Lands File. The SCCIC records search summary letter is included as Attachment A and the NAHC response will be provided upon receipt.

PROJECT DESCRIPTION

The 6.02-acre project site is located within the southern portion of the City of Rialto in San Bernardino County, situated at the northeast corner of South Willow Avenue and West Valley Boulevard; a large self-storage facility bounds the east edge of the property and a channelized drainage runs northwest-southeast at the northeastern edge of the parcel. The project area is generally bounded by Interstate 10 and a major railroad switching station to the south and Riverside Avenue to the east. The property is located within the southeast $\frac{1}{4}$ of the northeast $\frac{1}{4}$ of Section 23, Township 1 South, Range 5 West as illustrated on the USGS San Bernardino South, California 7.5-minute topographic quadrangle (Figure 1). The property has been graded flat and is at approximately 1,065 feet above mean sea level. The southern portion of the project site is currently developed with structures, parking lots, and landscaping that were built ca. 1987, with the northern portion remaining as vacant land.

RESULTS OF ARCHIVAL RESEARCH

SCCIC Records Search Results

The SCCIC records search was conducted to determine whether the Project area has been previously subject to survey as well as to detect the presence or absence of cultural resources previously documented within the Project area. The search included all records and documents on file with the SCCIC, as well as the National Register of Historic Places, the Office of Historic Preservation (OHP) Historic Property Directory, the OHP Archaeological Determinations of Eligibility list, and the Los Angeles Historic-Cultural Monuments (HCM) list.

A total of 25 previous reports were identified as a result of the records search (Table 1). One of these, SB-01772, encompassed the Project area, and included an archival search and pedestrian survey, neither of which resulted in documentation of any prehistoric or historical resources within or near the parcel.

Table 1. Previous Cultural Resource Projects Conducted within the 1-Mile Records Search Radius

Report No. (SB-)	Year	Author(s) / Affiliation	Title
01468	1984	Hammond, Stephen R.	Negative Archaeological Survey Report: Colton/San Bernardino Maintenance Station, City of Rialto, San Bernardino County
01558	1986	Bixler, David / Mohave Environmental Consultants	Archaeological Site Survey: West Valley Redevelopment Project in the City of Colton
01635	1987	Bixler, David	Archeological Surface Survey: Colton Dune Site
01651	1987	Lerch, Michael K.	Negative Resource Field Reconnaissance: Tentative Tract 12352, Bloomington
01772	1988	Hallaran, Kevin B., and Karen K. Swope / Archaeological Research Unit, UCR	Environmental Impact Evaluation: An Archaeological Assessment of the Rialto Gateway Project, San Bernardino County, California
03586	2000	Love, Bruce / CRM Tech	Ontario to Colton Pipeline, San Bernardino County, CA
03603	1998	Love, Bruce / CRM Tech	Installation of Water Pipes along I-10 Between Colton and Fontana
03931	2002	Dahdul, Miriam / CRM Tech	Historical/Archaeological Resources Survey Report: Rialto Channel Improvement Project (Phase 3) in the City of Rialto, San Bernardino County, CA
04261	2004	McKenna, Jeanette A. / McKenna et al.	A Phase I Cultural Resources Investigation of the Colton Joint Unified School District Middle School No. 5 in the City of Rialto, San Bernardino County, CA
04345	1995	McKenna, Jeanette A. / McKenna et al.	I-10/Pepper Ave Interchange
04355	2003	Dice, Michael / Michael Brandman Associates	Cultural Resources Evaluation of Sprint Telecommunications Facility Candidate Sb56xc802d, 1558 S. Riverside Ave, Rialto, San Bernardino County, CA
04634	2004	Tibbett, Casey	Historical/Archaeological Resources Survey Report: WalMart Supercenter Project, City of Rialto, San Bernardino County, California
05116	1998	William Self Associates	Cultural Resources Assessment of the Southwest Gas Corporation Pipeline for the High Desert Power Project, San Bernardino, County, California
05628	2007	Bonner, Wayne H., and Marnie Aislin-Kay	Cultural Resource Records Search Results and Site Visit for T-Mobile Telecommunications Facility Candidate IE 04845C (Space Place Storage), 220 West Valley Boulevard, Rialto, San Bernardino County, California
06089	2008	Bholat, Sara, and Evelyn N. Chandler	Cultural Resources Survey of a Temporary Ethanol Transload Facility in the City of Rialto, San Bernardino County, California
06443	2008	Wlodarski, Robert / CARE	Record Search Results for the Proposed Bechtel Wireless Telecommunications Site ES0160 (Rialto City Park) located at 130 East San Bernardino Avenue, Rialto, CA
06516	1999	Ashkar, Shahira	Cultural Resource Inventory Report for Williams Communications, Inc., Proposed Fiber Optic System Installation Project, Los Angeles to Riverside, Los Angeles, Riverside and San Bernardino Counties
06917	2010	Bonner, Wayne H., and Sarah A. Williams	Cultural Resource Records Search and Site Visit Results for T-Mobile USA Candidate IE24778E (Inland Lighthouse Church Monopole), 1123 South Cactus Avenue, Rialto, San Bernardino County, California

Report No. (SB-)	Year	Author(s) / Affiliation	Title
07123	2010	Panich, Lee, and John Holson	Supplemental Archaeological Survey Report, 66kV Transmission Lines Access Roads, Tehachapi Renewable Transmission Project Segments & and 8, Los Angeles and San Bernardino Counties, California
07184	2012	Billat, Lorna / Earth Touch, Inc.	Archaeological Assessment Report for Excel/MLAX04226A Wireless Facility Located at 2353 South Cactus Avenue, Bloomington in San Bernardino County, California
07259	2011	Allan, James L.	Live Section 111 Fly Area at M.P. 07
07960	2010	Self, William / William Self Associates, Inc.	Class III Cultural Resources Survey Addendum for the Proposed Calnev Expansion Project, California Portion San Bernardino County, California
07991	2014	Estes, Allen, and Thomas Young / WSA	Cultural Resources Assessment Report: Ground Water Monitoring Well Project Colton, California
07992	2014	Estes, Allen, and Thomas Young / WSA	Cultural Resources Assessment Report: Delhi Sands Flower Loving Fly Project; Colton, California
08072	2015	Goodwin, Riordan / LSA	Cultural Resources Assessment Willow Avenue Warehouse Project City of Rialto San Bernardino County, California

The search also revealed that 14 resources have been previously documented within the 1-mi. records search radius (Table 2). None of these resources are within or in direct proximity to the Project area. Four of the previously recorded resources are from the prehistoric period, comprising two lithic scatters and two isolated artifacts, the nearest of which is approximately 0.5 mi. south of the Project; the remaining 13 resources are from the historical period.

Table 2. Resources Previously Recorded within the 1-Mile Records Search Radius

Primary # (P-36-)	Trinomial (CA-SBR-)	Date (Recorded by)	Description	Attribute Codes
001579	1579	1963 (Smith)	Slover Avenue site	AP2. Lithic scatter
006868	6868H	1990 (Schmidt et al., Greenwood & Assoc.)	-	AH4. Privies/dumps/trash scatters
008927	8927H	1997 (Lerch and Swope)	-	AH4. Privies/dumps/trash scatters
010330	10330H	1999 (Ashkar, Jones & Stokes Associates, Inc.); 2002 (Goodwin, LSA Associates, Inc.); 2008 (Harper, SWCA); 2010 (Tibbet, LSA Associates, Inc.); 2012 (Paul, ICF International)	Union Pacific Railroad; Southern Pacific Railroad; West Line Basin Alignment; Union Pacific Railroad Crossing at Anderson Street	AH7. Roads/trails/railroad grades; HP39. Other
013627	12613H	2007 (Dice, MBA); 2011 (Hoffman, ICS); 2012 (Sanka and Gilleean, Atkins); 2017 (McGinnis, ICF); 2019 (Stropes, BFSA)	Southern Sierras Powerline	HP11. Engineering structure
020676	-	2009 (Daly, Daly & Associates); 2015	2385 South Willow Ave, Rialto	HP2. Single family property; HP33. Farm/ranch
021603	-	2008 (Hollins, URS Corp.)	176 E. Slover Ave, Colton; Tank Farm	HP8. Industrial building

Primary # (P-36-)	Trinomial (CA-SBR-)	Date (Recorded by)	Description	Attribute Codes
021604	-	2008 (Hollins, URS Corp.)	1717 E. Slover Ave, Colton; Tank Farm	HP8. Industrial building
021609	-	2008 (Hollins, URS Corp.)	1030 Bloomington Ave, Bloomington; Tank Farm	HP8. Industrial building
025455	16173H	2012 (Sanka, Atkins)	-	AH15. Standing structures; HP11. Engineering structure
031941	31941H	2018 (Smith, L&L)	-	AH4. Privies/dumps/trash scatters AH5. Wells/cisterns; AH6. Water conveyance system
033059	-	1986 (Bixler); 2013 (Sanka, Atkins)	-	AP2. Lithic scatter
060240	-	1986 (Bixler)	-	AP16. Other (isolated projectile point)
060241	-	1986 (Bixler)	-	AP16. Other (isolated pottery sherd)

Historical Imagery

Historical aerial photographs from 1938, 1948, 1959, 1966, 1967, 1968, 1977, 1980, 1994, 1995, 2002, 2005, 2009, 2010, 2012, 2014, 2016, and 2018 were analyzed on historicaerials.com, as were historical topographic maps dated 1896, 1898, 1901, 1905, 1909, 1913, 1926, 1929, 1938, 1943, 1946, 1955, 1959, 1963, 1965, 1969, 1974, 1975, 1980, 1981, 1985, 2012, 2015, and 2018.

Historical imagery provides minimal additional information regarding the use of the Project area over time. Early topographic maps dating from 1896-1938 show no development directly within the Project area, though the east-west road that lies north of the Southern Pacific Railroad (sharing a similar alignment with current Interstate 10) appears to the south of the project area from the earliest map onward. Willow Avenue and Valley Boulevard first appear on the 1943 topographic map. No structures or land use symbols appear at any time on the topographic maps.

The 1938 aerial image shows Valley Boulevard and Willow Avenue in place, with Valley as a paved road and Willow as a wide dirt road. A roughly north-south drainage appears to the east of the project site approximately midway between Willow and Riverside Avenue. The 1948 image appears to show the project under cultivation with two east-west dirt roads cutting through the parcel. In 1959, the parcel appears vacant and uncultivated, with the east-west roads becoming overgrown and losing clarity. The 1977 image shows the area checker-boarded with graded road in between. The currently extant development on the project site and the channelized drainage both appear in the 1994 image, with no significant changes after this time.

NAHC Sacred Lands File Search

ASM requested for search of the Sacred Lands File (SLF) held by the California Native American Heritage Commission (NAHC) to supplement the SCCIC records search to inquire as to whether resources important to local Native American groups may exist within the proposed Project area that may not appear within the CHRIS system. The NAHC response has not yet been received; it will be provided upon receipt.

October 18, 2021
Brian Bargemann
Page 5 of 5

CONCLUSION

Review of the results of the SCCIC records search and historical imagery indicate that the Project location does not contain any nor has it contained any known historical properties as defined by CEQA. The results of prior studies encompassing and adjacent to the Project site suggest that the area overall has a low potential for containing previously undocumented archaeological or historical resources.

If you have any further questions or concerns, please do not hesitate to contact me.

Sincerely,

A handwritten signature in black ink that reads "Sherri Andrews". The signature is written in a cursive, flowing style.

Sherri Andrews
Senior Archaeologist
ASM Affiliates, Inc.
20 North Raymond Avenue, Suite 220
Pasadena, California 91103
(626) 793-7395
sandrews@asmaffiliates.com

Figure 1. Project location map.
Attachment A: SCCIC Records Search Summary

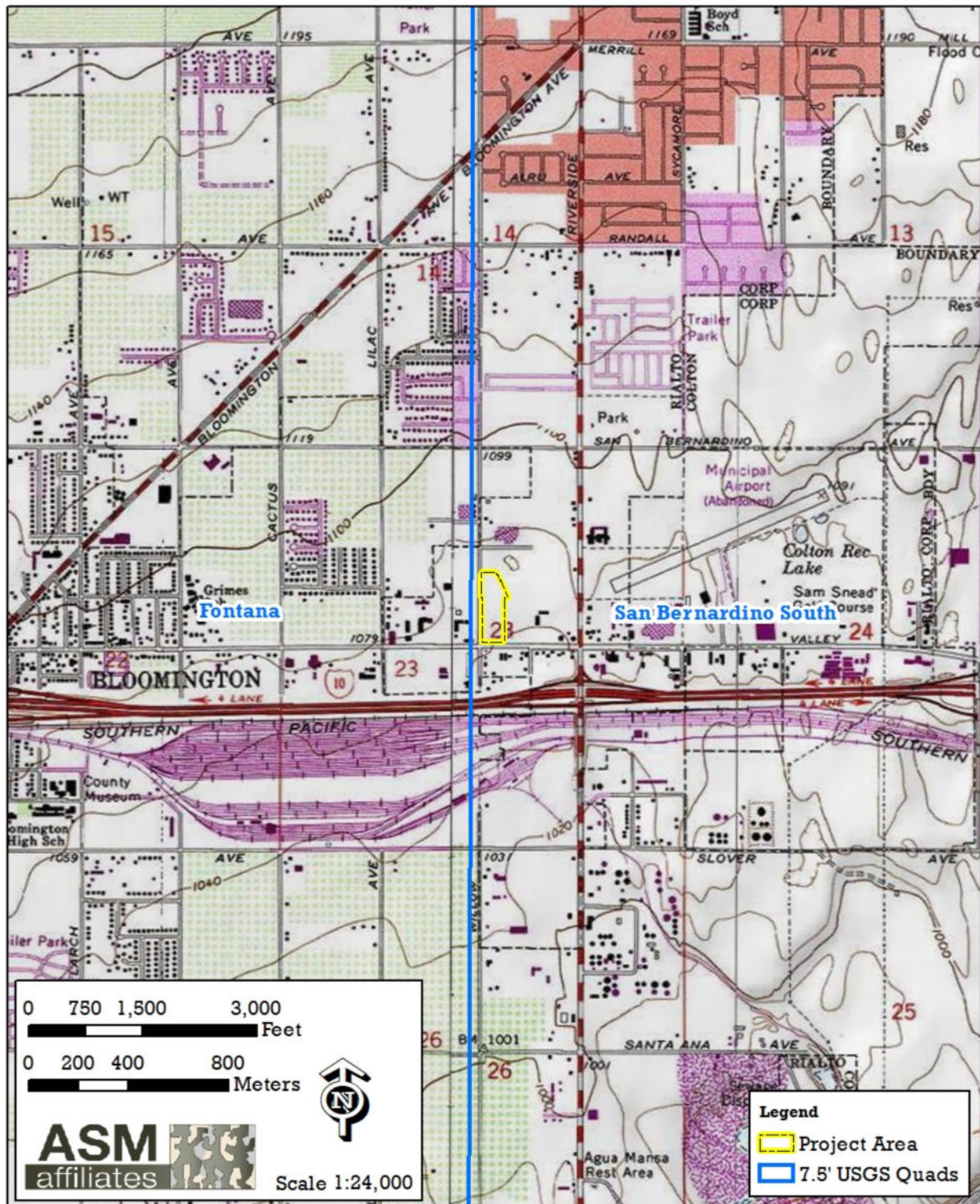

Figure 1. Project location map.

ATTACHMENT A: SCCIC Records Search Summary

South Central Coastal Information Center

California State University, Fullerton
Department of Anthropology MH-426
800 North State College Boulevard
Fullerton, CA 92834-6846
657.278.5395 / FAX 657.278.5542
sccic@fullerton.edu

California Historical Resources Information System
Orange, Los Angeles, and Ventura Counties

10/14/2021

Records Search File No.: 22795.8952

Sherri Andrews
ASM Affiliates, Inc.
20 N. Raymond Av., Ste. 220
Pasadena, CA 91103

Re: Record Search Results for the 280 W. Valley Bl. Rialto Records Searches

The South Central Coastal Information Center received your records search request for the project area referenced above, located on the Fontana and San Bernardino South, CA USGS 7.5' quadrangle(s). Due to the COVID-19 emergency, we have implemented new records search protocols, which limits the deliverables available to you at this time. **WE ARE ONLY PROVIDING DATA THAT IS ALREADY DIGITAL AT THIS TIME.** Please see the attached document on COVID-19 Emergency Protocols for what data is available and for future instructions on how to submit a records search request during the course of this crisis. If your selections on your data request form are in conflict with this document, we reserve the right to default to emergency protocols and provide you with what we stated on this document. You may receive more than you asked for or less than you wanted. The following reflects the results of the records search for the project area and a 1-mile radius:

As indicated on the data request form, the locations of resources and reports are provided in the following format: custom GIS maps shape files hand-drawn maps

Resources within project area: 0	None
Resources within 1-mile radius: 14	SEE ATTACHED MAP or LIST
Reports within project area: 1	SB-01772
Reports within 1-mile radius: 24	SEE ATTACHED MAP or LIST

- Resource Database Printout (list):** enclosed not requested nothing listed
- Resource Database Printout (details):** enclosed not requested nothing listed
- Resource Digital Database (spreadsheet):** enclosed not requested nothing listed
- Report Database Printout (list):** enclosed not requested nothing listed
- Report Database Printout (details):** enclosed not requested nothing listed
- Report Digital Database (spreadsheet):** enclosed not requested nothing listed
- Resource Record Copies:** enclosed not requested nothing listed
- Report Copies:** enclosed not requested nothing listed

- OHP Built Environment Resources Directory (BERD) 2019:** available online; please go to https://ohp.parks.ca.gov/?page_id=30338
- Archaeo Determinations of Eligibility 2012:** enclosed not requested nothing listed
- Historical Maps:** not available at SCCIC; please go to <https://ngmdb.usgs.gov/topoview/viewer/#4/39.98/-100.02>
- Ethnographic Information:** not available at SCCIC
- Historical Literature:** not available at SCCIC
- GLO and/or Rancho Plat Maps:** not available at SCCIC
- Caltrans Bridge Survey:** not available at SCCIC; please go to <http://www.dot.ca.gov/hq/structur/strmaint/historic.htm>
- Shipwreck Inventory:** not available at SCCIC; please go to http://shipwrecks.slc.ca.gov/ShipwrecksDatabase/Shipwrecks_Database.asp
- Soil Survey Maps: (see below)** not available at SCCIC; please go to <http://websoilsurvey.nrcs.usda.gov/app/WebSoilSurvey.aspx>

Please forward a copy of any resulting reports from this project to the office as soon as possible. Due to the sensitive nature of archaeological site location data, we ask that you do not include resource location maps and resource location descriptions in your report if the report is for public distribution. If you have any questions regarding the results presented herein, please contact the office at the phone number listed above.

The provision of CHRIS Data via this records search response does not in any way constitute public disclosure of records otherwise exempt from disclosure under the California Public Records Act or any other law, including, but not limited to, records related to archeological site information maintained by or on behalf of, or in the possession of, the State of California, Department of Parks and Recreation, State Historic Preservation Officer, Office of Historic Preservation, or the State Historical Resources Commission.

Due to processing delays and other factors, not all of the historical resource reports and resource records that have been submitted to the Office of Historic Preservation are available via this records search. Additional information may be available through the federal, state, and local agencies that produced or paid for historical resource management work in the search area. Additionally, Native American tribes have historical resource information not in the CHRIS Inventory, and you should contact the California Native American Heritage Commission for information on local/regional tribal contacts.

Should you require any additional information for the above referenced project, reference the record search number listed above when making inquiries. Requests made after initial invoicing will result in the preparation of a separate invoice.

Thank you for using the [California Historical Resources Information System](#),

Isabela Kott

 Digitally signed by Isabela Kott
Date: 2021.10.14 16:19:59 -07'00'

Isabela Kott
Assistant Coordinator, GIS Program Specialist

Enclosures:

(X) Covid-19 Emergency Protocols for San Bernardino County Records Searches – 2 pages

(X) Custom Maps – 2 pages

(X) Resource Database Printout (list) – 2 pages

(X) Report Database Printout (list) – 3 pages

(X) Resource Record Copies – (all) 108 pages

(X) Report Copies – (all – scanned only) 596 pages