



## Preliminary Arborist Report

---

### Haker Bucknall Multi-Purpose Building San Jose, CA

**PREPARED FOR:**  
DEVCON Construction Incorporated  
690 Gibraltar Drive  
Milpitas, CA 05035

**PREPARED BY:**  
HortScience | Bartlett Consulting  
2550 Ninth Street, Suite 112  
Berkeley, CA 94710

**January 2025**



**Preliminary Arborist Report**  
Haker Bucknall Multi-Purpose Building  
San Jose, CA

**Table of Contents**

---

	<b>Page</b>
Introduction and Overview	1
Assessment Methods	1
Description of Trees	2
City of San Jose Tree Protection Requirements	6
Suitability for Preservation	6
Preliminary Evaluations of Impacts and Recommendations	8
San Jose Tree Mitigation Requirements	9
Preliminary Tree Preservation Guidelines	10

---

**List of Tables**

---

Table 1. Condition ratings and frequency of occurrence of trees	2
Table 2. Tree suitability for preservation	7

**Exhibits**

---

***Tree Assessment Form***

***Tree Assessment Map***

***Preliminary Tree Disposition***

***San Jose Replacement Calculations***

# Preliminary Arborist Report

## Harker Bucknall Multi-Purpose Building

### San Jose, CA

### ***Introduction and Overview***

DEVCON Construction Incorporated is preparing plans to renovate the subject property located at 4300 Bucknall Road in San Jose. One multi-purpose building will be erected in the existing sports field. Additional improvements will occur elsewhere throughout the campus including expansion of parking, landscape renovations, and resurfacing of paving. HortScience | Bartlett Consulting (Divisions of The F. A. Bartlett Tree Expert Co.) was asked to prepare a **Preliminary Arborist Report** for the project site for submission to the City of San Jose.

This report provides the following information:

1. An assessment of tree health, structure, and suitability for preservation.
2. An estimate of the value of each tree.
3. A preliminary assessment of the impacts of constructing the proposed project and recommendations for action.
4. Preliminary tree preservation guidelines.

### ***Assessment Methods***

Trees were assessed on January 17, 2025. Trees with a trunk diameter of 6 inches or greater located in the project area were included in the assessment along with street trees of any size. The assessment procedure consisted of the following steps:

1. Identifying the tree species;
2. Tagging each tree with an identifying number and recording its location on a map;
3. Measuring the trunk diameter at a point 54 inches above grade;
4. Evaluating the health and structural condition using a scale of 0 – 5:
  - 5** - A healthy, vigorous tree, reasonably free of signs and symptoms of disease, with good structure and form typical of the species.
  - 4** - Tree with slight decline in vigor, small amount of twig dieback, minor structural defects that could be corrected.
  - 3** - Tree with moderate vigor, moderate twig, and small branch dieback, thinning of crown, poor leaf color, moderate structural defects that might be mitigated with regular care.
  - 2** - Tree in decline, epicormic growth, extensive dieback of medium to large branches, significant structural defects that cannot be abated.
  - 1** - Tree in severe decline, dieback of scaffold branches and/or trunk; most of foliage from epicormics; extensive structural defects that cannot be abated.
  - 0** - Tree is dead.
5. Rating the suitability for preservation as “high”, “moderate” or “low”. Suitability for preservation considers the health, age and structural condition of the tree, and its potential to remain an asset to the site for years to come.

**High:** Trees with good health and structural stability that have the potential for longevity at the site.

**Moderate:** Trees with somewhat declining health and/or structural defects that can be abated with treatment. The tree will require more intense management and monitoring, and may have shorter life span than those in ‘good’ category.

**Low:** Trees in poor health or with significant structural defects that cannot be mitigated. Trees are expected to continue to decline, regardless of treatment. The species or individual may have characteristics that are undesirable for landscapes, and generally are unsuited for use areas.

**Description of Trees**

One hundred and seventy (170) trees were assessed, representing 20 species (Table 1). Coast redwood was the most common species with 42 trees, followed by Callery pear with 27 and Chinese pistache with 23. No other species was represented by more than 16 trees. All trees encountered had been installed as landscaping. None appeared indigenous to the site. Overall, 72 trees were in good condition, 58 were fair, 39 were poor, and tree #16 was dead (Table 1). Trees #146 – 170 were street trees in the public right-of-way along Rincon Avenue, San Tomas Aquino Road, or Bucknall Road.

Descriptions of each tree are found in the **Tree Assessment Form** and approximate locations are shown on the **Tree Assessment Map** (see Exhibits).

**Table 1: Condition ratings and frequency of occurrence of trees  
 Harker Bucknall Multi-Purpose Billing, San Jose CA**

Common Name	Scientific Name	Condition				Total
		Dead (0)	Poor (1-2)	Fair (3)	Good (4-5)	
Red maple	<i>Acer rubrum</i>	-	-	-	1	1
African fern-pine	<i>Afrocarpus falcatus</i>	-	1	7	-	8
Deodar cedar	<i>Cedrus deodara</i>	-	-	2	2	4
Chinese hackberry	<i>Celtis sinensis</i>	-	1	15	-	16
Fig	<i>Ficus carica</i>	-	-	1	-	1
Evergreen ash	<i>Fraxinus uhdei</i>	-	-	3	-	3
Cajeput paperbark tree	<i>Melaleuca quinquenervia</i>	-	5	1	-	6
Canary Island date palm	<i>Phoenix canariensis</i>	-	-	-	1	1
Colorado blue spruce	<i>Picea pungens</i> 'Glauca'	-	-	1	-	1
Chinese pistache	<i>Pistacia chinensis</i>	-	14	4	5	23
London plane	<i>Platanus x hispanica</i>	-	-	2	6	8
Plum	<i>Prunus domestica</i>	-	-	1	-	1
Callery pear	<i>Pyrus calleryana</i>	-	4	14	9	27
Pear	<i>Pyrus communis</i>	-	-	1	-	1
Cork oak	<i>Quercus suber</i>	-	-	-	2	2
Pepper tree	<i>Schinus molle</i>	-	-	-	2	2
African sumac	<i>Searsia lancea</i>	1	-	-	7	8
Coast redwood	<i>Sequoia sempervirens</i>	-	1	4	37	42
Chinese elm	<i>Ulmus parvifolia</i>	-	-	2	-	2
Siberian elm	<i>Ulmus pumila</i>	-	13	-	-	13
<b>Total</b>		<b>1</b>	<b>39</b>	<b>58</b>	<b>72</b>	<b>170</b>

Of the 41 coast redwoods, 37 were in good condition while four were fair and #62 was poor. Condition varied with tree health, signs of water stress, and overall vigor. Redwoods in good condition had full, dense crowns (Photo 1). Fair condition redwoods had slightly thin foliage and moderate structural deficiencies such as a sweeping trunk and/or codominant trunks. Redwood #62 had more severe thinning. Development stage was a mix of young to mature, indicated by individual trunk diameters ranging from 8 to 57 inches. Most were intermediate with diameters between 20 – 25 inches, located in a dense row along the perimeter of the sports field.

**Photo 1:** Coast redwoods #93 – 95 (left – right) were in good condition.



Twenty-seven (27) Callery pears were distributed throughout the parking lots. Development stage was mostly mature, indicated by an average diameter of 17 inches. Fourteen (14) were in fair condition, nine were good, and four were poor. Several stems arose from a single attachment point on most pears, which is a common condition for the species (Photo 2). Pears in good condition had fewer compounding conditions than those in fair,

**Photo 2:** Several narrowly attached stems arose from a single point on the trunk of Callery pear #97.

such as moderate fire blight or mistletoe infestation. Pears in poor condition had more serious structural deficiencies like decay in the trunk or a severe lean.

Twenty-three (23) Chinese pistache were assessed. Of these, nine (#162 – 170) were street trees along Bucknall Road. The street trees were either in good (five trees) or fair (4 trees) condition, largely dependent on suppression from nearby larger trees (Photo 3). The 14 pistache located within the campus were uniformly in poor condition, having been repeatedly topped. Diameters ranged between 7 – 12 inches.

**Photo 3:** Chinese pistache #168 was in fair condition, having developed a one-sided crown due to competition for space with a nearby redwood.



Sixteen (16) Chinese hackberries were street trees along Rincon Avenue. Thirteen (13) were in fair condition, having multiple attachments at approximately 6-feet and being moderately suppressed by the row of larger redwoods along the field to the north. Hackberry #151 was in poor condition with a history of stem failure. All were semi-mature in development with diameters between 6 – 12 inches.

Thirteen (13) Siberian elms were located along the west property line. All were in very poor condition, and had been disfigured by a history of severe topping. Many topping cuts had been colonized by decay. Diameters ranged from 15 – 23 inches.

Eight African fern-pines were foundation plantings at the edge of several buildings. Of these, seven were in fair condition with two or more stems arising between 5 – 7 feet and a dense, asymmetric crown. Fern-pine #107 had been severely topped and was in poor condition. Diameters ranged from 8 to 17 inches



Eight small African sumacs, 5 inches in diameter or smaller, were located along the west fence line (Photo 4). Seven were good, young trees with good vigor and structure. Sumac #16 was dead.

**Photo 4:** African sumac #17 was a good, young tree.

Of the eight London planes, six were in good condition and #139 and 140 were fair. Planes in good condition had good decurrent structure with several scaffold branches and well-distributed lateral branching. Trees in fair condition appeared vigorous, but had been topped for high-voltage line clearance. Development stage was semi-mature, with diameters between 8 – 16 inches.

Six cajeput paperbark trees were either in fair (#48) or poor (five trees) condition. Most had high crowns with foliage concentrated at the top of the tree.

The remaining 11 species were represented by four trees or fewer:

- Deodar cedars #3 and 6 were in fair condition while #5 and 65 were good. The cedars in good condition had a strong central leader and well-distributed lateral branching. The cedars in fair condition had structural deficiencies such as a history of topping (tree #3) or codominant attachments with included bark in the union (tree #6).
- Evergreen ash ##4, 10, and 26 were in fair condition. All had multiple narrow attachments at approximately seven feet above grade and were located in small landscape areas in the parking lot. Diameters measured 11 – 15 inches.
- Cork oaks #109 and 124 were mature in development, measuring 31 and 26 inches in diameter, respectively. The trees were prominent design elements in their respective areas of the campus. Both had good, decurrent structure with several, large scaffold branches and well-distributed lateral branching. Vigor appeared good.

**Photo 5:** Cork oak #109 was in good condition with a well-structured, decurrent growth habit.



- Pepper trees #59 and 68 both had 38-inch diameter trunks and were in good condition. Codominant stems arose from attachments at approximately 6 – 8 feet to form spreading, weeping crowns.
- Chinese elms #28 and 136 measured 20 and 18 inches in diameter, respectively. Both had sinuous trunks and a spreading, vase-shaped crown.
- Red maple #105 had a 5-inch diameter trunk and a columnar form created by tight branching structure. Condition was good overall.
- Fig #64 was in fair condition and had developed a one-sided crown to the west due to suppression from the nearby, larger redwoods. Diameter measured 5 inches.
- Canary Island date palm #38 had a 32-inch diameter trunk and approximately 18 feet of brown trunk beneath the lowest living frond. It was in good condition.
- Colorado blue spruce #138 was in fair condition. The 16-inch diameter trunk bifurcated at a narrow codominant union at 6 feet to form a narrow crown. Mild twig dieback was visible.
- Codominant stems arose from 2 feet on plum #135, measuring 4 and 3 inches. Overall condition was fair.
- Pear #134 was located in a fenced play area. Several stems arose from approximately 3 feet measuring between 2 – 6 inches.

### ***City of San Jose Tree Protection Requirements***

The City of San Jose Municipal Code 13.32 defines all trees, living or dead, with a trunk circumference of 38 inches or greater (12 inches diameter) as an *Ordinance Sized Tree*. Individual trunk circumferences are combined for multi-stemmed trees. *Street trees* of any size are protected under Municipal Code 13.28. *Ordinance Sized* and *Street trees* require a permit for removal. Removing a “tree of any size” requires a permit and tree replacement for multifamily, commercial, and industrial properties. To my knowledge, Harker Bucknall School does not fit that definition, and removal of non-Ordinance Sized trees outside the public right-of-way does not require mitigation.

Ninety-nine (99) trees were large enough to be considered *Ordinance Sized*, and 25 trees were *Street Trees*. Neither class may not be removed without a permit. Protected status individual trees are provided in the ***Tree Assessment Form*** (see exhibits).

### ***Suitability for Preservation***

Before evaluating the impacts that will occur during development, it is important to consider the quality of the tree resource itself, and the potential for individual trees to function well over an extended length of time. Trees that are preserved on development sites must be carefully selected to make sure that they may survive development impacts, adapt to a new environment and perform well in the landscape.

Our goal is to identify trees that have the potential for long-term health, structural stability, and longevity. For trees growing in open fields, away from areas where people and property are present, structural defects and/or poor health present a low risk of damage or injury if they fail.

We must be concerned, however, about safety in use areas. Therefore, where development encroaches into existing plantings, we must consider their structural stability as well as their potential to grow and thrive in a new environment. Where development will not occur, the normal life cycles of decline, structural failure, and death should be allowed to continue.

Evaluation of suitability for preservation considers several factors:

- **Tree health**  
Healthy, vigorous trees are better able to tolerate impacts such as root injury, demolition of existing structures, changes in soil grade and moisture, and soil compaction than non-vigorous trees are. For example, all Siberian elms were in very poor condition. They would not tolerate site changes well.
- **Structural integrity**  
Trees with significant amounts of wood decay and other structural defects that cannot be corrected are more likely to fail. Such trees should not be preserved in areas where damage to people or property is likely.
- **Species response**  
There is a wide variation in the response of individual species to construction impacts and changes in the environment. For example, coast redwood is tolerant of root severance and general construction impacts. Callery pear and deodar cedar are intolerant. Chinese hackberry and Chinese pistache are moderate in response.
- **Tree age and longevity**  
Old trees, while having significant emotional and aesthetic appeal, have limited physiological capacity to adjust to an altered environment. Young trees are better able to generate new tissue and respond to change.

- **Invasiveness**

Species which spread across a site and displace desired vegetation are not always appropriate for retention. This is particularly true when indigenous species are displaced. The California Invasive Plant Inventory Database (<https://www.cal-ipc.org/paf/>) lists species identified as being invasive. San Jose is part of the Central Western California Region of the California Floristic Province. Fig has moderate invasive potential. Pepper tree and Canary Island date palm have limited potential.

Each tree was rated for suitability for preservation based upon its age, health, structural condition, and ability to safely coexist within a development environment (Table 2).

**Table 2: Tree suitability for preservation.  
Harker Bucknall Multi-Purpose Building**

---

<b>High</b>	Trees in good health and with structural stability that have the potential for longevity at the site. Twenty-two (21) trees had high suitability for preservation: seven African sumacs, Canary Island date palm #38, cork oaks #109 and 124, deodar cedars #5 and 64, six London planes, pepper trees #49 and 68, and red maple #105.
<b>Moderate</b>	Trees in fair health and/or with structural defects that may be abated with treatment. Trees in this category require more intense management and monitoring, and may have shorter lifespans than those in the “high” category. One hundred and three (103) trees had moderate suitability for preservation: seven African fern-pines, cajeput paperbark #48, Chinese elms #28 and 136, 15 Chinese hackberries, nine Chinese pistache, 41 coast redwoods, Colorado blue spruce #138, deodar cedars #3 and 6, evergreen ash #4 and 10, fig #63, London planes #139 and 140, pear #134, and plum #135.
<b>Low</b>	Trees in poor health or with significant defects in structure that cannot be abated with treatment. These trees can be expected to decline regardless of management. The species or individual tree may possess either characteristics that are undesirable in landscape settings or be unsuited for use areas. Forty-five (45) trees had low suitability for preservation: African fern-pine #107, five cajeput paperbarks, nine Callery pears, Chinese hackberry #151, Chinese pistache #14, coast redwood #62, evergreen ash #26, and 13 Siberian elms.

---

**Note:** African sumac #16 was dead and excluded from this consideration.

We consider trees with high suitability for preservation to be the best candidates for preservation. Retention of trees with moderate or low suitability for preservation depends upon the intensity of proposed site changes and the use nature of the site.

### ***Preliminary Evaluations of Impacts and Recommendations***

Appropriate tree retention develops a practical match between the location and intensity of construction activities with the quality and health of trees. The **Tree Assessment** was the reference point for tree condition and quality. Impacts from construction were estimated using a conceptual site plan (*Landscape Coordination, SWA, dated 12/3/2024*). As such, this evaluation of impacts is preliminary.

The site plan depicted proposed improvements throughout most of the campus. A large, multi-purpose building is proposed to be installed in the existing Rincon field along with an associated parking lot and new driveways connected to Rincon Avenue. The existing library in the northwest will be demolished and existing parking will be expanded in its place. The existing parking lot in the northeast will be reduced in size and replaced by a new sports field. The Central Courtyard and West Dining areas will be significantly redesigned, affecting existing trees and landscaping. Building 500, located on the east side of the site, will be extended. Sidewalks on all sides of the site will be replaced.

Impacts to trees in the areas proposed for new construction will be severe. First, demolition of existing infrastructure and landscape may damage trees. Second, grading, excavation, and other construction activities will injure trees, both directly by mechanical injury and indirectly by altering drainage. Finally, existing trees may be within areas planned for new structures.

Based on my review of the plans, 72 trees will be removed (37 Ordinance Sized and four Street Trees) and 77 will be preserved (62 Ordinance Sized). I have identified the 21 *Street Trees* located in the public right-of-way for potential preservation (see **Preliminary Disposition** table in Exhibits).

Of the 72 trees to be removed (37 *Ordinance Sized* and four *Street Trees*):

- Fifty (50) trees were within the proposed footprint of improvements, including the multi-purpose building, expanded parking lots, curb cuts for access to Rincon Avenue, and new concrete pavers. Given the proposed design, the trees cannot be preserved.
- Twenty-one (21) trees were at the edge of impacts such as the building 500 extension, curb cuts for new driveways, or in severely reduced landscape areas. I expect impacts to exceed the tolerance of the trees.
- Tree #16 was dead.

Of the 77 trees to be preserved (62 *Ordinance Sized*):

- Forty (40) trees appear to be outside the project area. I expect impacts to be negligible if not mechanically damaged by equipment.
- Twenty-six (26) trees appear to be at the edge of proposed improvements, with the existing edge of the root area to be preserved or expanded. If the root area is not reduced, I expect impacts to be minor and within the tolerance of the trees.
- Eight trees (#41 – 45 and 137 – 139) are at the edge to the new sports field. Currently, the area is a parking lot, and I expect few roots to be encountered during the conversion. I expect impacts to be moderate and within their tolerances.
- Three trees (#46, 47, and 68) are between approximately 8 – 15 feet from new paving or the building 500 extension. I expect impacts to be mild to moderate and within their tolerances.

Of the 21 *Street Trees* identified for potential preservation:

- The curb, gutter, and sidewalk are proposed for replacement near 21 trees (#146, 147, 150 – 152, 155 – 170). Impacts to the trees will occur during demolition and any necessary excavation in the process of construction of new curbs, sidewalk, or gutters along road edges. Due to the imprecise nature of the preliminary plans and the nature of the interaction between tree roots and adjacent hardscape, it is difficult to determine the severity of construction impacts to the trees in the public right-of-way along Bucknall Road and Rincon Avenue before demolition has occurred and roots can be inspected.

Successful retention of the trees to be preserved will depend on the care with which work is performed around the trees and all parties committing to the **Preliminary Tree Preservation Guidelines**.

**San Jose Tree Mitigation Requirements**

The City of San Jose requires mitigation for trees removed on development sites. The species and exact number of trees to be planted on the site will be determined in consultation with the City Arborist and the Department of Planning, Building, and Code Enforcement.

All *Ordinance Sized* and *Street Trees* that are to be removed shall be replaced at the following ratios. Note that the subject property is a school, and does not appear subject to the requirement to replace every removed “tree of any size” on multifamily, commercial, and industrial properties. I recommend that this be confirmed with the City.

Circumference of Tree to be Removed (measured at 4.5 feet above ground)	Type of Tree to be Removed			Minimum Size of Each Replacement Tree
	Native	Non-Native	Orchard	
38 inches or greater	5:1	4:1	3:1	15-gallon container
19 – 38 inches	3:1	2:1	none	15-gallon container
less than 19 inches	1:1	1:1	none	15-gallon container

x:x = tree replacement to tree loss ratio

**Note:** Trees with a circumference of greater than or equal to 38” (=12.1” diameter) shall not be removed unless a Tree Removal Permit, or equivalent, has been approved for the removal of such trees.

One 24-inch box tree = two 15-gallon container trees.

The 37 *Ordinance Sized* and four *Street Trees* that require replacements were categorized by provenance (native, non-native, or orchard) and trunk circumference to estimate tree mitigation. Mitigation measures require **169 replacement trees** (15-gallon containers). Individual mitigation measures are described in **San Jose Replacement Calculations** (see **Attachments**). Replacement totals may change once disposition of the 21 *Street Trees* identified for potential preservation is determined.

### **Alternative Mitigation Measures**

In the event the project site does not have sufficient area to accommodate the required tree mitigation, one or more of the following measures may be implemented, to the satisfaction of the City's Environmental Principal Planner, at the development permit stage:

- The size of a 15-gallon replacement tree can be increased to 24-inch box and count as two replacement trees.
- An alternative site(s) will be identified for additional tree planting. Alternative sites may include local parks or schools or installation of trees on adjacent properties for screening.
- A donation of \$775 per mitigation tree to The City of San Jose for in-lieu off-site tree planting in the community. These funds will be used for tree planting and maintenance of planted trees for approximately three years. A donation receipt for off-site tree planting will be provided to the Planning Project Manager prior to issuance of a development permit.

### **Preliminary Tree Preservation Guidelines**

The following recommendations will help reduce impacts to trees from development as well as maintain and improve their health and vitality through the clearing, grading, and construction phases. The key elements of a tree preservation plan for the Harker Bucknall Multi-Purpose Building project would include:

- Establishing **Tree Protection Zones (TPZ)** for each tree to be preserved. **Tree Protection Zones** are identified by the Consulting Arborist based on species tolerances, tree condition, trunk diameters and the nature and proximity of the proposed disturbance. For design purposes, **Tree Protection Zones** for trees to be preserved shall be the dripline in all directions or the nearest edge of proposed work. **Tree Protection Zones** for *Street Trees* shall be the edge of the tree well.
  - A **Tree Protection Zone** shall be identified for each tree to be preserved on the Tree Protection Plan prepared by the project arborist.
  - Tree protection fences shall be installed to encompass the **Tree Protection Zone**. Fences shall be 6-foot-tall chain link with posts sunk into the ground or equivalent as approved by the City.
  - Fences must be installed prior to beginning demolition and must remain until construction is complete.
  - No grading, excavation, construction, or storage or dumping of materials shall occur within the **Tree Protection Zone**.
  - No underground services including utilities, sub-drains, water or sewer shall be placed in the Tree Protection Zone.
  - Fenced areas shall be posted with signs stating, "TREE PROTECTION FENCE – DO NOT MOVE OR REMOVE WITHOUT APPROVAL FROM CITY ARBORIST".
- Surveying accurate trunk locations to determine proximity to proposed impacts and of trees near proposed improvements, particularly those identified for preservation. Reevaluate impacts once trees are surveyed.
- Determining impacts to the 21 *Street Trees* located in the public right-of-way that were identified for potential preservation. Until demolition of the current hardscape occurs, it will not be possible to fully determine the likelihood of the trees' survival. Special care must be taken during sidewalk and curb demolition. I recommend an inspection by a

qualified Arborist whenever roots exceeding 2 inches in diameter are encountered during either demolition of old hardscape or excavation for new hardscape. If roots of this size must be cut, tree disposition should be reevaluated on a case-by-case basis as the construction process occurs.

### Design recommendations

1. All revised plans depicting improvements near trees shall be reviewed by the Consulting Arborist regarding tree impacts. These include, but are not limited to, site plans, improvement plans, utility and drainage plans, grading plans, landscape and irrigation plans, and demolition plans.
2. Twenty-six (26) trees appear to be at the edge of proposed improvements, with the existing edge of the root area to be preserved or expanded. Where possible, preserve the existing curb instead of demolishing and replacing. Where the curb must be demolished, plan to conduct the work by hand.
3. Irrigation systems must be designed so that no trenching severs roots larger than 1 inch in diameter within the Tree Protection Zone.
4. Tree Preservation Guidelines prepared by the Project Arborist, which include specifications for tree protection during demolition and construction, must be included within the plan set. Reference to the Arborist Report is not sufficient.

### Pre-demolition and pre-construction treatments and recommendations

1. The demolition contractor shall meet with the Consulting Arborist before beginning work to discuss work procedures and tree protection.
2. Fence all trees to be retained to completely enclose the **Tree Protection Zone** prior to demolition, grubbing, or grading. Fences are to remain in place until all construction is completed.
3. The 21 *Street Trees* in the public right-of-way will require trunk protection during demolition of the existing hardscape and construction of the renovated sidewalk. This may be created by enclosing the entire planter in 6-foot-tall wooden fencing wrapped in orange snow fencing (Figure 1).

**Figure 1:** An example of trunk protection measures in the public right-of-way.



4. Trees to be preserved may require pruning. All pruning shall be done by a State of California Licensed Tree Contractor (C61/D49). Ensure all pruning is done by Certified Arborist or Certified Tree Worker in accordance with the latest edition of the Best Management Practices for Pruning

- (International Society of Arboriculture), and adheres to the most recent editions of the American National Standard for Tree Care Operations (Z133.1) and Pruning (A300). The Consulting Arborist will provide pruning specifications prior to site demolition upon request. Branches extending into the work area that can remain following demolition should be tied back and protected from damage where possible.
5. Trees to be removed that have branches extending into the canopy of tree(s) or located within the **Tree Protection Zone** of trees to remain shall be removed by a Certified Arborist or Certified Tree Worker and not by the demolition contractor. The Certified Arborist or Certified Tree Worker shall remove the trees in a manner that causes no damage to the trees and understory to remain. Stumps shall be ground below grade.
  6. Trees to be removed shall be felled to fall away from **Tree Protection Zone** and avoid pulling and breaking of roots of trees to remain. If roots are entwined, the Consulting Arborist may require first severing the major woody root mass before extracting the trees, or grinding the stump below ground.
  7. All down brush and trees shall be removed from the **Tree Protection Zone** either by hand, or with equipment sitting outside the **Tree Protection Zone**. Extraction shall occur by lifting the material out, not by skidding across the ground. Brush shall be chipped and spread beneath the trees within the **Tree Protection Zone**.
  8. All tree work shall comply with the Migratory Bird Treaty Act as well as California Fish and Wildlife code 3503-3513 to not disturb nesting birds. Tree pruning and removal should be scheduled outside of the breeding season to avoid scheduling delays. Breeding bird surveys should be conducted prior to tree work. Qualified biologists should be involved in establishing work buffers for active nests.

#### **Recommendations for tree protection during construction**

1. Prior to beginning work, the contractors working in the vicinity of trees to be preserved are required to meet with the Consulting Arborist at the site to review all work procedures, access routes, storage areas and tree protection measures.
2. All contractors shall conduct operations in a manner that will prevent damage to trees to be preserved.
3. Any demolition or excavation work that is expected to encounter tree roots should be monitored by the Consulting Arborist.
4. Tree protection measures are to remain until all sitework has been completed. Protection may not be relocated or removed without permission of the Consulting Arborist.
5. Construction trailers, traffic, and storage areas must always remain outside Tree Protection Zones areas.
6. If injury should occur to any tree during construction, it should be evaluated as soon as possible by the Consulting Arborist so that appropriate treatments can be applied.
7. Any root pruning required for construction purposes shall receive prior approval of and be supervised by the Project Arborist. Roots should be cut with a saw to provide a flat and smooth cut. Removal of roots larger than 2 inches in diameter should be avoided.
8. If roots 2 inches and greater in diameter are encountered during site work and must be cut to complete the construction, the Project Arborist must be consulted to evaluate the effects on the health and stability of the tree and recommend treatment.

9. Spoil from trench, footing, utility, or other excavation shall not be placed within the Tree Protection Zone, neither temporarily nor permanently.
10. All grading within the dripline of trees shall be done using the smallest equipment possible. The equipment shall operate perpendicular to the tree and operate from outside the Tree Protection Zone. Any modifications must be approved and monitored by the Project Arborist.
11. No excess soil, chemicals, debris, equipment, or other materials shall be dumped or stored within the Tree Protection Zone.
12. Any additional tree pruning needed for clearance during construction must be performed by a Certified Arborist and not by construction personnel.
13. All trees shall be irrigated on a schedule to be determined by the Consulting Arborist (every 3 to 6 weeks is typical). Each irrigation shall wet the soil within the **Tree Protection Zone** to a depth of 30 inches. This will be particularly important for the coast redwoods during the dry season.

#### **Maintenance of impacted trees**

Preserved trees will experience a physical environment different from that pre-development. As a result, tree health and structural stability should be monitored. Occasional pruning, fertilization, mulch, pest management, replanting and irrigation may be required. In addition, provisions for monitoring both tree health and structural stability following construction must be made a priority. Inspect trees annually and following major storms to identify conditions requiring treatment to manage risk associated with tree failure.

Our procedures included assessing trees for observable defects in structure. This is not to say that trees without significant defects will not fail. Failure of apparently defect-free trees does occur, especially during storm events. Wind forces, for example, can exceed the strength of defect-free wood causing branches and trunks to break. Wind forces coupled with rain can saturate soils, reducing their ability to hold roots, and blow over defect-free trees. Although we cannot predict all failures, identifying those trees with observable defects is a critical component of enhancing public safety.

Furthermore, trees change over time. Our inspections represent the condition of the tree at the time of inspection. As trees age, the likelihood of failure of branches or entire trees increases. Annual tree inspections are recommended to identify changes to tree health and structure. In addition, trees should be inspected after storms of unusual severity to evaluate damage and structural changes. Initiating these inspections is the responsibility of the client.

If you have any questions about my observations or recommendations, please contact me.

#### **HortScience | Bartlett Consulting**



Ryan Suttle, Consulting Arborist & Urban Forester  
ISA Board Certified Master Arborist, Utility Specialist No. WE-12647BU  
ISA Tree Risk Assessment Qualified  
ASCA Registered Consulting Arborist #813



## **Exhibits**

---

**Tree Assessment Form**

**Tree Assessment Map**

**Preliminary Tree Disposition**

**San Jose Replacement Calculations**



# Tree Assessment

Harker Bucknall  
San Jose, CA  
January 2025



Tree No.	Species	Trunk Diameter (in.)	Protected Tree?	Condition 0=dead 5=excellent	Suitability for Preservation	Comments
1	Callery pear	11	No	4	Moderate	5' planter; multiple narrow attachments at 7 feet; moderate fire
2	Callery pear	12	Ordinance Sized	3	Moderate	5' planter; multiple narrow attachments at 7 feet; moderate fire blight.
3	Deodar cedar	18	Ordinance Sized	3	Moderate	Slightly thin; topped; reduction cuts on laterals.
4	Evergreen ash	15	Ordinance Sized	3	Moderate	Multiple narrow attachments at 7 feet; asymmetric S.
5	Deodar cedar	5	No	4	High	Good young tree.
6	Deodar cedar	34	Ordinance Sized	3	Moderate	Candelabra; included bark in attachments at 8 and 10 feet.
7	London plane	13	Ordinance Sized	4	High	3 feet from curb; raised crown over building; good structure.
8	London plane	16	Ordinance Sized	4	High	3 feet from curb; raised crown over building; good structure.
9	London plane	14	Ordinance Sized	4	High	4 foot planting strip; good structure with defined leader; large surface roots.
10	Evergreen ash	11	No	3	Moderate	4' planter; multiple narrow attachments at 7 feet; small crown.
11	Callery pear	12	Ordinance Sized	3	Low	5' planter; multiple narrow attachments at 7 feet; moderate fire blight; topped under light fixture.
12	Callery pear	11	No	3	Low	5' planter; multiple narrow attachments at 7 feet; moderate fire
13	Callery pear	10	No	3	Low	5' planter; multiple narrow attachments at 7 feet; moderate fire
14	Callery pear	12	Ordinance Sized	3	Low	5' planter; multiple narrow attachments at 7 feet; moderate fire blight.
15	African sumac	5	No	4	High	Multiple attachments between 4-5 feet; sinuous branching; good vigor.
16	African sumac	5	No	0		Dead.
17	African sumac	5	No	4	High	Multiple attachments between 4-5 feet; sinuous branching; good vigor.

# Tree Assessment

Harker Bucknall  
San Jose, CA  
January 2025



Tree No.	Species	Trunk Diameter (in.)	Protected Tree?	Condition 0=dead 5=excellent	Suitability for Preservation	Comments
18	African sumac	5	No	4	High	Multiple attachments between 4-5 feet; sinuous branching; good vigor.
19	African sumac	5	No	4	High	Multiple attachments between 4-5 feet; sinuous branching; good vigor.
20	African sumac	5	No	4	High	Multiple attachments between 4-5 feet; sinuous branching; good vigor.
21	African sumac	5	No	4	High	Multiple attachments between 4-5 feet; sinuous branching; good vigor.
22	African sumac	4	No	4	High	Multiple attachments between 4-5 feet; sinuous branching; good vigor.
23	Callery pear	15	Ordinance Sized	4	Moderate	At edge of walkway; multiple narrow attachments at 7 feet; good vigor.
24	Callery pear	15	Ordinance Sized	4	Moderate	At edge of walkway; multiple narrow attachments at 7 feet; good vigor; small amount of mistletoe.
25	Callery pear	12	Ordinance Sized	2	Low	At edge of walkway; bow N with base outside dripline; poor structure.
26	Evergreen ash	15	Ordinance Sized	3	Low	Multiple narrow attachments at 7 feet; epicormic sprouting; swollen root flare.
27	Callery pear	12	Ordinance Sized	3	Moderate	Parking lot planter; multiple narrow attachments at 7 feet; heading cuts for light fixture; moderate fire blight.
28	Chinese elm	20	Ordinance Sized	3	Moderate	Codominant at 5 feet; vase-shaped; at edge of new curb; history of large branch removal.
74	Coast redwood	8	No	4	Moderate	Row at edge of field; crowded with neighbor.
35	Coast redwood	11	No	4	Moderate	Good young tree.
36	Coast redwood	12	Ordinance Sized	4	Moderate	Good young tree.
32	Callery pear	12	Ordinance Sized	2	Low	Multiple narrow attachments at 6-7 feet; good vigor; moderate fire blight.
60	Coast redwood	12	Ordinance Sized	4	Moderate	Good young tree; high voltage lines to E.

# Tree Assessment

Harker Bucknall  
San Jose, CA  
January 2025



Tree No.	Species	Trunk Diameter (in.)	Protected Tree?	Condition 0=dead 5=excellent	Suitability for Preservation	Comments
64	Coast redwood	14	Ordinance Sized	4	Moderate	Good young tree; high voltage lines to E.
30	Coast redwood	15	Ordinance Sized	4	Moderate	Good vigor; codominant at top.
67	Coast redwood	15	Ordinance Sized	4	Moderate	Good young tree; edge of tented seating area.
37	Callery pear	12	Ordinance Sized	2	Low	Multiple narrow attachments at 6-7 feet; good vigor; moderate fire blight; mild mistletoe.
38	Canary Island date palm	32	Ordinance Sized	4	High	18 feet brown trunk; good vigor; shaved pineapple.
39	Callery pear	12	Ordinance Sized	3	Moderate	Multiple narrow attachments at 6-7 feet; just outside fence.
40	Callery pear	12	Ordinance Sized	3	Moderate	Multiple narrow attachments at 6-7 feet; just outside fence.
41	Callery pear	12	Ordinance Sized	3	Moderate	Multiple narrow attachments at 6-7 feet; just outside fence; heaving curb wall.
42	Callery pear	14	Ordinance Sized	3	Moderate	Multiple narrow attachments at 6-7 feet; moderate fire blight; just outside fence before curb; narrow crown.
43	Callery pear	15	Ordinance Sized	3	Moderate	Multiple narrow attachments at 6-7 feet; moderate fire blight; just outside fence before curb; heaving curb wall.
44	Callery pear	11	No	3	Moderate	Multiple narrow attachments at 6-7 feet; moderate fire blight; just outside fence before curb; heaving curb wall.
45	Callery pear	16	Ordinance Sized	3	Moderate	Multiple narrow attachments at 6-7 feet; moderate fire blight; just outside fence before curb; heaving curb wall.
46	African fern-pine	8	No	3	Moderate	Narrow form; edge of building.
47	African fern-pine	16	Ordinance Sized	3	Moderate	Codominant at 5 and 7 feet; one-sided N; at edge of building.
48	Cajeput paperbark tree	6	No	3	Moderate	High narrow crown; surface roots; at edge of building.
49	Cajeput paperbark tree	9	No	2	Low	High narrow crown; surface roots; topped; at edge of building.

# Tree Assessment

Harker Bucknall  
San Jose, CA  
January 2025



Tree No.	Species	Trunk Diameter (in.)	Protected Tree?	Condition 0=dead 5=excellent	Suitability for Preservation	Comments
50	Cajeput paperbark tree	9	No	2	Low	High narrow crown; surface roots; topped; at edge of pool
51	Chinese pistache	8	No	2	Low	Repeatedly topped; in 4 foot planter.
52	Chinese pistache	10	No	2	Low	Repeatedly topped; in 4 foot planter.
53	Chinese pistache	9	No	2	Low	Repeatedly topped; in 4 foot planter.
54	Chinese pistache	8	No	2	Low	Repeatedly topped; in 4 foot planter.
55	Chinese pistache	9	No	2	Low	Repeatedly topped; in 4 foot planter.
56	Chinese pistache	8	No	2	Low	Repeatedly topped; in 4 foot planter.
57	Chinese pistache	9	No	2	Low	Repeatedly topped; in 4 foot planter.
58	Chinese pistache	7	No	2	Low	Repeatedly topped; in 4 foot planter.
59	Pepper tree	38	Ordinance Sized	4	High	Large butler base; wide codominant at 8 feet; spreading, weeping crown.
79	Coast redwood	19	Ordinance Sized	4	Moderate	Row at edge of field; crowded with neighbor.
61	Coast redwood	20	Ordinance Sized	4	Moderate	Good young tree; high voltage lines to E.
71	Coast redwood	20	Ordinance Sized	4	Moderate	Row at edge of field; crowded with neighbor.
63	Fig	5	No	3	Moderate	Crowded understory tree; one-sided W.
70	Coast redwood	21	Ordinance Sized	4	Moderate	Row at edge of field; crowded with neighbor.
65	Deodar cedar	27	Ordinance Sized	4	High	Near stairwell; strong central leader; laterals over building.
77	Coast redwood	21	Ordinance Sized	4	Moderate	Row at edge of field; crowded with neighbor.
85	Coast redwood	21	Ordinance Sized	4	Moderate	Row at edge of field; crowded with neighbor.
68	Pepper tree	38	Ordinance Sized	4	High	Large burlled base; wide codominant at 6 feet; spreading, weeping crown; some decay in trunk.

# Tree Assessment

Harker Bucknall  
San Jose, CA  
January 2025



Tree No.	Species	Trunk Diameter (in.)	Protected Tree?	Condition 0=dead 5=excellent	Suitability for Preservation	Comments
86	Coast redwood	21	Ordinance Sized	4	Moderate	Row at edge of field; crowded with neighbor.
88	Coast redwood	21	Ordinance Sized	4	Moderate	Row at edge of field; crowded with neighbor.
72	Coast redwood	22	Ordinance Sized	4	Moderate	Row at edge of field; crowded with neighbor.
75	Coast redwood	22	Ordinance Sized	4	Moderate	Row at edge of field; crowded with neighbor.
87	Coast redwood	22	Ordinance Sized	4	Moderate	Row at edge of field; crowded with neighbor.
93	Coast redwood	22	Ordinance Sized	4	Moderate	Row at edge of field; crowded with neighbor.
94	Coast redwood	22	Ordinance Sized	4	Moderate	Row at edge of field; crowded with neighbor.
31	Coast redwood	23	Ordinance Sized	4	Moderate	Good vigor; asymmetric N.
80	Coast redwood	23	Ordinance Sized	4	Moderate	Row at edge of field; crowded with neighbor.
82	Coast redwood	23	Ordinance Sized	4	Moderate	Row at edge of field; crowded with neighbor.
83	Coast redwood	23	Ordinance Sized	4	Moderate	Row at edge of field; crowded with neighbor.
89	Coast redwood	23	Ordinance Sized	4	Moderate	Row at edge of field; crowded with neighbor.
90	Coast redwood	23	Ordinance Sized	4	Moderate	Row at edge of field; crowded with neighbor; small crossing roots N.
92	Coast redwood	23	Ordinance Sized	4	Moderate	Row at edge of field; crowded with neighbor.
29	Coast redwood	24	Ordinance Sized	3	Moderate	Slightly thin; codominant at 20 feet.

# Tree Assessment

Harker Bucknall  
San Jose, CA  
January 2025



Tree No.	Species	Trunk Diameter (in.)	Protected Tree?	Condition 0=dead 5=excellent	Suitability for Preservation	Comments
78	Coast redwood	24	Ordinance Sized	4	Moderate	Row at edge of field; crowded with neighbor.
81	Coast redwood	24	Ordinance Sized	4	Moderate	Row at edge of field; crowded with neighbor.
84	Coast redwood	24	Ordinance Sized	4	Moderate	Row at edge of field; crowded with neighbor.
91	Coast redwood	25	Ordinance Sized	4	Moderate	Row at edge of field; crowded with neighbor.
76	Coast redwood	27	Ordinance Sized	4	Moderate	Row at edge of field; crowded with neighbor.
33	Coast redwood	28	Ordinance Sized	4	Moderate	Good vigor; asymmetric S.
95	Coast redwood	28	Ordinance Sized	4	Moderate	Row at edge of field; crowded with neighbor; crossing surface roots.
34	Coast redwood	30	Ordinance Sized	4	Moderate	Good vigor; full crown.
123	Coast redwood	33	Ordinance Sized	3	Moderate	Slightly thin; asymmetric E; crowded with neighbor.
66	Coast redwood	34	Ordinance Sized	4	Moderate	Good young tree; high voltage lines to E; side-pruned.
122	Coast redwood	35	Ordinance Sized	3	Moderate	Slightly thin; asymmetric W; crowded with neighbor.
62	Coast redwood	43	Ordinance Sized	2	Low	Thin; epicormic sprouting and twig dieback; high voltage lines to E; side-pruned.
96	Callery pear	9	No	4	Moderate	Narrow attachments at 5-7 feet; vase-shaped; moderate fire
97	Callery pear	18	Ordinance Sized	4	Moderate	Narrow attachments at 5-7 feet; epicormics; vase-shaped; moderate fire blight.
98	Callery pear	8	No	4	Moderate	Narrow attachments at 5-7 feet; epicormics; vase-shaped; moderate fire blight.

# Tree Assessment

Harker Bucknall  
San Jose, CA  
January 2025



Tree No.	Species	Trunk Diameter (in.)	Protected Tree?	Condition 0=dead 5=excellent	Suitability for Preservation	Comments
99	Callery pear	16	Ordinance Sized	4	Moderate	Narrow attachments at 5-7 feet; epicormics; vase-shaped; moderate fire blight.
100	Callery pear	19	Ordinance Sized	4	Moderate	Narrow attachments at 5-7 feet; epicormics; vase-shaped; moderate fire blight.
101	Callery pear	18	Ordinance Sized	4	Moderate	Narrow attachments at 5-7 feet; epicormics; vase-shaped; moderate fire blight.
102	Callery pear	18	Ordinance Sized	2	Low	Narrow attachments at 6 feet; decay in trunk and wounds; lower than average vigor.
103	London plane	8	No	5	High	Columnar narrow form; good young tree.
104	London plane	17	Ordinance Sized	5	High	In 4x4 planter; spreading decurrent form; most branches have reduction cuts; larger removal cuts at stem compartmentalizing
105	Red maple	5	No	4	High	Columnar; tight branching structure.
106	Cajeput paperbark tree	8,7,7,6	Ordinance Sized	2	Low	Multiple attachments; topped.
107	African fern-pine	17	Ordinance Sized	2	Low	Between curb and building; topped; vigorous.
108	African fern-pine	17	Ordinance Sized	3	Moderate	Between curb and building; vigorous.
109	Cork oak	31	Ordinance Sized	4	High	High crown; codominant at; 15 feet with seam and included bark below; spreading vigorous crown.
110	Cajeput paperbark tree	8	No	2	Low	Multiple attachments; high crown; topped.
111	Cajeput paperbark tree	6	No	2	Low	Multiple attachments; high crown; topped.
112	Chinese pistache	7	No	2	Low	Repeatedly topped; in 8 foot planter.
113	Chinese pistache	7	No	2	Low	Repeatedly topped; in 8 foot planter.
114	Chinese pistache	8	No	2	Low	Repeatedly topped; in 8 foot planter.
115	Chinese pistache	8	No	2	Low	Repeatedly topped; in 8 foot planter.
116	Chinese pistache	7	No	2	Low	Repeatedly topped; in 8 foot planter.
117	Chinese pistache	7	No	2	Low	Repeatedly topped; in 8 foot planter.

# Tree Assessment

Harker Bucknall  
San Jose, CA  
January 2025



Tree No.	Species	Trunk Diameter (in.)	Protected Tree?	Condition 0=dead 5=excellent	Suitability for Preservation	Comments
118	African fern-pine	15	Ordinance Sized	3	Moderate	Multiple attachments at 7 feet; dense crown; slightly asymmetric N.
119	African fern-pine	10	No	3	Moderate	Multiple attachments at 7 feet; dense crown; slightly asymmetric
120	African fern-pine	10	No	3	Moderate	Multiple attachments at 7 feet; dense crown; narrow crown.
121	African fern-pine	11	No	3	Moderate	Multiple attachments at 7 feet; dense crown; narrow crown.
69	Coast redwood	45	Ordinance Sized	4	Moderate	Slight sweep S; good structure and vigor.
73	Coast redwood	57	Ordinance Sized	3	Moderate	Row at edge of field; crowded with neighbor; largest in area; swollen root flare; thin; sweep N.
124	Cork oak	26	Ordinance Sized	4	High	Multiple attachments at 8 feet; spreading crown; good vigor.
125	Siberian elm	23	Ordinance Sized	1	Low	Severely topped; disfigured.
126	Siberian elm	15	Ordinance Sized	1	Low	Severely topped; disfigured; sounds hollow.
127	Siberian elm	20	Ordinance Sized	1	Low	Severely topped; disfigured; dead stubs.
128	Siberian elm	33	Ordinance Sized	1	Low	Severely topped; disfigured; decay in old wounds.
129	Siberian elm	18	Ordinance Sized	1	Low	Severely topped; disfigured; decay in old wounds.
130	Siberian elm	18	Ordinance Sized	1	Low	Severely topped; disfigured; decay in old wounds.
131	Siberian elm	19	Ordinance Sized	1	Low	Severely topped; disfigured; decay in old wounds.
132	Siberian elm	23	Ordinance Sized	1	Low	Severely topped; disfigured; decay in old wounds.
133	Siberian elm	18	Ordinance Sized	1	Low	Severely topped; disfigured; decay in old wounds.

# Tree Assessment

Harker Bucknall  
San Jose, CA  
January 2025



Tree No.	Species	Trunk Diameter (in.)	Protected Tree?	Condition 0=dead 5=excellent	Suitability for Preservation	Comments
134	Pear	6,5,4,2	Ordinance Sized	3	Moderate	Multiple attachments at 3 feet; low, vase-shaped crown.
135	Plum	4,3	No	3	Moderate	Codominant at 2 feet; flat crown EW.; low crown.
136	Chinese elm	18	Ordinance Sized	3	Moderate	Irregular 6 foot triangular planter; grafted onto barked rootstock heaving bricks; codominant at 10 feet; spreading crown.
137	London plane	12	Ordinance Sized	4	High	5 feet from back of walk; multiple attachments at 7 feet; low, rounded crown.
138	Colorado blue spruce	16	Ordinance Sized	3	Moderate	Narrow codominant at 6 feet; narrow form; mild twig dieback.
139	London plane	16	Ordinance Sized	3	Moderate	Codominant at 5 and 10 feet; history of stem tear out; topped for high voltage; otherwise vigorous and well formed.
140	London plane	16	Ordinance Sized	3	Moderate	Codominant at 4 feet; history of stem tear out; topped for high voltage; otherwise vigorous and well formed; between fence and sidewalk.
141	Callery pear	5	No	3	Low	3 foot planter; high crown; narrow branch attachments.
142	Siberian elm	22	Ordinance Sized	1	Low	Severely topped; disfigured; decay in old wounds.
143	Siberian elm	18	Ordinance Sized	1	Low	Severely topped; disfigured; decay in old wounds.
144	Siberian elm	18	Ordinance Sized	1	Low	Severely topped; disfigured; decay in old wounds.
145	Siberian elm	21	Ordinance Sized	1	Low	Severely topped; disfigured; decay in old wounds.
146	Chinese hackberry	6	Street Tree	3	Moderate	Street tree; multiple attachments at 6 feet; vase-shaped.
147	Chinese hackberry	13	Street Tree	3	Moderate	Street tree; multiple attachments at 6 feet; vase-shaped.
148	Chinese hackberry	12	Street Tree	3	Moderate	Street tree; multiple attachments at 6 feet; vase-shaped; asymmetric S.
149	Chinese hackberry	12	Street Tree	3	Moderate	Street tree; multiple attachments at 6 feet; vase-shaped; small crossing branches.

# Tree Assessment

Harker Bucknall  
San Jose, CA  
January 2025



Tree No.	Species	Trunk Diameter (in.)	Protected Tree?	Condition 0=dead 5=excellent	Suitability for Preservation	Comments
150	Chinese hackberry	8	Street Tree	3	Moderate	Street tree; multiple attachments at 6 feet; vase-shaped; small crossing branches; lockbox hung in crown; large crossing surface roots.
151	Chinese hackberry	10	Street Tree	2	Low	Street tree; multiple attachments at 6 feet; stem failure S; suppressed by redwoods.
152	Chinese hackberry	8	Street Tree	3	Moderate	Street tree; multiple attachments at 6 feet; one-sided S; crowded with redwoods.
153	Chinese hackberry	6	Street Tree	3	Moderate	Street tree; multiple attachments at 6 feet; one-sided S; crowded with redwoods.
154	Chinese hackberry	7	Street Tree	3	Moderate	Street tree; multiple attachments at 6 feet; one-sided S; crowded with redwoods; small branch dieback.

# Tree Assessment Map

Harker Bucknall  
MP Building  
4300 Bucknall Road  
San Jose, CA

Prepared for:  
Devcon Construction, Inc.  
Milpitas, CA

January 2025



No Scale

Notes:  
Base map provided by:  
Devcon Construction, Inc.  
Milpitas, CA

Numbered tree locations are approximate.



2550 Ninth Street, Suite 112  
Berkeley, CA 94710  
Phone 925.484.0211  
Fax 925.484.0596  
www.hortscience.com

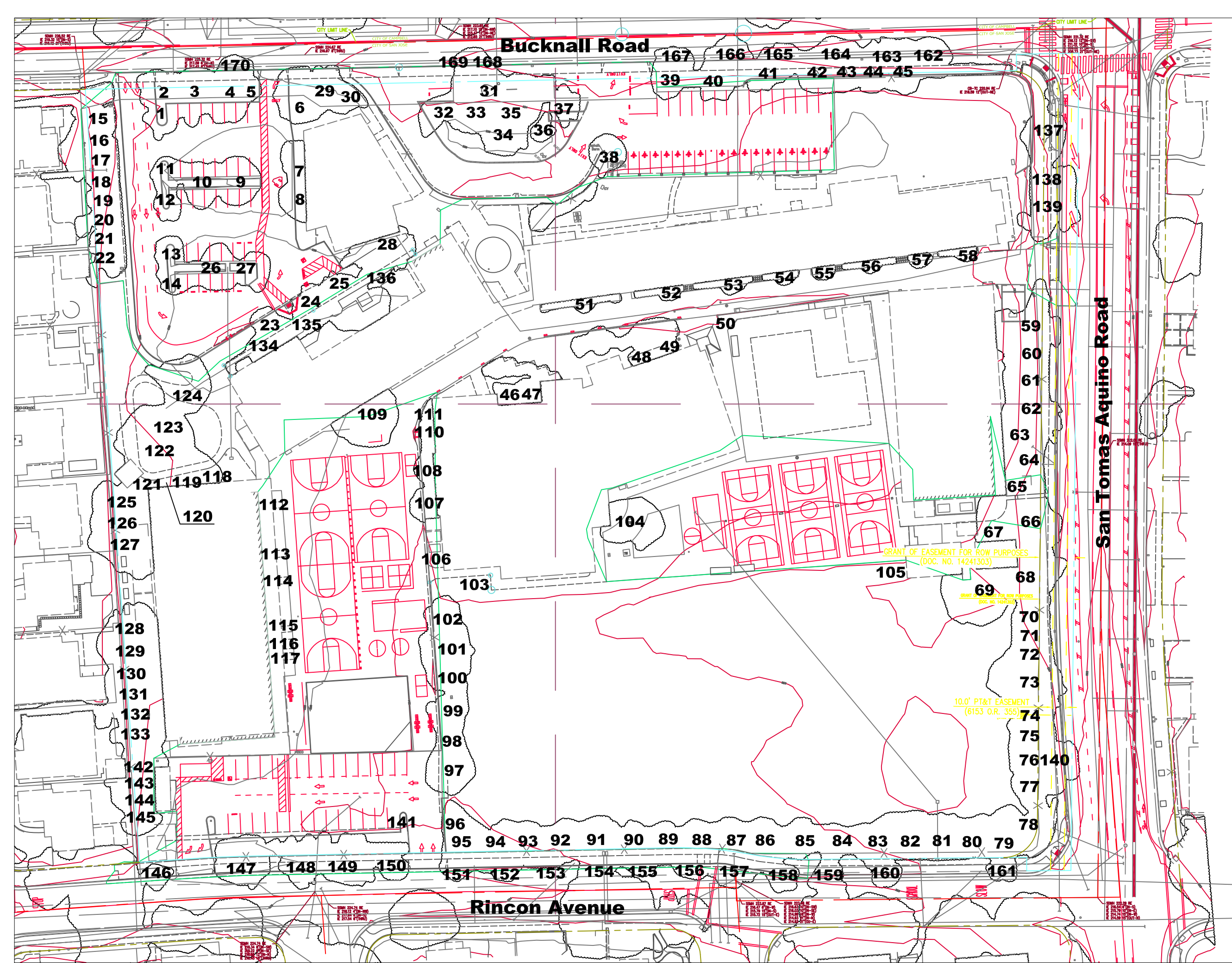

# Preliminary Tree Disposition

Harker Bucknall  
San Jose, CA  
January 2025



Tree No.	Species	Trunk Diameter (in.)	Protected Tree?	Disposition	Comments
1	Callery pear	11	No	Preserve	Edge of new parking; preserve existing curb location.
2	Callery pear	12	Ordinance Sized	Preserve	Edge of new parking; preserve existing curb location.
3	Deodar cedar	18	Ordinance Sized	Preserve	Edge of new parking; preserve existing curb location.
4	Evergreen ash	15	Ordinance Sized	Preserve	Edge of new parking; preserve existing curb location.
5	Deodar cedar	5	No	Preserve	Edge of new parking; preserve existing curb location.
6	Deodar cedar	34	Ordinance Sized	Remove	In proposed parking lot landscape planter; curb cuts ~4 feet on two sides.
7	London plane	13	Ordinance Sized	Remove	In project footprint
8	London plane	16	Ordinance Sized	Remove	In project footprint
9	London plane	14	Ordinance Sized	Preserve	Edge of new parking; preserve existing curb location.
10	Evergreen ash	11	No	Preserve	Edge of new parking; preserve existing curb location.
11	Callery pear	12	Ordinance Sized	Preserve	Edge of new parking; preserve existing curb location.
12	Callery pear	11	No	Preserve	Edge of new parking; preserve existing curb location.
13	Callery pear	10	No	Preserve	Edge of new parking; preserve existing curb location.
14	Callery pear	12	Ordinance Sized	Preserve	Edge of new parking; preserve existing curb location.
15	African sumac	5	No	Remove	New curb <1 foot from trunk.
16	African sumac	5	No	Remove	Dead
17	African sumac	5	No	Remove	New curb <1 foot from trunk.
18	African sumac	5	No	Remove	New curb <1 foot from trunk.
19	African sumac	5	No	Remove	New curb <1 foot from trunk.
20	African sumac	5	No	Remove	New curb <1 foot from trunk.
21	African sumac	5	No	Remove	New curb <1 foot from trunk.
22	African sumac	4	No	Remove	New curb <1 foot from trunk.
23	Callery pear	15	Ordinance Sized	Remove	In project footprint
24	Callery pear	15	Ordinance Sized	Remove	In project footprint
25	Callery pear	12	Ordinance Sized	Remove	In project footprint
26	Evergreen ash	15	Ordinance Sized	Preserve	Edge of new parking; expanding planting area.
27	Callery pear	12	Ordinance Sized	Preserve	Edge of new parking; expanding planting area.
28	Chinese elm	20	Ordinance Sized	Remove	In project footprint
74	Coast redwood	8	No	Preserve	Outside project area.

# Preliminary Tree Disposition

Harker Bucknall  
San Jose, CA  
January 2025



Tree No.	Species	Trunk Diameter (in.)	Protected Tree?	Disposition	Comments
35	Coast redwood	11	No	Preserve	Preserve edge of existing planting area.
36	Coast redwood	12	Ordinance Sized	Preserve	Preserve edge of existing planting area.
32	Callery pear	12	Ordinance Sized	Preserve	Preserve edge of existing planting area.
60	Coast redwood	12	Ordinance Sized	Preserve	Outside project area.
64	Coast redwood	14	Ordinance Sized	Preserve	Outside project area.
30	Coast redwood	15	Ordinance Sized	Remove	~4 feet from impacts.
67	Coast redwood	15	Ordinance Sized	Remove	In project footprint
37	Callery pear	12	Ordinance Sized	Preserve	Preserve edge of existing planting area.
38	Canary Island date palm	32	Ordinance Sized	Preserve	Preserve edge of existing planting area.
39	Callery pear	12	Ordinance Sized	Preserve	Edge of new parking; preserve existing curb location.
40	Callery pear	12	Ordinance Sized	Preserve	Edge of new parking; preserve existing curb location.
41	Callery pear	12	Ordinance Sized	Preserve	Edge of new landscape area and field.
42	Callery pear	14	Ordinance Sized	Preserve	Edge of new landscape area and field.
43	Callery pear	15	Ordinance Sized	Preserve	Edge of new landscape area and field.
44	Callery pear	11	No	Preserve	Edge of new landscape area and field.
45	Callery pear	16	Ordinance Sized	Preserve	Edge of new landscape area and field.
46	African fern-pine	8	No	Preserve	~8 feet from edge of new paving.
47	African fern-pine	16	Ordinance Sized	Preserve	~15 feet from edge of new
48	Cajeput paperbark tree	6	No	Remove	In project footprint
49	Cajeput paperbark tree	9	No	Remove	In project footprint
50	Cajeput paperbark tree	9	No	Remove	In project footprint
51	Chinese pistache	8	No	Remove	Edge of new paving; poor
52	Chinese pistache	10	No	Remove	Edge of new paving; poor
53	Chinese pistache	9	No	Remove	Edge of new paving; poor
54	Chinese pistache	8	No	Remove	Edge of new paving; poor
55	Chinese pistache	9	No	Remove	Edge of new paving; poor
56	Chinese pistache	8	No	Remove	Edge of new paving; poor
57	Chinese pistache	9	No	Remove	Edge of new paving; poor
58	Chinese pistache	7	No	Remove	Edge of new paving; poor

# Preliminary Tree Disposition

Harker Bucknall  
San Jose, CA  
January 2025



Tree No.	Species	Trunk Diameter (in.)	Protected Tree?	Disposition	Comments
59	Pepper tree	38	Ordinance Sized	Preserve	Outside project area.
79	Coast redwood	19	Ordinance Sized	Preserve	Outside project area.
61	Coast redwood	20	Ordinance Sized	Preserve	Outside project area.
71	Coast redwood	20	Ordinance Sized	Preserve	Outside project area.
63	Fig	5	No	Preserve	Outside project area.
70	Coast redwood	21	Ordinance Sized	Preserve	Outside project area.
65	Deodar cedar	27	Ordinance Sized	Preserve	Outside project area.
77	Coast redwood	21	Ordinance Sized	Preserve	Outside project area.
85	Coast redwood	21	Ordinance Sized	Preserve	Outside project area.
68	Pepper tree	38	Ordinance Sized	Preserve	~15 feet from building 500 extension.
86	Coast redwood	21	Ordinance Sized	Preserve	Outside project area.
88	Coast redwood	21	Ordinance Sized	Preserve	Outside project area.
72	Coast redwood	22	Ordinance Sized	Preserve	Outside project area.
75	Coast redwood	22	Ordinance Sized	Preserve	Outside project area.
87	Coast redwood	22	Ordinance Sized	Preserve	Outside project area.
93	Coast redwood	22	Ordinance Sized	Remove	In project footprint
94	Coast redwood	22	Ordinance Sized	Remove	In project footprint
31	Coast redwood	23	Ordinance Sized	Preserve	Preserve edge of existing planting area.
80	Coast redwood	23	Ordinance Sized	Preserve	Outside project area.
82	Coast redwood	23	Ordinance Sized	Preserve	Outside project area.
83	Coast redwood	23	Ordinance Sized	Preserve	Outside project area.
89	Coast redwood	23	Ordinance Sized	Preserve	Outside project area.
90	Coast redwood	23	Ordinance Sized	Preserve	Outside project area.
92	Coast redwood	23	Ordinance Sized	Remove	In project footprint
29	Coast redwood	24	Ordinance Sized	Remove	~4 feet from impacts.
78	Coast redwood	24	Ordinance Sized	Preserve	Outside project area.
81	Coast redwood	24	Ordinance Sized	Preserve	Outside project area.
84	Coast redwood	24	Ordinance Sized	Preserve	Outside project area.
91	Coast redwood	25	Ordinance Sized	Remove	In project footprint
76	Coast redwood	27	Ordinance Sized	Preserve	Outside project area.
33	Coast redwood	28	Ordinance Sized	Preserve	Preserve edge of existing planting area.
95	Coast redwood	28	Ordinance Sized	Remove	In project footprint
34	Coast redwood	30	Ordinance Sized	Preserve	Preserve edge of existing planting area.
123	Coast redwood	33	Ordinance Sized	Preserve	Outside project area.
66	Coast redwood	34	Ordinance Sized	Remove	Edge of building 500 extension.
122	Coast redwood	35	Ordinance Sized	Preserve	Outside project area.
62	Coast redwood	43	Ordinance Sized	Preserve	Outside project area.

# Preliminary Tree Disposition

Harker Bucknall  
San Jose, CA  
January 2025



Tree No.	Species	Trunk Diameter (in.)	Protected Tree?	Disposition	Comments
96	Callery pear	9	No	Remove	In project footprint
97	Callery pear	18	Ordinance Sized	Remove	In project footprint
98	Callery pear	8	No	Remove	In project footprint
99	Callery pear	16	Ordinance Sized	Remove	In project footprint
100	Callery pear	19	Ordinance Sized	Remove	In project footprint
101	Callery pear	18	Ordinance Sized	Remove	In project footprint
102	Callery pear	18	Ordinance Sized	Remove	In project footprint
103	London plane	8	No	Preserve	Edge of project area
104	London plane	17	Ordinance Sized	Preserve	Outside project area; preserve existing planter.
105	Red maple	5	No	Remove	In project footprint
106	Cajeput paperbark tree	8,7,7,6	Ordinance Sized	Remove	In project footprint
107	African fern-pine	17	Ordinance Sized	Remove	In project footprint
108	African fern-pine	17	Ordinance Sized	Remove	In project footprint
109	Cork oak	31	Ordinance Sized	Preserve	Preserve edge of existing planting area.
110	Cajeput paperbark tree	8	No	Remove	In project footprint
111	Cajeput paperbark tree	6	No	Remove	In project footprint
112	Chinese pistache	7	No	Remove	In project footprint
113	Chinese pistache	7	No	Remove	In project footprint
114	Chinese pistache	8	No	Remove	In project footprint
115	Chinese pistache	8	No	Remove	In project footprint
116	Chinese pistache	7	No	Remove	In project footprint
117	Chinese pistache	7	No	Remove	In project footprint
118	African fern-pine	15	Ordinance Sized	Preserve	Outside project area.
119	African fern-pine	10	No	Preserve	Outside project area.
120	African fern-pine	10	No	Preserve	Outside project area.
121	African fern-pine	11	No	Preserve	Outside project area.
69	Coast redwood	45	Ordinance Sized	Preserve	Outside project area.
73	Coast redwood	57	Ordinance Sized	Preserve	Outside project area.
124	Cork oak	26	Ordinance Sized	Preserve	Edge of new parking lot and sidewalk; preserve edge of existing planter.
125	Siberian elm	23	Ordinance Sized	Remove	In project footprint
126	Siberian elm	15	Ordinance Sized	Remove	In project footprint
127	Siberian elm	20	Ordinance Sized	Remove	In project footprint
128	Siberian elm	33	Ordinance Sized	Remove	In project footprint
129	Siberian elm	18	Ordinance Sized	Remove	In project footprint

# Preliminary Tree Disposition

Harker Bucknall  
San Jose, CA  
January 2025



Tree No.	Species	Trunk Diameter (in.)	Protected Tree?	Disposition	Comments
130	Siberian elm	18	Ordinance Sized	Remove	In project footprint
131	Siberian elm	19	Ordinance Sized	Remove	In project footprint
132	Siberian elm	23	Ordinance Sized	Remove	In project footprint
133	Siberian elm	18	Ordinance Sized	Remove	In project footprint
134	Pear	6,5,4,2	Ordinance Sized	Preserve	Outside project area.
135	Plum	4,3	No	Preserve	Outside project area.
136	Chinese elm	18	Ordinance Sized	Preserve	Outside project area.
137	London plane	12	Ordinance Sized	Preserve	Edge of new landscape area and field.
138	Colorado blue spruce	16	Ordinance Sized	Preserve	Edge of new landscape area and field.
139	London plane	16	Ordinance Sized	Preserve	Edge of new landscape area and field.
140	London plane	16	Ordinance Sized	Preserve	Outside project area.
141	Callery pear	5	No	Remove	In project footprint
142	Siberian elm	22	Ordinance Sized	Remove	In project footprint; very poor condition.
143	Siberian elm	18	Ordinance Sized	Remove	In project footprint; very poor condition.
144	Siberian elm	18	Ordinance Sized	Remove	In project footprint; very poor condition.
145	Siberian elm	21	Ordinance Sized	Remove	In project footprint; very poor condition.
146	Chinese hackberry	6	Street Tree	essentially preserve	Curb, gutter, and sidewalk to be replaced.
147	Chinese hackberry	13	Street Tree	essentially preserve	Curb, gutter, and sidewalk to be replaced.
148	Chinese hackberry	12	Street Tree	Remove	Edge of curb cut.
149	Chinese hackberry	12	Street Tree	Remove	Edge of curb cut.
150	Chinese hackberry	8	Street Tree	essentially preserve	Curb, gutter, and sidewalk to be replaced.
151	Chinese hackberry	10	Street Tree	essentially preserve	Curb, gutter, and sidewalk to be replaced.
152	Chinese hackberry	8	Street Tree	essentially preserve	Curb, gutter, and sidewalk to be replaced.
153	Chinese hackberry	6	Street Tree	Remove	In project footprint; curb cut.
154	Chinese hackberry	7	Street Tree	Remove	In project footprint; curb cut.

# San Jose Replacement Calculations

Harker Bucknall  
San Jose, CA  
January 2025



Tree Species No.	Trunk Diameter (in.)	Circumference (in.)	Ordinance Size?	Disposition	Provenance	Replacement Trees	
6	Deodar cedar	34	107	Yes	Remove	Non-native	4
7	London plane	13	41	Yes	Remove	Non-native	4
8	London plane	16	50	Yes	Remove	Non-native	4
15	African sumac	5	16	No	Remove	Non-native	0
16	African sumac	5	16	No	Remove	Non-native	0
17	African sumac	5	16	No	Remove	Non-native	0
18	African sumac	5	16	No	Remove	Non-native	0
19	African sumac	5	16	No	Remove	Non-native	0
20	African sumac	5	16	No	Remove	Non-native	0
21	African sumac	5	16	No	Remove	Non-native	0
22	African sumac	4	13	No	Remove	Non-native	0
23	Callery pear	15	47	Yes	Remove	Non-native	4
24	Callery pear	15	47	Yes	Remove	Non-native	4
25	Callery pear	12	38	Yes	Remove	Non-native	4
28	Chinese elm	20	63	Yes	Remove	Non-native	4
30	Coast redwood	15	47	Yes	Remove	Native	5
67	Coast redwood	15	47	Yes	Remove	Native	5
48	Cajeput paperbark tree	6	19	No	Remove	Non-native	0
49	Cajeput paperbark tree	9	28	No	Remove	Non-native	0
50	Cajeput paperbark tree	9	28	No	Remove	Non-native	0
51	Chinese pistache	8	25	No	Remove	Non-native	0
52	Chinese pistache	10	31	No	Remove	Non-native	0
53	Chinese pistache	9	28	No	Remove	Non-native	0
54	Chinese pistache	8	25	No	Remove	Non-native	0
55	Chinese pistache	9	28	No	Remove	Non-native	0
56	Chinese pistache	8	25	No	Remove	Non-native	0
57	Chinese pistache	9	28	No	Remove	Non-native	0
58	Chinese pistache	7	22	No	Remove	Non-native	0
93	Coast redwood	22	69	Yes	Remove	Native	5
94	Coast redwood	22	69	Yes	Remove	Native	5
92	Coast redwood	23	72	Yes	Remove	Native	5
29	Coast redwood	24	75	Yes	Remove	Native	5
91	Coast redwood	25	79	Yes	Remove	Native	5
95	Coast redwood	28	88	Yes	Remove	Native	5
66	Coast redwood	34	107	Yes	Remove	Native	5
96	Callery pear	9	28	No	Remove	Non-native	0
97	Callery pear	18	57	Yes	Remove	Non-native	4
98	Callery pear	8	25	No	Remove	Non-native	0
99	Callery pear	16	50	Yes	Remove	Non-native	4
100	Callery pear	19	60	Yes	Remove	Non-native	4
101	Callery pear	18	57	Yes	Remove	Non-native	4

# San Jose Replacement Calculations

Harker Bucknall  
San Jose, CA  
January 2025



Tree Species No.	Trunk Diameter (in.)	Circumference (in.)	Ordinance Size?	Disposition	Provenance	Replacement Trees
102 Callery pear	18	57	Yes	Remove	Non-native	4
105 Red maple	5	16	No	Remove	Non-native	0
106 Cajeput paperbark tree	8,7,7,6	88	Yes	Remove	Non-native	4
107 African fern-pine	17	53	Yes	Remove	Non-native	4
108 African fern-pine	17	53	Yes	Remove	Non-native	4
110 Cajeput paperbark tree	8	25	No	Remove	Non-native	0
111 Cajeput paperbark tree	6	19	No	Remove	Non-native	0
112 Chinese pistache	7	22	No	Remove	Non-native	0
113 Chinese pistache	7	22	No	Remove	Non-native	0
114 Chinese pistache	8	25	No	Remove	Non-native	0
115 Chinese pistache	8	25	No	Remove	Non-native	0
116 Chinese pistache	7	22	No	Remove	Non-native	0
117 Chinese pistache	7	22	No	Remove	Non-native	0
125 Siberian elm	23	72	Yes	Remove	Non-native	4
126 Siberian elm	15	47	Yes	Remove	Non-native	4
127 Siberian elm	20	63	Yes	Remove	Non-native	4
128 Siberian elm	33	104	Yes	Remove	Non-native	4
129 Siberian elm	18	57	Yes	Remove	Non-native	4
130 Siberian elm	18	57	Yes	Remove	Non-native	4
131 Siberian elm	19	60	Yes	Remove	Non-native	4
132 Siberian elm	23	72	Yes	Remove	Non-native	4
133 Siberian elm	18	57	Yes	Remove	Non-native	4
141 Callery pear	5	16	No	Remove	Non-native	0
142 Siberian elm	22	69	Yes	Remove	Non-native	4
143 Siberian elm	18	57	Yes	Remove	Non-native	4
144 Siberian elm	18	57	Yes	Remove	Non-native	4
145 Siberian elm	21	66	Yes	Remove	Non-native	4
148 Chinese hackberry	12	38	Yes; Street Tree	Remove	Non-native	4
149 Chinese hackberry	12	38	Yes; Street Tree	Remove	Non-native	4
153 Chinese hackberry	6	19	No; Street Tree	Remove	Non-native	2
154 Chinese hackberry	7	22	No; Street Tree	Remove	Non-native	2

**Total 169**