



**CITY OF RANCHO MIRAGE**  
**PUBLIC NOTICE OF AVAILABILITY &**  
**NOTICE OF INTENT TO ADOPT A MITIGATED**  
**NEGATIVE DECLARATION**  
**Global Wildlife Discovery Museum**

---

**LEAD AGENCY:** City of Rancho Mirage  
69-825 Highway 111  
Rancho Mirage, CA 92270

**CONTACT PERSON:** Lezlee Perez, Assistant Planner – (760) 328-2266 ext. 257

**PROJECT TITLE:** Global Wildlife Discovery Museum - Environmental Assessment Case No. EA25-0003 and Preliminary Development Plan PDP25-0003

**PROJECT LOCATION:** 69934 Highway 111, Rancho Mirage, CA, 92270.  
Assessor's Parcel Numbers: 689-040-023, 689-040-025, & 689-040-028

**PROJECT DESCRIPTION:** The project proposes to construct a new single-story 21,967 square foot museum located on the corner of Mirage Cove Drive and Highway 111. The project contains three parcels that will be merged into one parcel totaling 6.78 acres, which includes a rock outcrop that rises to an elevation of 370 feet. One of the parcels was previously the site of the 1978 Chart House Restaurant, which was demolished in 2013 due to fire damage. The proposed building design incorporates the rock outcrop and requires removal of a small portion of the adjoining hillside, which was previously modified to accommodate the previous restaurant.

The museum will include a lobby, a coffee shop, a gift shop, storage spaces, office spaces, restrooms, an outdoor plaza with a fountain, a main parking lot, and an overflow parking lot with separate access from Mirage Cove Drive. The museum includes a bus drop off in front of the building and an overflow parking lot for buses, special events, and groups. The Global Wildlife Discovery Museum will provide interactive exhibits, virtual habitats, conservation labs, and live educational events. Display areas will include representations of the animals, birds, reptiles, flora, and fauna in their natural environment.

**FINDINGS/DETERMINATION:** The City has reviewed and considered the proposed project and has determined that no significant impacts will occur with the implementation of mitigation measures. The City hereby prepares and proposes to adopt a Mitigated Negative Declaration (MND) for this project.

**PUBLIC REVIEW PERIOD:** A 30-day public review period for the Draft Negative Declaration will commence on **October 13, 2025**, and end on **November 12, 2025**, for interested individuals and public agencies to submit written comments on the document. Any written comments on the Negative Declaration must be received at the above address within the public review period. In addition, you may email comments to the following address: [LezleeP@RanchoMirageCA.gov](mailto:LezleeP@RanchoMirageCA.gov). Copies of the MND are available for review at the above address and on the City's website, at: [https://ranchomirageca.gov/our\\_city/city\\_departments/planning/environmental\\_documents.php](https://ranchomirageca.gov/our_city/city_departments/planning/environmental_documents.php)

**Vicinity Map**

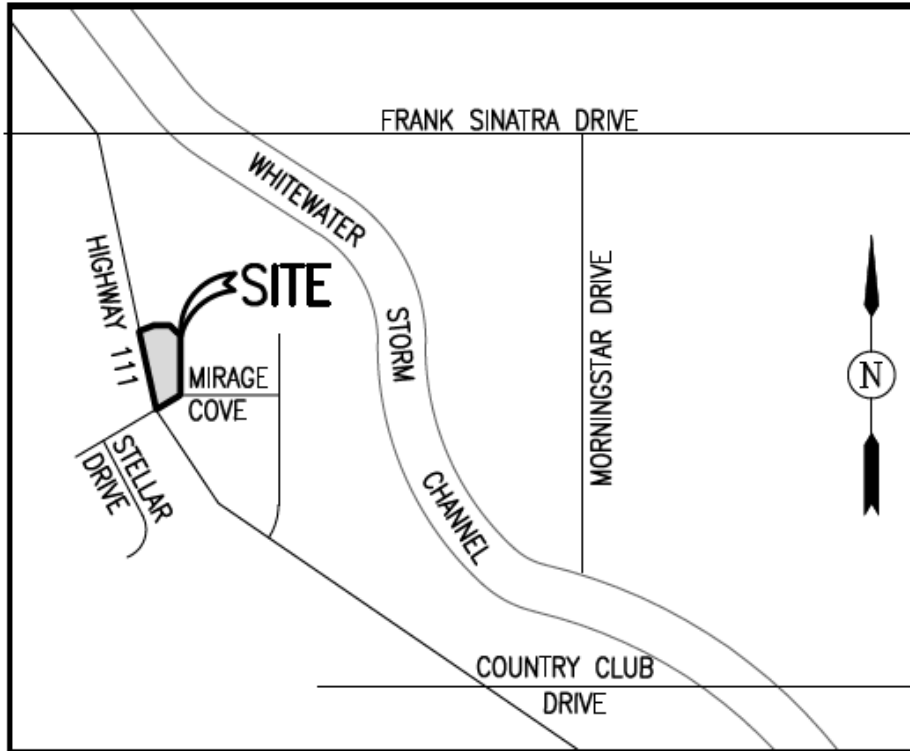

**VICINITY MAP**

NOT TO SCALE