

APPENDIX H
AMBIENT NOISE MEASUREMENT DATA



Noise Measurement Report Form – Part A

Date: 2/23/17 Day of Week: Thurs Time: 9:37 Project Number: 6016
on Allington St. behind
 Monitoring Segment / Area: ØØ1 Monitoring Site Address: 10326 Bellflower, ca
Amber St.
 Measurement Taken By: S. Seferyn of UltraSystems Environmental
 Approximate Wind Speed: 15 mph [km/hr] Approximate Wind Direction: From the N
 Approximate distance of sound level meter from receptor location: 40 FT
 Approximate distance of sound level meter from construction site: _____
(Leave Blank for Baseline Ambient)
 Receptor Land Use (Check One): Residential Institutional Comm./Ind. Recreational
 Sound Level Meter: Make and Model: Quest SoundPro DL-1-1/3 Serial Number: BLH080004
 Meter Setting: A-Weighted Sound Level (SLOW) A-Weighted Sound Level (FAST)
 Measurement Start Time: 9:37 Measurement End Time: 9:52
 Total Measurement Time: 15 mins Session File Name (e.g., S012): S089

Check the measurement purpose:

Baseline condition Ongoing construction Major change Complaint response

Measurement Results

Measurement Type	Measured Levels (dB)	
Calibration	Pre: <u>113.9</u>	Post: <u>113.9</u>
L _{eq} (h)	Slow: <u>65.3</u>	Fast: _____
L _{max}	Slow: <u>81.4</u>	Fast: _____
L ₉₀	Slow: <u>48.5</u>	Fast: _____

Field Notes:

1. Photos: Ø1
2. Busy road
3. _____

Noise Monitor's Signature: *S. Seferyn* Date: 2/23/17



Noise Measurement Report Form - Part B

Date: 2/23/17 Day of Week: Thurs. Time: 937 Project Number: 6016
 Monitoring Segment / Area: 001 Monitoring Site Address: on ajlington st behind 10326 Amber St. Bellflower, CA

Site Map

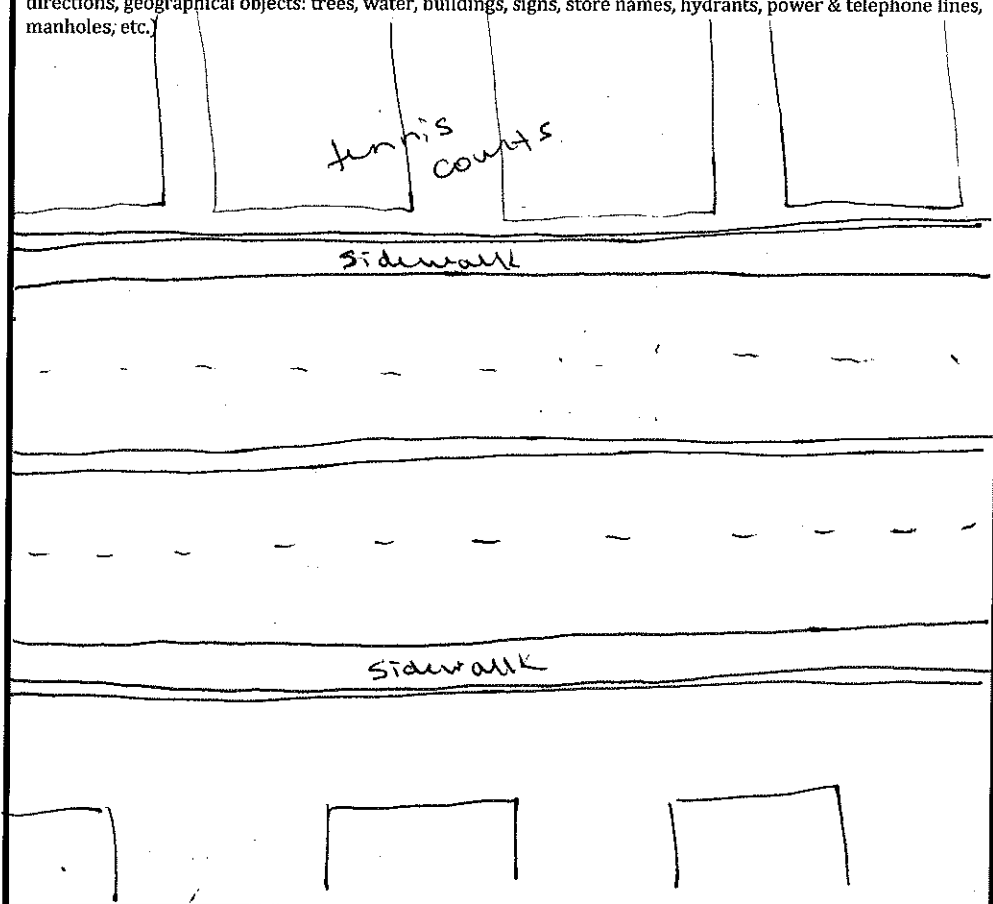
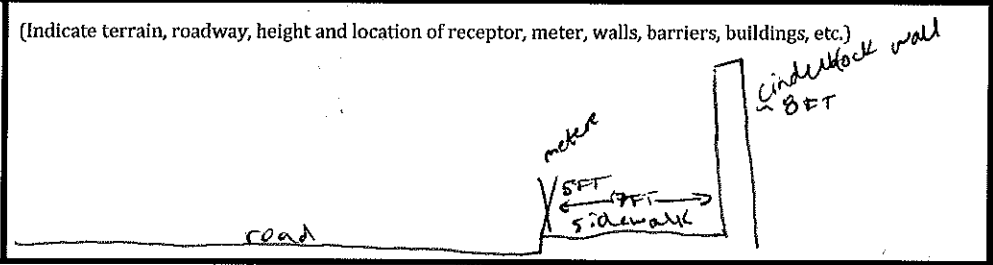
<p>Plan View</p>  <p>North Arrow (fill-in)</p>	<p>(Indicate site location, receptor location, meter location, distance in feet to landmarks, roadways, travel lane directions, geographical objects: trees, water, buildings, signs, store names, hydrants, power & telephone lines, manholes; etc.)</p>  <p>tennis courts</p> <p>sidewalk</p> <p>12 FT chain link fence</p> <p>sidewalk</p> <p>cinderblock wall</p>	
<p>Elevation View</p>	<p>(Indicate terrain, roadway, height and location of receptor, meter, walls, barriers, buildings, etc.)</p>  <p>road</p> <p>meter</p> <p>5 FT sidewalk</p> <p>cinderblock wall 8 FT</p>	
<p>Latitude: <u>33.86561</u></p>	<p>Longitude: <u>118.11315</u></p>	<p>Elevation: <u>116</u></p>

Noise Monitor's Signature: [Signature] Date: 2/23/17

Session Report

2/27/2017

Information Panel

Name S089_BLH080004_27022017_080517
Start Time 2/23/2017 9:38:03 AM
Stop Time 2/23/2017 9:53:03 AM
Device Name BLH080004
Model Type SoundPro DL
Device Firmware Rev R.13H
Comments

Summary Data Panel

<u>Description</u>	<u>Meter</u>	<u>Value</u>	<u>Description</u>	<u>Meter</u>	<u>Value</u>
Leq	1	65.3 dB			
Exchange Rate	1	3 dB	Weighting	1	A
Response	1	SLOW	Bandwidth	1	OFF
Exchange Rate	2	3 dB	Weighting	2	A
Response	2	FAST			

Statistics Chart

S089_BLH080004_27022017_080517: Statistics Chart

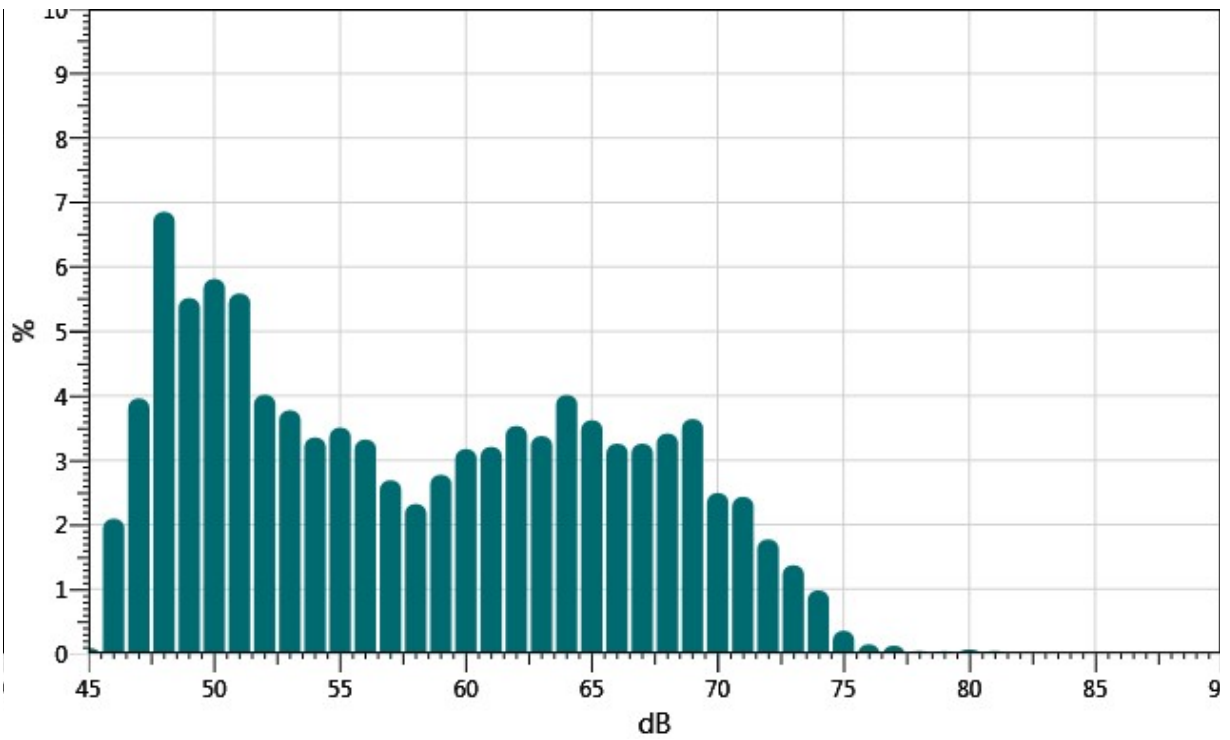

Exceedance Chart

S089_BLH080004_27022017_080517: Exceedance Chart

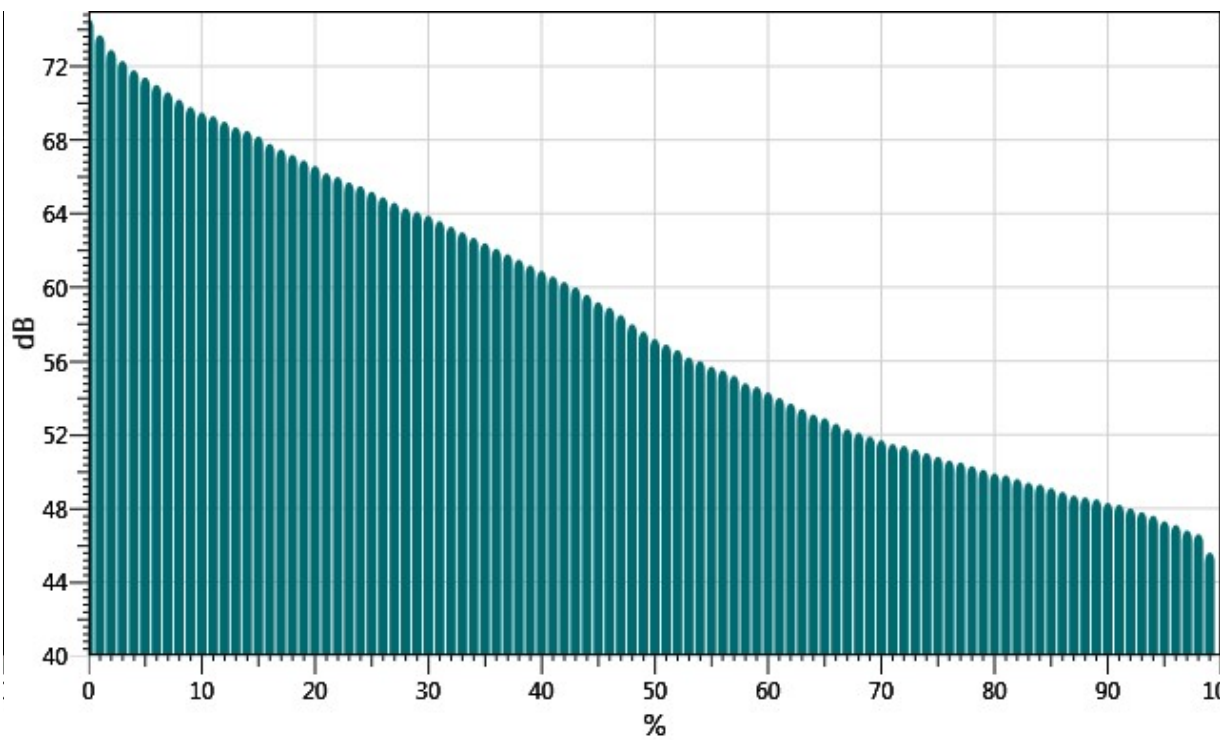

Statistics Table

dB:	0.0	0.1	0.2	0.3	0.4	0.5	0.6	0.7	0.8	0.9	%
45:	0.00	0.00	0.00	0.00	0.00	0.00	0.00	0.02	0.04	0.04	0.09
46:	0.02	0.07	0.08	0.16	0.18	0.19	0.14	0.23	0.38	0.64	2.09
47:	0.48	0.34	0.26	0.42	0.43	0.46	0.43	0.42	0.39	0.34	3.96
48:	0.63	0.65	0.46	0.68	0.54	0.57	0.85	1.03	0.89	0.54	6.85
49:	0.46	0.49	0.49	0.46	0.64	0.60	0.55	0.60	0.61	0.63	5.52
50:	0.57	0.50	0.49	0.64	0.53	0.55	0.63	0.62	0.62	0.65	5.81
51:	0.58	0.55	0.37	0.51	0.58	0.61	0.64	0.71	0.52	0.51	5.59
52:	0.63	0.44	0.44	0.43	0.38	0.35	0.33	0.38	0.32	0.34	4.02
53:	0.46	0.37	0.33	0.37	0.36	0.38	0.30	0.43	0.39	0.37	3.77
54:	0.30	0.29	0.18	0.29	0.29	0.35	0.33	0.41	0.51	0.40	3.35
55:	0.28	0.27	0.26	0.25	0.36	0.41	0.44	0.35	0.45	0.44	3.51
56:	0.39	0.38	0.35	0.33	0.38	0.28	0.31	0.27	0.33	0.30	3.32
57:	0.32	0.38	0.21	0.30	0.30	0.27	0.25	0.23	0.23	0.22	2.69
58:	0.23	0.24	0.21	0.27	0.23	0.22	0.23	0.23	0.23	0.23	2.32
59:	0.23	0.27	0.34	0.29	0.28	0.26	0.26	0.24	0.32	0.30	2.77
60:	0.33	0.31	0.27	0.34	0.33	0.35	0.28	0.33	0.35	0.30	3.17
61:	0.33	0.32	0.31	0.32	0.35	0.33	0.34	0.29	0.32	0.30	3.21
62:	0.37	0.33	0.30	0.32	0.34	0.35	0.35	0.38	0.42	0.38	3.53
63:	0.38	0.40	0.27	0.31	0.35	0.35	0.32	0.32	0.32	0.35	3.38
64:	0.39	0.34	0.47	0.46	0.40	0.44	0.42	0.47	0.36	0.27	4.01
65:	0.27	0.27	0.32	0.29	0.32	0.34	0.38	0.40	0.57	0.47	3.62
66:	0.42	0.42	0.28	0.36	0.29	0.30	0.30	0.31	0.30	0.29	3.26
67:	0.32	0.32	0.29	0.30	0.33	0.34	0.34	0.33	0.36	0.33	3.26
68:	0.29	0.26	0.26	0.33	0.32	0.38	0.34	0.40	0.42	0.42	3.41
69:	0.40	0.36	0.30	0.39	0.36	0.35	0.40	0.37	0.38	0.32	3.64
70:	0.26	0.28	0.22	0.22	0.23	0.27	0.26	0.25	0.25	0.27	2.49
71:	0.28	0.27	0.30	0.22	0.26	0.21	0.20	0.22	0.20	0.27	2.43
72:	0.26	0.26	0.16	0.09	0.15	0.16	0.17	0.17	0.18	0.16	1.77
73:	0.18	0.15	0.16	0.15	0.13	0.13	0.15	0.11	0.12	0.10	1.37
74:	0.09	0.11	0.13	0.16	0.10	0.10	0.09	0.10	0.05	0.06	0.98
75:	0.07	0.03	0.04	0.02	0.03	0.03	0.03	0.03	0.03	0.05	0.35
76:	0.06	0.01	0.01	0.01	0.01	0.01	0.01	0.01	0.01	0.01	0.14
77:	0.01	0.01	0.01	0.01	0.01	0.02	0.03	0.02	0.01	0.00	0.12
78:	0.01	0.01	0.01	0.00	0.00	0.01	0.00	0.00	0.00	0.00	0.04
79:	0.01	0.00	0.00	0.01	0.00	0.01	0.00	0.00	0.00	0.00	0.04

80:	0.00	0.01	0.00	0.00	0.01	0.00	0.00	0.01	0.02	0.01	0.06
81:	0.01	0.01	0.01	0.01	0.01	0.00	0.00	0.00	0.00	0.00	0.04

Exceedance Table

	0%	1%	2%	3%	4%	5%	6%	7%	8%	9%
0%:		74.6	73.7	72.9	72.3	71.8	71.4	71.0	70.6	70.2
10%:	69.8	69.5	69.3	69.0	68.7	68.5	68.2	67.8	67.5	67.2
20%:	66.9	66.6	66.2	66.0	65.7	65.5	65.2	64.9	64.6	64.3
30%:	64.1	63.9	63.6	63.3	63.0	62.7	62.4	62.1	61.8	61.5
40%:	61.2	60.9	60.6	60.3	60.0	59.6	59.2	58.9	58.5	58.0
50%:	57.6	57.2	56.9	56.6	56.2	56.0	55.7	55.5	55.2	54.8
60%:	54.6	54.3	54.0	53.7	53.4	53.1	52.9	52.6	52.3	52.1
70%:	51.9	51.7	51.5	51.4	51.2	51.0	50.8	50.6	50.5	50.3
80%:	50.1	49.9	49.8	49.6	49.4	49.3	49.1	48.9	48.7	48.6
90%:	48.5	48.3	48.2	48.0	47.8	47.6	47.3	47.1	46.8	46.6
100%:	45.6									

Logged Data Chart

S089_BLH080004_27022017_080517: Logged Data Chart

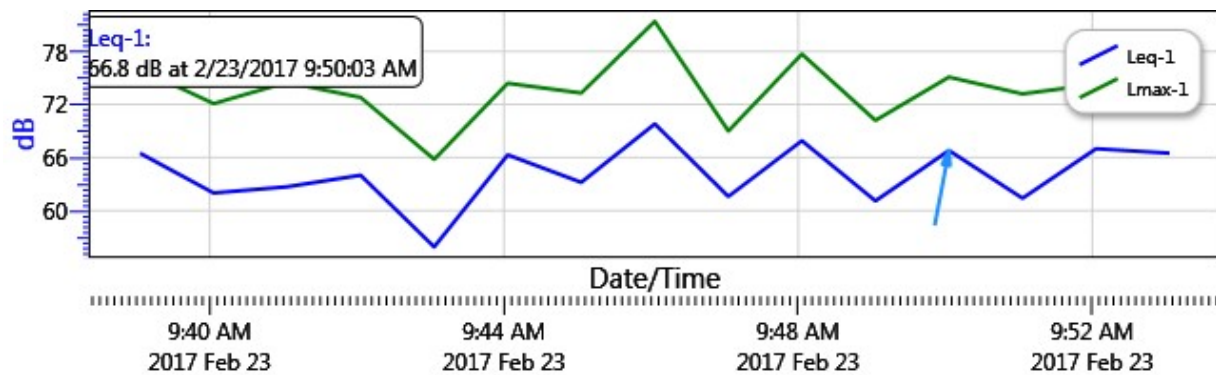



Noise Measurement Report Form – Part A

Date: 2/23/17 Day of Week: Thurs. Time: 756 Project Number: 6016
 Monitoring Segment / Area: 002 Monitoring Site Address: on Alhington St. behind 10426 Ambrose St
 Measurement Taken By: S. Seferyn of UltraSystems Environmental
 Approximate Wind Speed: 2 mph [km/hr] Approximate Wind Direction: From the NW/W
 Approximate distance of sound level meter from receptor location: 45 ft
 Approximate distance of sound level meter from construction site: _____
 (Leave Blank for Baseline Ambient)
 Receptor Land Use (Check One): Residential Institutional Comm./Ind. Recreational
 Sound Level Meter: Make and Model: Quest SoundPro DL-1-1/3 Serial Number: BLH080004
 Meter Setting: A-Weighted Sound Level (SLOW) A-Weighted Sound Level (FAST)
 Measurement Start Time: 956 Measurement End Time: 1011
 Total Measurement Time: 15 mins Session File Name (e.g., S012): S090

Check the measurement purpose:

Baseline condition Ongoing construction Major change Complaint response

Measurement Results

Measurement Type	Measured Levels (dB)	
Calibration	Pre: <u>113.9</u>	Post: <u>113.9</u>
Leq (h)	Slow: <u>64.2</u>	Fast: _____
Lmax	Slow: <u>76.5</u>	Fast: _____
L90	Slow: <u>50.3</u>	Fast: _____

Field Notes:

1. Photos: 002
2. Busy road
3. _____

Noise Monitor's Signature: *S. Seferyn* Date: 2/23/17



Noise Measurement Report Form - Part B

Date: 2/23/17 Day of Week: Thurs. Time: 956 Project Number: 6016
Monitoring Segment / Area: 602 Monitoring Site Address: 10426 Amber St *On Alhambra St behind*

Site Map

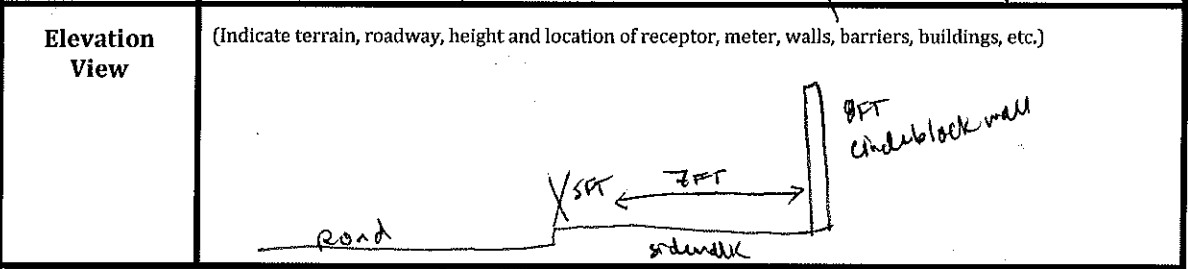
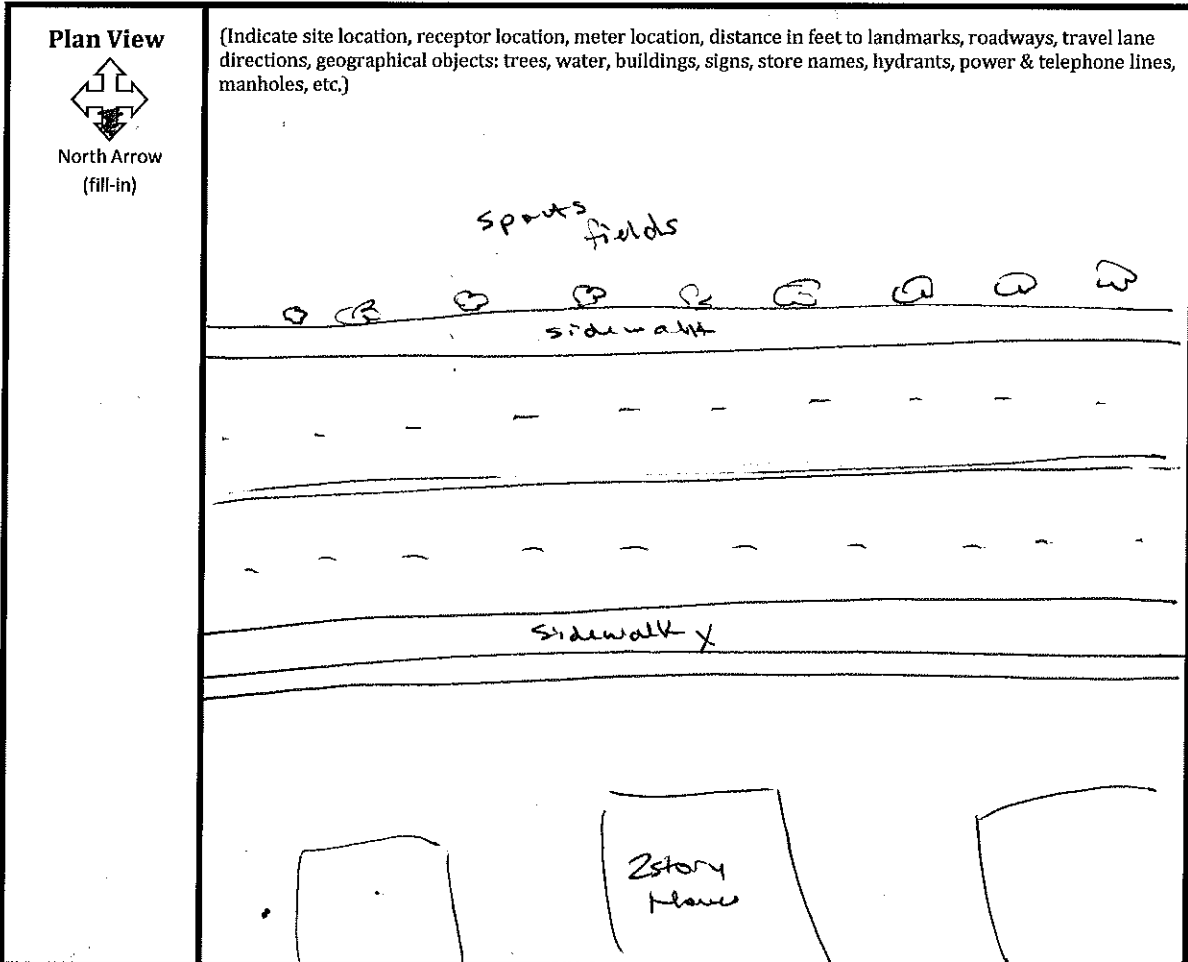

Latitude: 33.86566 Longitude: 118.11215 Elevation: 83

Noise Monitor's Signature: *[Signature]* Date: 2/23/17

Session Report

2/27/2017

Information Panel

Name S090_BLH080004_27022017_080510
Start Time 2/23/2017 9:57:44 AM
Stop Time 2/23/2017 10:12:44 AM
Device Name BLH080004
Model Type SoundPro DL
Device Firmware Rev R.13H
Comments

Summary Data Panel

<u>Description</u>	<u>Meter</u>	<u>Value</u>	<u>Description</u>	<u>Meter</u>	<u>Value</u>
Leq	1	64.2 dB			
Exchange Rate	1	3 dB	Weighting	1	A
Response	1	SLOW	Bandwidth	1	OFF
Exchange Rate	2	3 dB	Weighting	2	A
Response	2	FAST			

Statistics Chart

S090_BLH080004_27022017_080510: Statistics Chart

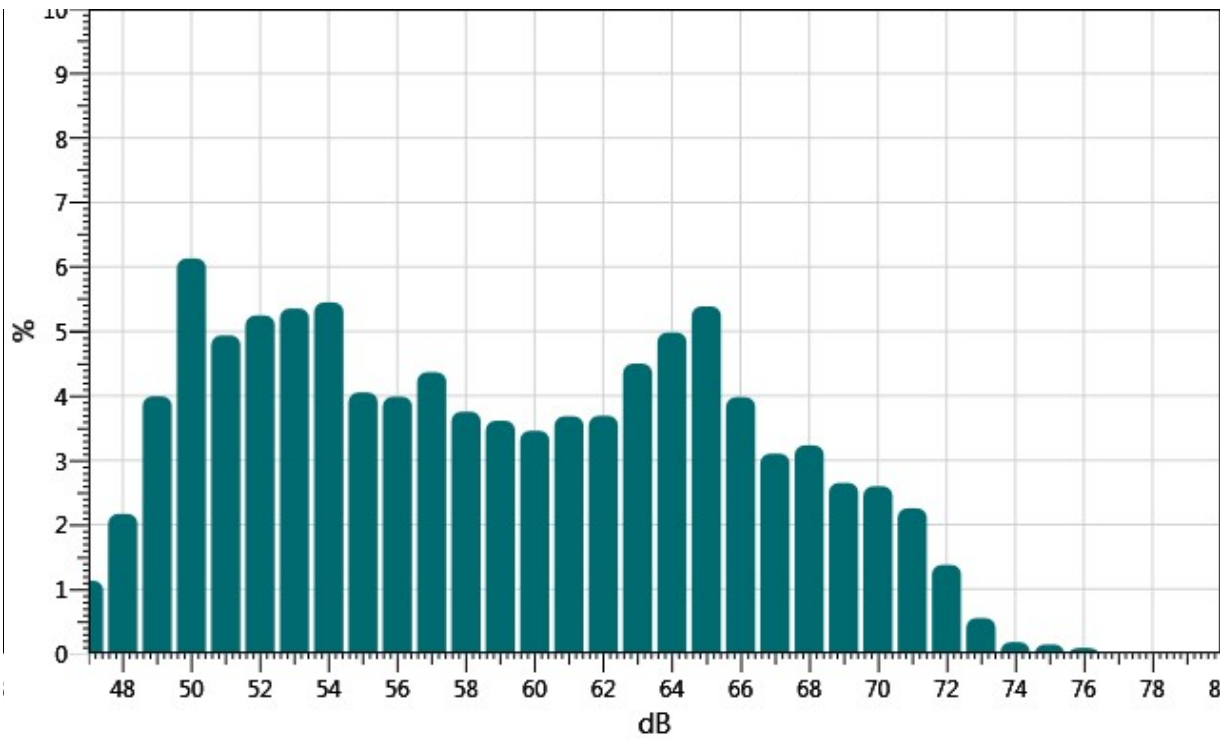

Exceedance Chart

S090_BLH080004_27022017_080510: Exceedance Chart

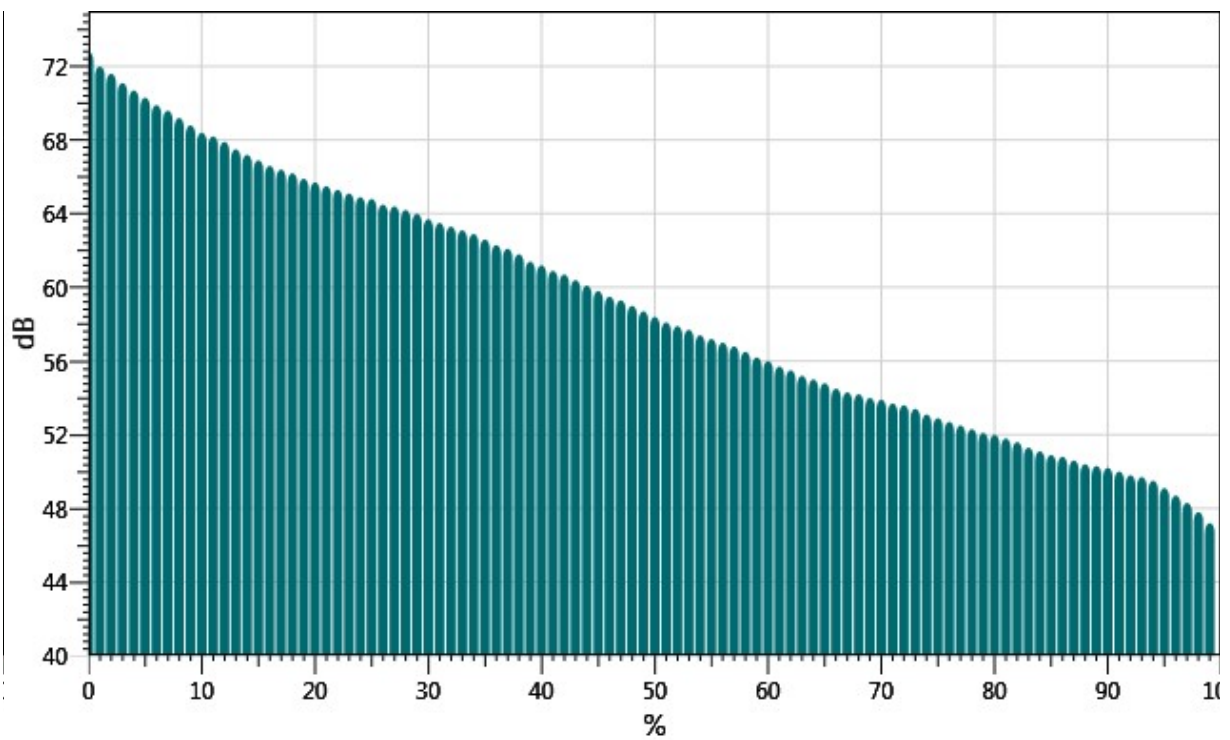

Statistics Table

dB:	0.0	0.1	0.2	0.3	0.4	0.5	0.6	0.7	0.8	0.9	%
47:	0.00	0.00	0.00	0.09	0.17	0.18	0.12	0.13	0.23	0.21	1.13
48:	0.23	0.18	0.21	0.23	0.27	0.16	0.18	0.22	0.22	0.26	2.17
49:	0.30	0.24	0.22	0.23	0.38	0.25	0.52	0.51	0.61	0.73	3.99
50:	0.62	0.54	0.45	0.70	0.67	0.75	0.50	0.66	0.57	0.67	6.13
51:	0.67	0.64	0.35	0.44	0.54	0.47	0.33	0.44	0.56	0.49	4.94
52:	0.53	0.60	0.61	0.48	0.57	0.53	0.55	0.40	0.43	0.55	5.24
53:	0.53	0.47	0.44	0.43	0.43	0.52	0.55	0.61	0.69	0.67	5.35
54:	0.77	0.63	0.51	0.65	0.58	0.54	0.48	0.45	0.44	0.40	5.45
55:	0.36	0.40	0.48	0.46	0.37	0.34	0.34	0.43	0.45	0.41	4.05
56:	0.40	0.38	0.39	0.38	0.38	0.37	0.38	0.38	0.46	0.46	3.98
57:	0.48	0.53	0.35	0.50	0.39	0.45	0.36	0.43	0.47	0.41	4.36
58:	0.36	0.42	0.42	0.42	0.40	0.34	0.34	0.35	0.31	0.38	3.75
59:	0.32	0.34	0.34	0.37	0.39	0.34	0.38	0.36	0.38	0.38	3.61
60:	0.38	0.38	0.24	0.36	0.34	0.34	0.30	0.31	0.35	0.45	3.46
61:	0.45	0.46	0.40	0.40	0.33	0.33	0.34	0.34	0.31	0.32	3.68
62:	0.32	0.34	0.36	0.37	0.34	0.39	0.40	0.37	0.39	0.42	3.69
63:	0.43	0.46	0.30	0.45	0.53	0.46	0.44	0.45	0.52	0.47	4.50
64:	0.47	0.50	0.53	0.48	0.50	0.55	0.49	0.40	0.48	0.59	4.98
65:	0.60	0.58	0.62	0.53	0.48	0.54	0.57	0.60	0.44	0.43	5.39
66:	0.41	0.42	0.28	0.43	0.40	0.40	0.50	0.40	0.38	0.36	3.98
67:	0.35	0.41	0.36	0.35	0.28	0.28	0.28	0.29	0.25	0.25	3.10
68:	0.28	0.34	0.32	0.36	0.41	0.43	0.34	0.25	0.27	0.23	3.23
69:	0.26	0.26	0.19	0.24	0.27	0.29	0.28	0.27	0.29	0.29	2.65
70:	0.28	0.28	0.26	0.27	0.27	0.25	0.23	0.26	0.25	0.26	2.60
71:	0.24	0.18	0.22	0.23	0.22	0.19	0.22	0.22	0.28	0.26	2.25
72:	0.27	0.19	0.12	0.07	0.13	0.14	0.14	0.12	0.12	0.08	1.38
73:	0.07	0.07	0.09	0.08	0.08	0.05	0.05	0.02	0.02	0.03	0.55
74:	0.02	0.03	0.03	0.01	0.01	0.01	0.01	0.01	0.02	0.02	0.18
75:	0.01	0.02	0.03	0.02	0.03	0.01	0.01	0.01	0.01	0.01	0.14
76:	0.01	0.01	0.01	0.01	0.03	0.03	0.00	0.00	0.00	0.00	0.09

Exceedance Table

.	0%	1%	2%	3%	4%	5%	6%	%7	%8	%9
0%:		72.8	72.0	71.6	71.1	70.7	70.3	69.9	69.6	69.2

10%:	68.8	68.4	68.2	67.9	67.5	67.2	66.9	66.6	66.4	66.2
20%:	65.9	65.7	65.5	65.3	65.1	64.9	64.8	64.5	64.4	64.2
30%:	64.0	63.7	63.5	63.3	63.1	62.9	62.6	62.3	62.1	61.8
40%:	61.4	61.2	60.9	60.7	60.4	60.1	59.8	59.5	59.3	59.0
50%:	58.7	58.4	58.1	57.9	57.7	57.4	57.2	57.0	56.8	56.5
60%:	56.2	56.0	55.7	55.5	55.2	55.0	54.8	54.5	54.3	54.2
70%:	54.0	53.9	53.7	53.6	53.4	53.1	52.9	52.7	52.5	52.3
80%:	52.1	52.0	51.8	51.6	51.3	51.1	50.9	50.8	50.6	50.4
90%:	50.3	50.2	50.0	49.8	49.7	49.5	49.1	48.7	48.3	47.8
100%:	47.2									

Logged Data Chart

S090_BLH080004_27022017_080510: Logged Data Chart

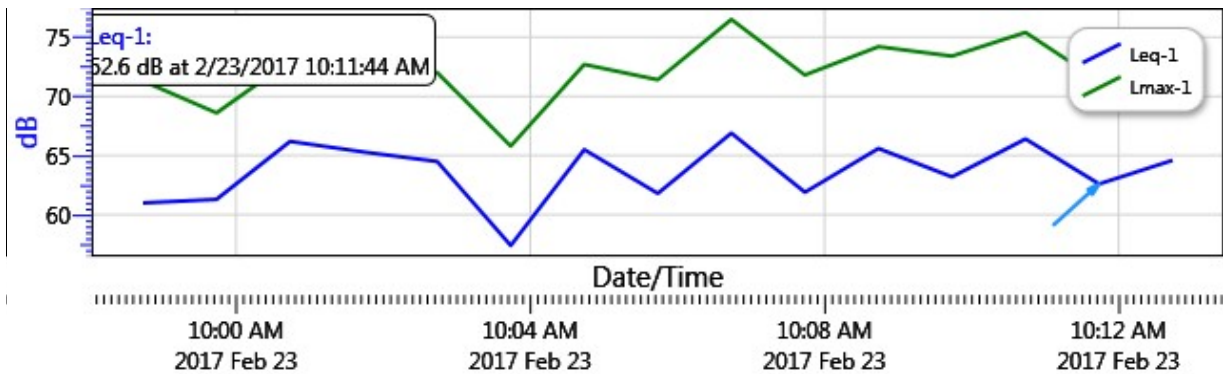



Noise Measurement Report Form – Part A

Date: 2/23/17 Day of Week: Thurs Time: 1020 Project Number: 6016

Monitoring Segment / Area: 003 Monitoring Site Address: 6054 Conehill

Measurement Taken By: S. Seferyn of UltraSystems Environmental

Approximate Wind Speed: 6.8 mph [km/hr] Approximate Wind Direction: From the NW

Approximate distance of sound level meter from receptor location: 12 FT

Approximate distance of sound level meter from construction site: _____
(Leave Blank for Baseline Ambient)

Receptor Land Use (Check One): Residential Institutional Comm./Ind. Recreational

Sound Level Meter: Make and Model: Quest SoundPro DL-1-1/3 Serial Number: BLH080004

Meter Setting: A-Weighted Sound Level (SLOW) A-Weighted Sound Level (FAST)

Measurement Start Time: 1020 Measurement End Time: 1035

Total Measurement Time: 15 mins Session File Name (e.g., S012): S091

Check the measurement purpose:

Baseline condition Ongoing construction Major change Complaint response

Measurement Results

Measurement Type	Measured Levels (dB)	
Calibration	Pre: <u>113.9</u>	Post: <u>113.9</u>
L _{eq} (h)	Slow: <u>58.2</u>	Fast: _____
L _{max}	Slow: <u>69.6</u>	Fast: _____
L ₉₀	Slow: <u>51.3</u>	Fast: _____

Field Notes:

1. Photos: 003
2. moderate traffic
3. _____

Noise Monitor's Signature: [Signature] Date: 2/23/17



Noise Measurement Report Form - Part B

Date: 2/23/17 Day of Week: Thurs Time: 10:20 Project Number: 6016

Monitoring Segment / Area: 003 Monitoring Site Address: 6054 Carnhill Ave.

Site Map

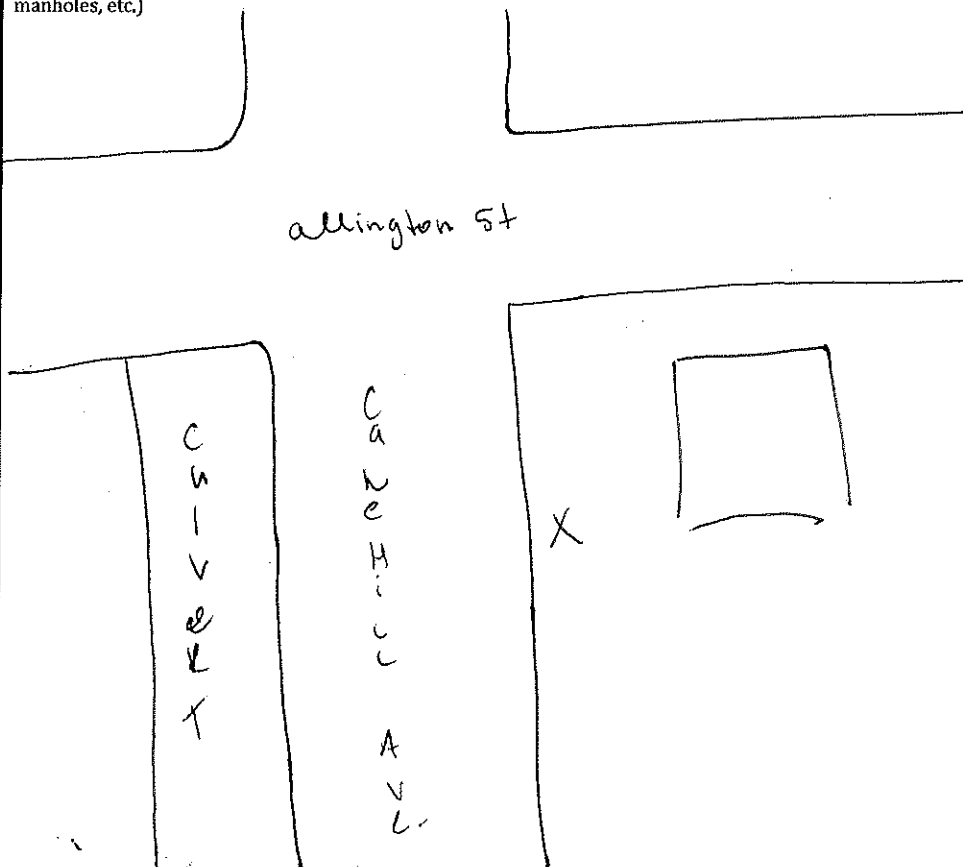
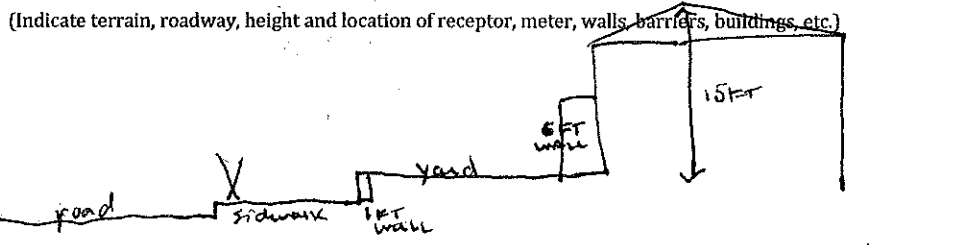
<p>Plan View</p>  <p>North Arrow (fill-in)</p>	<p>(Indicate site location, receptor location, meter location, distance in feet to landmarks, roadways, travel lane directions, geographical objects: trees, water, buildings, signs, store names, hydrants, power & telephone lines, manholes, etc.)</p>  <p>allington st</p> <p>CARNHILL AVE</p>	
<p>Elevation View</p>	<p>(Indicate terrain, roadway, height and location of receptor, meter, walls, barriers, buildings, etc.)</p>  <p>road sidewalk 1FT wall yard 6FT wall 15FT</p>	
<p>Latitude: <u>33.86530</u></p>	<p>Longitude: <u>118.11137</u></p>	<p>Elevation: <u>71</u></p>

Noise Monitor's Signature: [Signature] Date: 2/23/17

Session Report

2/27/2017

Information Panel

Name S091_BLH080004_27022017_080512
Start Time 2/23/2017 10:21:01 AM
Stop Time 2/23/2017 10:36:01 AM
Device Name BLH080004
Model Type SoundPro DL
Device Firmware Rev R.13H
Comments

Summary Data Panel

<u>Description</u>	<u>Meter</u>	<u>Value</u>	<u>Description</u>	<u>Meter</u>	<u>Value</u>
Leq	1	58.2 dB			
Exchange Rate	1	3 dB	Weighting	1	A
Response	1	SLOW	Bandwidth	1	OFF
Exchange Rate	2	3 dB	Weighting	2	A
Response	2	FAST			

Statistics Chart

S091_BLH080004_27022017_080512: Statistics Chart

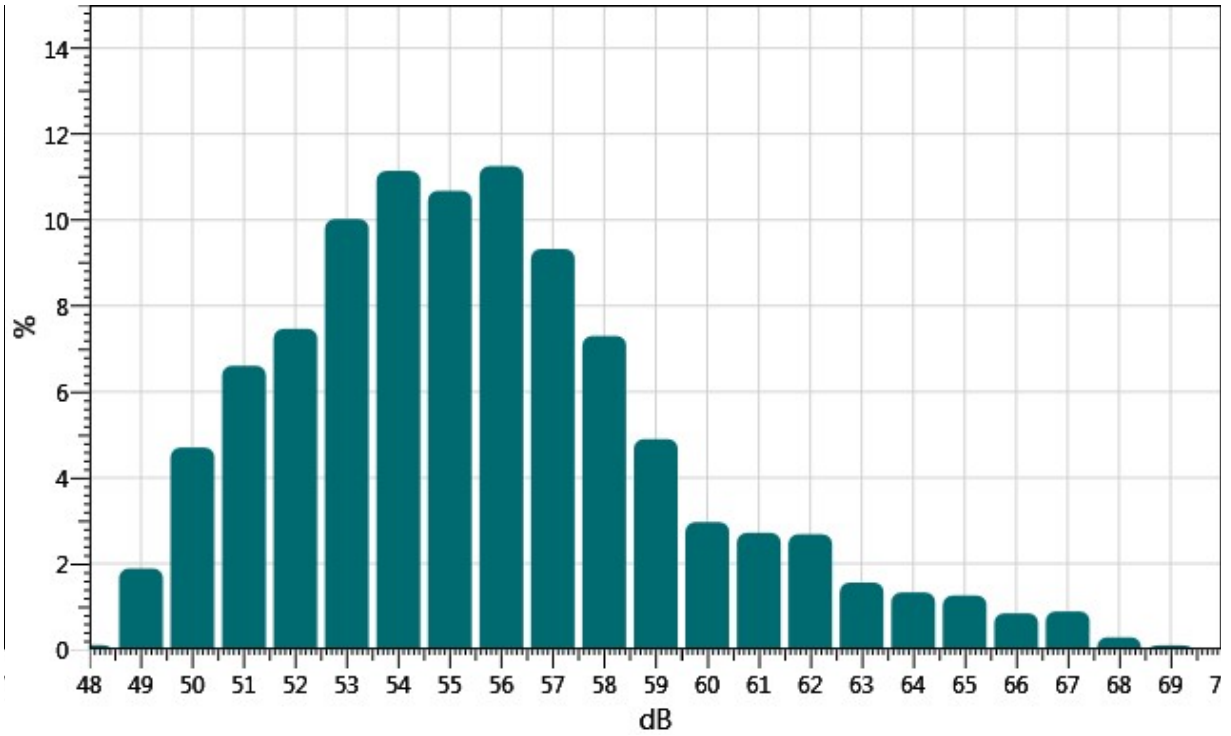

Exceedance Chart

S091_BLH080004_27022017_080512: Exceedance Chart

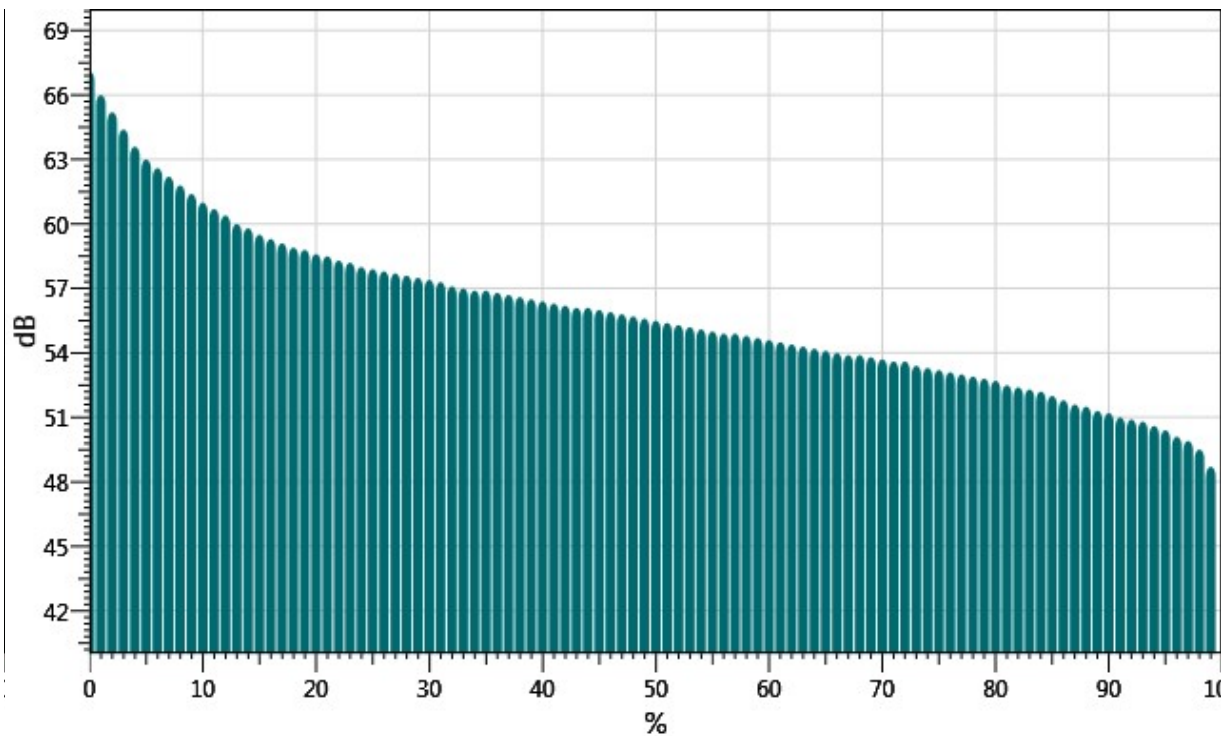

Statistics Table

dB:	0.0	0.1	0.2	0.3	0.4	0.5	0.6	0.7	0.8	0.9	%
48:	0.00	0.00	0.00	0.00	0.00	0.00	0.00	0.00	0.03	0.08	0.11
49:	0.12	0.06	0.13	0.15	0.18	0.22	0.29	0.27	0.18	0.27	1.89
50:	0.31	0.36	0.42	0.43	0.47	0.42	0.57	0.49	0.49	0.74	4.70
51:	0.79	0.82	0.44	0.85	0.73	0.67	0.69	0.63	0.49	0.50	6.61
52:	0.49	0.54	0.53	0.62	0.74	0.96	0.97	0.84	0.87	0.91	7.47
53:	0.86	0.97	0.94	0.86	0.77	0.85	0.97	1.10	1.19	1.51	10.02
54:	1.37	1.30	0.72	0.90	0.99	0.98	1.12	1.03	1.44	1.28	11.14
55:	1.17	1.32	1.04	1.01	1.10	1.06	0.88	1.15	1.04	0.91	10.68
56:	1.06	1.33	1.23	0.99	1.05	1.12	0.96	1.12	1.28	1.12	11.25
57:	1.30	1.20	0.67	0.86	0.88	0.66	0.92	0.84	0.98	1.01	9.32
58:	0.84	0.99	0.87	0.75	0.70	0.58	0.68	0.69	0.63	0.56	7.30
59:	0.56	0.51	0.57	0.56	0.48	0.55	0.40	0.40	0.41	0.46	4.90
60:	0.41	0.40	0.23	0.29	0.24	0.24	0.27	0.31	0.29	0.29	2.97
61:	0.36	0.32	0.29	0.28	0.31	0.26	0.21	0.20	0.22	0.27	2.72
62:	0.21	0.22	0.24	0.29	0.33	0.29	0.33	0.34	0.25	0.18	2.68
63:	0.22	0.22	0.14	0.15	0.14	0.13	0.13	0.16	0.14	0.13	1.56
64:	0.16	0.12	0.13	0.11	0.15	0.15	0.14	0.13	0.12	0.12	1.33
65:	0.12	0.13	0.12	0.16	0.14	0.18	0.16	0.09	0.10	0.08	1.26
66:	0.09	0.10	0.09	0.10	0.07	0.06	0.07	0.08	0.09	0.11	0.85
67:	0.11	0.14	0.09	0.08	0.06	0.07	0.09	0.10	0.07	0.08	0.89
68:	0.05	0.02	0.02	0.03	0.02	0.04	0.05	0.03	0.01	0.01	0.28
69:	0.01	0.01	0.01	0.01	0.02	0.03	0.02	0.00	0.00	0.00	0.10

Exceedance Table

.	0%	1%	2%	3%	4%	5%	6%	%7	%8	%9
0%:		67.1	66.0	65.2	64.4	63.6	63.0	62.6	62.2	61.8
10%:	61.4	61.0	60.7	60.4	60.0	59.8	59.5	59.3	59.1	58.9
20%:	58.8	58.6	58.5	58.3	58.2	58.0	57.9	57.8	57.7	57.6
30%:	57.5	57.4	57.3	57.1	57.0	56.9	56.9	56.8	56.7	56.6
40%:	56.5	56.4	56.3	56.2	56.1	56.1	56.0	55.9	55.8	55.7
50%:	55.6	55.5	55.4	55.3	55.2	55.1	55.0	54.9	54.9	54.8
60%:	54.7	54.6	54.5	54.4	54.3	54.2	54.1	54.0	53.9	53.9
70%:	53.8	53.7	53.6	53.6	53.4	53.3	53.2	53.1	53.0	52.9
80%:	52.8	52.7	52.5	52.4	52.3	52.2	52.0	51.8	51.6	51.5

90%: 51.3 51.2 51.0 50.9 50.8 50.6 50.4 50.1 49.9 49.5
 100%: 48.7

Logged Data Chart

S091_BLH080004_27022017_080512: Logged Data Chart

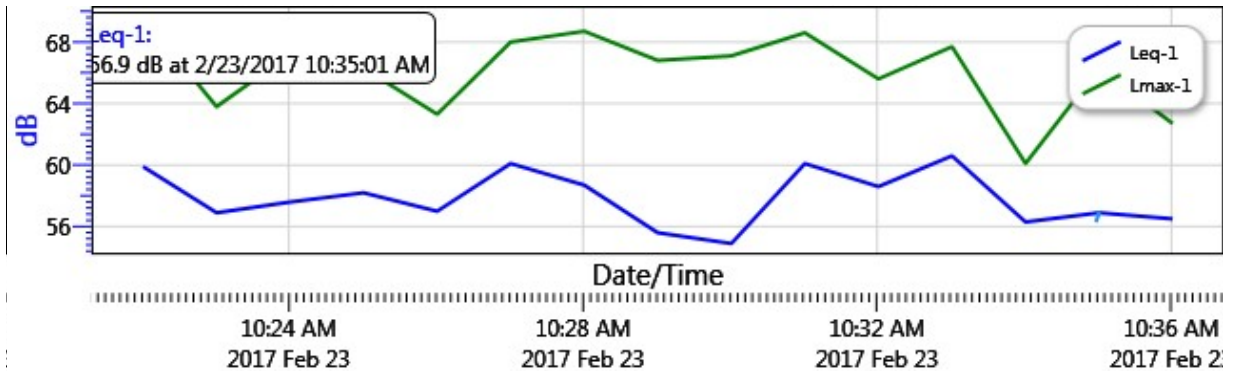



Noise Measurement Report Form - Part A

Date: 2/23/17 Day of Week: Thurs. Time: 1040 Project Number: 6016

Monitoring Segment / Area: 004 Monitoring Site Address: 6014 Canhill Ave.

Measurement Taken By: S. Seferyn of UltraSystems Environmental

Approximate Wind Speed: 0.8 mph [km/hr] Approximate Wind Direction: From the W

Approximate distance of sound level meter from receptor location: 10 ft

Approximate distance of sound level meter from construction site: _____
(Leave Blank for Baseline Ambient)

Receptor Land Use (Check One): Residential Institutional Comm./Ind. Recreational

Sound Level Meter: Make and Model: Quest SoundPro DL-1-1/3 Serial Number: BLH080004

Meter Setting: A-Weighted Sound Level (SLOW) A-Weighted Sound Level (FAST)

Measurement Start Time: 1040 Measurement End Time: 1055

Total Measurement Time: 15 mins Session File Name (e.g., S012): S092

Check the measurement purpose:

Baseline condition Ongoing construction Major change Complaint response

Measurement Results

Measurement Type	Measured Levels (dB)	
Calibration	Pre: <u>113.9</u>	Post: <u>113.9</u>
L _{eq} (h)	Slow: <u>50.1</u>	Fast: _____
L _{max}	Slow: <u>70.7</u>	Fast: _____
L ₉₀	Slow: <u>40.9</u>	Fast: _____

Field Notes:

1. Photo 004
2. _____
3. _____

Noise Monitor's Signature: [Signature] Date: 2/23/17



Noise Measurement Report Form - Part B

Date: 2/23/17 Day of Week: Thurs Time: 1040 Project Number: 6016

Monitoring Segment / Area: 604 Monitoring Site Address: 6014 Canhill Ave

Site Map

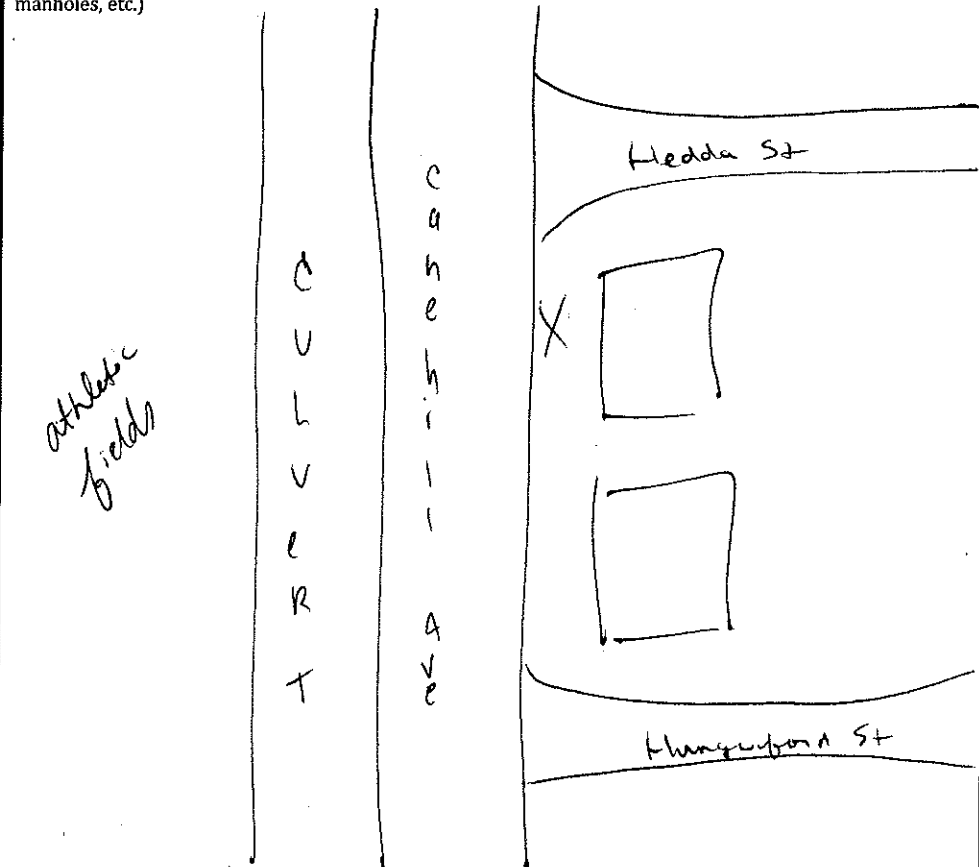
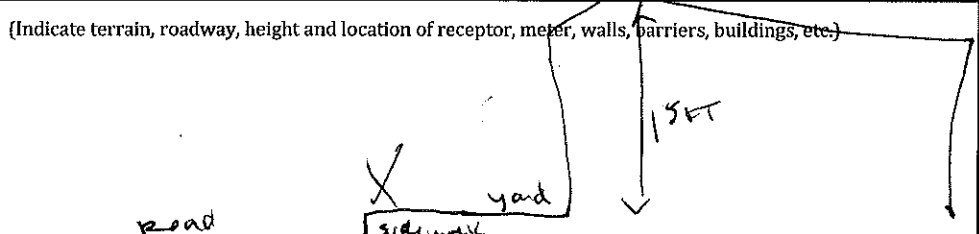
<p>Plan View</p>  <p>North Arrow (fill-in)</p>	<p>(Indicate site location, receptor location, meter location, distance in feet to landmarks, roadways, travel lane directions, geographical objects: trees, water, buildings, signs, store names, hydrants, power & telephone lines, manholes, etc.)</p> 	
<p>Elevation View</p>	<p>(Indicate terrain, roadway, height and location of receptor, meter, walls, barriers, buildings, etc.)</p> 	
<p>Latitude: <u>33.86430</u></p>	<p>Longitude: <u>118.1137</u></p>	<p>Elevation: <u>60</u></p>

Noise Monitor's Signature: Sher Sep Date: 2/23/17

Session Report

2/27/2017

Information Panel

Name S092_BLH080004_27022017_080513
Start Time 2/23/2017 10:41:10 AM
Stop Time 2/23/2017 10:56:10 AM
Device Name BLH080004
Model Type SoundPro DL
Device Firmware Rev R.13H
Comments

Summary Data Panel

<u>Description</u>	<u>Meter</u>	<u>Value</u>	<u>Description</u>	<u>Meter</u>	<u>Value</u>
Leq	1	56.1 dB			
Exchange Rate	1	3 dB	Weighting	1	A
Response	1	SLOW	Bandwidth	1	OFF
Exchange Rate	2	3 dB	Weighting	2	A
Response	2	FAST			

Statistics Chart

S092_BLH080004_27022017_080513: Statistics Chart

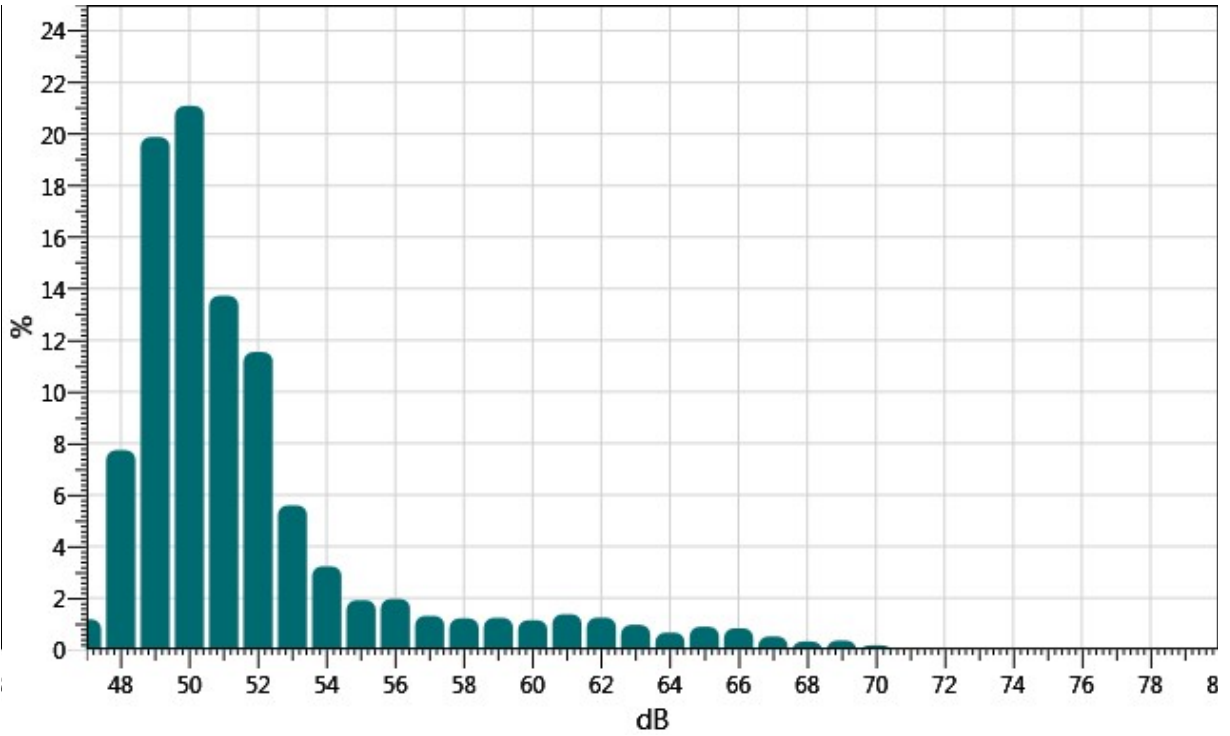

Exceedance Chart

S092_BLH080004_27022017_080513: Exceedance Chart

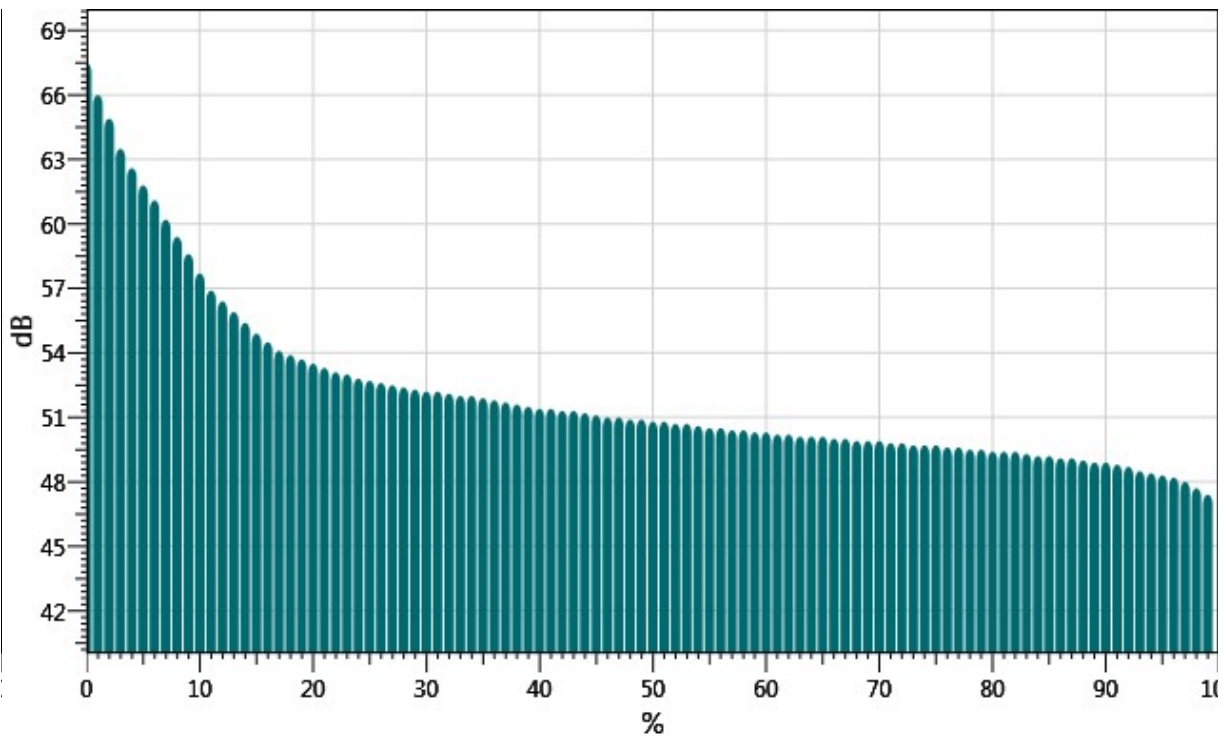

Statistics Table

dB:	0.0	0.1	0.2	0.3	0.4	0.5	0.6	0.7	0.8	0.9	%
47:	0.00	0.00	0.00	0.00	0.00	0.06	0.23	0.43	0.29	0.16	1.17
48:	0.33	0.74	0.48	0.66	0.80	0.96	0.90	0.93	0.84	1.09	7.73
49:	1.26	1.51	1.68	1.72	1.89	2.24	2.39	2.29	2.44	2.47	19.88
50:	2.63	2.46	2.59	2.44	1.80	1.86	1.80	1.53	1.85	2.14	21.09
51:	1.98	1.76	0.93	1.43	1.51	1.55	1.34	1.08	1.09	1.05	13.72
52:	1.13	1.85	1.41	1.20	1.25	1.23	0.93	0.93	0.83	0.79	11.54
53:	0.67	0.67	0.61	0.54	0.57	0.62	0.48	0.47	0.47	0.49	5.60
54:	0.51	0.52	0.24	0.28	0.33	0.27	0.29	0.28	0.29	0.22	3.23
55:	0.15	0.20	0.21	0.23	0.20	0.16	0.18	0.21	0.19	0.19	1.91
56:	0.18	0.20	0.23	0.18	0.19	0.20	0.19	0.24	0.18	0.19	1.96
57:	0.17	0.18	0.11	0.14	0.14	0.11	0.13	0.12	0.11	0.10	1.31
58:	0.12	0.10	0.10	0.11	0.11	0.11	0.10	0.13	0.15	0.18	1.21
59:	0.15	0.12	0.11	0.10	0.12	0.13	0.11	0.12	0.13	0.13	1.23
60:	0.13	0.12	0.07	0.12	0.12	0.11	0.12	0.12	0.11	0.11	1.14
61:	0.11	0.14	0.15	0.16	0.16	0.13	0.14	0.12	0.12	0.13	1.37
62:	0.13	0.12	0.11	0.12	0.18	0.12	0.11	0.11	0.12	0.11	1.24
63:	0.11	0.15	0.07	0.08	0.10	0.12	0.12	0.09	0.06	0.06	0.96
64:	0.05	0.08	0.07	0.07	0.06	0.06	0.05	0.07	0.07	0.08	0.66
65:	0.10	0.09	0.08	0.07	0.07	0.09	0.09	0.10	0.12	0.08	0.89
66:	0.07	0.10	0.07	0.09	0.09	0.10	0.08	0.08	0.09	0.05	0.82
67:	0.05	0.05	0.05	0.05	0.04	0.09	0.05	0.03	0.04	0.05	0.51
68:	0.06	0.05	0.02	0.02	0.03	0.03	0.02	0.02	0.03	0.03	0.31
69:	0.04	0.05	0.06	0.02	0.04	0.03	0.04	0.03	0.03	0.02	0.35
70:	0.01	0.01	0.02	0.03	0.02	0.02	0.05	0.01	0.00	0.00	0.17

Exceedance Table

.	0%	1%	2%	3%	4%	5%	6%	%7	%8	%9
0%:		67.5	66.0	64.9	63.5	62.6	61.8	61.1	60.2	59.4
10%:	58.6	57.7	56.9	56.4	55.9	55.4	54.9	54.5	54.1	53.9
20%:	53.7	53.5	53.3	53.1	53.0	52.8	52.7	52.6	52.5	52.4
30%:	52.3	52.2	52.2	52.1	52.0	52.0	51.9	51.8	51.7	51.6
40%:	51.5	51.4	51.4	51.3	51.3	51.2	51.1	51.0	51.0	50.9
50%:	50.9	50.8	50.8	50.7	50.7	50.6	50.5	50.5	50.4	50.4
60%:	50.3	50.3	50.2	50.2	50.1	50.1	50.1	50.0	50.0	49.9

70%:	49.9	49.9	49.8	49.8	49.7	49.7	49.7	49.6	49.6	49.5
80%:	49.5	49.4	49.4	49.4	49.3	49.2	49.2	49.1	49.1	49.0
90%:	48.9	48.9	48.8	48.7	48.5	48.4	48.3	48.2	48.0	47.7
100%:	47.4									

Logged Data Chart

S092_BLH080004_27022017_080513: Logged Data Chart

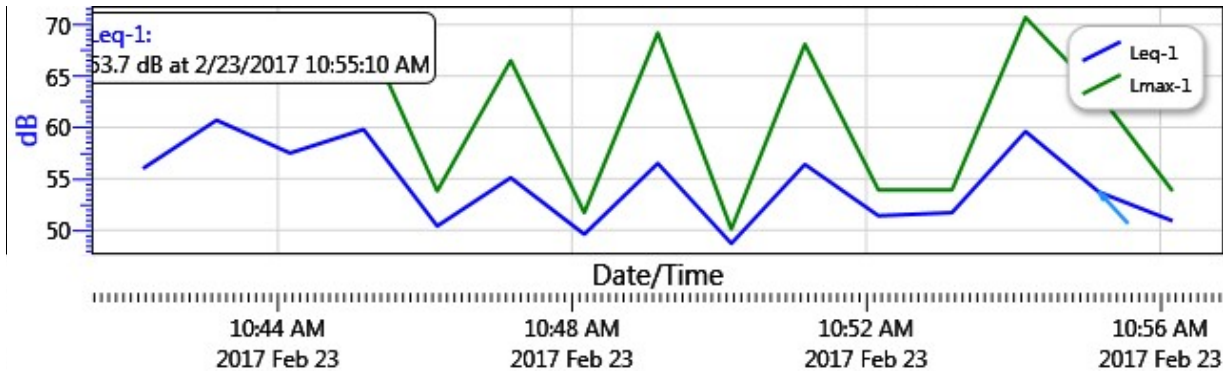



Noise Measurement Report Form – Part A

Date: 2/23/17 Day of Week: Thurs Time: 1058 Project Number: 6016

Monitoring Segment / Area: 045 Monitoring Site Address: 5922 Canehill Ave

Measurement Taken By: S. Seferyn of UltraSystems Environmental

Approximate Wind Speed: 1.5 mph [km/hr] Approximate Wind Direction: From the NW

Approximate distance of sound level meter from receptor location: 60 ft

Approximate distance of sound level meter from construction site: _____
(Leave Blank for Baseline Ambient)

Receptor Land Use (Check One): Residential Institutional Comm./Ind. Recreational

Sound Level Meter: Make and Model: Quest SoundPro DL-1-1/3 Serial Number: BLH080004

Meter Setting: A-Weighted Sound Level (SLOW) A-Weighted Sound Level (FAST)

Measurement Start Time: 1058 Measurement End Time: 1113

Total Measurement Time: 15 mins Session File Name (e.g., S012): S093

Check the measurement purpose:

Baseline condition Ongoing construction Major change Complaint response

Measurement Results

Measurement Type	Measured Levels (dB)	
Calibration	Pre: <u>114.0</u>	Post: <u>114.0</u>
L _{eq} (h)	Slow: <u>58.7</u>	Fast: <u>X</u>
L _{max}	Slow: <u>72.7</u>	Fast: <u>X</u>
L ₉₀	Slow: <u>48.8</u>	Fast: <u>X</u>

Field Notes:

1. Photo 045
2. _____
3. _____

Noise Monitor's Signature: S. Seferyn Date: 2/23/17



Noise Measurement Report Form - Part B

Date: 2/23/17 Day of Week: Thurs Time: 1058 Project Number: 6016

Monitoring Segment / Area: dfs Monitoring Site Address: 5922 Canhill Ave.

Site Map

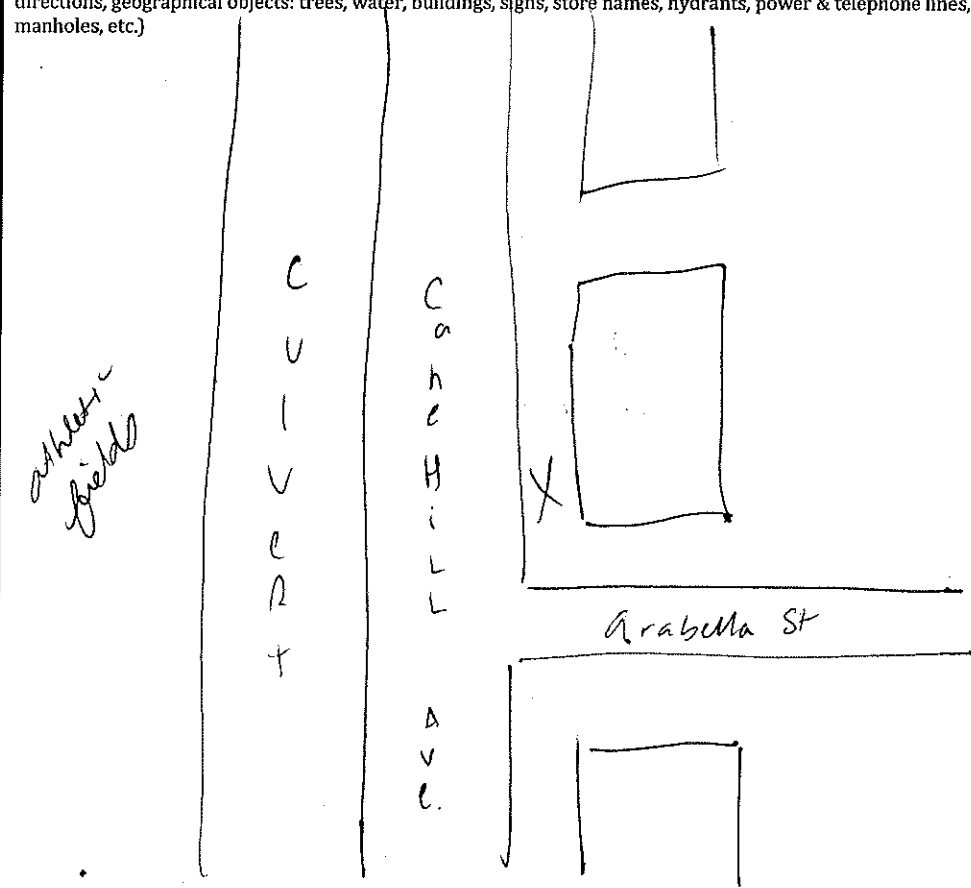
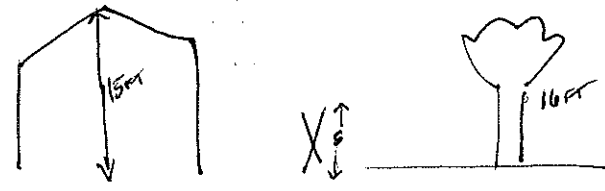
<p>Plan View</p>  <p>North Arrow (fill-in)</p>	<p>(Indicate site location, receptor location, meter location, distance in feet to landmarks, roadways, travel lane directions, geographical objects: trees, water, buildings, signs, store names, hydrants, power & telephone lines, manholes, etc.)</p> 	
<p>Elevation View</p>	<p>(Indicate terrain, roadway, height and location of receptor, meter, walls, barriers, buildings, etc.)</p> 	
<p>Latitude: <u>33.86331</u></p>	<p>Longitude: <u>118.11134</u></p>	<p>Elevation: <u>62</u></p>

Noise Monitor's Signature: [Signature] Date: 2/23/17

Session Report

2/27/2017

Information Panel

Name S093_BLH080004_27022017_080514
Start Time 2/23/2017 10:59:50 AM
Stop Time 2/23/2017 11:14:50 AM
Device Name BLH080004
Model Type SoundPro DL
Device Firmware Rev R.13H
Comments

Summary Data Panel

<u>Description</u>	<u>Meter</u>	<u>Value</u>	<u>Description</u>	<u>Meter</u>	<u>Value</u>
Leq	1	58.7 dB			
Exchange Rate	1	3 dB	Weighting	1	A
Response	1	SLOW	Bandwidth	1	OFF
Exchange Rate	2	3 dB	Weighting	2	A
Response	2	FAST			

Statistics Chart

S093_BLH080004_27022017_080514: Statistics Chart

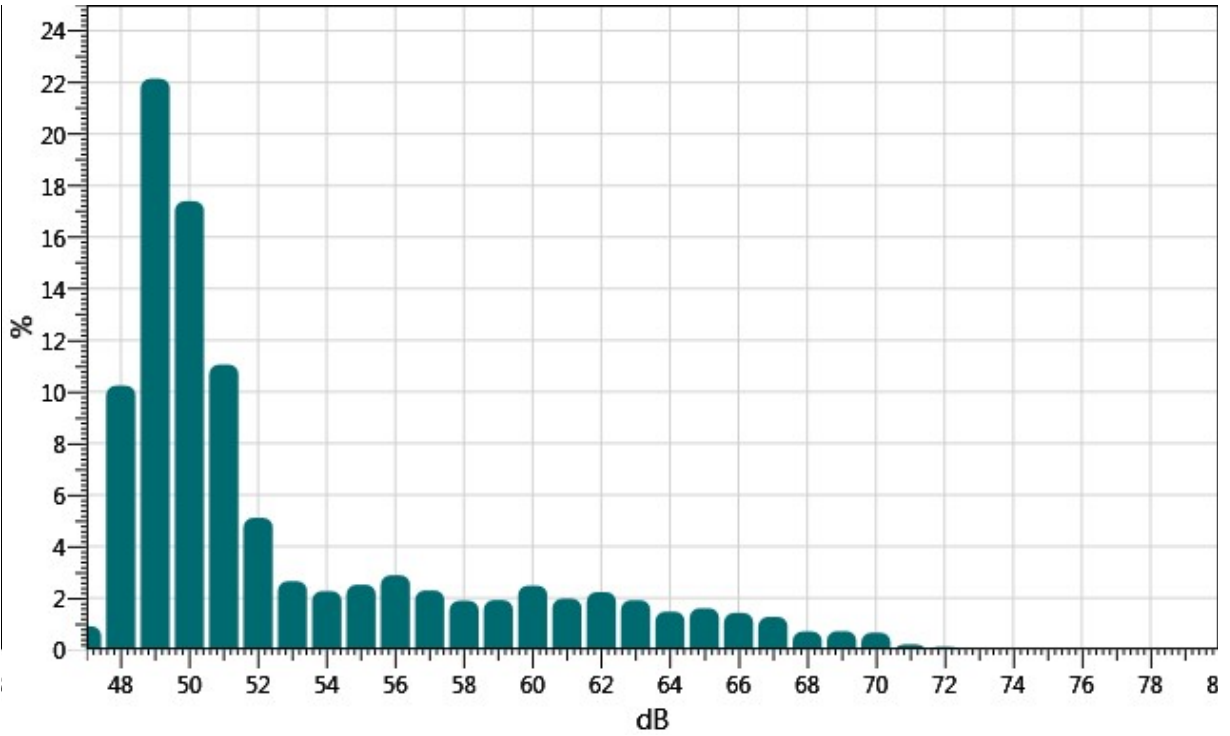

Exceedance Chart

S093_BLH080004_27022017_080514: Exceedance Chart

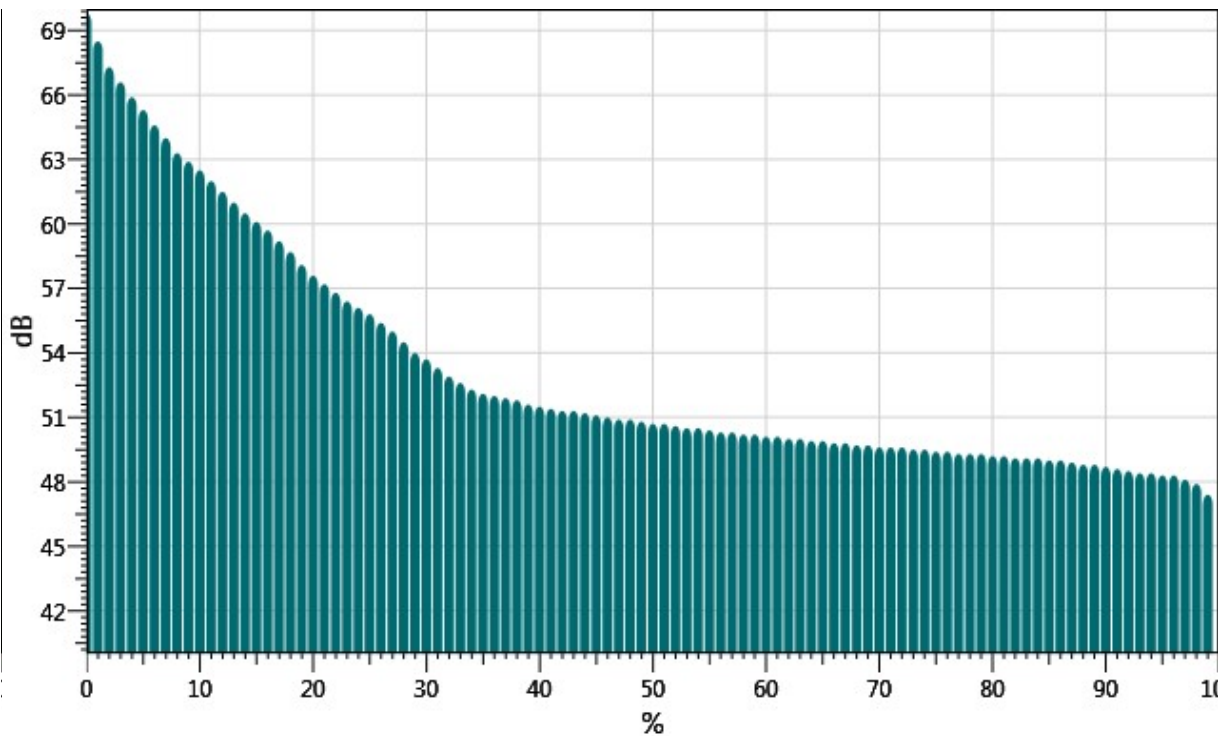

Statistics Table

dB:	0.0	0.1	0.2	0.3	0.4	0.5	0.6	0.7	0.8	0.9	%
47:	0.00	0.00	0.00	0.00	0.00	0.02	0.05	0.05	0.41	0.38	0.90
48:	0.34	0.59	0.30	0.77	1.45	1.76	1.31	1.03	1.03	1.66	10.24
49:	1.76	2.03	2.47	2.30	2.54	2.40	2.23	2.18	2.05	2.17	22.14
50:	2.45	2.23	1.73	1.87	1.66	1.49	1.54	1.37	1.43	1.62	17.39
51:	1.80	1.45	0.80	1.03	1.29	1.10	1.15	0.79	0.81	0.83	11.06
52:	0.73	0.82	0.76	0.60	0.45	0.45	0.38	0.30	0.29	0.32	5.11
53:	0.32	0.29	0.23	0.20	0.21	0.23	0.32	0.31	0.22	0.31	2.65
54:	0.25	0.28	0.18	0.23	0.19	0.22	0.22	0.20	0.23	0.26	2.27
55:	0.20	0.22	0.20	0.24	0.21	0.20	0.22	0.37	0.33	0.32	2.51
56:	0.32	0.29	0.39	0.30	0.24	0.24	0.29	0.27	0.27	0.26	2.88
57:	0.24	0.28	0.20	0.30	0.24	0.26	0.20	0.23	0.18	0.16	2.29
58:	0.21	0.23	0.17	0.18	0.18	0.17	0.18	0.18	0.18	0.21	1.89
59:	0.22	0.20	0.23	0.15	0.16	0.17	0.23	0.18	0.18	0.20	1.92
60:	0.28	0.39	0.21	0.22	0.23	0.25	0.24	0.23	0.22	0.21	2.48
61:	0.21	0.20	0.21	0.17	0.16	0.19	0.18	0.20	0.18	0.28	1.98
62:	0.17	0.21	0.24	0.21	0.21	0.18	0.20	0.20	0.27	0.33	2.23
63:	0.25	0.24	0.18	0.23	0.20	0.17	0.16	0.16	0.16	0.16	1.92
64:	0.14	0.16	0.12	0.14	0.16	0.16	0.15	0.17	0.13	0.14	1.47
65:	0.14	0.13	0.14	0.17	0.19	0.16	0.20	0.14	0.14	0.18	1.60
66:	0.15	0.17	0.12	0.18	0.21	0.14	0.11	0.09	0.16	0.10	1.42
67:	0.10	0.15	0.12	0.13	0.15	0.17	0.13	0.15	0.08	0.09	1.27
68:	0.09	0.07	0.05	0.05	0.04	0.05	0.06	0.07	0.12	0.10	0.70
69:	0.12	0.07	0.05	0.06	0.05	0.06	0.10	0.07	0.06	0.07	0.71
70:	0.07	0.06	0.09	0.11	0.06	0.12	0.03	0.05	0.03	0.02	0.65
71:	0.03	0.04	0.02	0.04	0.02	0.02	0.01	0.01	0.01	0.01	0.21
72:	0.01	0.01	0.01	0.01	0.01	0.02	0.02	0.02	0.00	0.00	0.11

Exceedance Table

.	0%	1%	2%	3%	4%	5%	6%	%7	%8	%9
0%:		69.8	68.5	67.3	66.6	65.9	65.3	64.6	64.0	63.3
10%:	62.9	62.5	62.0	61.5	61.0	60.5	60.1	59.7	59.2	58.7
20%:	58.1	57.6	57.2	56.8	56.4	56.1	55.8	55.4	55.0	54.5
30%:	54.0	53.7	53.3	52.9	52.6	52.3	52.1	52.0	51.9	51.8
40%:	51.6	51.5	51.4	51.3	51.3	51.2	51.1	51.0	50.9	50.9

50%:	50.8	50.7	50.7	50.6	50.5	50.5	50.4	50.3	50.3	50.2
60%:	50.2	50.1	50.1	50.0	50.0	49.9	49.9	49.8	49.8	49.7
70%:	49.7	49.6	49.6	49.6	49.5	49.5	49.4	49.4	49.3	49.3
80%:	49.3	49.2	49.2	49.1	49.1	49.1	49.0	49.0	48.9	48.8
90%:	48.8	48.7	48.6	48.5	48.4	48.4	48.3	48.3	48.1	47.9
100%:	47.4									

Logged Data Chart

S093_BLH080004_27022017_080514: Logged Data Chart

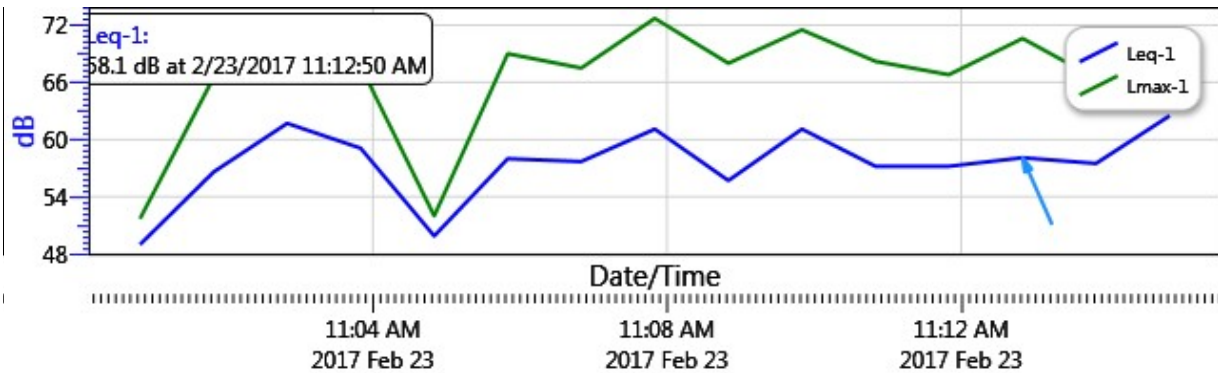



Noise Measurement Report Form - Part A

Date: 2/23/17 Day of Week: Thurs Time: 1118 Project Number: 606

Monitoring Segment / Area: 006 Monitoring Site Address: 5900 Canwell Ave.
ESTHER LINDSTROM SCHOOL

Measurement Taken By: S. Seferyr of UltraSystems Environmental

Approximate Wind Speed: 1.5 mph [km/hr] Approximate Wind Direction: From the N

Approximate distance of sound level meter from receptor location: 45 FT

Approximate distance of sound level meter from construction site: _____
(Leave Blank for Baseline Ambient)

Receptor Land Use (Check One): Residential Institutional Comm./Ind. Recreational

Sound Level Meter: Make and Model: Quest SoundPro DL-1-1/3 Serial Number: BLH080004

Meter Setting: A-Weighted Sound Level (SLOW) A-Weighted Sound Level (FAST)

Measurement Start Time: 1118 Measurement End Time: 1133

Total Measurement Time: 15 mins Session File Name (e.g., S012): S094

Check the measurement purpose:

Baseline condition Ongoing construction Major change Complaint response

Measurement Results

Measurement Type	Measured Levels (dB)	
Calibration	Pre: <u>113.9</u>	Post: <u>none - see</u>
Leq (h)	Slow: <u>54.5</u>	Fast: <u>X</u>
Lmax	Slow: <u>70.0</u>	Fast: <u>X</u>
L90	Slow: <u>48.5</u>	Fast: <u>X</u>

Field Notes:

- Photo 006
- _____
- _____

Noise Monitor's Signature: S. Seferyr Date: 2/23/17



Noise Measurement Report Form – Part B

Date: 2/23/17 Day of Week: Thurs Time: 1110 Project Number: 6016
Monitoring Segment / Area: 006 Monitoring Site Address: 5900 of Carehill / Esther Lindstrom School

Site Map

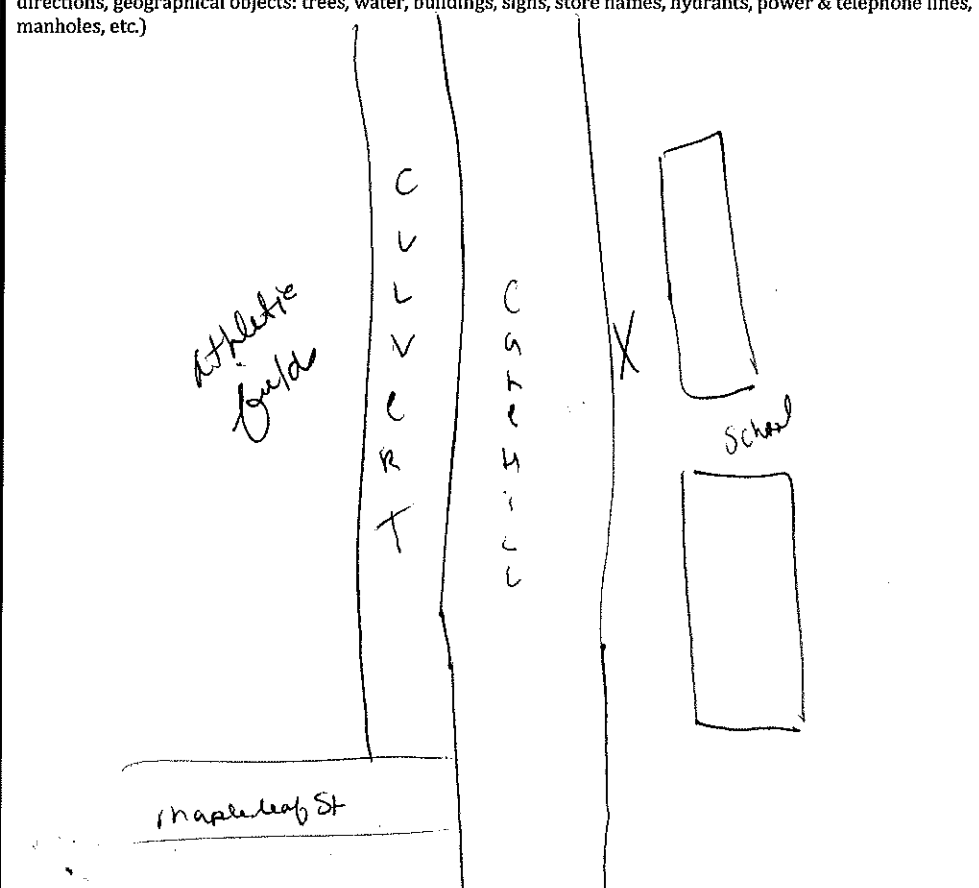
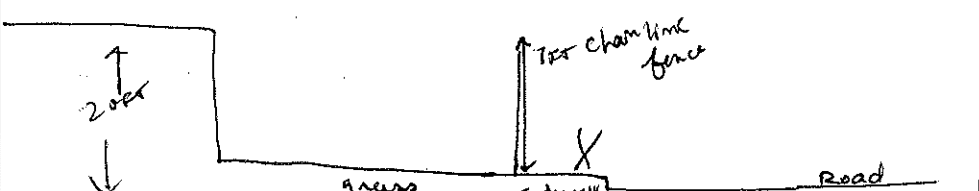
<p>Plan View</p>  <p>North Arrow (fill-in)</p>	<p>(Indicate site location, receptor location, meter location, distance in feet to landmarks, roadways, travel lane directions, geographical objects: trees, water, buildings, signs, store names, hydrants, power & telephone lines, manholes, etc.)</p> 	
<p>Elevation View</p>	<p>(Indicate terrain, roadway, height and location of receptor, meter, walls, barriers, buildings, etc.)</p> 	
<p>Latitude: <u>33.86238</u></p>	<p>Longitude: <u>118.1105</u></p>	<p>Elevation: <u>67</u></p>

Noise Monitor's Signature: [Signature] Date: 2/23/17

Session Report

2/27/2017

Information Panel

Name S094_BLH080004_27022017_080515
Start Time 2/23/2017 11:19:19 AM
Stop Time 2/23/2017 11:34:19 AM
Device Name BLH080004
Model Type SoundPro DL
Device Firmware Rev R.13H
Comments

Summary Data Panel

<u>Description</u>	<u>Meter</u>	<u>Value</u>	<u>Description</u>	<u>Meter</u>	<u>Value</u>
Leq	1	54.5 dB			
Exchange Rate	1	3 dB	Weighting	1	A
Response	1	SLOW	Bandwidth	1	OFF
Exchange Rate	2	3 dB	Weighting	2	A
Response	2	FAST			

Statistics Chart

S094_BLH080004_27022017_080515: Statistics Chart

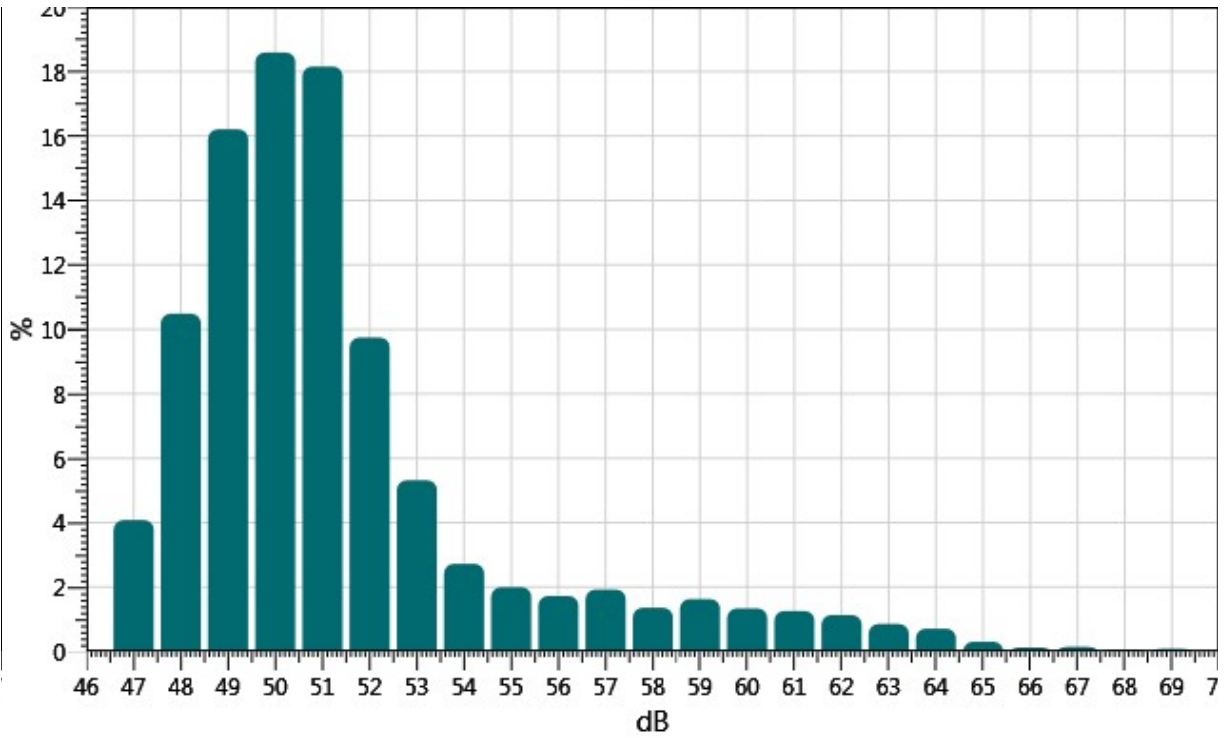

Exceedance Chart

S094_BLH080004_27022017_080515: Exceedance Chart

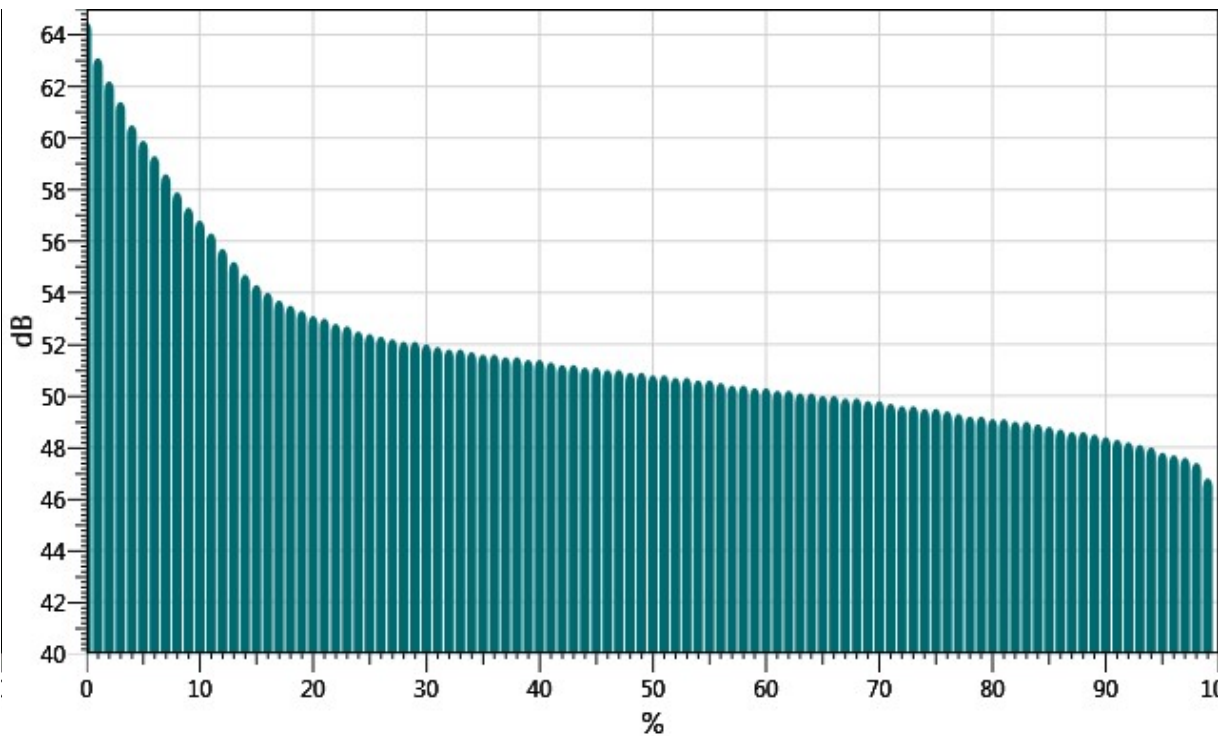

Statistics Table

dB:	0.0	0.1	0.2	0.3	0.4	0.5	0.6	0.7	0.8	0.9	%
46:	0.00	0.00	0.00	0.00	0.00	0.00	0.00	0.00	0.00	0.03	0.03
47:	0.10	0.09	0.20	0.20	0.26	0.50	0.53	0.64	0.64	0.92	4.08
48:	0.88	0.90	0.64	1.07	0.85	1.13	1.03	1.39	1.35	1.22	10.48
49:	1.21	1.77	1.80	1.75	1.52	1.34	1.56	1.62	1.80	1.82	16.20
50:	2.04	1.74	1.89	1.83	1.81	2.00	1.74	1.71	1.75	2.07	18.59
51:	2.03	2.33	1.63	1.75	1.68	1.87	2.01	1.68	1.60	1.58	18.15
52:	1.28	1.10	1.30	1.21	1.06	0.90	0.77	0.71	0.64	0.77	9.74
53:	0.69	0.60	0.54	0.54	0.56	0.54	0.56	0.47	0.43	0.37	5.31
54:	0.35	0.36	0.23	0.28	0.28	0.27	0.27	0.27	0.22	0.19	2.72
55:	0.19	0.21	0.24	0.20	0.20	0.20	0.22	0.20	0.16	0.16	2.00
56:	0.14	0.15	0.14	0.17	0.18	0.23	0.16	0.20	0.20	0.16	1.73
57:	0.20	0.20	0.17	0.19	0.22	0.20	0.20	0.21	0.18	0.14	1.92
58:	0.15	0.13	0.15	0.11	0.14	0.15	0.14	0.15	0.12	0.11	1.36
59:	0.13	0.13	0.13	0.14	0.15	0.11	0.13	0.16	0.25	0.30	1.63
60:	0.28	0.28	0.11	0.10	0.10	0.10	0.10	0.10	0.09	0.09	1.34
61:	0.09	0.12	0.16	0.14	0.09	0.14	0.14	0.14	0.12	0.13	1.26
62:	0.12	0.14	0.13	0.11	0.09	0.12	0.08	0.09	0.12	0.13	1.13
63:	0.09	0.15	0.08	0.11	0.13	0.05	0.06	0.07	0.06	0.06	0.85
64:	0.09	0.07	0.07	0.09	0.07	0.07	0.08	0.05	0.07	0.05	0.71
65:	0.03	0.04	0.05	0.06	0.06	0.01	0.01	0.01	0.01	0.01	0.30
66:	0.01	0.01	0.01	0.01	0.01	0.01	0.01	0.02	0.01	0.01	0.13
67:	0.01	0.02	0.02	0.02	0.04	0.01	0.01	0.01	0.01	0.01	0.15
68:	0.01	0.01	0.00	0.01	0.01	0.01	0.01	0.01	0.01	0.01	0.06
69:	0.01	0.01	0.01	0.01	0.01	0.01	0.01	0.01	0.01	0.02	0.09
70:	0.02	0.00	0.00	0.00	0.00	0.00	0.00	0.00	0.00	0.00	0.02

Exceedance Table

.	0%	1%	2%	3%	4%	5%	6%	%7	%8	%9
0%:		64.5	63.1	62.2	61.4	60.5	59.9	59.3	58.6	57.9
10%:	57.3	56.8	56.3	55.7	55.2	54.7	54.3	54.0	53.7	53.5
20%:	53.3	53.1	53.0	52.8	52.7	52.5	52.4	52.3	52.2	52.1
30%:	52.1	52.0	51.9	51.8	51.8	51.7	51.6	51.6	51.5	51.5
40%:	51.4	51.4	51.3	51.2	51.2	51.1	51.1	51.0	51.0	50.9
50%:	50.9	50.8	50.8	50.7	50.7	50.6	50.6	50.5	50.4	50.4

60%:	50.3	50.3	50.2	50.2	50.1	50.1	50.0	50.0	49.9	49.9
70%:	49.8	49.8	49.7	49.6	49.6	49.5	49.5	49.4	49.3	49.2
80%:	49.2	49.1	49.1	49.0	49.0	48.9	48.8	48.7	48.6	48.6
90%:	48.5	48.4	48.3	48.2	48.1	48.0	47.8	47.7	47.6	47.4
100%:	46.8									

Logged Data Chart

S094_BLH080004_27022017_080515: Logged Data Chart

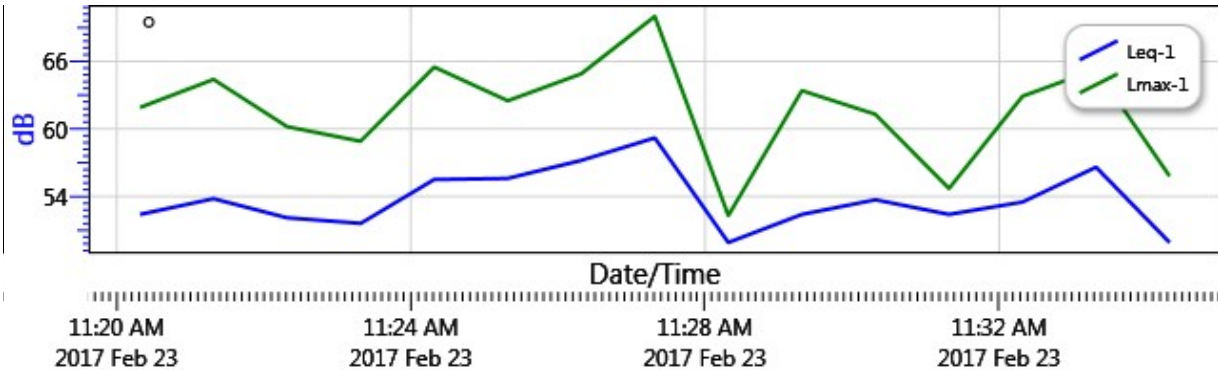



Noise Measurement Report Form – Part A

Date: 2/23/17 Day of Week: Thurs Time: 1140 Project Number: 6016

Monitoring Segment / Area: φφ7 Monitoring Site Address: 5815 Snowden Ave.

Measurement Taken By: S. Seferyn of UltraSystems Environmental

Approximate Wind Speed: 6.0 mph [km/hr] Approximate Wind Direction: From the N

Approximate distance of sound level meter from receptor location: 14 ft

Approximate distance of sound level meter from construction site: _____
(Leave Blank for Baseline Ambient)

Receptor Land Use (Check One): Residential Institutional Comm./Ind. Recreational

Sound Level Meter: Make and Model: Quest SoundPro DL-1-1/3 Serial Number: BLH080004

Meter Setting: A-Weighted Sound Level (SLOW) A-Weighted Sound Level (FAST)

Measurement Start Time: 1140 Measurement End Time: 1155

Total Measurement Time: 15 mins Session File Name (e.g., S012): S095

Check the measurement purpose:

Baseline condition Ongoing construction Major change Complaint response

Measurement Results

Measurement Type	Measured Levels (dB)	
Calibration	Pre: <u>113.9</u>	Post: <u>113.9</u>
L _{eq} (h)	Slow: <u>64.4</u>	Fast: _____
L _{max}	Slow: <u>64.5</u>	Fast: _____
L ₉₀	Slow: <u>49.8</u>	Fast: _____

Field Notes:

1. Photo φφ7
2. _____
3. _____

Noise Monitor's Signature: [Signature] Date: 2/23/17



Noise Measurement Report Form - Part B

Date: 2/23/17 Day of Week: Thurs Time: 1146 Project Number: 6816

Monitoring Segment / Area: 007 Monitoring Site Address: 5815 Snowden Ave.

Site Map

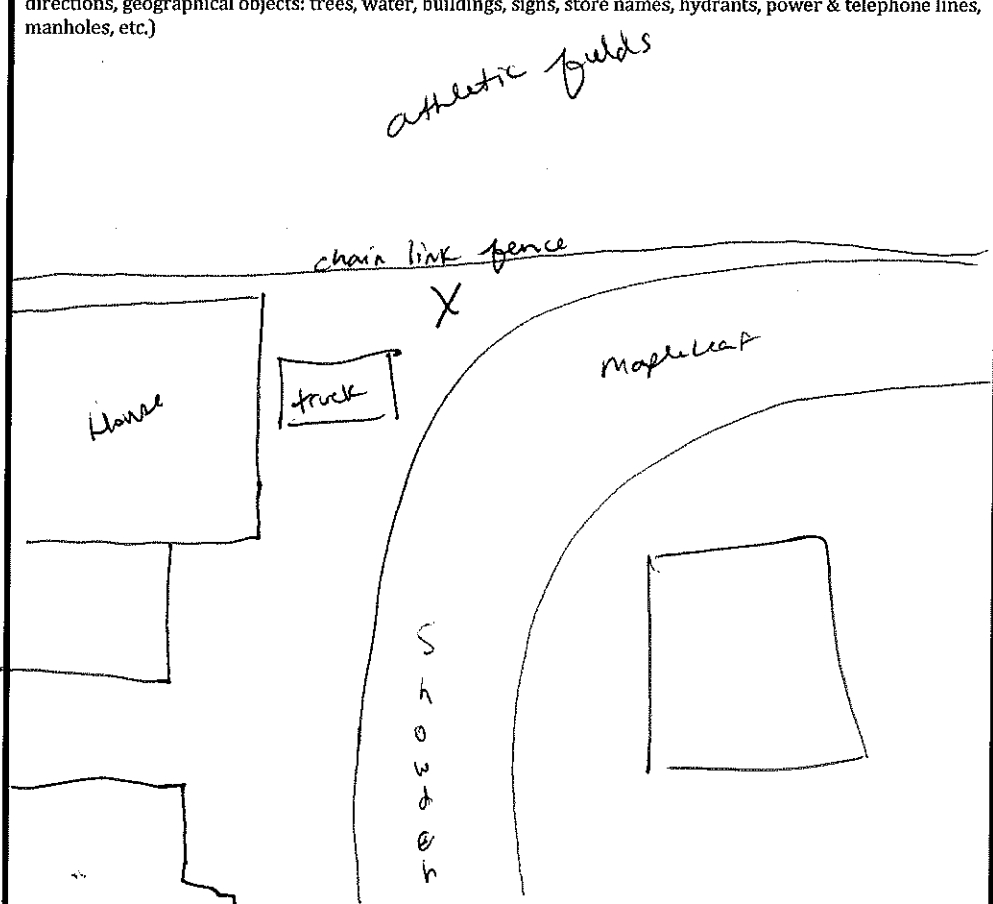
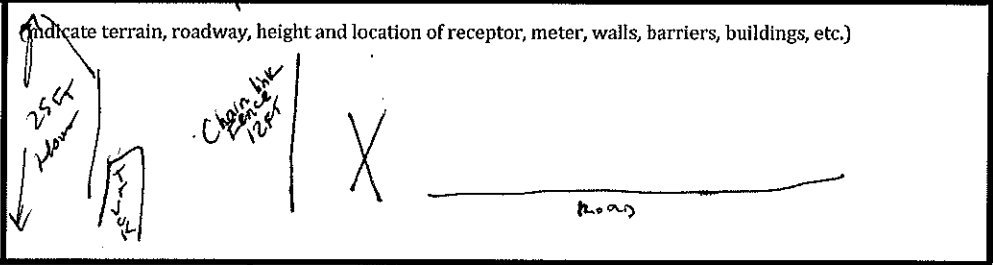
<p>Plan View</p>  <p>North Arrow (fill-in)</p>	<p>(Indicate site location, receptor location, meter location, distance in feet to landmarks, roadways, travel lane directions, geographical objects: trees, water, buildings, signs, store names, hydrants, power & telephone lines, manholes, etc.)</p> 	
<p>Elevation View</p>	<p>(Indicate terrain, roadway, height and location of receptor, meter, walls, barriers, buildings, etc.)</p> 	
<p>Latitude: <u>33.86192</u></p>	<p>Longitude: <u>118.112189</u></p>	<p>Elevation: <u>78</u></p>

Noise Monitor's Signature: *[Signature]* Date: 2/23/17

Session Report

2/27/2017

Information Panel

Name S095_BLH080004_27022017_080515
Start Time 2/23/2017 11:41:31 AM
Stop Time 2/23/2017 11:56:31 AM
Device Name BLH080004
Model Type SoundPro DL
Device Firmware Rev R.13H
Comments

Summary Data Panel

<u>Description</u>	<u>Meter</u>	<u>Value</u>	<u>Description</u>	<u>Meter</u>	<u>Value</u>
Leq	1	54.3 dB			
Exchange Rate	1	3 dB	Weighting	1	A
Response	1	SLOW	Bandwidth	1	OFF
Exchange Rate	2	3 dB	Weighting	2	A
Response	2	FAST			

Statistics Chart

S095_BLH080004_27022017_080515: Statistics Chart

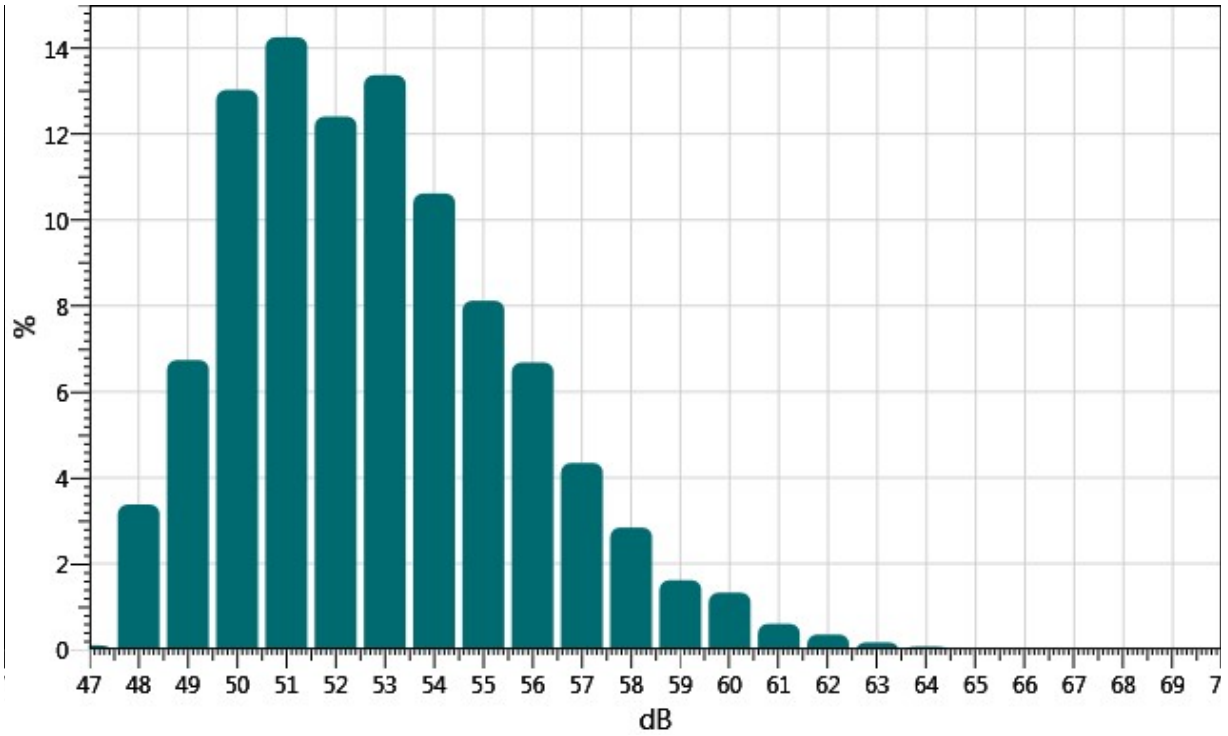

Exceedance Chart

S095_BLH080004_27022017_080515: Exceedance Chart

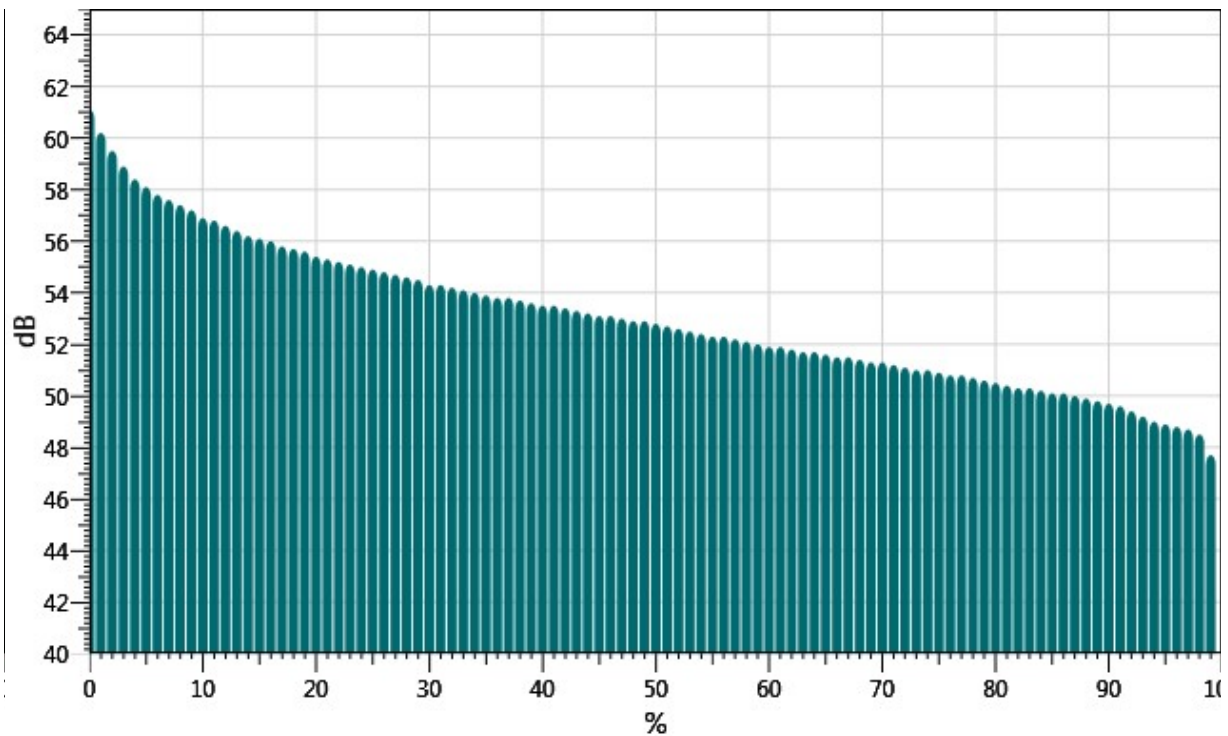

Statistics Table

dB:	0.0	0.1	0.2	0.3	0.4	0.5	0.6	0.7	0.8	0.9	%
47:	0.00	0.00	0.00	0.00	0.00	0.00	0.00	0.00	0.02	0.08	0.10
48:	0.03	0.08	0.11	0.14	0.21	0.13	0.24	0.54	0.87	1.02	3.38
49:	0.94	0.65	0.47	0.54	0.51	0.64	0.68	0.64	0.69	0.98	6.74
50:	1.22	1.30	1.50	1.44	1.57	1.10	1.24	1.18	1.12	1.36	13.03
51:	1.49	1.81	0.86	1.25	1.47	1.52	1.37	1.35	1.70	1.43	14.25
52:	1.59	1.36	1.20	1.22	1.30	1.37	1.11	1.02	0.99	1.23	12.41
53:	1.45	1.49	1.24	1.47	1.31	1.11	1.26	1.46	1.27	1.31	13.37
54:	1.40	1.29	0.77	1.20	1.11	0.91	0.87	0.95	1.11	1.01	10.62
55:	1.07	0.93	0.91	0.79	0.81	0.79	0.72	0.67	0.74	0.69	8.12
56:	0.92	0.72	0.73	0.69	0.66	0.62	0.52	0.56	0.57	0.70	6.68
57:	0.45	0.41	0.30	0.47	0.46	0.58	0.46	0.45	0.36	0.40	4.34
58:	0.35	0.37	0.33	0.31	0.31	0.29	0.26	0.26	0.20	0.15	2.84
59:	0.16	0.14	0.21	0.18	0.19	0.14	0.18	0.14	0.13	0.15	1.61
60:	0.17	0.18	0.12	0.21	0.13	0.10	0.11	0.12	0.10	0.08	1.32
61:	0.09	0.07	0.08	0.10	0.06	0.06	0.04	0.03	0.03	0.03	0.60
62:	0.05	0.04	0.04	0.03	0.03	0.03	0.06	0.02	0.03	0.03	0.35
63:	0.02	0.03	0.01	0.02	0.02	0.02	0.02	0.01	0.01	0.01	0.17
64:	0.01	0.01	0.01	0.01	0.01	0.01	0.00	0.00	0.00	0.00	0.07

Exceedance Table

.	0%	1%	2%	3%	4%	5%	6%	%7	%8	%9
0%:		61.1	60.2	59.5	58.9	58.4	58.1	57.8	57.6	57.4
10%:	57.2	56.9	56.8	56.6	56.4	56.2	56.1	56.0	55.8	55.7
20%:	55.6	55.4	55.3	55.2	55.1	55.0	54.9	54.8	54.7	54.6
30%:	54.5	54.3	54.3	54.2	54.1	54.0	53.9	53.8	53.8	53.7
40%:	53.6	53.5	53.5	53.4	53.3	53.2	53.1	53.1	53.0	52.9
50%:	52.9	52.8	52.7	52.6	52.5	52.4	52.3	52.3	52.2	52.1
60%:	52.0	51.9	51.9	51.8	51.7	51.7	51.6	51.5	51.5	51.4
70%:	51.3	51.3	51.2	51.1	51.0	51.0	50.9	50.8	50.8	50.7
80%:	50.6	50.5	50.4	50.3	50.3	50.2	50.1	50.1	50.0	49.9
90%:	49.8	49.7	49.6	49.4	49.2	49.0	48.9	48.8	48.7	48.5
100%:	47.7									

Logged Data Chart

S095_BLH080004_27022017_080515: Logged Data Chart

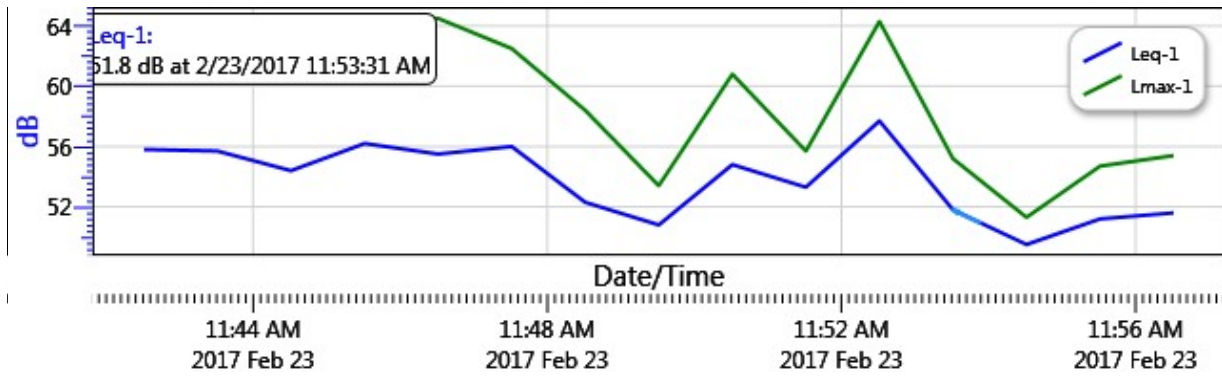



Noise Measurement Report Form - Part A

Date: 2/23/17 Day of Week: THURS Time: 1200 Project Number: 6016

Monitoring Segment / Area: 008 Monitoring Site Address: 6037 Arabella St

Measurement Taken By: J. Selinger of UltraSystems Environmental

Approximate Wind Speed: 2.7 mph [km/hr] Approximate Wind Direction: From the W

Approximate distance of sound level meter from receptor location: 15 ft

Approximate distance of sound level meter from construction site: —————
(Leave Blank for Baseline Ambient)

Receptor Land Use (Check One): Residential Institutional Comm./Ind. Recreational

Sound Level Meter: Make and Model: Quest SoundPro DL-1-1/3 Serial Number: BLH080004

Meter Setting: A-Weighted Sound Level (SLOW) A-Weighted Sound Level (FAST)

Measurement Start Time: 1203 Measurement End Time: 1218

Total Measurement Time: 15 mins Session File Name (e.g., S012): S096

Check the measurement purpose:

Baseline condition Ongoing construction Major change Complaint response

Measurement Results

Measurement Type	Measured Levels (dB)	
Calibration	Pre: <u>113.9</u>	Post: <u>113.9</u>
Leq (h)	Slow: <u>56.1</u>	Fast: —————
Lmax	Slow: <u>73.5</u>	Fast: —————
L90	Slow: <u>48.7</u>	Fast: —————

Field Notes:

- Photo 008
- no traffic - dead end street
- no kids on football/track fields during survey

Noise Monitor's Signature: J. Selinger Date: 2/23/17





Noise Measurement Report Form - Part B

Date: 2/23/17 Day of Week: Thurs Time: 12:00 Project Number: 6016

Monitoring Segment / Area: 408 Monitoring Site Address: 6037 Arabella St

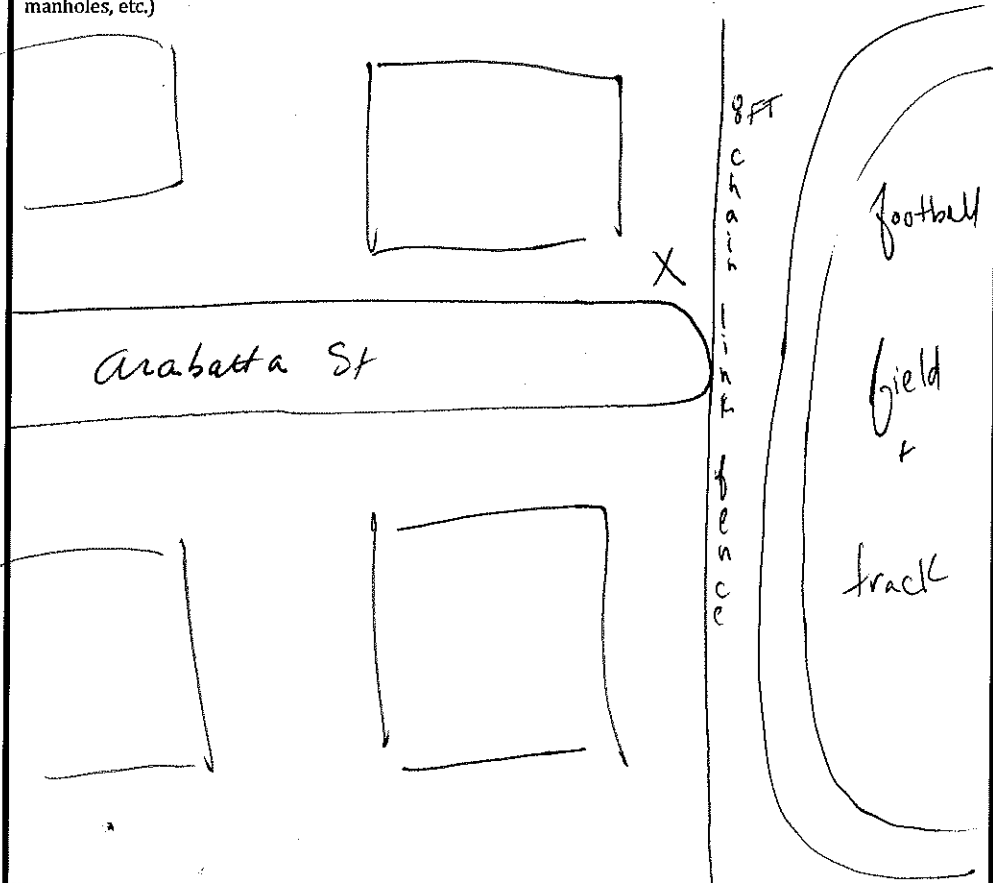
Site Map

<p>Plan View</p>  <p>North Arrow (fill-in)</p>	<p>(Indicate site location, receptor location, meter location, distance in feet to landmarks, roadways, travel lane directions, geographical objects: trees, water, buildings, signs, store names, hydrants, power & telephone lines, manholes, etc.)</p> 	
<p>Elevation View</p>	<p>(Indicate terrain, roadway, height and location of receptor, meter, walls, barriers, buildings, etc.)</p> 	
<p>Latitude: <u>33.86270</u></p>	<p>Longitude: <u>118.11389</u></p>	<p>Elevation: <u>93</u></p>

Noise Monitor's Signature: S. Sef Date: 2/23/17

Session Report

2/27/2017

Information Panel

Name S096_BLH080004_27022017_080516
Start Time 2/23/2017 12:04:15 PM
Stop Time 2/23/2017 12:19:15 PM
Device Name BLH080004
Model Type SoundPro DL
Device Firmware Rev R.13H
Comments

Summary Data Panel

<u>Description</u>	<u>Meter</u>	<u>Value</u>	<u>Description</u>	<u>Meter</u>	<u>Value</u>
Leq	1	56.1 dB			
Exchange Rate	1	3 dB	Weighting	1	A
Response	1	SLOW	Bandwidth	1	OFF
Exchange Rate	2	3 dB	Weighting	2	A
Response	2	FAST			

Statistics Chart

S096_BLH080004_27022017_080516: Statistics Chart

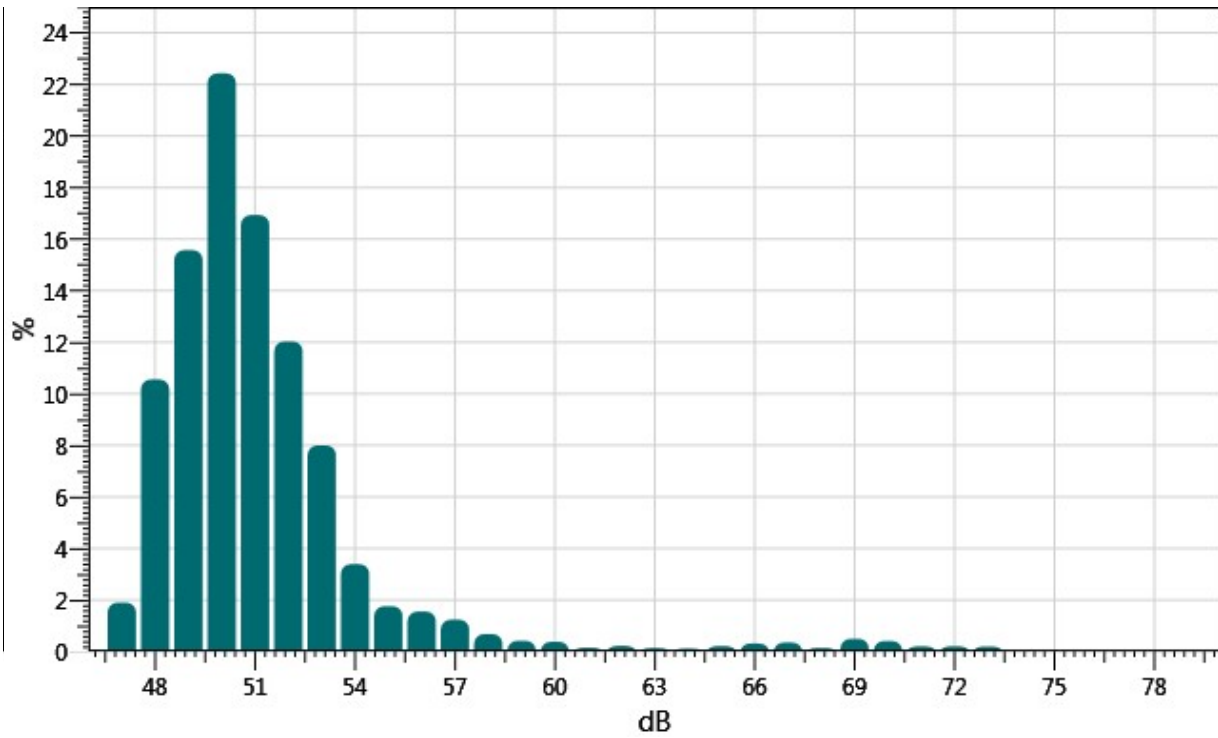

Exceedance Chart

S096_BLH080004_27022017_080516: Exceedance Chart

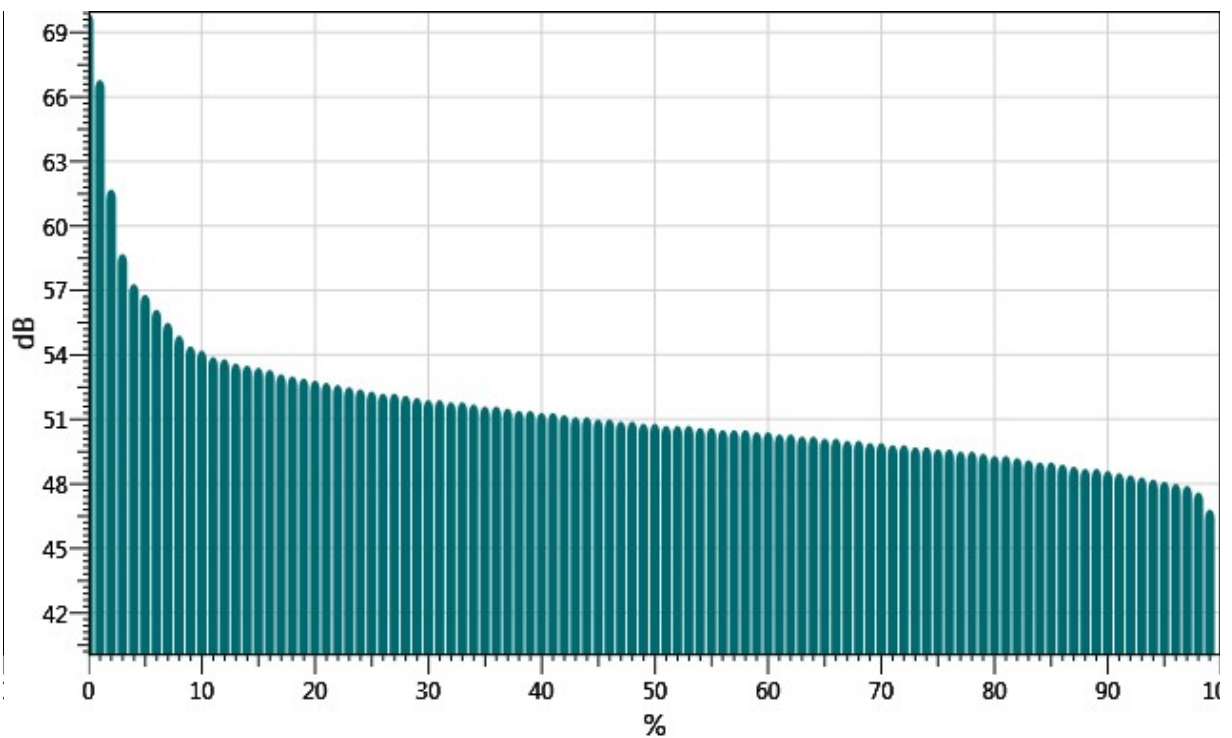

Statistics Table

dB:	0.0	0.1	0.2	0.3	0.4	0.5	0.6	0.7	0.8	0.9	%
46:	0.00	0.00	0.00	0.00	0.00	0.00	0.00	0.00	0.00	0.06	0.06
47:	0.06	0.02	0.01	0.06	0.15	0.18	0.29	0.27	0.30	0.57	1.90
48:	0.75	0.96	0.57	0.93	1.11	1.28	1.22	1.12	1.15	1.46	10.55
49:	1.48	1.24	1.35	1.27	1.52	1.55	1.66	1.81	1.88	1.82	15.57
50:	2.10	2.05	2.10	1.97	2.24	2.29	2.51	2.41	2.48	2.27	22.43
51:	2.25	2.22	1.21	1.74	1.78	1.72	1.54	1.47	1.41	1.59	16.93
52:	1.56	1.57	1.30	1.24	1.19	1.10	0.98	1.04	1.04	1.01	12.03
53:	0.93	0.82	0.89	0.89	0.84	0.80	0.65	0.77	0.70	0.70	8.00
54:	0.60	0.50	0.30	0.41	0.44	0.32	0.23	0.20	0.18	0.19	3.39
55:	0.24	0.20	0.20	0.14	0.15	0.15	0.14	0.19	0.16	0.18	1.76
56:	0.13	0.13	0.14	0.09	0.14	0.18	0.15	0.16	0.18	0.26	1.55
57:	0.22	0.20	0.16	0.19	0.15	0.08	0.05	0.06	0.08	0.06	1.24
58:	0.08	0.08	0.07	0.05	0.06	0.05	0.06	0.08	0.08	0.06	0.68
59:	0.05	0.04	0.02	0.02	0.04	0.03	0.03	0.03	0.06	0.09	0.42
60:	0.06	0.03	0.02	0.06	0.03	0.04	0.04	0.04	0.03	0.02	0.38
61:	0.02	0.02	0.01	0.02	0.02	0.01	0.01	0.01	0.01	0.01	0.15
62:	0.02	0.02	0.01	0.01	0.02	0.02	0.01	0.02	0.01	0.09	0.22
63:	0.02	0.01	0.01	0.02	0.02	0.02	0.01	0.01	0.01	0.01	0.14
64:	0.02	0.01	0.02	0.01	0.01	0.01	0.01	0.01	0.01	0.01	0.12
65:	0.01	0.01	0.01	0.01	0.01	0.01	0.03	0.03	0.06	0.04	0.22
66:	0.04	0.03	0.02	0.02	0.02	0.04	0.05	0.02	0.03	0.05	0.31
67:	0.02	0.03	0.03	0.04	0.03	0.07	0.08	0.03	0.02	0.01	0.35
68:	0.02	0.01	0.01	0.01	0.01	0.01	0.01	0.01	0.02	0.03	0.14
69:	0.04	0.05	0.04	0.06	0.07	0.08	0.05	0.04	0.03	0.03	0.49
70:	0.03	0.05	0.04	0.03	0.03	0.03	0.03	0.03	0.05	0.07	0.40
71:	0.03	0.03	0.04	0.02	0.02	0.02	0.02	0.01	0.01	0.01	0.20
72:	0.01	0.01	0.02	0.01	0.01	0.02	0.01	0.01	0.04	0.06	0.20
73:	0.05	0.02	0.03	0.03	0.03	0.03	0.00	0.00	0.00	0.00	0.20

Exceedance Table

.	0%	1%	2%	3%	4%	5%	6%	%7	%8	%9
0%:		69.9	66.8	61.7	58.7	57.3	56.8	56.1	55.5	54.9
10%:	54.4	54.2	53.9	53.8	53.6	53.5	53.4	53.3	53.1	53.0
20%:	52.9	52.8	52.7	52.6	52.5	52.4	52.3	52.2	52.2	52.1

30%:	52.0	51.9	51.9	51.8	51.8	51.7	51.6	51.6	51.5	51.4
40%:	51.4	51.3	51.3	51.2	51.1	51.1	51.0	51.0	50.9	50.9
50%:	50.8	50.8	50.7	50.7	50.7	50.6	50.6	50.5	50.5	50.5
60%:	50.4	50.4	50.3	50.3	50.2	50.2	50.1	50.1	50.0	50.0
70%:	49.9	49.9	49.8	49.8	49.7	49.7	49.6	49.6	49.5	49.5
80%:	49.4	49.3	49.3	49.2	49.1	49.0	49.0	48.9	48.8	48.7
90%:	48.7	48.6	48.5	48.4	48.3	48.2	48.1	48.0	47.9	47.6
100%:	46.8									

Logged Data Chart

S096_BLH080004_27022017_080516: Logged Data Chart

