

Notice of Exemption

Appendix E

To: Office of Planning and Research
P.O. Box 3044, Room 113
Sacramento, CA 95812-3044

From: (Public Agency): County of Modoc Planning Department
203 W. 4th Street
Alturas, CA 96101

County Clerk
County of: Modoc
108 E. Modoc St.
Alturas, CA 96101

(Address)

Project Title: EX2025-05 Blue Lake Road Project

Project Applicant: Modoc County Road Department

Project Location - Specific:

4.6 miles east of Likely, California, and within portions of the Tule Mountain and Jess V

Project Location - City: Project Location - County: Modoc

Description of Nature, Purpose and Beneficiaries of Project:

The proposed project will mitigate safety concerns and improve motorist safety along CR 64 and CR 258. Proposed improvements include rockfall hazard mitigation in 2 locations. This project also includes 6.5 miles of pavement rehabilitation, 500 feet of a new guardrail, and replacement of several culverts along CR 258. Most work is within the existing road prism.

Name of Public Agency Approving Project: Modoc County Planning Department

Name of Person or Agency Carrying Out Project: Modoc County Road Department

Exempt Status: (check one):

- Ministerial (Sec. 21080(b)(1); 15268);
Declared Emergency (Sec. 21080(b)(3); 15269(a));
Emergency Project (Sec. 21080(b)(4); 15269(b)(c));
[X] Categorical Exemption. State type and section number: 15301(c) Existing Facilities
Statutory Exemptions. State code number:

Reasons why project is exempt:

Existing Highway Facility

Lead Agency
Contact Person: Sean Curtis Area Code/Telephone/Extension: (530) 233-7651

If filed by applicant:

- 1. Attach certified document of exemption finding.
2. Has a Notice of Exemption been filed by the public agency approving the project? Yes No

Signature: Sean Curtis Date: 23 JUNE 25 Title: Interim Planning Director

Signed by Lead Agency Signed by Applicant

Authority cited: Sections 21083 and 21110, Public Resources Code.
Reference: Sections 21108, 21152, and 21152.1, Public Resources Code.

Date Received for filing at OPR:

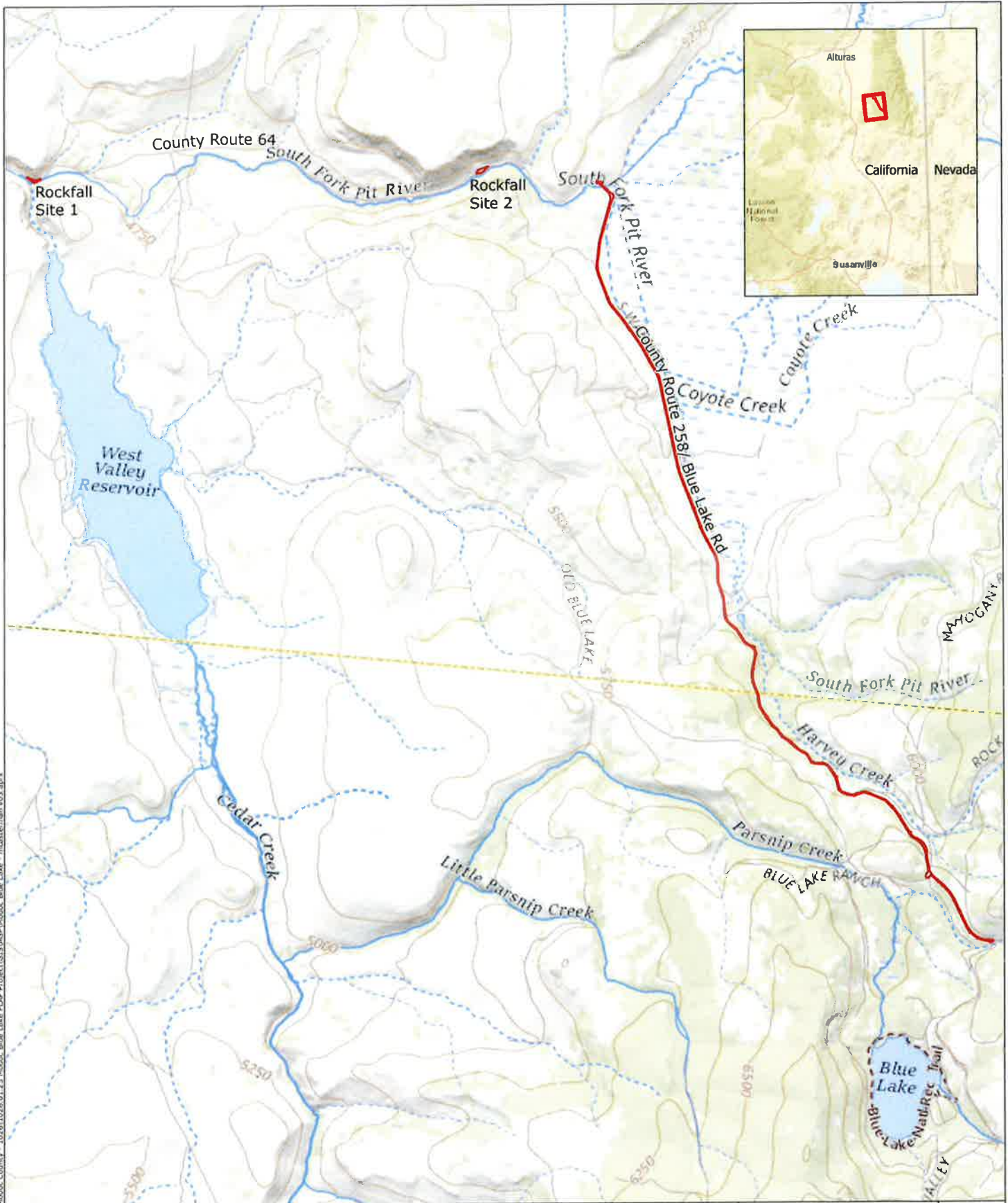

Document Path: P:\Active Projects\Modoc County - 1026\1026.01.25 Modoc Blue Lake FLAP Project\GIS\Map\MapDoc Blue Lake - mcasterman.v03.aprx

**Legend**  
 Project Area



**Blue Lake Road Project**  
 Project Vicinity Map

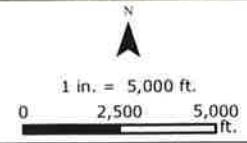

FIGURE  
**1**

SOURCE USGS Topo Basemap	JOB NUMBER 1026.01.25	DRAWN mcasterman	DATE 2/25/2021	REVISED -	APPROVED drios
-----------------------------	--------------------------	---------------------	-------------------	--------------	-------------------