

**MENDOCINO COUNTY RUSSIAN RIVER FLOOD CONTROL
AND WATER CONSERVATION IMPROVEMENT DISTRICT
NEGATIVE DECLARATION REGARDING ENVIRONMENTAL IMPACT**

1. NOTICE IS HEREBY GIVEN that the Project described below has been reviewed pursuant to the provisions of the California Environmental Quality Act of 1970 (Public Resources Code Section 21100, et seq.) and a determination has been made that it will have no significant effect upon the environment.
2. PROJECT NAME: Mendocino County Russian River Flood Control and Water Conservation Improvement District Redwood Valley Annexation Project (“**Project**”).
3. DESCRIPTION OF THE PROJECT: Filing of an application with the Mendocino County Local Agency Formation Commission to annex the Redwood Valley County Water District (“**RVCWD**”) into the RRFC. The Project Description is more fully set forth in the Initial Study for the Project. The purpose of the annexation is to allow RVCWD to contract with the RRFC to receive surface water supplies available under the RRFC’s licensed water right.
4. LOCATION OF PROJECT: The Project is located within Mendocino County as shown on the areas identified on the map attached as **EXHIBIT “A”**.
5. NAME AND ADDRESS OF PROJECT PROPONENT: Mendocino County Russian River Flood Control and Water Conservation Improvement District, PO Box 2104, Ukiah, CA 95482, (707) 462-5278.
6. MITIGATION MEASURES: None.
7. A copy of the Initial Study regarding the environmental effect of this Project is on file at the RRFC office at 304 North State Street, Ukiah, California, 95482. This study was:
 - X Adopted as presented.
 - Adopted with changes. Specific modifications supporting reasons are attached.
8. The RRFC considered and adopted this Negative Declaration at a public meeting of its Board of Directors on October 6, 2025.
9. DETERMINATION: *(To be completed by the Lead Agency).*

On the basis of this initial evaluation:

- X I find that the proposed Project COULD NOT have a significant effect on the environment, and a NEGATIVE DECLARATION will be prepared.

- I find that although the proposed Project could have a significant effect on the environment, there will not be a significant effect in this case because revisions to the Project have been made by or agreed to by the Project proponent. A MITIGATED NEGATIVE DECLARATION will be prepared.
- I find that the proposed Project MAY have a significant effect on the environment, and an ENVIRONMENTAL IMPACT REPORT is required.
- I find that the proposed Project MAY have a “potentially significant impact” or “potentially significant unless mitigated” impact on the environment, but at least one effect (1) has been adequately analyzed in an earlier document pursuant to applicable legal standards; and (2) has been addressed by mitigation measures based on the earlier analysis as described on the attached sheets. An ENVIRONMENTAL IMPACT REPORT is required, but it must analyze only the effects that remain to be addressed.
- I find that although the proposed Project could have a significant effect on the environment, because all potentially significant effects (1) have been adequately analyzed in an earlier EIR or NEGATIVE DECLARATION pursuant to the applicable standards, and (c) have been avoided or mitigated pursuant to that earlier EIR or NEGATIVE DECLARATION, including revisions or mitigation measures that are imposed upon the Project, nothing further is required.

Elizabeth Salomone

Elizabeth Salomone

October 6, 2025

Date

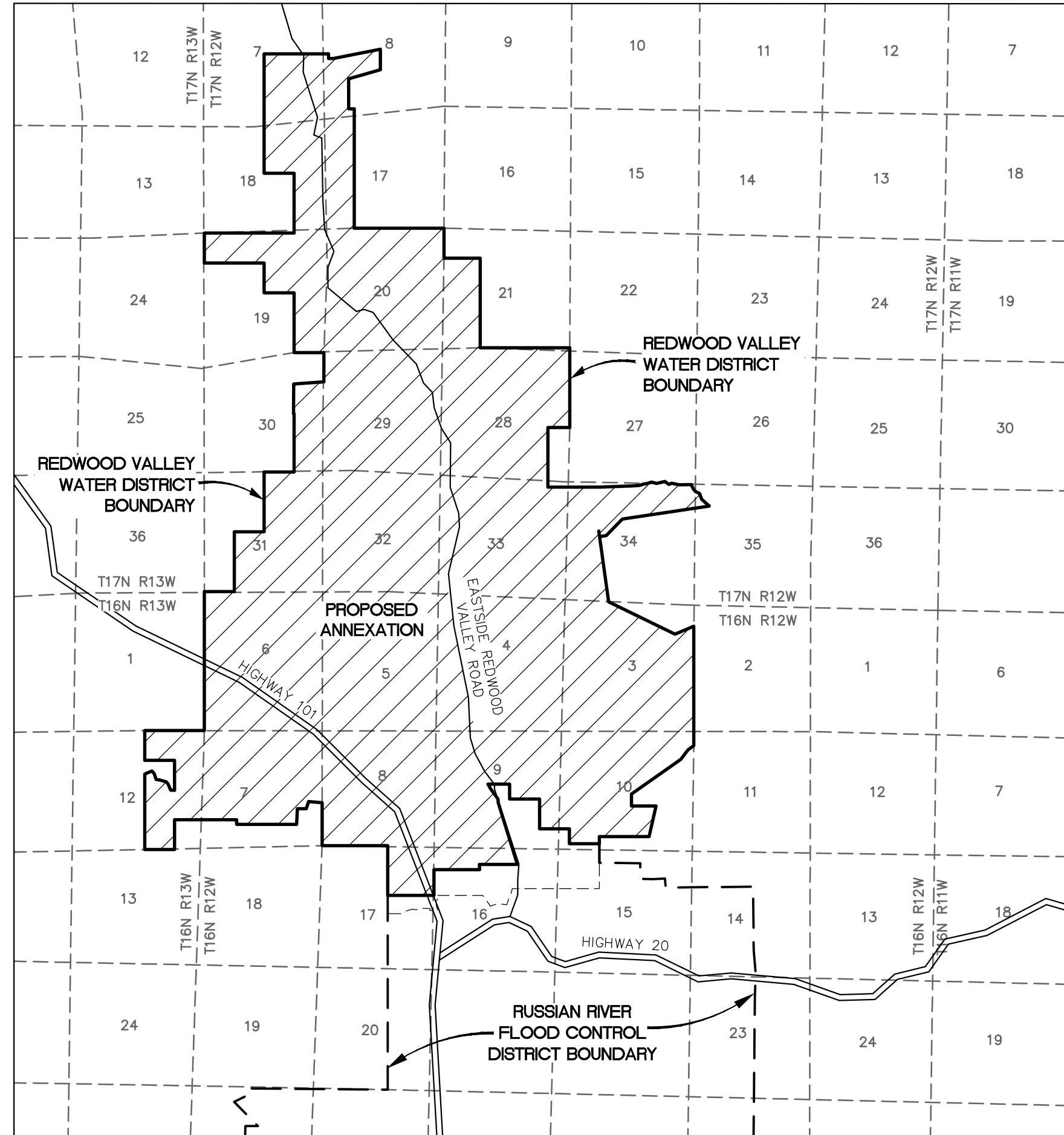
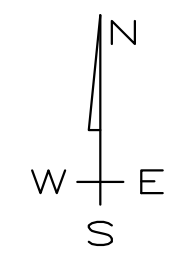
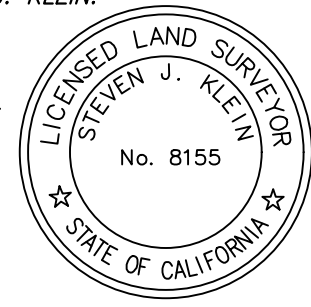

EXHIBIT "A"
TO NEGATIVE DECLARATION
MAP OF RVCWD AREA TO BE ANNEXED INTO RRFC
October 6, 2025

THIS MAP HAS BEEN PREPARED BY STEVEN J. KLEIN.

Steven J. Klein 06/18/25
 STEVEN J. KLEIN, P.L.S. 8155



LEGEND

- BOUNDARY OF LANDS TO BE ANNEXED
- EXISTING BOUNDARY OF RUSSIAN RIVER FLOOD CONTROL DISTRICT
- SECTION LINES
- OVERLAP OF RVCWD & RRFC

MUNSELLE CIVIL ENGINEERING
CIVIL ENGINEERING & LAND SURVEYING
 513 CENTER STREET
 HEALDSBURG, CA 95448
 (707) 395-0968



LAFCO SITE PLAN
REDWOOD VALLEY COUNTY WATER DISTRICT
REDWOOD VALLEY, CA

JOB NO.
129-25

SHEET NO.
1
OF 1 SHEETS