

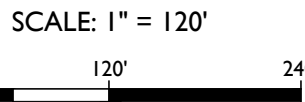

SCALE: 1" = 120'



SCALE: 1" = 3,000'

### PROJECT INFORMATION:

**CLIENT:**

TRUST VINEYARD PARTNERS  
CARE OF:  
BRUCE PHILLIPS & BILL KELHA  
POST OFFICE BOX 2066  
YOUNTVILLE, CA 94599

**SURVEY NOTES:**

1. FADED BACKGROUND REPRESENTS EXISTING TOPOGRAPHIC FEATURES. TOPOGRAPHIC INFORMATION WAS TAKEN FROM THE NAPA COUNTY GEOGRAPHIC INFORMATION SYSTEM DATABASE. APPLIED CIVIL ENGINEERING INCORPORATED ASSUMES NO LIABILITY REGARDING THE ACCURACY OR COMPLETENESS OF THE TOPOGRAPHIC INFORMATION.
2. AERIAL PHOTOGRAPHS WERE OBTAINED FROM THE SAN FRANCISCO ESTUARY INSTITUTE (SFEI) SAN FRANCISCO BAY AREA ORTHOPHOTOS DATABASE, DATED JUNE 2014 AND MAY NOT REPRESENT CURRENT CONDITIONS.
3. CONTOUR INTERVAL: FIVE (5) FEET, HIGHLIGHTED EVERY TWENTY FIVE (25) FEET.
4. BENCHMARK: NAVD 88
5. THE PROPERTY LINES SHOWN ON THESE PLANS DO NOT REPRESENT A BOUNDARY SURVEY. THEY ARE VERY APPROXIMATE AND ARE PROVIDED FOR INFORMATIONAL PURPOSES ONLY.

**LEGEND:**

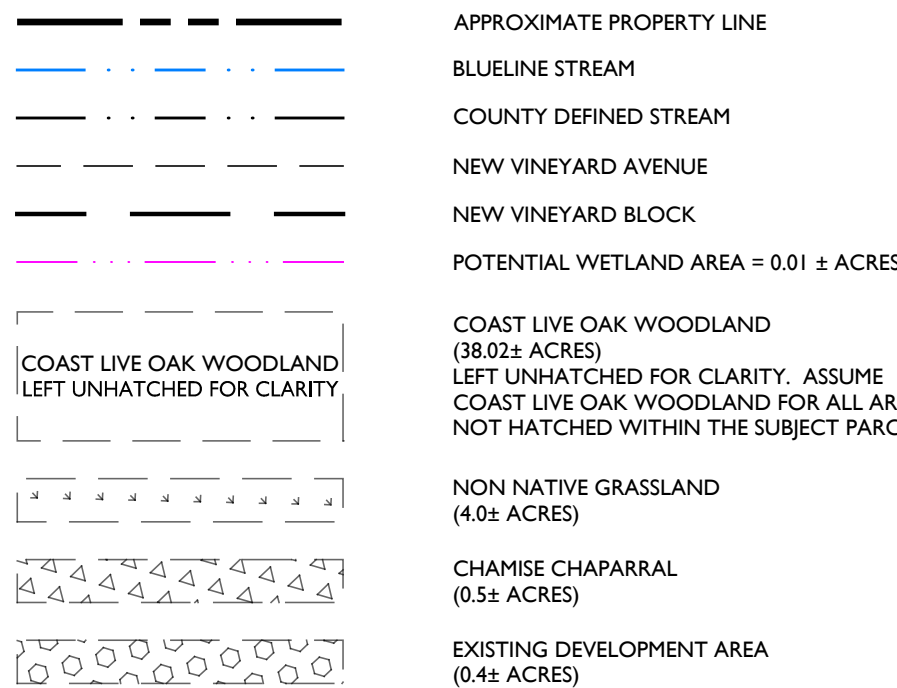

VEGETATION REMOVAL AND RETENTION SUMMARY					
	AREA REMOVED BY VEGETATION TYPE				
	NON NATIVE GRASSLAND	CHAMISE CHAPARRAL	COAST LIVE OAK WOODLAND	EXISTING DEVELOPMENT	TOTAL
VINEYARD BLOCK 1	1.1	0.0	3.0	0.0	4.1
VINEYARD BLOCK 2	2.4	0.5	6.4	0.4	9.7
TOTAL REMOVED	3.5	0.5	9.4	0.4	13.8
*TOTAL ON APN 027-490-006	4.0	0.5	38.0	0.4	42.9
% RETAINED	13%	0%	75%	0%	

\* THE VEGETATION COVER FOR THE DRAINAGE AND WETLAND AREAS ARE INCLUDED IN THE OVERALL ACREAGE FOR THE VEGETATION TYPE.

2074 West Lincoln Avenue  
Napa, CA 94558  
(707) 320-4968 (707) 320-2395 Fax  
[www.appliedcivil.com](http://www.appliedcivil.com)

## TRUST VINEYARD PARTNERS

VINEYARD PLANNING EXHIBIT

PREPARED UNDER THE  
DIRECTION OF:



DRAWN BY:  
SMI / BT DRAFTING

CHECKED BY:  
MRM

DATE: MARCH 2019

REVISIONS: B

JOB NUMBER:  
18-110

FILE:  
18-110ECP-VDP 120.DV

ORIGINAL SIZE:  
24" X 36"

SHEET NUMBER:

CI  
OF