

NOTICE OF EXEMPTION

From: Kern County Planning and Natural Resources Department
2700 "M" Street, Suite 100
Bakersfield, CA 93301

Project Title: - Site Plan Review 2, Map 197; Sagebrush 2 Energy Storage Project

Project Location -- Specific: Section 16 of Township 11 North, Range 13 West (APN 237-031-38)

Project Location -- City: Unincorporated area of Kern County

Project Location -- County: Kern

Description of Project: Install a battery storage accessory to an existing wind farm in an A WE District.

Name of Public Agency Approving Project: KERN COUNTY PLANNING AND NATURAL RESOURCES DEPARTMENT

Name of Person or Agency Carrying Out Project: Sagebrush 2 ESS, LLC, an affiliate of Terra-Gen LLC

Exempt Status: Sections 21080(b)(1) and 15268

Reasons Why Project Is Exempt: Site Plan Reviews are ministerial under Kern County Zoning Ordinance and are exempt under Sections 21080(b)(1) and 15268 of the State CEQA Guidelines

Contact Person: Andrea Calderon, Planner, (661) 862-5029, Calderona@kerncounty.com

Date Received for Filing:

March 24, 2025

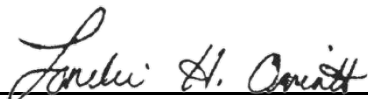

Lorelei H. Oviatt, AICP
Director

cc: County Clerk
Applicant
Case File

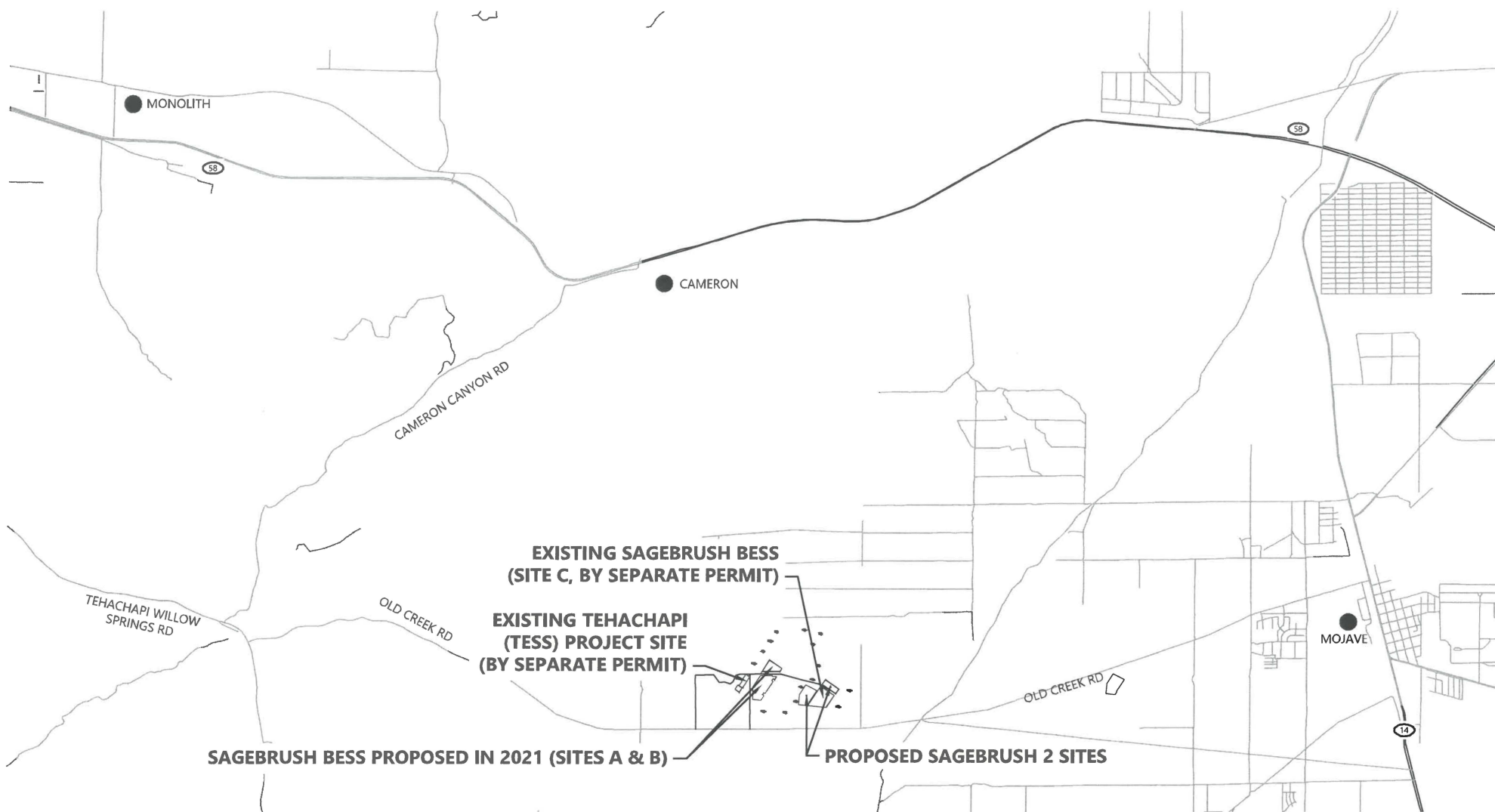

VICINITY MAP
N.T.S

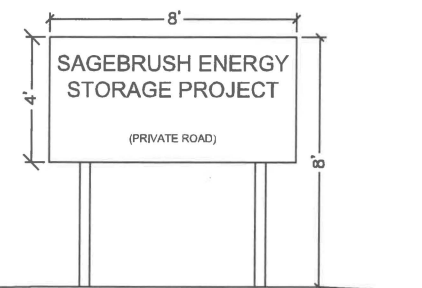
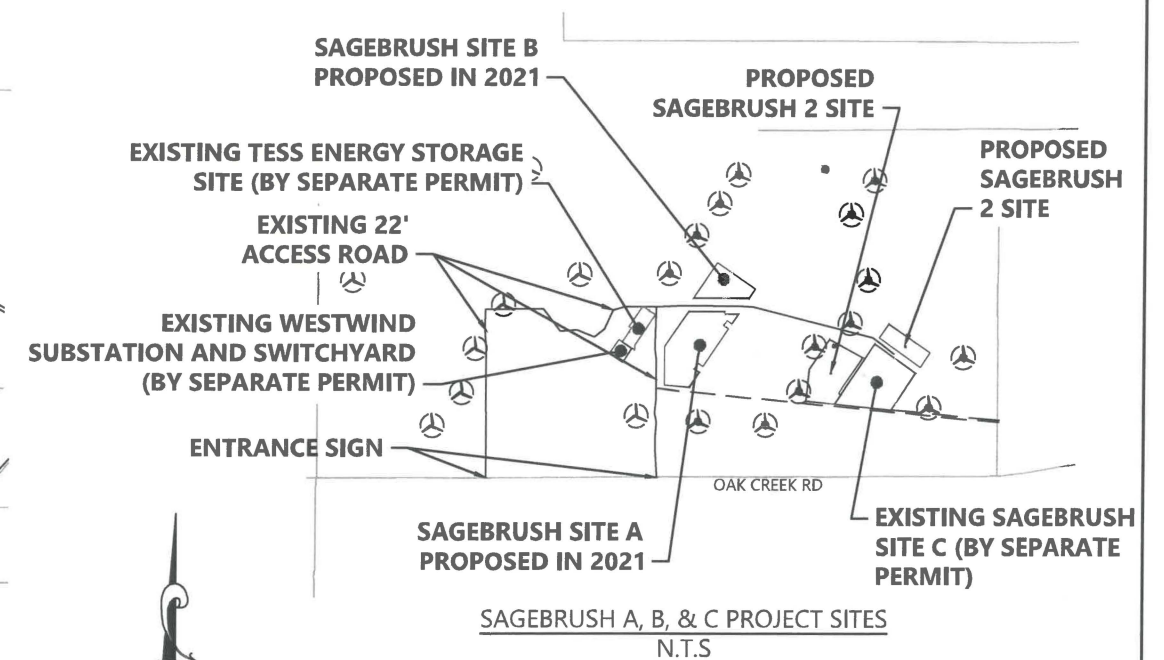

NOTES:

1. THERE ARE NO RESIDENCES, ROADS, THIRD PARTY PARCEL BOUNDARIES, OR THIRD PARTY INFRASTRUCTURE LOCATED WITHIN 1000 FEET OF PROPOSED PROJECT SITE.
2. THERE ARE NO KNOWN ARCHAEOLOGICAL REMAINS LOCATED WITHIN THE PROPOSED PROJECT SITE.
3. THERE ARE NO JOSHUA TREES OR SENSITIVE PLANT SPECIES WITHIN THE PROPOSED PROJECT SITE.

APPROVED
FOR ZONE REQUIREMENTS ONLY
Kern County Planning & Natural Resources

BY: Audrea Calderon

DATE: 2/27/25 ZONE AWE

FOR: Plot Plan Review

per 19.64 of the KCZO
Sagebrush 2. site

I, NATHANIEL H. VISTE, STATE THAT THE PROPOSED DEVELOPMENT ON THIS PLOT PLAN IS IN FULL COMPLIANCE WITH THE REQUIREMENTS OF CHAPTER 19.64 OF THE KERN COUNTY ZONING ORDINANCE AND THAT THE AREA ENCOMPASSED BY THE PROJECT HAS BEEN PREVIOUSLY SURVEYED AND MONUMENTS FOUND TO ACCURATELY ESTABLISH THE EXTERIOR PROJECT BOUNDARIES.

BY:

NATHANIEL H. VISTE
CALIFORNIA NO.: C71809
EXP. 12/31/25

DATE

SHEET 1 OF 4

PLOT PLAN

COVER SHEET SAGEBRUSH 2
ENERGY STORAGE PROJECT

SEC. 16 , T.11 , R.13W S.B.M., COUNTY OF KERN

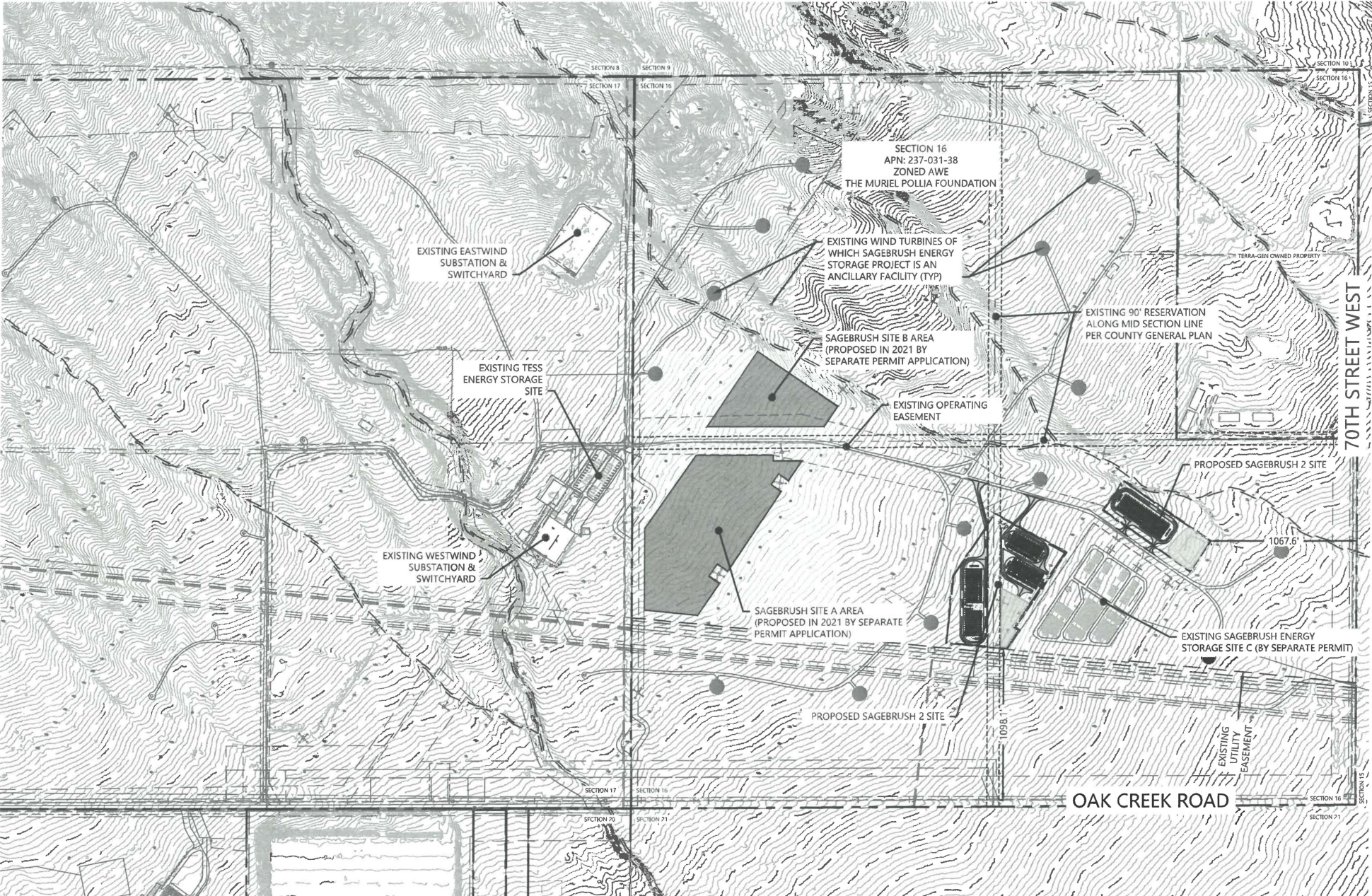

- LEGEND:**
- EXISTING MET TOWER (90' TALL)
 - EXISTING TURBINE (492' TALL)
 - EXISTING TURBINE (146' TALL)
 - EXISTING DIRT ROADS
 - EXISTING MAJOR CONTOUR
 - EXISTING MINOR CONTOUR
 - EXISTING FENCE LINE
 - EXISTING SAGEBRUSH (SITE C) PROJECT BOUNDARY
 - SAGEBRUSH BESS 2021 PROPOSED AREAS (SITES A & B)
 - EXISTING PROPERTY OR SECTION LINE
 - EXISTING STREAM LINE
 - EXISTING SAGEBRUSH OPERATING EASEMENT AREA
 - EXISTING EASEMENT
 - EXISTING BESS EQUIPMENT
 - PROPOSED BESS EQUIPMENT
 - PROPOSED 20' ACCESS ROAD
 - PROPOSED DRAINAGE BASIN
 - PROPOSED FENCE LINE

LEGAL DESCRIPTION:
SOUTH 1/2 OF SECTION 16 T.11N., R.13W., S.B.M.
(APN 237-031-38)

STATISTICAL INFORMATION:	SAGEBRUSH 2 BESS, LLC
PREPARED FOR:	AWE
EXISTING & PROPOSED ZONING:	EXISTING WIND FARM, WIND ENERGY STORAGE SYSTEM, SUBSTATION & GRID FACILITIES, AND RELATED FACILITIES
EXISTING USE:	WIND ENERGY STORAGE SYSTEM AND RELATED FACILITIES
PROPOSED USE:	
PROPERTY ACREAGE: (EXISTING)	566.44 AC
PROJECT ACREAGE:	TOTAL 16.74 AC
PERCENT OF PROPERTY USED BY PROJECT:	2.9%
PROPOSED STRUCTURES:	BATTERY STORAGE CONTAINERS POWER CONVERSION SYSTEMS, AND AUXILIARY ELECTRICAL EQUIPMENT
PROPOSED LANDSCAPING:	NONE
PROPOSED SEWAGE DISPOSAL:	NONE
PROPOSED WATER SUPPLY:	NONE
PROPOSED DRAINAGE:	TO AN APPROVED RETENTION BASIN PER APPROVED PROJECT GRADING PLAN

THIS WILL NOT BE A PHASED DEVELOPMENT
PLOT PLAN CONFORMS WITH KERN COUNTY'S ZONING ORDINANCE
ACCESS OVER EXISTING APPROVED WIND PARK ACCESS ROADS

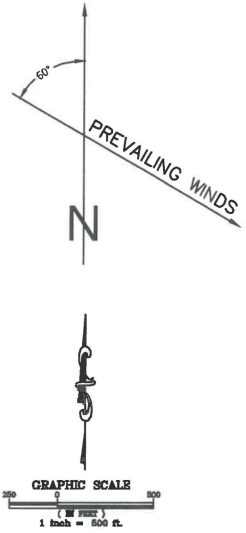

APPROVED
FOR ZONE REQUIREMENTS ONLY
Kern County Planning & Natural Resources
BY: Audrey Calderon
DATE: 2/27/2025 ZONE AWE
FOR: Plot Plan Review
per 19.64 of the KCZO
Sagebrush 2 site

SHEET 2 OF 4

PLOT PLAN

OVERALL VIEW SAGEBRUSH 2
ENERGY STORAGE PROJECT

SEC. 16 , T.11 , R.13W S.B.M., COUNTY OF KERN

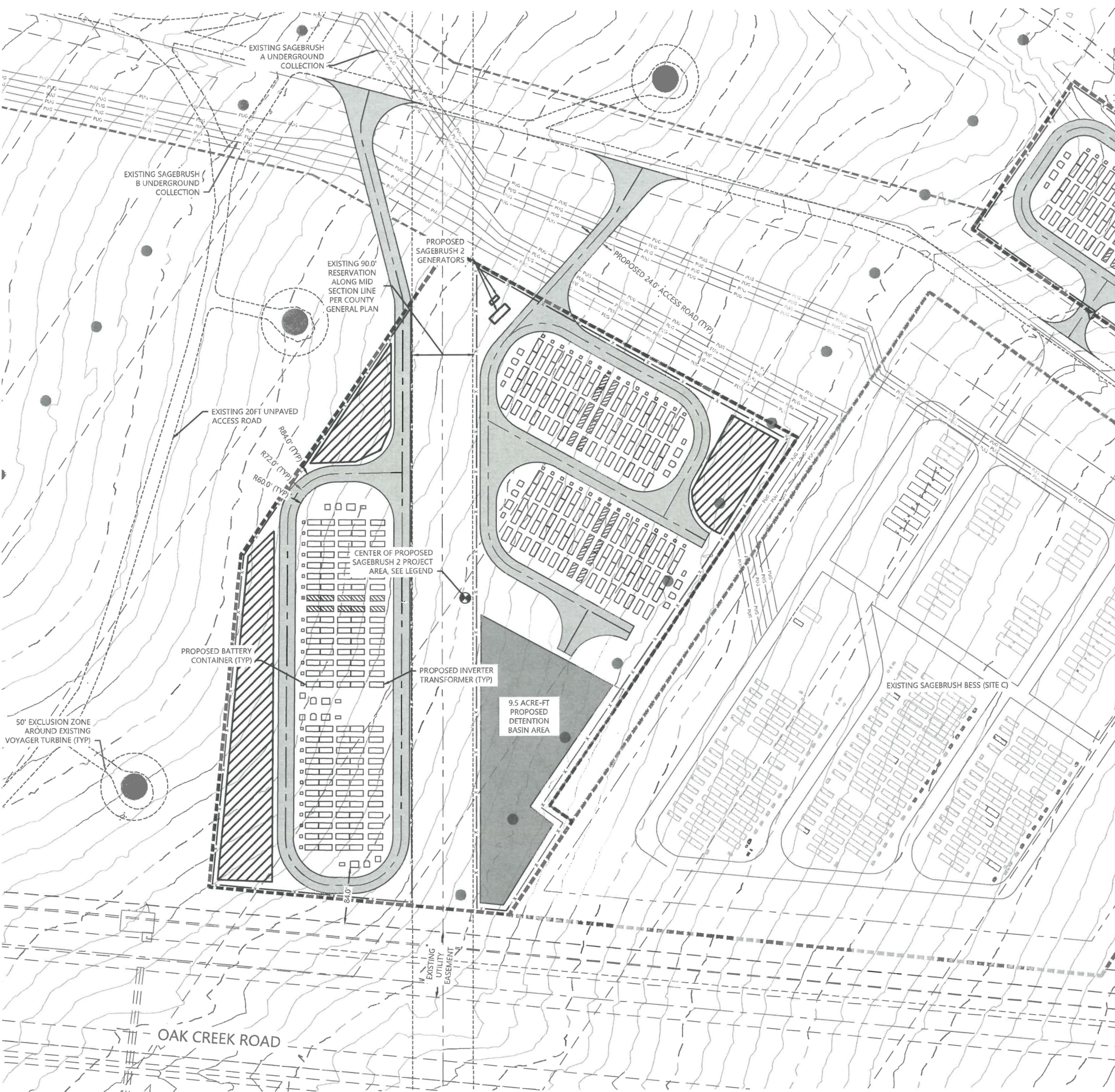

LEGEND:

- PROJECT BOUNDARY LINE
- PROPOSED FENCE (7' HIGH WITH 3 STRANDS BARBED WIRE AT THE TOP)
- PROPOSED 24' GATE
- PROPOSED DISTURBANCE AREA OUTSIDE OF PROJECT AREA
- PROPOSED SETBACK LINE
- CENTER OF PROJECT - (WEST AREA):
LAT: 35.0428722222 LONG: -118.2653916667 (NAD 83)
- PROPOSED MAJOR CONTOUR
- PROPOSED MINOR CONTOUR
- PROPOSED 20' ACCESS ROAD
- PROPOSED LAYDOWN AREA
- PROPOSED DRAINAGE BASIN
- EXISTING BESS EQUIPMENT
- PROPOSED BESS EQUIPMENT
- EXISTING MET TOWER (90' TALL)
- EXISTING TURBINE (492' TALL)
- EXISTING TURBINE (146' TALL)
- EXISTING DIRT ROADS
- EXISTING MAJOR CONTOUR
- EXISTING MINOR CONTOUR
- EXISTING FENCE LINE
- EXISTING SAGEBRUSH (SITE C) PROJECT BOUNDARY
- EXISTING PROPERTY OR SECTION LINE
- EXISTING STREAM LINE
- EXISTING SAGEBRUSH OPERATION EASEMENT AREA
- EXISTING EASEMENT
- EXISTING UNDERGROUND COLLECTION
- MID SECTION LINE

LEGAL DESCRIPTION:
SOUTH 1/2 OF SECTION 16 T.11N., R.13W., S.B.M.
(APN 237-031-38)

STATISTICAL INFORMATION:
PREPARED FOR: SAGEBRUSH 2 BESS, LLC
EXISTING & PROPOSED ZONING: AWE
EXISTING USE: EXISTING WIND FARM, WIND ENERGY STORAGE SYSTEM, SUBSTATION & GRID FACILITIES, AND RELATED FACILITIES
PROPOSED USE: WIND ENERGY STORAGE SYSTEM AND RELATED FACILITIES
PROPERTY ACREAGE: (EXISTING) 566.44 AC
PROJECT ACREAGE: TOTAL 16.74 AC
PERCENT OF PROPERTY USED BY PROJECT: 2.9%
PROPOSED STRUCTURES: BATTERY STORAGE CONTAINERS, POWER CONVERSION SYSTEMS, AND AUXILIARY ELECTRICAL EQUIPMENT
PROPOSED LANDSCAPING: NONE
PROPOSED SEWAGE DISPOSAL: NONE
PROPOSED WATER SUPPLY: NONE
PROPOSED DRAINAGE: TO AN APPROVED RETENTION BASIN PER APPROVED PROJECT GRADING PLAN

THIS WILL NOT BE A PHASED DEVELOPMENT
PLOT PLAN CONFORMS WITH KERN COUNTY'S ZONING ORDINANCE
ACCESS OVER EXISTING APPROVED WIND PARK ACCESS ROADS

APPROVED
FOR ZONE REQUIREMENTS ONLY
Kern County Planning & Natural Resources
BY: Andrea Calderon
DATE: 2/27/25 **ZONE AWE**
FOR: Plot Plan Review
per 19.64 of KCZO
Sagebrush 2 site

60°
PREVAILING WINDS
N
GRAPHIC SCALE
1 inch = 50 ft.

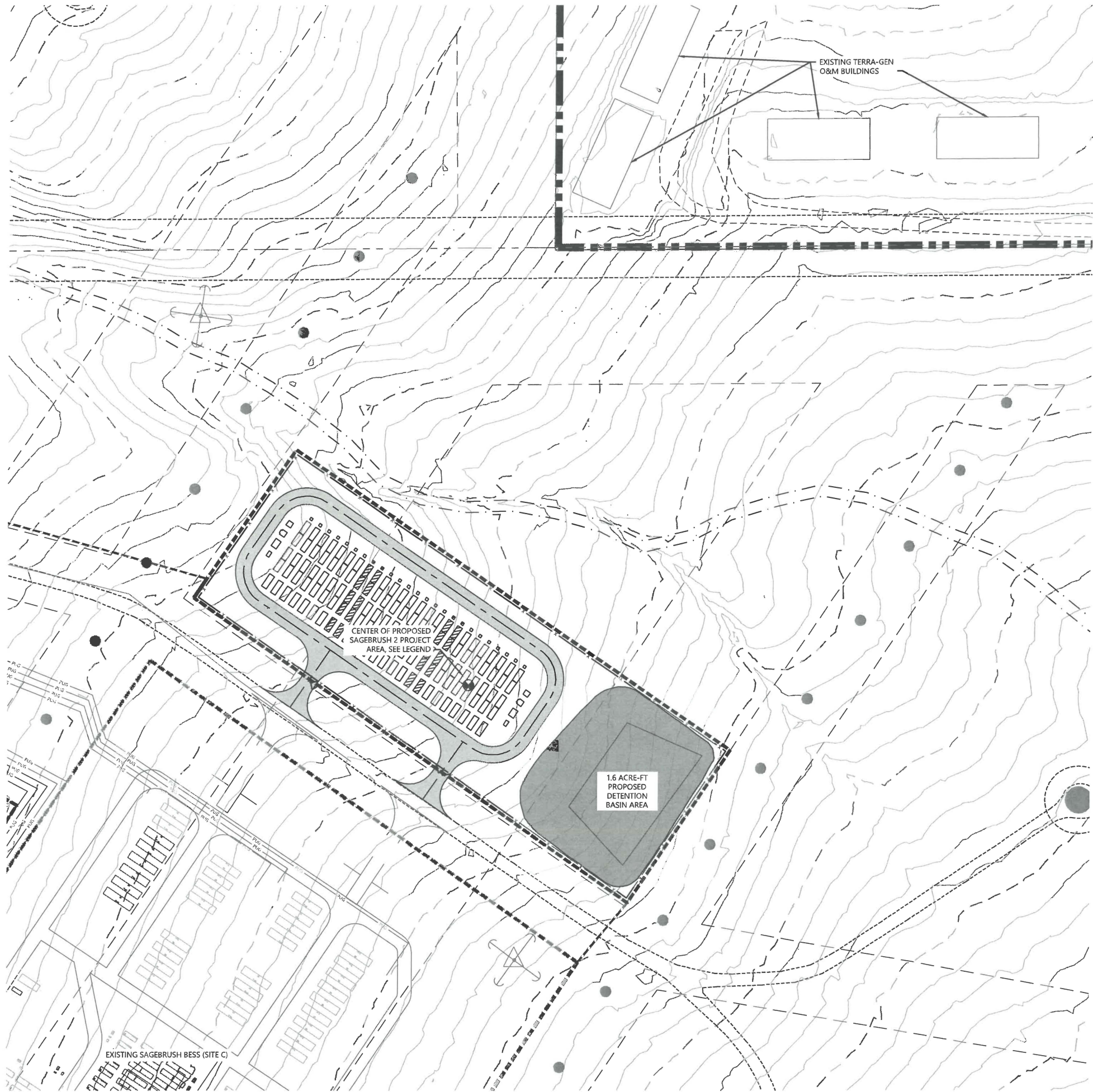

LEGEND:

- PROJECT BOUNDARY LINE
- PROPOSED FENCE (7' HIGH WITH 3 STRANDS BARBED WIRE AT THE TOP)
- PROPOSED 24' GATE
- PROPOSED DISTURBANCE AREA OUTSIDE OF PROJECT AREA
- PROPOSED SETBACK LINE
- CENTER OF PROJECT - (WEST AREA):
LAT: 35.0428722222 LONG: -118.2653916667 (NAD 83)
- PROPOSED MAJOR CONTOUR
- PROPOSED MINOR CONTOUR
- PROPOSED 20' ACCESS ROAD
- PROPOSED LAYDOWN AREA
- PROPOSED DRAINAGE BASIN
- EXISTING BESS EQUIPMENT
- PROPOSED BESS EQUIPMENT
- EXISTING MET TOWER (90' TALL)
- EXISTING TURBINE (492' TALL)
- EXISTING TURBINE (146' TALL)
- EXISTING DIRT ROADS
- EXISTING MAJOR CONTOUR
- EXISTING MINOR CONTOUR
- EXISTING FENCE LINE
- EXISTING SAGEBRUSH (SITE C) PROJECT BOUNDARY
- EXISTING PROPERTY OR SECTION LINE
- EXISTING STREAM LINE
- EXISTING SAGEBRUSH OPERATION EASEMENT AREA
- EXISTING EASEMENT
- EXISTING UNDERGROUND COLLECTION
- MID SECTION LINE

LEGAL DESCRIPTION:
SOUTH 1/2 OF SECTION 16 T.11N., R.13W., S.B.M.
(APN 237-031-38)

STATISTICAL INFORMATION:
PREPARED FOR:

EXISTING & PROPOSED ZONING:

EXISTING USE:

PROPOSED USE:

PROPERTY ACREAGE: (EXISTING)

PROJECT ACREAGE:

PERCENT OF PROPERTY USED BY PROJECT:

PROPOSED STRUCTURES:

PROPOSED LANDSCAPING:

PROPOSED SEWAGE DISPOSAL:

PROPOSED WATER SUPPLY:

PROPOSED DRAINAGE:

THIS WILL NOT BE A PHASED DEVELOPMENT

PLOT PLAN CONFORMS WITH KERN COUNTY'S ZONING ORDINANCE

ACCESS OVER EXISTING APPROVED WIND PARK ACCESS ROADS

SAGEBRUSH 2 BESS, LLC
AWC
EXISTING WIND FARM, WIND ENERGY STORAGE SYSTEM,
SUBSTATION & GRID FACILITIES, AND RELATED FACILITIES
WIND ENERGY STORAGE SYSTEM AND RELATED FACILITIES
556.44 AC
TOTAL 18.74 AC
2.9%
BATTERY STORAGE CONTAINERS
POWER CONVERSION SYSTEMS, AND
AUXILIARY ELECTRICAL EQUIPMENT
NONE
NONE
NONE
TO AN APPROVED RETENTION
BASIN PER APPROVED PROJECT
GRADING PLAN

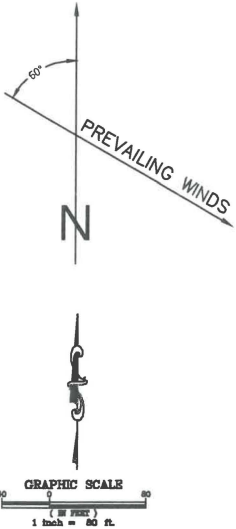

APPROVED
FOR ZONE REQUIREMENTS ONLY
Kern County Planning & Natural Resources

BY: Andrew Calderon

DATE: 2/27/25 ZONE AWC

FOR: Plot Plan Review

per 19.64 of the KCZO

Sagebrush 2 site

PLOT PLAN

DETAIL VIEW, SAGEBRUSH 2
ENERGY STORAGE PROJECT
(EAST AREA)