

# Notice of Exemption

## Appendix E

**To:** Office of Planning and Research  
P.O. Box 3044, Room 113  
Sacramento, CA 95812-3044

County Clerk

County of: Los Angeles

12400 Imperial Hwy.

Norwalk, CA 90650

**From:** (Public Agency): City of Los Angeles

Department of Cannabis Regulation

221 N. Figueroa St., Suite 1245, Los Angeles, CA 90012

(Address)

Project Title: DCR CORE RECORD NO. 310070

Project Applicant: Weed Lane, Inc.

Project Location - Specific:

7872 S Crenshaw Blvd., Los Angeles, CA 90043 / Crenshaw Blvd and 79th St

Project Location - City: Los Angeles

Project Location - County: Los Angeles

Description of Nature, Purpose and Beneficiaries of Project:

Retail sales of commercial cannabis products under State and local law.

Name of Public Agency Approving Project: City of Los Angeles, Department of Cannabis Regulation

Name of Person or Agency Carrying Out Project: Weed Lane, Inc.

Exempt Status: **(check one):**

- ☐ Ministerial (Sec. 21080(b)(1); 15268);
- ☐ Declared Emergency (Sec. 21080(b)(3); 15269(a));
- ☐ Emergency Project (Sec. 21080(b)(4); 15269(b)(c));
- ☒ Categorical Exemption. State type and section number: CEQA Sections 15301 & 15332/Class 1 & 32
- ☐ Statutory Exemptions. State code number: \_\_\_\_\_

Reasons why project is exempt:

Environmentally benign infill project consistent with the General Plan, Zoning requirements and consistent with the criteria for a Class 1 & Class 32 Categorical Exemption pursuant to CEQA Guidelines Section 15301 & 15332 and does not require further analysis based on the exceptions in CEQA Guidelines Section 15300.2, and thus, DCR finds that no further CEQA analysis is required.

Lead Agency

Contact Person: Jason Killeen

Area Code/Telephone/Extension: (213) 978-0738

**If filed by applicant:**

1. Attach certified document of exemption finding.
2. Has a Notice of Exemption been filed by the public agency approving the project? ■ Yes      No

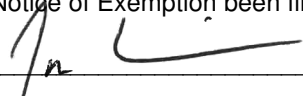
Signature:  Date: 12/12/2024 Title: Asst. Executive Director

■ Signed by Lead Agency      Signed by Applicant

Authority cited: Sections 21083 and 21110, Public Resources Code.  
Reference: Sections 21108, 21152, and 21152.1, Public Resources Code.

Date Received for filing at OPR: \_\_\_\_\_

THIS NOTICE WAS POSTED

ON October 01 2024UNTIL October 31 2024

REGISTRAR – RECORDER/COUNTY CLERK

CITY OF LOS ANGELES  
OFFICE OF THE CITY CLERK  
200 NORTH SPRING STREET, ROOM 395  
LOS ANGELES, CALIFORNIA 90012

CALIFORNIA ENVIRONMENTAL QUALITY ACT

**NOTICE OF EXEMPTION**

(PRC Section 21152; CEQA Guidelines Section 15062)

**2024 204364****FILED**

Oct 01 2024

Dean C. Logan, Registrar – Recorder/County Clerk

Electronically signed by TINA TRAN

Pursuant to Public Resources Code § 21152(b) and CEQA Guidelines § 15062, the notice should be posted with the County Clerk by mailing the form and posting fee payment to the following address: Los Angeles County Clerk/Recorder, Environmental Notices, P.O. Box 1208, Norwalk, CA 90650. Pursuant to Public Resources Code § 21167 (d), the posting of this notice starts a 35-day statute of limitations on court challenges to reliance on an exemption for the project. Failure to file this notice as provided above, results in the statute of limitations being extended to 180 days.

PARENT CASE NUMBER(S) / REQUESTED ANNUAL LICENSES

LA-R-24-310070-ANN / Retail with on-site sales (Type 10)

LEAD CITY AGENCY

City of Los Angeles (Department of Cannabis Regulation)

CASE NUMBER

ENV- 310070-ANN

PROJECT TITLE

DCR CORE RECORD NO. 310070

COUNCIL DISTRICT

8

PROJECT LOCATION (Street Address and Cross Streets and/or Attached Map)

7872 S Crenshaw Blvd., Los Angeles, CA 90043 / Crenshaw Blvd and 79th St

☒ Map attached.

PROJECT DESCRIPTION:

Retail sales of commercial cannabis products under State and local law.

☐ Additional page(s) attached.

NAME OF APPLICANT / OWNER:

Weed Lane, Inc.

CONTACT PERSON (If different from Applicant/Owner above)

Jason Killeen

(AREA CODE) TELEPHONE NUMBER

(213) 978-0738

EXT.

EXEMPT STATUS: (Check all boxes, and include all exemptions, that apply and provide relevant citations.)

STATE CEQA STATUTE &amp; GUIDELINES

☐ STATUTORY EXEMPTION(S)

Public Resources Code Section(s) \_\_\_\_\_

☒ CATEGORICAL EXEMPTION(S) (State CEQA Guidelines Sec. 15301-15333 / Class 1-Class 33)CEQA Guideline Section(s) / Class(es) CEQA Sections 15301 & 15332/Class 1 & 32☐ OTHER BASIS FOR EXEMPTION (E.g., CEQA Guidelines Section 15061(b)(3) or (b)(4) or Section 15378(b) )

JUSTIFICATION FOR PROJECT EXEMPTION:

☒ Additional page(s) attached

Environmentally benign infill project consistent with the General Plan, Zoning requirements and consistent with the criteria for a Class 1 & Class 32 Categorical Exemption pursuant to CEQA Guidelines Section 15301 & 15332 and does not require further analysis based on the exceptions in CEQA Guidelines Section 15300.2, and thus, DCR finds that no further CEQA analysis is required.

☒ None of the exceptions in CEQA Guidelines Section 15300.2 to the categorical exemption(s) apply to the Project.☐ The project is identified in one or more of the list of activities in the City of Los Angeles CEQA Guidelines as cited in the justification.

IF FILED BY APPLICANT, ATTACH CERTIFIED DOCUMENT ISSUED BY THE DEPARTMENT OF CANNABIS REGULATION

STATING THAT THE DEPARTMENT HAS FOUND THE PROJECT TO BE EXEMPT.

If different from the applicant, the identity of the person undertaking the project.

**CITY STAFF USE ONLY:**

CITY STAFF NAME AND SIGNATURE

Jason Killeen

STAFF TITLE

Asst. Executive Director

COMMERCIAL CANNABIS ANNUAL LICENSE(S) APPROVED

Retail with on-site sales (Type 10)

DISTRIBUTION: County Clerk, Agency Record

Rev. 6-22-2021

DEPARTMENT OF  
CANNABIS REGULATION  
-  
CANNABIS REGULATION  
COMMISSION

THRYERIS MASON  
PRESIDENT

DAVID NASH  
VICE PRESIDENT

ANTON FARMBY  
SHI YOUNG LIM  
MARIO MELENDEZ

JOSIE TREVIZO  
Commission Executive Assistant  
(213) 978-0738

City of Los Angeles  
CALIFORNIA



Karen Bass  
MAYOR

EXECUTIVE OFFICES  
221 N. FIGUEROA STREET, SUITE 1245  
LOS ANGELES, CA 90012  
(213) 978-0738

MICHELLE GARAKIAN  
EXECUTIVE DIRECTOR

JASON KILLEEN  
ASSISTANT EXECUTIVE DIRECTOR

VACANT  
ASSISTANT EXECUTIVE DIRECTOR

<http://cannabis.lacity.org>

## RECOMMENDATION REPORT FOR RETAIL WITH ON-SITE SALES COMMERCIAL CANNABIS LICENSE

Pursuant to Los Angeles Municipal Code (LAMC) Section 104.06, the following application for commercial cannabis activity is complete and the Department of Cannabis Regulation (DCR) has determined the Applicant meets the requirements for the issuance of an Annual License for the commercial cannabis activity listed below. DCR recommends that the Cannabis Regulation Commission approve the issuance of an Annual License. DCR also has determined this project is categorically exempt from the requirements of the California Environmental Quality Act (CEQA) pursuant to the Class 1 and Class 32 categorical exemptions.

<b>DCR Core Record No.:</b>	310070
<b>Applicant Name:</b>	Weed Lane, Inc.
<b>DCR Record No. / Activities Requested:</b>	LA-R-24-310070-ANN / Retail w/ on-site sales (Type 10)
<b>Proposed Project:</b>	The Applicant seeks an Annual License for the Type 10 Retail Storefront with on-site sales commercial cannabis activity pursuant to LAMC section 104.06 et. al.
<b>Business Premises Address/ Project Location:</b>	7872 S Crenshaw Blvd., Los Angeles, CA 90043
Council District: Closest Neighborhood Council (NC): Business Improvement District: Community Plan Area: Zoning:	8 Park Mesa Heights None West Adams - Baldwin Hills - Leimert C2-1VL-CPIO
<b>LAMC Section / "Phase":</b>	LAMC 104.06 / Phase 3 Retail Round 1
<b>Evidence of Offer to Meet with NC:</b>	Yes
<b>Complaint Portal Entry: Recent Compliance Inspection:</b>	No No
<b>Social Equity Applicant / Ownership %:</b>	Yes / 51%
<b>Environmental Analysis/Clearance: ENV-310070-ANN</b>	Notice of Exemption pursuant to the Class 1 and Class 32 categorical exemptions (tit. 14, Cal. Code Regs., §§ 15301, 15332)

**BACKGROUND:**

The Applicant was issued Temporary Approval by DCR on June 2, 2022. Since that time, the Applicant has adhered to the requirements of the Los Angeles Municipal Code (LAMC) and DCR's Rules and Regulations, and completed all requirements for the issuance of an Annual License. The Applicant currently possesses a State provisional License, C10-0001045-LIC to conduct Retail with on-site sales Commercial Cannabis Activity, which is active through May 27, 2025. The Applicant is subject to the requirements of LAMC Section 104.20 for the Social Equity Program. The Business Premises is located at 7872 S Crenshaw Blvd., Los Angeles, CA 90043, a parcel zoned for Neighborhood Commercial purposes.

Social Equity Applications are evaluated for compliance with the Equity Share requirements under LAMC 104.20. To comply with the Equity Share requirements, Social Equity Individual Applicants (SEIAs) must possess unrestricted ownership of their share of the Social Equity Applicant (business), a proportional right to vote and to the profits, and include certain language mandated by LAMC 104.20 in their agreements, among other requirements. As part of the application process, DCR reviewed the corporate and ownership documentation provided for this Applicant and determined that the Applicant met the minimum Equity Share requirements at that time.

**DEPARTMENT ANNUAL LICENSING RECOMMENDATION:**

DCR recommends approving the Annual License for the Applicant based on the following factors:

- The Applicant has met the Application requirements under LAMC Section 104.03.
- The Business Premises location meets the requirements under LAMC Section 105.02.
- The Application does not contain any grounds for denial under LAMC Section 104.04.
- The Applicant has met the requirements under LAMC Section 104.20.

**COMMUNITY INPUT:**

On or about August 8, 2024, DCR provided notice of the community meeting and Cannabis Regulation Commission meeting by mail to the owners and occupants of all property within 700 feet of the property line of the Business Premises. Notice was also provided to the nearest Neighborhood Council, Business Improvement District, and Council Office.

The virtual community meeting was held on August 29, 2024. During the meeting, members of the public were afforded two minutes each to speak about the Application. DCR also accepted online written input through the date of the community meeting. DCR did not receive oral or written testimony for this Applicant.

Number of Comments In Favor of the Application	0
Number of Comments Against the Application	0
<b>Total Number of Comments</b>	<b>0</b>

The Applicant provided proof to DCR that it contacted the nearest Neighborhood Council and offered to appear before the Neighborhood Council, however, it was not within 10 days per LAMC Section 104.06(b)(1)(ii).

**COMPLIANCE REVIEW:**

DCR has not recently performed a compliance inspection for this Applicant. However, this business shall be subject to multiple, future inspections by DCR and several other agencies prior to the receipt of an Operating Permit. An Operating Permit is the final authorization from DCR to conduct Commercial Cannabis Activity, and is issued only after a licensee has passed a Final Inspection by DCR, and obtained all permits, clearances, or other authorizations required by law, which may include a Certificate of Occupancy from the Los Angeles Department of Building and Safety, clearance from the Los Angeles Fire Department and/or permit from the Los Angeles County Department of Public Health.



**THERE ARE NO EXISTING REASONS TO DENY AN ANNUAL LICENSE:**

DCR or the Cannabis Regulation Commission may deny an Annual Application for the reasons stated in LAMC section 104.04. These denial reasons include, but are not limited, to:

- The Business Premises is substantially different from the diagram of the Business Premises submitted by the Applicant or Licensee;
- Denying DCR employees or agents access to the Business Premises;
- Procuring a License by fraud or deceit, making a material misrepresentation, false statement, or knowingly failing to disclose a material fact;
- Failing to timely to provide DCR with requested information, forms or documents;
- Denial of a license, permit or other authorization to engage in Commercial Cannabis Activity by any state or other local licensing authority;
- Creation a significant public safety problem as documented by a law enforcement agency;
- Failure to adhere to the requirements of this article or the Rules and Regulations;
- Engaging in unlicensed Commercial Cannabis Activity in violation of Section 104.15;
- Revocation of Temporary Approval;
- Failing a Business Premises inspection by DCR, another City agency, or the Los Angeles County Department of Public Health; or
- Failing to comply with any requirement in LAMC Section 104.20;
- The Business Premises was the site of a utility disconnect, padlocking or certain criminal convictions for a period of 5 years from the date of the conviction, padlock or disconnect;
- Improper zoning or distancing of the Business Premises from Sensitive Uses under LAMC Section 105.00 *et seq.*;
- An Owner is an individual who holds office in, is employed by any agency of the State of California and any of its political subdivisions when the individual's duties include the enforcement or regulation of Commercial Cannabis Activity or any other penal provisions of law of the State of California prohibiting or regulating Commercial Cannabis Activity; and,
- An Owner is an entity incorporated outside of the United States.

At present, DCR is not aware of any existing facts or circumstances to deny this Annual License for the reasons in LAMC Section 104.04. Thus, DCR recommends the Commission approve the issuance of this Annual License.

**CALIFORNIA ENVIRONMENTAL QUALITY ACT (CEQA) PROJECT DESCRIPTION:**

The Applicant seeks conversion of an existing Retail Storefront (Type 10) Temporary Approval to an Annual License to be located on an existing site zoned for Neighborhood Commercial, C2-1VL-CPIO at 7872 S Crenshaw Blvd., Los Angeles, CA 90043 (Assessor's Parcel Number 4012-009-025). The Project-Specific Information (LIC-4013-FORM) submitted by the Applicant states that existing structures will remain with no expansion proposed (Exhibit A). Existing City sewer service is provided to the project site, and water and electricity are provided by the City of Los Angeles Department of Water and Power. Operations would be seven days per week from 8:00 a.m. to 10:00 p.m. Pre-application review has found the project to be consistent with planning and zoning. Further project site information is provided in the Project Parcel Profile Report from the City's Zone Information and Map Access System (ZIMAS) (Exhibit A). Compliance with Los Angeles Municipal Code Sections 104.00 *et seq.* and 105.00 *et seq.*, as well as DCR's Rules and Regulations, does not waive or otherwise circumvent any other City or State requirements or necessary permits from the City, State, or other public agencies, such as the Los Angeles Department of Building and Safety, the Los Angeles Fire Department, or the Los Angeles County Public Health Department. Full compliance with all applicable regulations for the proposed cannabis use(s) are assumed in this analysis.

**CEQA PROJECT ANALYSIS & FINDINGS:**

**Land Use/Zoning Designations**

Neighborhood Commercial / C2-1VL-CPIO

**Surrounding Land Use/Zoning Designations**

Neighborhood Commercial / C2-1VL-CPIO

Low Residential / R1-1

**Subject Property**

The subject site is a fully developed lot within the West Adams - Baldwin Hills - Leimert Community Plan Area.

The lot is approximately 100 feet deep and a width of 44 feet along Crenshaw Blvd. The site is currently developed with a one-story commercial building, built in 1984 proposed to be maintained.

The site has a Neighborhood Commercial land-use designation and is zoned C2-1VL-CPIO. The site is located within Council District 8, Park Mesa Heights Neighborhood Council, the lot is flat and contains a pre-existing building to be used by the Applicant.

### **Abutting Properties**

Abutting uses include Neighborhood Commercial and Low Residential uses within 200 feet of the site. The immediate area along Crenshaw Blvd is predominantly developed with Neighborhood Commercial uses, zoned C2-1VL-CPIO. (See Exhibit A)

### **CEQA Findings**

CEQA Guidelines, Sections 15301 & 15332, Class 1 & Class 32, consists of projects characterized as in-fill development meeting the following 5 conditions: (a) The project is consistent with the applicable general plan designation and all applicable general plan policies as well as with the applicable zoning designation and regulations; (b) The proposed development occurs within city limits on a project site of no more than five acres substantially surrounded by urban uses; (c) The project site has no value as habitat for endangered, rare or threatened species; (d) Approval of the project would not result in any significant effects relating to traffic, noise, air quality, or water quality; and (e) The site can be adequately served by all required utilities and public services.

These conditions are met as follows: The project is consistent with the applicable general plan designation and all applicable general plan policies as well as with the applicable zoning designation and regulations for the requested commercial cannabis activities.

a) The site is comprised of one lot totaling approximately 9,083 gross square feet, zoned C2-1VL-CPIO with a commercial building originally constructed in 1984. No relief has been requested from any applicable provision or requirement of the Los Angeles Municipal Code.

b) The subject site is wholly within the City of Los Angeles, on an approximately 9,083 gross square foot property (i.e., less than five acres), and is substantially surrounded by urban uses. The surrounding area is zoned Neighborhood Commercial / C2-1VL-CPIO, and Low Residential / R1-1; and developed with a mix of Neighborhood Commercial uses along Crenshaw Blvd between 78th Place and W 79th Street.

c) The project site has no value as habitat for endangered, rare or threatened species. The project is located within an established, fully developed, neighborhood. The project site has no value as habitat for endangered, rare or threatened species. The project does not propose the removal of any trees on-site and/or within the adjacent public right-of-way.

d) Approval of the project would not result in any significant effects relating to traffic, noise, air quality, or water quality.

e) The site can be adequately served by all required utilities and public services. The project site will be adequately served by all required public utilities and services, given that the site is currently served by the City's Department of Water and Power, the City's Bureau of Sanitation, the Southern California (SoCal) Gas Company, the Los Angeles Police Department, the Los Angeles Fire Department, Los Angeles Unified School District, Los Angeles Public Library, and other public services. Compliance with Regulatory Compliance Measures as enforced through the Department of Building and Safety permitting process will ensure that any needed improvements are made in order to provide adequate delivery of utilities and services to the proposed project.

CEQA Section 15300.2: Exceptions to the Use of Categorical Exemptions. The City has further considered whether the proposed project is subject to any of the exceptions set forth in State CEQA Guidelines Section 15300.2, that would prohibit the use and reliance on the categorical exemptions. None of the exceptions are triggered. As the proposed project will result in no physical changes to the site, the project would not have physical impacts to the environment. As such, it would not have a combined impact with other projects in the area that would result in cumulative impacts. There are no unusual circumstances associated with the project, which is proposed in general plan designation and zoning classification that allow the proposed use. The project

will not physically change the site or the existing structures. Therefore, the project would have no impact on scenic resources, historic building(s), and the site is not on the lists that satisfy Government Code Section 65962.5, commonly referred to as the "Cortese List," as being affected by hazardous wastes or clean-up problems.

Based on the analysis above, the proposed project is consistent with the criteria for Class 1 and Class 32 categorical exemptions (tit. 14, Cal. Code Regs., §§ 15301, 15332) and does not require further analysis based on the exceptions in CEQA Guidelines Section 15300.2, and thus, DCR finds that no further CEQA analysis is required.

In conclusion, since the project meets all of the requirements for categorical exemption as set forth at CEQA Guidelines, Sections 15301 & 15332, and none of the applicable exceptions to the use of an exemption apply to the project, it is appropriate to determine this project is categorically exempt from the requirements of CEQA.

**DEPARTMENT OF CANNABIS REGULATION RECOMMENDED ACTIONS:**

That the Cannabis Regulation Commission:

1. Determine, based on the whole of the administrative record, that the project is exempt from the California Environmental Quality Act (CEQA) pursuant to Article 19, Section 15301, Class 1, and Article 19, Section 15332, Class 32 of the State CEQA Guidelines (tit. 14, Cal. Code Regs., §§ 15301, 15332), and there is no substantial evidence demonstrating that an exception to a categorical exemption pursuant to CEQA Guidelines Section 15300.2 applies;
2. Pursuant to Los Angeles Municipal Code Section 104.06(b)(2), approve the Annual License for Type 10 Storefront Retail Commercial Cannabis Activity at the Business Premises location; and,
3. Adopt DCR's Project Analysis & Findings as the Commission's report on the subject.

  
\_\_\_\_\_  
Jason Killeen  
Assistant Executive Director, Department of Cannabis Regulation

September 3, 2024  
CRC Transmission Date

**EXHIBITS:**

A – Project Specific Information Form (LIC-4013-FORM) and Materials



LIC-4013-FORM

**Instructions:** Before the Department of Cannabis Regulation (DCR) can grant an Annual License, DCR must independently evaluate the document prepared for the project in compliance with the California Environmental Quality Act (CEQA), or documentation provided by the Applicant or Licensee as evidence of exemption from CEQA. To conduct this evaluation, DCR must have a complete description of the proposed project that provides information about the project site, including existing conditions and facilities, proposed facilities and improvements, and the construction methods and operations practices of the proposed project.

Please provide detailed responses with as much information as possible. If more space is needed, additional pages may be added. Missing, incomplete, or inconsistent information may delay the processing of your Annual License Application.

Date (MM/DD/YYYY): October 27, 2023

Lead Agency: City of Los Angeles - Department of Cannabis Regulation

DCR Record No.: LA-S-23-310070-ANN

Applicant Entity Name: Weed Lane, Inc.

License Type(s): Retailer

Business Premises Location: 7872 S. Crenshaw Blvd., Los Angeles, CA 90043

County: Los Angeles Assessor's Parcel Number (APN): 4012-009-025

Council District: CD-8 Marqueece Harris-Dawson Neighborhood Council: Park Mesa Heights

Community Plan Area: West Adams - Baldwin Hills - Leimert

Zoning: C2-1VL-CPIO Specific Plan Area: South Los Angeles Alcohol Sales

General Plan Land Use: Neighborhood Commercial Redevelopment Project Area: Crenshaw/Slauson

Business Improvement District: None

Promise Zone: None

State Enterprise Zone: Los Angeles

Historic Preservation Review: No

LAPD Division/Station: 77th Street

LAFD District/Fire Station: 66

### Categorical Exemption Evaluation Form

**Instructions:** Before the Department of Cannabis Regulation (DCR) can grant an Annual License, DCR must independently evaluate the document prepared for the project in compliance with the California Environmental Quality Act (CEQA), or documentation provided by the Applicant as evidence of exemption from CEQA. To conduct this evaluation, DCR must have a complete description of the proposed project that provides information about the project site, including existing conditions and facilities, proposed facilities and improvements, and the construction methods and operations practices of the proposed project. DCR can complete its review more quickly and efficiently when applicants provide as much of the information needed by DCR to complete an independent evaluation of the proposed project as is available.

Please provide detailed responses. If more space is needed, additional pages may be added. Missing, incomplete, or inconsistent information may delay the processing of your Annual License Application.

**Project Description:** *Insert project description information or reference where this information is located.*

Address=7872 S. Crenshaw Blvd., Los Angeles, CA 90043

Los Angeles County

APN=4012-009-025

Major cross streets = Crenshaw Blvd. and Florence Avenue

Project cross streets: Crenshaw Blvd. and 79th Street

Directions: Approximately 8 blocks South of Florence Avenue, on the East side of Crenshaw, at the corner of 79th Street and Crenshaw.

Project Site is a one-story building with its own parking lot. Entrance/exit is from driveway on Crenshaw Blvd. or 79th St. Customer entrance door near South end of building and deliveries/employees enter door near North end of building.

Project occupies entire APN; there are no subleases.

The Project does not involve the expansion of any structures beyond the existing footprint and this is a fully existing structure in which interior tenant improvements and minor alterations have been made to accommodate the use activities of commercial cannabis cultivation, manufacturing, distribution and processing.

See attached documents, maps and photos.

**Categorical Exemption Evaluation Form**

**Class 1: Existing Facilities**

1. Is the project site currently operating as a cannabis activity site or a similar use, or has it recently operated for this purpose? ☒ Yes ☐ No

*Provide details of current or prior operation(s). Cite source(s) of information.*

Project site has recently operated for this purpose.

Current use is Retail.

2. Does the project involve an expansion of existing structures that would be considered negligible or no expansion of existing or former use? (If no, skip to Question 6) ☐ Yes ☒ No

*Provide expansion details, if applicable. Cite source(s) of information.*

There is no expansion. Existing structure to remain.



3. Project Expansion: NA

Size of expansion in square feet: \_\_\_\_\_

*Cite source(s) of information.*

- a. Would the expansion be less than or equal to 2,500 square feet or 50 percent of the floor area before expansion? (If yes, skip to Question 6.) ☐ Yes ☐ No

*Cite source(s) of information.*

- b. Would the expansion be more than 2,500 square feet or 50 percent of the floor area before expansion? (If yes, skip to Question 4.) ☐ Yes ☐ No

*Cite source(s) of information.*

- c. Would the expansion be greater than 10,000 square feet? ☐ Yes ☐ No

*Cite source(s) of information.*

4. Is the project site served by all public services sufficient to serve the project (e.g., water, sewer, electricity, gas)? ☒ Yes ☐ No

*Describe which public services serve the project site. Cite source(s) of information.*

Water service by Los Angeles Department of Water &amp; Power

Power service by Los Angeles Department of Water &amp; Power

Site is connected to City sewer line

Site is adequately serviced by these companies.

5. Is there evidence that the project site is located in an environmentally sensitive area?

☐ Yes ☒ No

*Describe the environmentally sensitive area (if applicable). Cite source(s) of information, if available.*

The site is not environmentally sensitive and there is no environmentally sensitive area within one half mile radius of the project site.

6. Does the project require a water right permit or another environmental permit that could result in physical changes to the environment? (If yes, see instructions.)

☐ Yes ☒ No

*List permits required and any potential physical changes that could occur. Cite source(s) of information.*

7. Does the project require demolition and removal of individual small structures (e.g., one single-family residence, a duplex or similar multifamily structure, a store, motel or restaurant or accessory structures?

☐ Yes ☒ No

*Describe size of structure to be demolished and location.*

**Categorical Exemption Evaluation Form**

**Class 2: Replacement or Reconstruction**

\*\*\*\*NOT APPLICABLE TO PROJECT SITE\*\*\*\*

1. Does the project involve the replacement or reconstruction of an existing structure on the same site as the structure being replaced or reconstructed? ☐ Yes ☐ No

*Describe both the existing structure and replacement structure, including the location on the site. Cite source(s) of information.*



2. Would the new structure have substantially the same purpose and capacity as the existing structure? ☐ Yes ☐ No

*Provide information on the purpose of both the existing and replacement structures to ensure they are the same. Cite source(s) of information.*



3. Does the project require a water right permit or another environmental permit that could result in physical changes to the environment? (If yes, see instructions.) ☐ Yes ☐ No

*List permits required and any potential physical changes that could occur. Cite source(s) of information.*

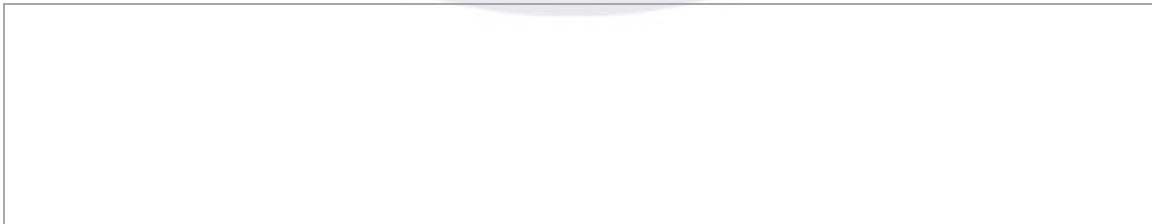

**Categorical Exemption Evaluation Form**

**Class 3: New Construction or Conversion of Small Structures**

\*\*\*\*NOT APPLICABLE TO PROJECT SITE\*\*\*\*

1. Does the project involve the conversion of existing small structures including only minor modifications, or the installation of small equipment and facilities in small structures? ☐ Yes ☐ No

*Provide information regarding the nature of modifications to existing small structures, if applicable. Cite source(s) of information.*



2. Does the project involve the construction of new small structures? ☐ Yes ☐ No

*Provide information regarding the size and purpose of the proposed new structures, if applicable. Cite source(s) of information.*



***Please check instructions for directions on how to proceed, based on answers to Questions 1 and 2.***

3. Is the project within an urbanized area? (If no, skip to Question 9.) ☐ Yes ☐ No

*Cite source(s) of information.*



**FOR SITES IN URBANIZED AREAS**

4. Does the project involve the construction of four or fewer structures totaling 10,000 square feet or less?

☐ Yes ☐ No

*Provide information regarding size of new structure(s), if applicable. Cite source(s) of information.*



5. Is the parcel zoned for the proposed use?

☐ Yes ☐ No

*Cite source(s) of information.*



6. Does the project involve the use of significant amounts of hazardous substances?

☐ Yes ☐ No

*Provide details of any hazardous substances used including amount of product(s), if applicable. Cite source(s) of information.*



7. Are all necessary public services and facilities available to the project?

☐ Yes ☐ No

*List all services and facilities provided. Cite source(s) of information.*

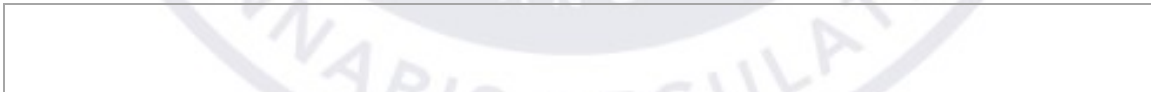

8. Do either the project site or the surrounding lands contain a sensitive environmental area? (If no, skip to Question 11.)

☐ Yes ☐ No

*Provide information on the nature of any sensitive environmental areas. Cite source(s) of information, if available.*



**FOR SITES NOT IN URBANIZED AREAS**

9. Does the project involve the construction of a single structure totaling 2,500 square feet or less?

☐ Yes ☐ No

*Provide information regarding size of new structure, if applicable. Cite source(s) of information.*



10. Does the project involve the use of significant amounts of hazardous substances?

☐ Yes ☐ No

*Provide list of any hazardous substances used, including amount of product(s), if applicable and available. Cite source(s) of information.*

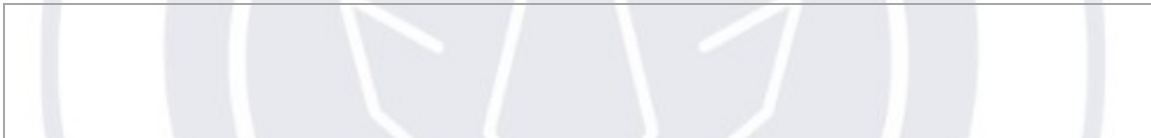

**FOR ALL SITES**

11. Does the project require a water right permit or another environmental permit that could result in physical changes to the environment? (If yes, see instructions.)

☐ Yes ☐ No

*List permits required and any potential physical changes that could occur. Cite source(s) of information.*





**Categorical Exemption Evaluation Form**

**Class 4: Minor Alterations to Land**  
**\*\*\*NOT APPLICABLE TO PROJECT SITE\*\*\***

1. Does the project involve the removal of healthy, mature, scenic trees (except for forestry and agricultural purposes)? ☐ Yes ☐ No

*Provide details, if needed. Cite source(s) of information.*



2. Does the project involve alterations to land, water, or vegetation that would be considered minor? ☐ Yes ☐ No

*Provide details, if needed. Cite source(s) of information.*



3. Would the alterations consist of grading on lands of 10 percent slope or steeper? ☐ Yes ☐ No

*Provide details, if needed. Cite source(s) of information.*



4. Would the alterations consist of grading in an area determined to be a wetland? ☐ Yes ☐ No

*Cite source(s) of information.*



5. Would the alterations consist of grading in a scenic area officially designated by a federal, state, or local agency? ☐ Yes ☐ No

*Provide name of scenic area (if applicable). Cite source(s) of information.*

6. Would the alterations consist of grading in an officially mapped area of severe geologic hazard, such as an Alquist- Priolo Earthquake Fault Zone, or within an official Seismic Hazard Zone designated by the State Geologist? ☐ Yes ☐ No

*Provide the name of the zone (if applicable). Cite source(s) of information.*

7. Does the project require a water right permit or another environmental permit that could result in physical changes to the environment? (If yes, see instructions.) ☐ Yes ☐ No

*List permits required and any potential physical changes that could occur. Cite source(s) of information.*

**Categorical Exemption Evaluation Form**

**Class 11: Accessory Structures**  
**\*\*\*\*NOT APPLICABLE TO PROJECT SITE\*\*\*\***

1. Does the project include the construction or placement of accessory structures? ☐ Yes ☒ No

*Describe new and/or replacement accessory structures. Cite source(s) of information.*



2. Does the project require a water right permit or another environmental permit that could result in physical changes to the environment? (If yes, see instructions.) ☐ Yes ☒ No

*List permits required and any potential physical changes that could occur. Cite source(s) of information.*



**Categorical Exemption Evaluation Form**

**Class 32: Infill Development Projects**  
**\*\*\*\*NOT APPLICABLE TO PROJECT SITE\*\*\*\***

1. Is the project consistent with the general plan designation, all applicable general plan policies, and zoning designation and regulations for the site? ☐ Yes ☐ No

*Cite source(s) of information.*



TM

2. Project Size and Location

- a. Is the project site 5 acres in size or less? ☐ Yes ☐ No

*Indicate the size of the project site, in acres. Cite source(s) of information.*

- b. Is the project site substantially surrounded by urban uses? ☐ Yes ☐ No

*Describe the uses of the surrounding properties. Cite source(s) of information.*

3. Does the project site have value as habitat for endangered, rare, or threatened species? ☐ Yes ☐ No

*Describe any habitat for endangered, rare, or threatened species identified on or near the project site (if applicable). Cite source(s) of information.*

4. Would the project have significant impacts related to traffic, noise, air quality, or water quality? ☐ Yes ☐ No

*Describe potential impact(s) and evidence (if applicable). Cite source(s) of information.*



5. Can the project site be adequately served by all required utilities and public services? ☐ Yes ☐ No

*Describe which utilities and public services serve the project site. Cite source(s) of information.*



6. Does the project require a water right permit or another environmental permit that could result in physical changes to the environment? (If yes, see instructions.) ☐ Yes ☐ No

*List permits required and any potential physical changes that could occur. Cite source(s) of information.*



**Exceptions to Exemptions****1. Scenic Highways**

- a. Is the project visible from an official State Scenic Highway? ☐ Yes ☒ No

*List State Scenic Highway(s) from which the project is visible (if applicable).  
Cite source(s) of information.*

No State Scenic Highway from which the project is visible.

- b. If yes, would the project result in damage to scenic resources? ☐ Yes ☒ No

*Describe scenic resources and potential damage (if applicable). Cite source(s) of information.*

**2. Is the project located on a site included on any list compiled pursuant to Government Code § 65962.5 (Cortese List)?**

☐ Yes ☒ No

*Describe the type of hazardous site (if applicable). Cite source(s) of information.*

Search of zip code at [envirostor.dts.ca.gov](https://envirostor.dts.ca.gov) shows the project is not located on the Cortese List. The Envirostor report showing a 1000' radius is attached.

**3. Would the project result in a substantial adverse change in the significance of a historical resource?**

☐ Yes ☒ No

*List the historic resource(s) potentially affected and describe the potential effects (if applicable). Cite source(s) of information.*

No historic resource exists at the project location.



4. **Is there evidence of the potential for the project to contribute to a significant cumulative impact?**

☐ Yes ☒ No

*Describe the potential cumulative impact(s) and evidence (if applicable). Cite source(s) of information.*



5. **Is there evidence of a reasonable possibility of a significant environmental impact due to unusual circumstances?**

☐ Yes ☒ No

*Describe the potential impact(s), circumstances, and evidence (if applicable). Cite source(s) of information.*



6. **Would the project impact an environmental resource of hazardous or critical concern?**

☐ Yes ☒ No

*Provide details, if needed. Cite source(s) of information.*



7. **Does the project involve the removal of healthy, mature, scenic trees (except for forestry and agricultural purposes)?**

☐ Yes ☒ No

*Provide details, if needed. Cite source(s) of information.*

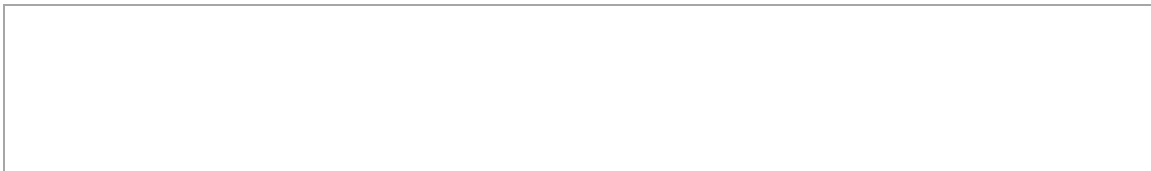

**CEQA Exemption Petition**Class: 1 Category: Existing Facilities

Explanation of how the project fits the CEQA exemption indicated above:

Project uses existing structure and consists of the operation, repair, maintenance, permitting, leasing, licensing, or minor alteration of existing public or private structures, facilities, mechanical equipment, or topographical features, involving no expansion of use.

Project site is existing. No expansion, this is not a new structure.  
Site is not an environmentally sensitive zone.  
Site is serviced by city water, sewer and power.  
There are no natural waterways onsite.

- 1. Source(s) of Information:** Identify Sources: *Indicate the document(s) or other sources of information reviewed to complete this form.*

Zimas Property Profile Report and Mapping  
Envirostor  
LADBS.org  
Internal corporate documents.

**2. Project Location and Surrounding Land Use.**

- (a) Describe Project Location: *Provide detailed information about the project location and any other physical description that clearly indicates the project site location.*

Address=7872 S. Crenshaw Blvd., Los Angeles, CA 90043 / Los Angeles County  
APN=4012-009-025 Project cross streets: Crenshaw Blvd. and 79th Street

Project Site is a one-story building with its own parkint lot. Entrance/exit is from driveway on Crenshaw Blvd. or 79th St. Customer entrance door near South end of building and deliveries/ employees enter door near North end of building.

- (b) Existing Land Uses/Zoning: *Describe the current land uses on the project site and any existing buildings and structures. Describe the surrounding land uses and zoning designations within a one-half mile radius of the project and list all abutting land uses.*

Current use is same as existing use, an industrial building improvement with parking spaces. Zoning for the Project Site is C2-1VL-CPIO – Commercial Zone. Within a one-half mile radius the zoning designations are: R1-1 – One Family Zone; R4-1 – Multiple Dwelling Zone. Adjacent uses in City of Inglewood are similar residential, with a Cemetery located three blocks West.

(See attached documents, maps and photos showing abutting uses)

- (c) Previous Use: Describe the previous use of the Project site or facility, if known. Include an estimate of the time such previous operations ceased, if such information is available.

Previous use was Silver Coin Laundry (coin-op laundry mat).

- (d) Was the site previously used for a similar use? The key consideration is whether the project involves negligible or no expansion of an existing use.

Yes. There is no expansion of the existing use. The previous use involved a daily customers bringing laundry loads and workers; the Applicant's business involves negligible expansion because Applicant has a comparable work force of sales staff and customers.

- (e) Maps to be Included: *Provide a vicinity map and aerial image to show the project location. Include photographs, not larger than 8½ by 11 inches, of existing visual conditions as observed from publicly accessible vantage point(s).*

**3. Project Operations/Description.** Provide the following information about project operation and maintenance activities. If more than one type of cannabis activity is occurring on-site, provide a description of the project operations for each activity. This should include the following relevant information.

- (a) Activities Occurring Onsite: *Describe the activities included in the project application and identify any other commercial cannabis activity or activities occurring at the proposed premises, including other proposed cannabis activities occurring on the property. Describe the cannabis business operation methods and activities (e.g. cultivation methods, manufacturing and/or distribution operations).*

Cannabis Retailer.

- (b) Cannabis Operation Activities Owned by the Same or Different Businesses: *Describe any additional cannabis operation activities existing or proposed either owned by the same or different businesses on the property.*

None.

- (c) Project Size: *Quantify the project size (total floor area of the project), and the lot size on which the project is located, in square feet.*

Total floor area is approximately 3,496 sq. ft.  
The lot size is 9,083 sq. ft.

- (d) State License: *Identify whether the applicant is licensed by, or has applied for licensure from, the California Department of Cannabis Control to engage in commercial cannabis activity at the proposed premises.*

Retailer license issued, C10-0001045-LIC

- (e) Hours of Operation/Work Shifts: *Identify the hours of operation/work shifts for the project.*

7 days per week  
8 a.m. to 10 p.m.  
Two work shifts, 8:00 a.m. to 4:00 p.m. and 2:00 p.m. to 10:00 p.m.

- (f) Number of employees (total and by shift): *Estimate the number of anticipated employees onsite and occupancy during operating hours.*

4 employees.  
15 occupancy.

- (g) Estimated Daily Trip Generation: *Estimate the frequency of deliveries or shipments originating from and/or arriving to the project site. Identify the approximate number of vehicle trips per day to be generated by the project and information regarding the days and times most trips are expected to occur.*

Estimated frequency of deliveries or shipments to/from site: Three times per week.  
Approximate number of vehicle trips: 4 vehicle trips  
Days and times of most trips: Monday-Friday, 8 a.m. to 8 p.m.

- (h) Source(s) of Water: *Name all sources of water, and indicate whether a new or amended water right must be obtained from the State Water Resources Control Board.*

Los Angeles Department of Water & Power

- (i) Wastewater Treatment Facilities: *Describe the facilities for treatment of wastewater (e.g., leach field, City wastewater collection facilities).*

City municipal sewer line. No on-site treatment facility.

#### 4. Environmental Setting:

- (a) Describe natural characteristics on the project site:

Metropolitan developed land with no natural characteristics.

- (b) General Topographic Features (slopes and other features):

No slopes or other features

- (c) Natural characteristics (general vegetation types, drainage, soil stability, habitat, etc.):

Paved over land with runoff drainage to municipal sewer line. No natural vegetation, soil, or habitat.

- (d) Identify whether there are any watercourses and riparian habitats within 150- feet of the proposed premises (e.g., drainage swales, stream courses, springs, ponds, lakes, creeks, tributary of creeks, wetlands):

No natural and/or artificial waterway on project site or within 150 feet of premises.

- (e) Identify whether the property contains natural features of scenic value of rare or unique characteristics (e.g., rock outcroppings, mature trees):

No natural features of scenic value or of rare/unique characteristics.

- (f) Identify whether the property has any historic designations or archeological remains onsite:

No historic designations or archeological remains.

- (g) Identify whether the property contains habitat for special status species:

No habitat for special status species.

- (h) Identify the location, type, and quantity of hazardous materials, as defined by Health and Safety Code section 25260, that are stored, used, or disposed of at the project site and a copy of the Hazardous Material Business Plan (HMBP) prepared for the proposed premises, if any:

None.

- (i) Discuss whether the project will increase the quantity and type of solid waste, as defined by Public Resources Code section 40191, or hazardous waste, as defined by Health and Safety Code section 25117, that is generated or stored onsite:

There will be no increase in waste.



- g) Describe the project's anticipated operational energy needs, identify the source of energy supplied for the project and the anticipated amount of energy per day, and explain whether the project will require an increase in energy demand and the need for additional energy resource:

Source of power is municipal utility, Los Angeles Department of Water & Power. Anticipated energy per day will be supplied by site transformer there is no need for additional energy sources. Daily energy demand is estimated at 75 kWh per day.

5. Explain whether any of the project activities will expand the existing footprint of the proposed facility beyond the current structural or parcel boundaries, increase the amount of impervious surface, or reduce any natural habitat. If the project is part of a larger project, attach a separate sheet to briefly describe the larger project.

No expansion of facility footprint, no increase in the amount of impervious surface, and no reduction in any natural habitat.

6. Environmental Commitments: *List any environmental commitments agreed to by the applicant to the protection of biological or cultural resources, energy efficiency, water efficiency, noise abatement, lighting, or other aspects of the project that may reduce impacts on the environment.*

Air filtration systems installed to reduce any odor of cannabis.

7. Other Relevant CEQA Information: *Submit any other relevant CEQA documentation or information that will assist the Department in determining CEQA compliance (e.g., any environmental impact analysis prepared by a consultant).*

See attached documents, maps and photos.

8. Permits Required: *List all other required federal, state, and local permits required, including, but not limited to, all entitlements required for this project by a planning commission, local air district, or regional water board. Identify whether the commercial cannabis business(es) is licensed by or has applied for licensure from the Department, or one of the prior state cannabis licensing authorities:*

- ☒ California Department of Cannabis Control
- ☒ Los Angeles Fire Department
- ☒ Los Angeles Department of Building and Safety
- ☐ California Department of Fish and Wildlife
- ☐ State Water Resources Control Board / Regional Water Quality Control Board
- ☒ County of Los Angeles Public Health Permit
- ☐ Local Air District
- ☐ Streambed Alteration Agreement
- ☐ Water quality protection program
- ☒ Los Angeles Department of Water and Power
- ☒ Los Angeles Department of Public Works, Bureau of Sanitation

## Partial List of Categorical Exemptions under CEQA

*Certain commercial cannabis activities (projects) may be exempt from further environmental review pursuant to the California Environmental Quality Act (CEQA) because they fall within a class of projects determined not to have significant effect on the environment. (Cal. Code Regs., tit. 14, § 15300 et seq.) Common exemptions that may apply have been identified below.*

Class	Category	Description
Class 1	Existing Facilities	Consists of the operation, repair, maintenance, permitting, leasing, licensing, or minor alteration of existing public or private structures, facilities, mechanical equipment, or topographical features, involving negligible or no expansion of use beyond that existing at the time of the lead agency's determination. (Cal. Code Regs., tit. 14, §15301.)
Class 2	Replacement or Reconstruction	Consists of replacement or reconstruction of existing structures and facilities where the new structure will be located on the same site as the structure replaced with a new structure of substantially the same size, purpose, and capacity. (Cal. Code Regs., tit. 14, § 15302.)
Class 3	New Construction or Conversion of Small Structures	Consists of construction and location of limited numbers of new, small facilities or structures; installation of small new equipment and facilities in small structures; and the conversion of existing small structures from one use to another where only minor modifications are made in the exterior of the structure. (Cal. Code Regs., tit. 14, § 15303.)
Class 4	Minor Alterations to Land	Consists of minor public or private alterations in the condition of land, water, and/or vegetation which do not involve removal of healthy, mature, scenic trees except for forestry and agricultural purposes. (Cal. Code Regs., tit. 14, § 15304.)
Class 11	Accessory Structures	Consists of construction, or placement of minor structures accessory to (appurtenant to) existing commercial, industrial, or institutional facilities. (Cal. Code Regs., tit. 14, § 15311.)
Class 32	In-Fill Development Projects	Consists of projects characterized as in-fill development meeting the conditions described in Cal. Code Regs., tit. 14, § 15332.

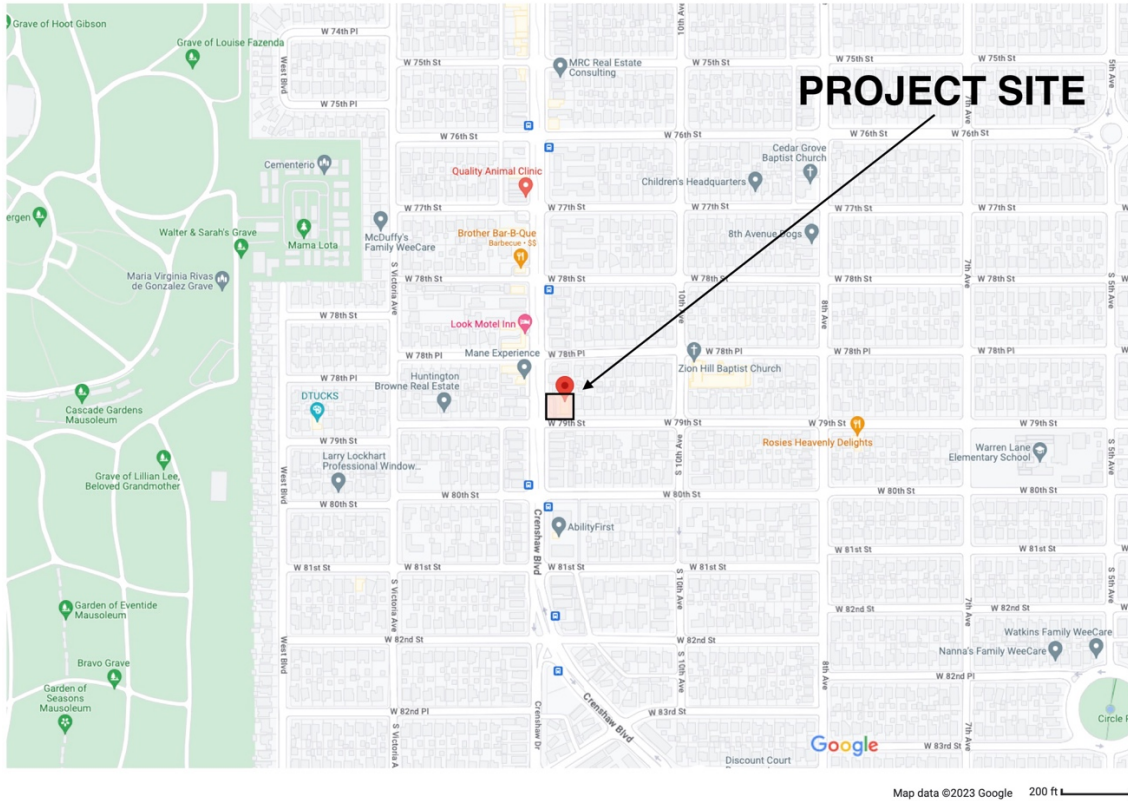

ASSESSOR'S PARCEL MAP

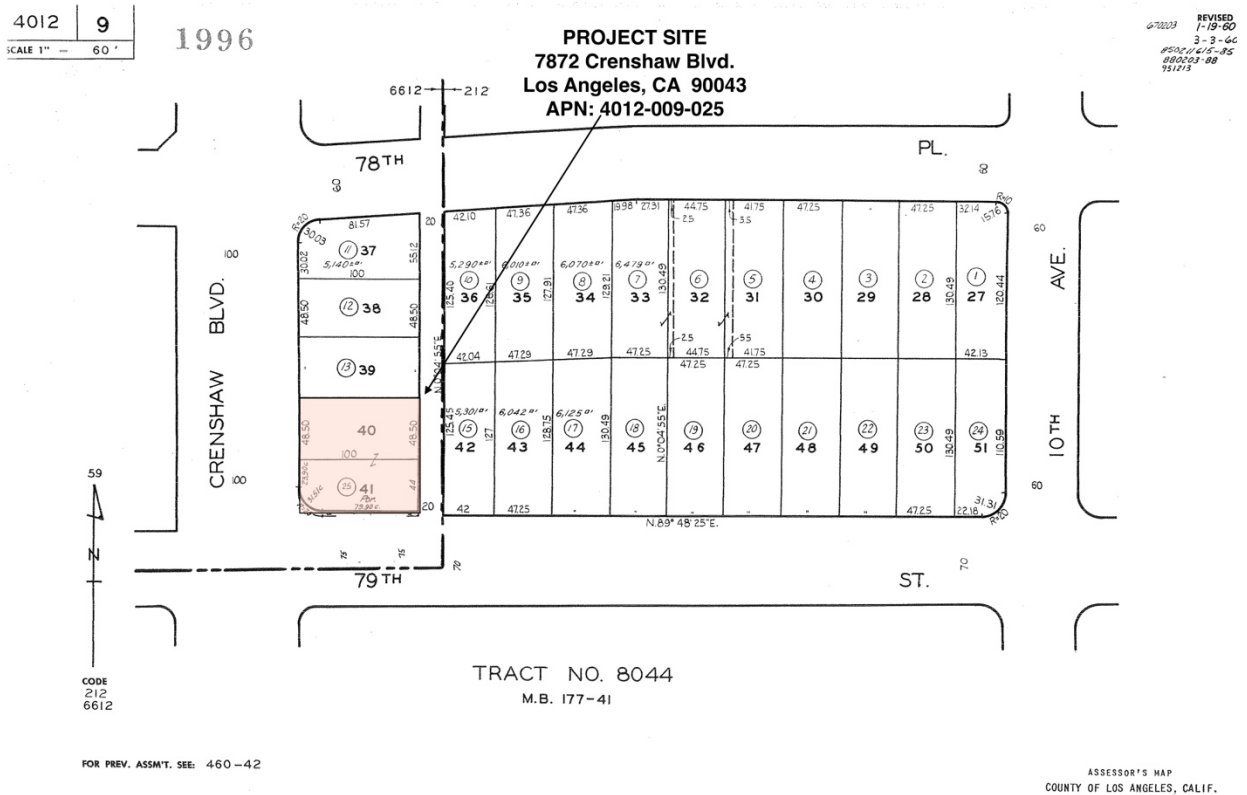



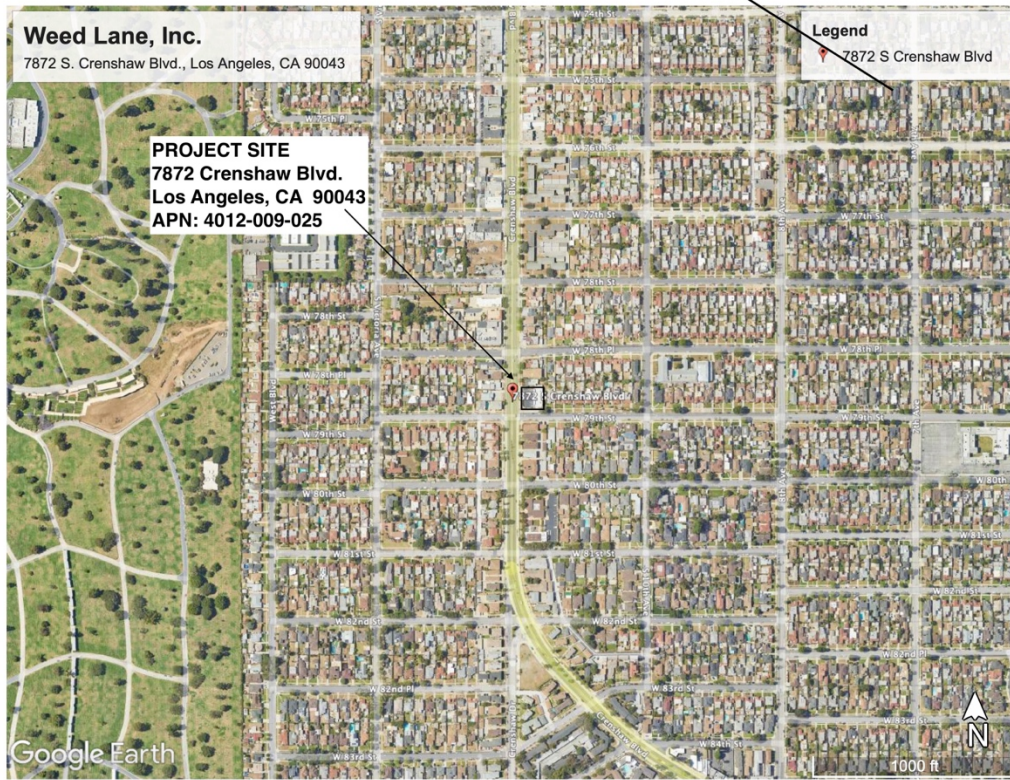



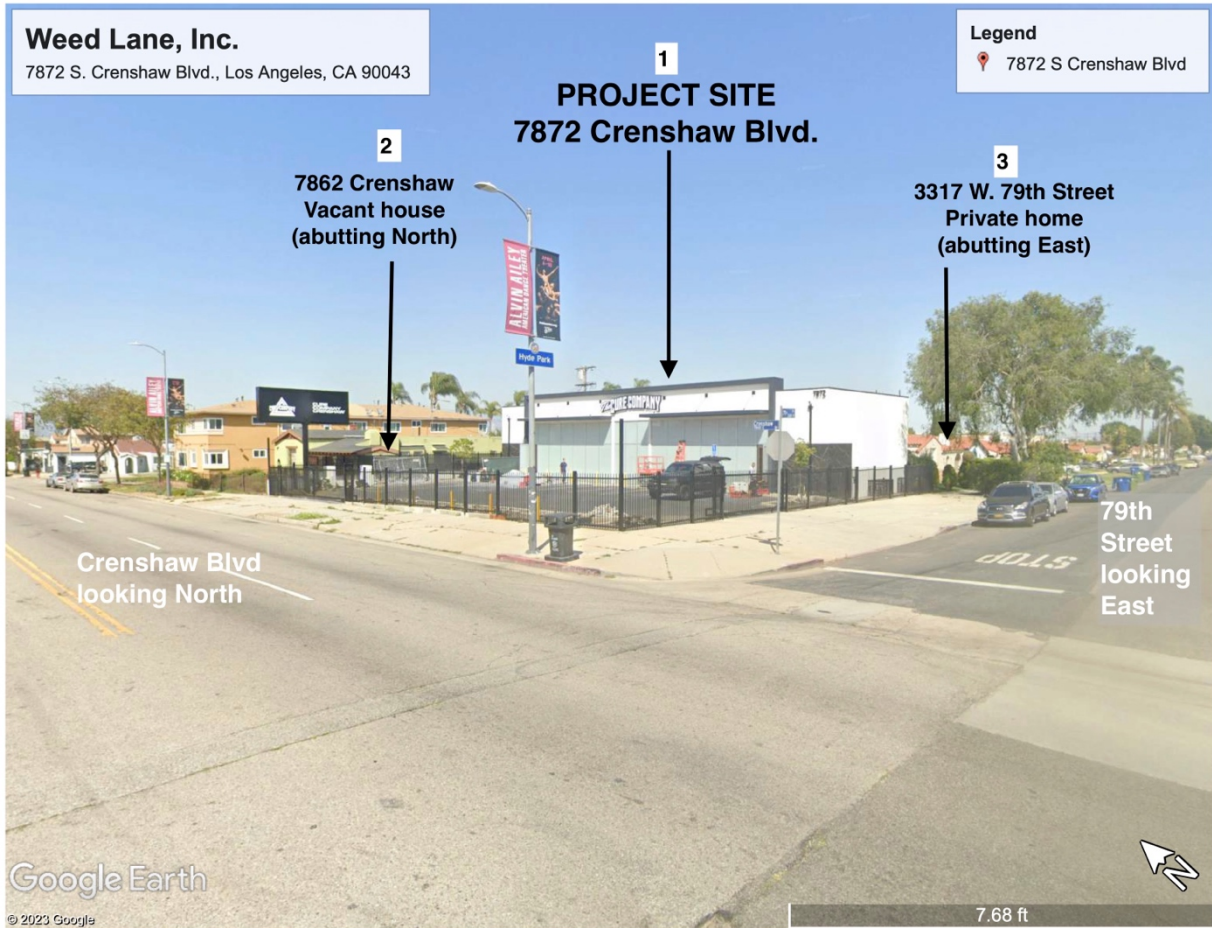

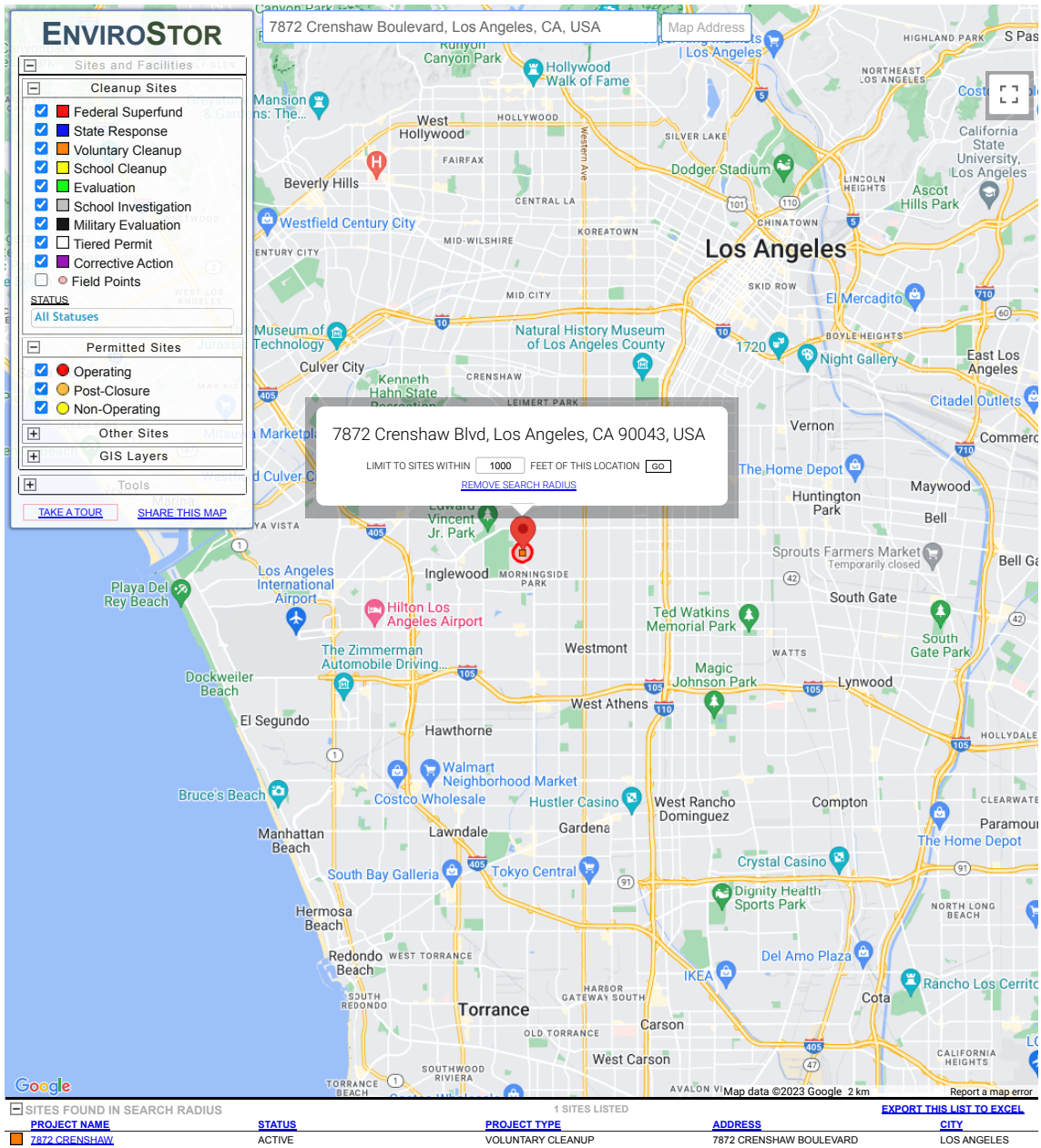





# City of Los Angeles Department of City Planning

## 9/6/2023 PARCEL PROFILE REPORT

### PROPERTY ADDRESSES

7872 S CRENSHAW BLVD

### ZIP CODES

90043

### RECENT ACTIVITY

None

### CASE NUMBERS

ADM-2019-3004-CPIOC

CPC-2018-6005-CA

CPC-2015-1314-MSC

CPC-2013-3169

CPC-2010-2278-GPA

CPC-2007-3827-ICO

CPC-2006-5567-CPU

CPC-1990-346-CA

CPC-1983-506

ORD-187643

ORD-184796-SA1890

ORD-184794

ORD-180103

ORD-171682

ORD-171681

ORD-162128

ENV-2019-4121-ND

ENV-2018-6006-CE

ENV-2015-1320-CE

ENV-2013-3170-CE

ENV-2010-2279-CE

ENV-2008-478-EIR

ENV-2007-3828-CE

ND-83-44-HD

AFF-55055

FG

### Address/Legal Information

PIN Number	099B185 420
Lot/Parcel Area (Calculated)	4,277.8 (sq ft)
Thomas Brothers Grid	PAGE 703 - GRID F1
Assessor Parcel No. (APN)	4012009025
Tract	TR 8044
Map Reference	M B 177-41
Block	None
Lot	FR 41
Arb (Lot Cut Reference)	None
Map Sheet	099B185

### Jurisdictional Information

Community Plan Area	West Adams - Baldwin Hills - Leimert
Area Planning Commission	South Los Angeles
Neighborhood Council	Park Mesa Heights
Council District	CD 8 - Marqueece Harris-Dawson
Census Tract #	2352.02
LADBS District Office	Los Angeles Metro

### Permitting and Zoning Compliance Information

Administrative Review	ADM-2019-3004-CPIOC
-----------------------	---------------------

### Planning and Zoning Information

Special Notes	None
Zoning	C2-1VL-CPIO
Zoning Information (ZI)	ZI-2498 Local Emergency Temporary Regulations - Time Limits and Parking Relief - LAMC 16.02.1
	ZI-2488 Redevelopment Project Area: Crenshaw/Slauson
	ZI-2374 State Enterprise Zone: Los Angeles
	ZI-2468 Community Plan Implementation Overlay: West Adams-Baldwin Hills-Leimert
	ZI-2452 Transit Priority Area in the City of Los Angeles
	ZI-2512 Housing Element Inventory of Sites
	ZI-1231 Specific Plan: South Los Angeles Alcohol Sales
General Plan Land Use	Neighborhood Commercial
General Plan Note(s)	Yes
Hillside Area (Zoning Code)	No
Specific Plan Area	SOUTH LOS ANGELES ALCOHOL SALES
Subarea	None
Special Land Use / Zoning	None
Historic Preservation Review	No
Historic Preservation Overlay Zone	None
Other Historic Designations	None
Other Historic Survey Information	None
Mills Act Contract	None
CDO: Community Design Overlay	None
CPIO: Community Plan Imp. Overlay	West Adams - Baldwin Hills - Leimert
Subarea	Commercial Corridors
CUGU: Clean Up-Green Up	None
HCR: Hillside Construction Regulation	No

This report is subject to the terms and conditions as set forth on the website. For more details, please refer to the terms and conditions at [zimas.lacity.org](https://zimas.lacity.org)  
(\*) - APN Area is provided "as is" from the Los Angeles County's Public Works, Flood Control, Benefit Assessment.

NSO: Neighborhood Stabilization Overlay	No
POD: Pedestrian Oriented Districts	None
RBP: Restaurant Beverage Program Eligible Area	None
RFA: Residential Floor Area District	None
RIO: River Implementation Overlay	No
SN: Sign District	No
AB 2334: Very Low VMT	Yes
AB 2097: Reduced Parking Areas	Yes
Streetscape	Crenshaw Boulevard
Adaptive Reuse Incentive Area	None
Affordable Housing Linkage Fee	
Residential Market Area	Medium
Non-Residential Market Area	Medium
Transit Oriented Communities (TOC)	Tier 2
ED 1 Eligibility	Eligible Site
RPA: Redevelopment Project Area	Crenshaw/Slauson
Central City Parking	No
Downtown Parking	No
Building Line	None
500 Ft School Zone	No
500 Ft Park Zone	No
<b>Assessor Information</b>	
Assessor Parcel No. (APN)	4012009025
APN Area (Co. Public Works)*	0.210 (ac)
Use Code	2400 - Commercial - Non-Auto Service and Repair Shop, Paint Shop, or Laundry - One Story
Assessed Land Val.	\$384,625
Assessed Improvement Val.	\$357,000
Last Owner Change	12/15/2021
Last Sale Amount	\$1,350,013
Tax Rate Area	6612
Deed Ref No. (City Clerk)	643935
	629242
	410490
	116371
	116370
	0-554
	0-544
Building 1	
Year Built	1984
Building Class	C6B
Number of Units	0
Number of Bedrooms	0
Number of Bathrooms	0
Building Square Footage	3,496.0 (sq ft)
Building 2	No data for building 2
Building 3	No data for building 3
Building 4	No data for building 4
Building 5	No data for building 5
Rent Stabilization Ordinance (RSO)	No [APN: 4012009025]
<b>Additional Information</b>	
Airport Hazard	None
Coastal Zone	None
Santa Monica Mountains Zone	No

This report is subject to the terms and conditions as set forth on the website. For more details, please refer to the terms and conditions at [zimas.lacity.org](https://zimas.lacity.org)  
 (\*) - APN Area is provided "as is" from the Los Angeles County's Public Works, Flood Control, Benefit Assessment.

Farmland	Area Not Mapped
Urban Agriculture Incentive Zone	YES
Very High Fire Hazard Severity Zone	No
Fire District No. 1	No
Flood Zone	Outside Flood Zone
Watercourse	No
Hazardous Waste / Border Zone Properties	No
Methane Hazard Site	Methane Buffer Zone
High Wind Velocity Areas	No
Special Grading Area (BOE Basic Grid Map A-13372)	No
Wells	None

#### Seismic Hazards

Active Fault Near-Source Zone	
Nearest Fault (Distance in km)	0.150318216
Nearest Fault (Name)	Newport - Inglewood Fault Zone (Onshore)
Region	Transverse Ranges and Los Angeles Basin
Fault Type	B
Slip Rate (mm/year)	1.00000000
Slip Geometry	Right Lateral - Strike Slip
Slip Type	Poorly Constrained
Down Dip Width (km)	13.00000000
Rupture Top	0.00000000
Rupture Bottom	13.00000000
Dip Angle (degrees)	90.00000000
Maximum Magnitude	7.10000000
Alquist-Priolo Fault Zone	No
Landslide	No
Liquefaction	No
Preliminary Fault Rupture Study Area	No
Tsunami Inundation Zone	No

#### Economic Development Areas

Business Improvement District	None
Hubzone	Qualified
Jobs and Economic Development Incentive Zone (JEDI)	None
Opportunity Zone	No
Promise Zone	None
State Enterprise Zone	LOS ANGELES STATE ENTERPRISE ZONE

#### Housing

Direct all Inquiries to	Los Angeles Housing Department
Telephone	(866) 557-7368
Website	<a href="https://housing.lacity.org">https://housing.lacity.org</a>
Rent Stabilization Ordinance (RSO)	No [APN: 4012009025]
Ellis Act Property	No
AB 1482: Tenant Protection Act	No
Housing Crisis Act Replacement Review	Yes
Housing Element Sites	
HE Replacement Required	Yes
SB 166 Units	0.03 Units, Lower
Housing Use within Prior 5 Years	No

#### Public Safety

Police Information	
Bureau	South
Division / Station	77th Street

This report is subject to the terms and conditions as set forth on the website. For more details, please refer to the terms and conditions at [zimas.lacity.org](https://zimas.lacity.org)  
 (\*) - APN Area is provided "as is" from the Los Angeles County's Public Works, Flood Control, Benefit Assessment.

Reporting District	1251
Fire Information	
Bureau	South
Battalion	13
District / Fire Station	66
Red Flag Restricted Parking	No

## CASE SUMMARIES

Note: Information for case summaries is retrieved from the Planning Department's Plan Case Tracking System (PCTS) database.

Case Number:	ADM-2019-3004-CPIOC
Required Action(s):	CPIOC-COMMUNITY PLAN IMPLEMENTATION OVERLAY CLEARANCE
Project Descriptions(s):	WEST ADAMS CPIO CLEARANCE.
Case Number:	CPC-2018-6005-CA
Required Action(s):	CA-CODE AMENDMENT
Project Descriptions(s):	RESOLUTION TO TRANSFER THE LAND USE AUTHORITY FROM THE COMMUNITY REDEVELOPMENT AGENCY OF THE CITY OF LOS ANGELES, DESIGNATED LOCAL AUTHORITY (CRA/LA-DLA) TO THE CITY OF LOS ANGELES AND CODE AMENDMENT TO ESTABLISH PROCEDURES FOR THE IMPLEMENTATION OF UNEXPIRED REDEVELOPMENT PLANS AND UPDATE OTHER RELEVANT CODE PROVISIONS IN THE LOS ANGELES MUNICIPAL CODE TO FACILITATE THE TRANSFER OF LAND USE AUTHORITY FROM THE CRA/LA-DLA TO THE CITY OF LOS ANGELES.
Case Number:	CPC-2015-1314-MSC
Required Action(s):	MSC-MISCELLANEOUS (POLICIES, GUIDELINES, RESOLUTIONS, ETC.)
Project Descriptions(s):	THE CRENSHAW BOULEVARD STREETSCAPE PLAN IS A GUIDELINE FOR STREETSCAPE ELEMENTS IN CRENSHAW BOULEVARD'S PUBLIC RIGHT-OF-WAY, BETWEEN I-10 FWY AND 79TH STREET.
Case Number:	CPC-2013-3169
Required Action(s):	Data Not Available
Project Descriptions(s):	THE PROPOSED PROJECT CONSISTS OF: (1) A TECHNICAL MODIFICATION TO SECTIONS 12.03, 12.04, 12.21, 12.22, 12.24, 13.11, 14.5, 16.05 AND 16.11 OF THE LOS ANGELES MUNICIPAL CODE (LAMC) TO REMOVE OR AMEND REFERENCES TO THE FORMER COMMUNITY REDEVELOPMENT AGENCY (CRA); (2) TECHNICAL CORRECTIONS TO CLARIFY EXISTING REGULATIONS IN THE LAMC THAT ARE IMPACTED BY THE TRANSFER OF LAND USE AUTHORITY; AND (3) A RESOLUTION REQUESTING THAT ALL LAND USE RELATED PLANS AND FUNCTIONS OF THE CRA/LA BE TRANSFERRED TO THE DEPARTMENT OF CITY PLANNING
Case Number:	CPC-2010-2278-GPA
Required Action(s):	GPA-GENERAL PLAN AMENDMENT
Project Descriptions(s):	GENERAL PLAN AMENDMENT FOR EXISTING FAST FOOD INTERIM CONTROL ORDINANCE (ICO) TO CREATE A GENERAL PLANT FOOTNOTE FOR THE PROHIBITION OF CERTAIN PROJECTS.
Case Number:	CPC-2007-3827-ICO
Required Action(s):	ICO-INTERIM CONTROL ORDINANCE
Project Descriptions(s):	ESTABLISHMENT OF AN ICO TO TEMPORARILY PROHIBIT THE ISSUANCE OF ALL PERMITS RELATED TO THE ESTABLISHMENT OF NEW FAST-FOOD RESTAURANTS LOCATED IN WHOLE OR IN PART WITHIN THE PROPOSED ICO BOUNDARY.
Case Number:	CPC-2006-5567-CPU
Required Action(s):	CPU-COMMUNITY PLAN UPDATE
Project Descriptions(s):	<p>1. PURSUANT TO PROCEDURES SET FORTH IN SECTION 11.5.6 OF THE MUNICIPAL CODE AND CITY CHARTER SECTIONS 555 AND 558, AMEND THE WEST ADAMS-BALDWIN HILLS-LEIMERT COMMUNITY PLAN AS PART OF THE GENERAL PLAN OF THE CITY OF LOS ANGELES, AS MODIFIED IN THE ATTACHED WEST ADAMS-BALDWIN HILLS-LEIMERT NEW COMMUNITY PLAN RESOLUTION, THE WEST ADAMS-BALDWIN HILLS-LEIMERT NEW COMMUNITY PLAN TEXT AND CHANGE MAPS (EXHIBITS A, B, C, M, O) AND ADDITIONAL PLAN MAP SYMBOL, FOOTNOTE, CORRESPONDING ZONE AND LAND USE NOMENCLATURE CHANGES (EXHIBIT K).</p> <p>2. PURSUANT TO SECTIONS 11.5.7.G., 16.50.D., 12.32. AND 12.04 OF THE MUNICIPAL CODE AND CITY CHARTER SECTION 558, AMEND THE CRENSHAW CORRIDOR SPECIFIC PLAN, AS SHOWN IN THE PROPOSED CRENSHAW CORRIDOR SPECIFIC PLAN AMENDMENTS (EXHIBIT G).</p> <p>3. PURSUANT TO SECTION 13.14.C., 12.32, AND 12.04 OF THE MUNICIPAL CODE AND CITY CHARTER SECTION 558, ADOPT THE WEST ADAMS-BALDWIN HILLS-LEIMERT COMMUNITY PLAN IMPLEMENTATION OVERLAY (CPIO) DISTRICT, AS SHOWN IN THE PROPOSED CPIO SUBDISTRICT ORDINANCES (EXHIBIT F).</p> <p>4. PURSUANT TO SECTION 12.32 OF THE MUNICIPAL CODE, ADOPT REZONING ACTIONS TO EFFECT CHANGES OF ZONE AS IDENTIFIED ON THE LAND USE CHANGE MAP (EXHIBIT H), LAND USE CHANGE MATRIX (EXHIBIT I) AND PROPOSED ZONING MAP (EXHIBIT Q).</p> <p>5. PURSUANT TO PROCEDURES SET FORTH IN SECTION 11.5.6 OF THE MUNICIPAL CODE AND CITY CHARTER SECTIONS 555 AND 558, AMEND THE HIGHWAYS AND FREEWAYS MAP OF THE TRANSPORTATION ELEMENT OF THE GENERAL PLAN TO RECLASSIFY SELECTED STREETS WITHIN THE WEST ADAMS-BALDWIN HILLS-LEIMERT NEW COMMUNITY PLAN AS SHOWN ON THE STREET REDESIGNATION MATRIX (EXHIBIT J).</p> <p>6. PURSUANT TO PROCEDURES SET FORTH IN SECTION 11.5.6 OF THE MUNICIPAL CODE AND CITY CHARTER SECTIONS 555 AND 558, AMEND THE LONG RANGE LAND USE DIAGRAM OF THE CITYWIDE GENERAL PLAN FRAMEWORK ELEMENT TO REFLECT CHANGES AND MODIFICATIONS TO THE GEOGRAPHY OF NEIGHBORHOOD DISTRICTS, COMMUNITY CENTERS, REGIONAL CENTERS, AND MIXED USE BOULEVARDS AS SHOWN ON THE PROPOSED LON</p>
Case Number:	CPC-1990-346-CA
Required Action(s):	CA-CODE AMENDMENT
Project Descriptions(s):	AMENDMENT TO THE L.A.M.C. TO - DRAFT AN ORDINANCE TO PROHIBIT THE GRANTING OF A CONDITIONAL USE PERMIT FOR THE OFF-SITE SALE OF ALCOHOLIC BEVERAGES (LOURDES GREEN/KAREN HOO)

This report is subject to the terms and conditions as set forth on the website. For more details, please refer to the terms and conditions at [zimas.lacity.org](http://zimas.lacity.org)  
(\*) - APN Area is provided "as is" from the Los Angeles County's Public Works, Flood Control, Benefit Assessment.

Case Number:	CPC-1983-506
Required Action(s):	Data Not Available
Project Descriptions(s):	SPECIFIC PLN ORD FOR INTERIM CONDITIONAL USE APPRVL FOR ESTABLISHMENTS FOR THE SALE OF ALCOHOL WHICH ARE GENERALLY LOCATED INTHE SOUTH CENTRAL AREA OF THE CITY
Case Number:	ENV-2019-4121-ND
Required Action(s):	ND-NEGATIVE DECLARATION
Project Descriptions(s):	RESOLUTION TO TRANSFER THE LAND USE AUTHORITY FROM THE COMMUNITY REDEVELOPMENT AGENCY OF THE CITY OF LOS ANGELES, DESIGNATED LOCAL AUTHORITY (CRA/LA-DLA) TO THE CITY OF LOS ANGELES AND CODE AMENDMENT TO ESTABLISH PROCEDURES FOR THE IMPLEMENTATION OF UNEXPIRED REDEVELOPMENT PLANS AND UPDATE OTHER RELEVANT CODE PROVISIONS IN THE LOS ANGELES MUNICIPAL CODE TO FACILITATE THE TRANSFER OF LAND USE AUTHORITY FROM THE CRA/LA-DLA TO THE CITY OF LOS ANGELES.
Case Number:	ENV-2018-6006-CE
Required Action(s):	CE-CATEGORICAL EXEMPTION
Project Descriptions(s):	RESOLUTION TO TRANSFER THE LAND USE AUTHORITY FROM THE COMMUNITY REDEVELOPMENT AGENCY OF THE CITY OF LOS ANGELES, DESIGNATED LOCAL AUTHORITY (CRA/LA-DLA) TO THE CITY OF LOS ANGELES AND CODE AMENDMENT TO ESTABLISH PROCEDURES FOR THE IMPLEMENTATION OF UNEXPIRED REDEVELOPMENT PLANS AND UPDATE OTHER RELEVANT CODE PROVISIONS IN THE LOS ANGELES MUNICIPAL CODE TO FACILITATE THE TRANSFER OF LAND USE AUTHORITY FROM THE CRA/LA-DLA TO THE CITY OF LOS ANGELES.
Case Number:	ENV-2015-1320-CE
Required Action(s):	CE-CATEGORICAL EXEMPTION
Project Descriptions(s):	THE CRENSHAW BOULEVARD STREETSCAPE PLAN IS A GUIDELINE FOR STREETSCAPE ELEMENTS IN CRENSHAW BOULEVARD'S PUBLIC RIGHT-OF-WAY, BETWEEN I-10 FWY AND 79TH STREET.
Case Number:	ENV-2013-3170-CE
Required Action(s):	CE-CATEGORICAL EXEMPTION
Project Descriptions(s):	THE PROPOSED PROJECT CONSISTS OF: (1) A TECHNICAL MODIFICATION TO SECTIONS 12.03, 12.04, 12.21, 12.22, 12.24, 13.11, 14.5, 16.05 AND 16.11 OF THE LOS ANGELES MUNICIPAL CODE (LAMC) TO REMOVE OR AMEND REFERENCES TO THE FORMER COMMUNITY REDEVELOPMENT AGENCY (CRA); (2) TECHNICAL CORRECTIONS TO CLARIFY EXISTING REGULATIONS IN THE LAMC THAT ARE IMPACTED BY THE TRANSFER OF LAND USE AUTHORITY; AND (3) A RESOLUTION REQUESTING THAT ALL LAND USE RELATED PLANS AND FUNCTIONS OF THE CRA/LA BE TRANSFERRED TO THE DEPARTMENT OF CITY PLANNING
Case Number:	ENV-2010-2279-CE
Required Action(s):	CE-CATEGORICAL EXEMPTION
Project Descriptions(s):	GENERAL PLAN AMENDMENT FOR EXISTING FAST FOOD INTERIM CONTROL ORDINANCE (ICO) TO CREATE A GENERAL PLANT FOOTNOTE FOR THE PROHIBITION OF CERTAIN PROJECTS.
Case Number:	ENV-2008-478-EIR
Required Action(s):	EIR-ENVIRONMENTAL IMPACT REPORT
Project Descriptions(s):	ADDENDUM TO THE WEST ADAMS CPU EIR CHANGE
Case Number:	ENV-2007-3828-CE
Required Action(s):	CE-CATEGORICAL EXEMPTION
Project Descriptions(s):	ESTABLISHMENT OF AN ICO TO TEMPORARILY PROHIBIT THE ISSUANCE OF ALL PERMITS RELATED TO THE ESTABLISHMENT OF NEW FAST-FOOD RESTAURANTS LOCATED IN WHOLE OR IN PART WITHIN THE PROPOSED ICO BOUNDARY.
Case Number:	ND-83-44-HD
Required Action(s):	HD-HEIGHT DISTRICT
Project Descriptions(s):	Data Not Available

## DATA NOT AVAILABLE

ORD-187643  
 ORD-184796-SA1890  
 ORD-184794  
 ORD-180103  
 ORD-171682  
 ORD-171681  
 ORD-162128  
 AFF-55055  
 FG

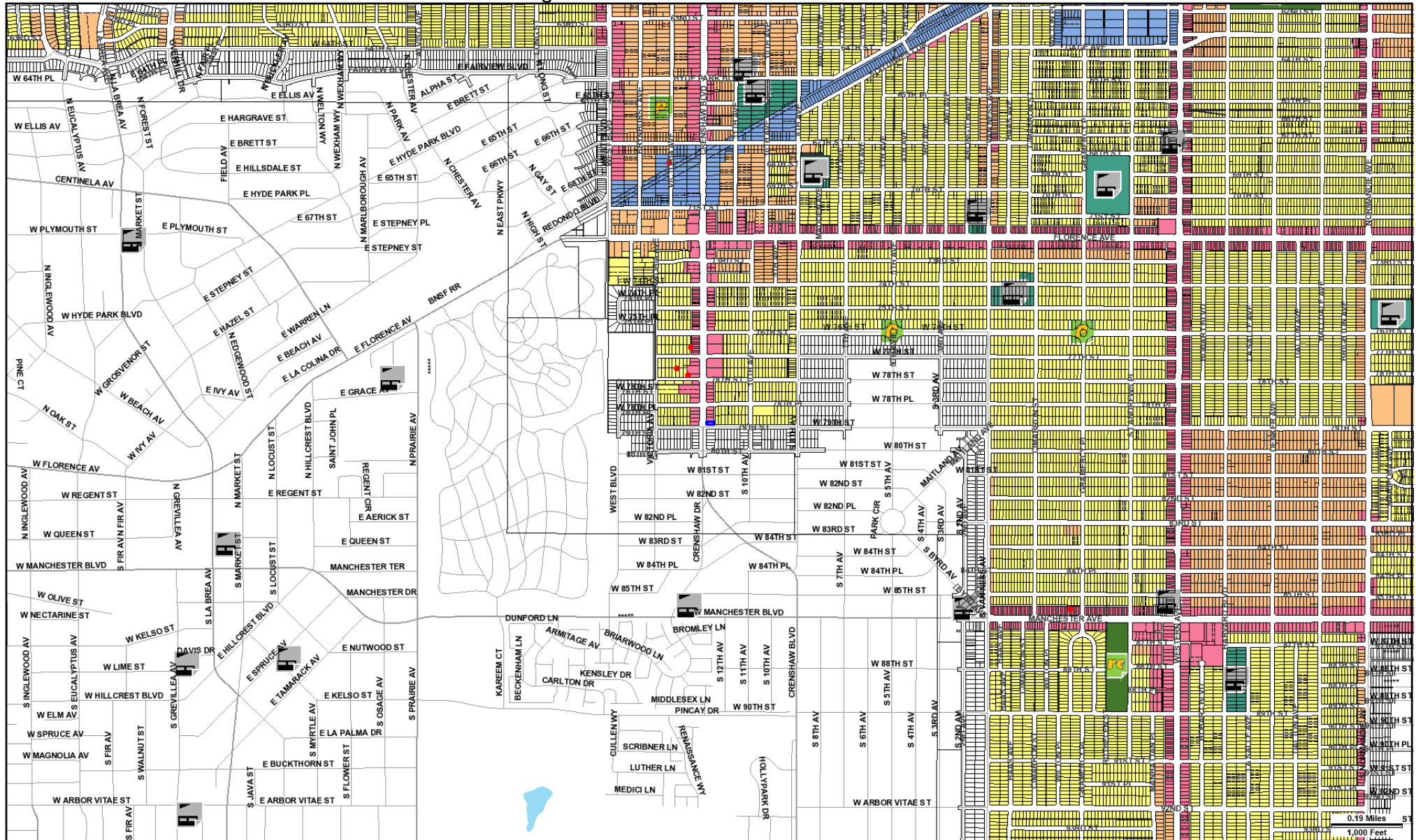

Address: 7872 S CRENSHAW BLVD

APN: 4012009025

PIN #: 099B185 420

Tract: TR 8044

Block: None

Lot: FR 41

Arb: None

Zoning: C2-1VL-CPIO

General Plan: Neighborhood Commercial







Address: 7872 S CRENSHAW BLVD

APN: 4012009025

PIN #: 099B185 420

Tract: TR 8044

Block: None

Lot: FR 41

Arb: None

Zoning: C2-1VL-CPIO

General Plan: Neighborhood Commercial

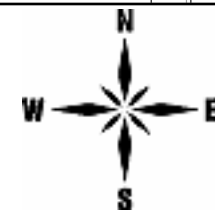

# LEGEND

## GENERALIZED ZONING

	OS, GW
	A, RA
	RE, RS, R1, RU, RZ, RW1
	R2, RD, RMP, RW2, R3, RAS, R4, R5, PVSP
	CR, C1, C1.5, C2, C4, C5, CW, WC, ADP, LASED, CEC, USC, PPSP, MU, NMU
	CM, MR, CCS, UV, UI, UC, M1, M2, LAX, M3, SL, HJ, HR, NI
	P, PB
	PF

## GENERAL PLAN LAND USE

### LAND USE

#### RESIDENTIAL

	Minimum Residential
	Very Low / Very Low I Residential
	Very Low II Residential
	Low / Low I Residential
	Low II Residential
	Low Medium / Low Medium I Residential
	Low Medium II Residential
	Medium Residential
	High Medium Residential
	High Density Residential
	Very High Medium Residential

#### COMMERCIAL

	Limited Commercial
	Limited Commercial - Mixed Medium Residential
	Highway Oriented Commercial
	Highway Oriented and Limited Commercial
	Highway Oriented Commercial - Mixed Medium Residential
	Neighborhood Office Commercial
	Community Commercial
	Community Commercial - Mixed High Residential
	Regional Center Commercial

### FRAMEWORK

#### COMMERCIAL

	Neighborhood Commercial
	General Commercial
	Community Commercial
	Regional Mixed Commercial

#### INDUSTRIAL

	Commercial Manufacturing
	Limited Manufacturing
	Light Manufacturing
	Heavy Manufacturing
	Hybrid Industrial

#### PARKING

	Parking Buffer
---	----------------

#### PORT OF LOS ANGELES

	General / Bulk Cargo - Non Hazardous (Industrial / Commercial)
	General / Bulk Cargo - Hazard
	Commercial Fishing
	Recreation and Commercial
	Intermodal Container Transfer Facility Site

#### LOS ANGELES INTERNATIONAL AIRPORT

	Airport Landside / Airport Landside Support
	Airport Airside
	LAX Airport Northside

#### OPEN SPACE / PUBLIC FACILITIES

	Open Space
	Public / Open Space
	Public / Quasi-Public Open Space
	Other Public Open Space
	Public Facilities

#### INDUSTRIAL

	Limited Industrial
	Light Industrial

CIRCULATION

STREET

- Arterial Mountain Road
- Collector Scenic Street
- Collector Street
- Collector Street (Hillside)
- Collector Street (Modified)
- Collector Street (Proposed)
- Country Road
- Divided Major Highway II
- Divided Secondary Scenic Highway
- Local Scenic Road
- Local Street
- Major Highway (Modified)
- Major Highway I
- Major Highway II
- Major Highway II (Modified)

- Major Scenic Highway
- Major Scenic Highway (Modified)
- Major Scenic Highway II
- Mountain Collector Street
- Park Road
- Parkway
- Principal Major Highway
- Private Street
- Scenic Divided Major Highway II
- Scenic Park
- Scenic Parkway
- Secondary Highway
- Secondary Highway (Modified)
- Secondary Scenic Highway
- Special Collector Street
- Super Major Highway

FREEWAYS

- Freeway
- Interchange
- On-Ramp / Off- Ramp
- Railroad
- Scenic Freeway Highway

MISC. LINES

- Airport Boundary
- Bus Line
- Coastal Zone Boundary
- Coastline Boundary
- Collector Scenic Street (Proposed)
- Commercial Areas
- Commercial Center
- Community Redevelopment Project Area
- Country Road
- DWP Power Lines
- Desirable Open Space
- Detached Single Family House
- Endangered Ridgeline
- Equestrian and/or Hiking Trail
- Hiking Trail
- Historical Preservation
- Horsekeeping Area
- Local Street
- MSA Desirable Open Space
- Major Scenic Controls
- Multi-Purpose Trail
- Natural Resource Reserve
- Park Road
- Park Road (Proposed)
- Quasi-Public
- Rapid Transit Line
- Residential Planned Development
- Scenic Highway (Obsolete)
- Secondary Scenic Controls
- Secondary Scenic Highway (Proposed)
- Site Boundary
- Southern California Edison Power
- Special Study Area
- Specific Plan Area
- Stagecoach Line
- Wildlife Corridor

## POINTS OF INTEREST

 Alternative Youth Hostel (Proposed)	 Horticultural Center	 Public Elementary School
 Animal Shelter	 Hospital	 Public Elementary School (Proposed)
 Area Library	 Hospital (Proposed)	 Public Golf Course
 Area Library (Proposed)	<b>HW</b> House of Worship	 Public Golf Course (Proposed)
 Bridge	<b>e</b> Important Ecological Area	 Public Housing
 Campground	 Important Ecological Area (Proposed)	 Public Housing (Proposed Expansion)
 Campground (Proposed)	 Interpretive Center (Proposed)	 Public Junior High School
 Cemetery	 Junior College	 Public Junior High School (Proposed)
<b>HW</b> Church	 MTA / Metrolink Station	 Public Middle School
 City Hall	 MTA Station	 Public Senior High School
 Community Center	 MTA Stop	 Public Senior High School (Proposed)
 Community Library	<b>MWD</b> MWD Headquarters	 Pumping Station
 Community Library (Proposed Expansion)	 Maintenance Yard	 Pumping Station (Proposed)
 Community Library (Proposed)	 Municipal Office Building	 Refuse Collection Center
 Community Park	<b>P</b> Municipal Parking lot	 Regional Library
 Community Park (Proposed Expansion)	 Neighborhood Park	 Regional Library (Proposed Expansion)
 Community Park (Proposed)	 Neighborhood Park (Proposed Expansion)	 Regional Library (Proposed)
 Community Transit Center	 Neighborhood Park (Proposed)	 Regional Park
 Convalescent Hospital	 Oil Collection Center	 Regional Park (Proposed)
 Correctional Facility	 Parking Enforcement	<b>RPD</b> Residential Plan Development
 Cultural / Historic Site (Proposed)	 Police Headquarters	 Scenic View Site
 Cultural / Historical Site	 Police Station	 Scenic View Site (Proposed)
 Cultural Arts Center	 Police Station (Proposed Expansion)	 School District Headquarters
<b>DMV</b> DMV Office	 Police Station (Proposed)	 School Unspecified Loc/Type (Proposed)
<b>DWP</b> DWP	 Police Training site	 Skill Center
 DWP Pumping Station	<b>PO</b> Post Office	 Social Services
 Equestrian Center	 Power Distribution Station	 Special Feature
 Fire Department Headquarters	 Power Distribution Station (Proposed)	 Special Recreation (a)
 Fire Station	 Power Receiving Station	 Special School Facility
 Fire Station (Proposed Expansion)	 Power Receiving Station (Proposed)	 Special School Facility (Proposed)
 Fire Station (Proposed)	<b>C</b> Private College	 Steam Plant
 Fire Supply & Maintenance	<b>E</b> Private Elementary School	 Surface Mining
 Fire Training Site	 Private Golf Course	 Trail & Assembly Area
 Fireboat Station	 Private Golf Course (Proposed)	 Trail & Assembly Area (Proposed)
 Health Center / Medical Facility	<b>JH</b> Private Junior High School	<b>UTL</b> Utility Yard
 Helistop	<b>PS</b> Private Pre-School	 Water Tank Reservoir
 Historic Monument	 Private Recreation & Cultural Facility	 Wildlife Migration Corridor
 Historical / Cultural Monument	<b>SH</b> Private Senior High School	 Wildlife Preserve Gate
 Horsekeeping Area	<b>SF</b> Private Special School	
 Horsekeeping Area (Proposed)	 Public Elementary (Proposed Expansion)	

SCHOOLS/PARKS WITH 500 FT. BUFFER

Existing School/Park Site      Planned School/Park Site      Inside 500 Ft. Buffer

- |                      |                                  |                          |
|----------------------|----------------------------------|--------------------------|
| Aquatic Facilities   | Other Facilities                 | Opportunity School       |
| Beaches              | Park / Recreation Centers        | Charter School           |
| Child Care Centers   | Parks                            | Elementary School        |
| Dog Parks            | Performing / Visual Arts Centers | Span School              |
| Golf Course          | Recreation Centers               | Special Education School |
| Historic Sites       | Senior Citizen Centers           | High School              |
| Horticulture/Gardens |                                  | Middle School            |
| Skate Parks          |                                  | Early Education Center   |

COASTAL ZONE

- Coastal Commission Permit Area
- Dual Permit Jurisdiction Area
- Single Permit Jurisdiction Area
- Not in Coastal Zone

TRANSIT ORIENTED COMMUNITIES (TOC)

- Tier 1
- Tier 2
- Tier 3
- Tier 4

**Note:** TOC Tier designation and map layers are for reference purposes only. Eligible projects shall demonstrate compliance with Tier eligibility standards prior to the issuance of any permits or approvals. As transit service changes, eligible TOC Incentive Areas will be updated.

WAIVER OF DEDICATION OR IMPROVEMENT

- Public Work Approval (PWA)
- Waiver of Dedication or Improvement (WDI)

OTHER SYMBOLS

- |                        |                       |                                     |
|------------------------|-----------------------|-------------------------------------|
| Lot Line               | Airport Hazard Zone   | Flood Zone                          |
| Tract Line             | Census Tract          | Hazardous Waste                     |
| Lot Cut                | Coastal Zone          | High Wind Zone                      |
| Easement               | Council District      | Hillside Grading                    |
| Zone Boundary          | LADBS District Office | Historic Preservation Overlay Zone  |
| Building Line          | Downtown Parking      | Specific Plan Area                  |
| Lot Split              | Fault Zone            | Very High Fire Hazard Severity Zone |
| Community Driveway     | Fire District No. 1   | Wells - Active                      |
| Building Outlines 2020 | Tract Map             | Wells - Inactive                    |
| Building Outlines 2017 | Parcel Map            |                                     |



# City of Los Angeles Department of City Planning

## 8/16/2024 PARCEL PROFILE REPORT

### PROPERTY ADDRESSES

7872 S CRENSHAW BLVD

### ZIP CODES

90043

### RECENT ACTIVITY

None

### CASE NUMBERS

ADM-2019-3004-CPIOC

CPC-2018-6005-CA

CPC-2015-1314-MSC

CPC-2013-3169

CPC-2010-2278-GPA

CPC-2007-3827-ICO

CPC-2006-5567-CPU

CPC-1990-346-CA

CPC-1983-506

ORD-187643

ORD-184796-SA1890

ORD-184794

ORD-180103

ORD-171682

ORD-171681

ORD-162128

ENV-2019-4121-ND

ENV-2018-6006-CE

ENV-2015-1320-CE

ENV-2013-3170-CE

ENV-2010-2279-CE

ENV-2008-478-EIR

ENV-2007-3828-CE

ND-83-44-HD

AFF-55055

FG

### Address/Legal Information

PIN Number	099B185 420
Lot/Parcel Area (Calculated)	4,277.8 (sq ft)
Thomas Brothers Grid	PAGE 703 - GRID F1
Assessor Parcel No. (APN)	4012009025
Tract	TR 8044
Map Reference	M B 177-41
Block	None
Lot	FR 41
Arb (Lot Cut Reference)	None
Map Sheet	099B185

### Jurisdictional Information

Community Plan Area	West Adams - Baldwin Hills - Leimert
Area Planning Commission	South Los Angeles
Neighborhood Council	Park Mesa Heights
Council District	CD 8 - Marqueece Harris-Dawson
Census Tract #	2352.02
LADBS District Office	Los Angeles Metro

### Permitting and Zoning Compliance Information

Administrative Review	ADM-2019-3004-CPIOC
-----------------------	---------------------

### Planning and Zoning Information

Special Notes	None
Zoning	C2-1VL-CPIO
Zoning Information (ZI)	ZI-2512 Housing Element Inventory of Sites ZI-2452 Transit Priority Area in the City of Los Angeles ZI-2517 Al Fresco Ordinance within Planning Overlay and/or the Coastal Zone (Ordinance 188073) ZI-2468 Community Plan Implementation Overlay: West Adams-Baldwin Hills-Leimert ZI-2498 Local Emergency Temporary Regulations - Time Limits and Parking Relief - LAMC 16.02.1 ZI-1231 Specific Plan: South Los Angeles Alcohol Sales ZI-2374 State Enterprise Zone: Los Angeles ZI-2488 Redevelopment Project Area: Crenshaw/Slauson
General Plan Land Use	Neighborhood Commercial
General Plan Note(s)	Yes
Hillside Area (Zoning Code)	No
Specific Plan Area	SOUTH LOS ANGELES ALCOHOL SALES
Subarea	None
Special Land Use / Zoning	None
Historic Preservation Review	No
Historic Preservation Overlay Zone	None
Other Historic Designations	None
Mills Act Contract	None
CDO: Community Design Overlay	None
CPIO: Community Plan Imp. Overlay	West Adams - Baldwin Hills - Leimert
Subarea	Commercial Corridors
CUGU: Clean Up-Green Up	None

This report is subject to the terms and conditions as set forth on the website. For more details, please refer to the terms and conditions at [zimas.lacity.org](https://zimas.lacity.org)  
(\*) - APN Area is provided "as is" from the Los Angeles County's Public Works, Flood Control, Benefit Assessment.

HCR: Hillside Construction Regulation	No
NSO: Neighborhood Stabilization Overlay	No
POD: Pedestrian Oriented Districts	None
RBP: Restaurant Beverage Program Eligible Area	None
RFA: Residential Floor Area District	None
RIO: River Implementation Overlay	No
SN: Sign District	No
AB 2334: Very Low VMT	Yes
AB 2097: Reduced Parking Areas	Yes
Streetscape	Crenshaw Boulevard
Adaptive Reuse Incentive Area	None
Affordable Housing Linkage Fee	
Residential Market Area	Medium
Non-Residential Market Area	Medium
Transit Oriented Communities (TOC)	Tier 2
ED 1 Eligibility	Review Eligibility
RPA: Redevelopment Project Area	Crenshaw/Slauson
Central City Parking	No
Downtown Parking	No
Building Line	None
500 Ft School Zone	No
500 Ft Park Zone	No
<b>Assessor Information</b>	
Assessor Parcel No. (APN)	4012009025
APN Area (Co. Public Works)*	0.210 (ac)
Use Code	2400 - Commercial - Non-Auto Service and Repair Shop, Paint Shop, or Laundry - One Story
Assessed Land Val.	\$384,625
Assessed Improvement Val.	\$371,422
Last Owner Change	12/15/2021
Last Sale Amount	\$1,350,013
Tax Rate Area	6612
Deed Ref No. (City Clerk)	643935
	629242
	410490
	116371
	116370
	0-554
	0-544
Building 1	
Year Built	1984
Building Class	C6B
Number of Units	0
Number of Bedrooms	0
Number of Bathrooms	0
Building Square Footage	3,496.0 (sq ft)
Building 2	No data for building 2
Building 3	No data for building 3
Building 4	No data for building 4
Building 5	No data for building 5
Rent Stabilization Ordinance (RSO)	No [APN: 4012009025]
<b>Additional Information</b>	
Airport Hazard	None
Coastal Zone	None

This report is subject to the terms and conditions as set forth on the website. For more details, please refer to the terms and conditions at [zimas.lacity.org](https://zimas.lacity.org)  
 (\*) - APN Area is provided "as is" from the Los Angeles County's Public Works, Flood Control, Benefit Assessment.



Farmland	Area Not Mapped
Urban Agriculture Incentive Zone	YES
Very High Fire Hazard Severity Zone	No
Fire District No. 1	No
Flood Zone	Outside Flood Zone
Watercourse	No
Hazardous Waste / Border Zone Properties	No
Methane Hazard Site	Methane Buffer Zone
High Wind Velocity Areas	No
Special Grading Area (BOE Basic Grid Map A-13372)	No
Wells	None
<b>Environmental</b>	
Santa Monica Mountains Zone	No
Biological Resource Potential	None
Mountain Lion Potential	None
<b>Seismic Hazards</b>	
Active Fault Near-Source Zone	
Nearest Fault (Distance in km)	0.150318216
Nearest Fault (Name)	Newport - Inglewood Fault Zone (Onshore)
Region	Transverse Ranges and Los Angeles Basin
Fault Type	B
Slip Rate (mm/year)	1.00000000
Slip Geometry	Right Lateral - Strike Slip
Slip Type	Poorly Constrained
Down Dip Width (km)	13.00000000
Rupture Top	0.00000000
Rupture Bottom	13.00000000
Dip Angle (degrees)	90.00000000
Maximum Magnitude	7.10000000
Alquist-Priolo Fault Zone	No
Landslide	No
Liquefaction	No
Preliminary Fault Rupture Study Area	No
Tsunami Hazard Area	No
<b>Economic Development Areas</b>	
Business Improvement District	None
Hubzone	Qualified
Jobs and Economic Development Incentive Zone (JEDI)	None
Opportunity Zone	No
Promise Zone	None
State Enterprise Zone	LOS ANGELES STATE ENTERPRISE ZONE
<b>Housing</b>	
Direct all Inquiries to	Los Angeles Housing Department
Telephone	(866) 557-7368
Website	<a href="https://housing.lacity.org">https://housing.lacity.org</a>
Rent Stabilization Ordinance (RSO)	No [APN: 4012009025]
Ellis Act Property	No
AB 1482: Tenant Protection Act	No
Housing Crisis Act Replacement Review	Yes
Housing Element Sites	
HE Replacement Required	Yes
SB 166 Units	0.03 Units, Lower
Housing Use within Prior 5 Years	No

This report is subject to the terms and conditions as set forth on the website. For more details, please refer to the terms and conditions at [zimas.lacity.org](https://zimas.lacity.org)  
 (\*) - APN Area is provided "as is" from the Los Angeles County's Public Works, Flood Control, Benefit Assessment.

## Public Safety

### Police Information

Bureau	South
Division / Station	77th Street
Reporting District	1251

### Fire Information

Bureau	South
Battalion	13
District / Fire Station	66
Red Flag Restricted Parking	No

## CASE SUMMARIES

Note: Information for case summaries is retrieved from the Planning Department's Plan Case Tracking System (PCTS) database.

Case Number:	ADM-2019-3004-CPIOC
Required Action(s):	CPIOC-COMMUNITY PLAN IMPLEMENTATION OVERLAY CLEARANCE
Project Descriptions(s):	WEST ADAMS CPIO CLEARANCE.
Case Number:	CPC-2018-6005-CA
Required Action(s):	CA-CODE AMENDMENT
Project Descriptions(s):	RESOLUTION TO TRANSFER THE LAND USE AUTHORITY FROM THE COMMUNITY REDEVELOPMENT AGENCY OF THE CITY OF LOS ANGELES, DESIGNATED LOCAL AUTHORITY (CRA/LA-DLA) TO THE CITY OF LOS ANGELES AND CODE AMENDMENT TO ESTABLISH PROCEDURES FOR THE IMPLEMENTATION OF UNEXPIRED REDEVELOPMENT PLANS AND UPDATE OTHER RELEVANT CODE PROVISIONS IN THE LOS ANGELES MUNICIPAL CODE TO FACILITATE THE TRANSFER OF LAND USE AUTHORITY FROM THE CRA/LA-DLA TO THE CITY OF LOS ANGELES.
Case Number:	CPC-2015-1314-MSC
Required Action(s):	MSC-MISCELLANEOUS (POLICIES, GUIDELINES, RESOLUTIONS, ETC.)
Project Descriptions(s):	THE CRENSHAW BOULEVARD STREETScape PLAN IS A GUIDELINE FOR STREETScape ELEMENTS IN CRENSHAW BOULEVARD'S PUBLIC RIGHT-OF-WAY, BETWEEN I-10 FWY AND 79TH STREET.
Case Number:	CPC-2013-3169
Required Action(s):	Data Not Available
Project Descriptions(s):	THE PROPOSED PROJECT CONSISTS OF: (1) A TECHNICAL MODIFICATION TO SECTIONS 12.03, 12.04, 12.21, 12.22, 12.24, 13.11, 14.5, 16.05 AND 16.11 OF THE LOS ANGELES MUNICIPAL CODE (LAMC) TO REMOVE OR AMEND REFERENCES TO THE FORMER COMMUNITY REDEVELOPMENT AGENCY (CRA); (2) TECHNICAL CORRECTIONS TO CLARIFY EXISTING REGULATIONS IN THE LAMC THAT ARE IMPACTED BY THE TRANSFER OF LAND USE AUTHORITY; AND (3) A RESOLUTION REQUESTING THAT ALL LAND USE RELATED PLANS AND FUNCTIONS OF THE CRA/LA BE TRANSFERRED TO THE DEPARTMENT OF CITY PLANNING
Case Number:	CPC-2010-2278-GPA
Required Action(s):	GPA-GENERAL PLAN AMENDMENT
Project Descriptions(s):	GENERAL PLAN AMENDMENT FOR EXISTING FAST FOOD INTERIM CONTROL ORDINANCE (ICO) TO CREATE A GENERAL PLANT FOOTNOTE FOR THE PROHIBITION OF CERTAIN PROJECTS.
Case Number:	CPC-2007-3827-ICO
Required Action(s):	ICO-INTERIM CONTROL ORDINANCE
Project Descriptions(s):	ESTABLISHMENT OF AN ICO TO TEMPORARILY PROHIBIT THE ISSUANCE OF ALL PERMITS RELATED TO THE ESTABLISHMENT OF NEW FAST-FOOD RESTAURANTS LOCATED IN WHOLE OR IN PART WITHIN THE PROPOSED ICO BOUNDARY.
Case Number:	CPC-2006-5567-CPU
Required Action(s):	CPU-COMMUNITY PLAN UPDATE
Project Descriptions(s):	<p>1. PURSUANT TO PROCEDURES SET FORTH IN SECTION 11.5.6 OF THE MUNICIPAL CODE AND CITY CHARTER SECTIONS 555 AND 558, AMEND THE WEST ADAMS-BALDWIN HILLS-LEIMERT COMMUNITY PLAN AS PART OF THE GENERAL PLAN OF THE CITY OF LOS ANGELES, AS MODIFIED IN THE ATTACHED WEST ADAMS-BALDWIN HILLS-LEIMERT NEW COMMUNITY PLAN RESOLUTION, THE WEST ADAMS-BALDWIN HILLS-LEIMERT NEW COMMUNITY PLAN TEXT AND CHANGE MAPS (EXHIBITS A, B, C, M, O) AND ADDITIONAL PLAN MAP SYMBOL, FOOTNOTE, CORRESPONDING ZONE AND LAND USE NOMENCLATURE CHANGES (EXHIBIT K).</p> <p>2. PURSUANT TO SECTIONS 11.5.7.G., 16.50.D., 12.32. AND 12.04 OF THE MUNICIPAL CODE AND CITY CHARTER SECTION 558, AMEND THE CRENSHAW CORRIDOR SPECIFIC PLAN, AS SHOWN IN THE PROPOSED CRENSHAW CORRIDOR SPECIFIC PLAN AMENDMENTS (EXHIBIT G).</p> <p>3. PURSUANT TO SECTION 13.14.C., 12.32, AND 12.04 OF THE MUNICIPAL CODE AND CITY CHARTER SECTION 558, ADOPT THE WEST ADAMS-BALDWIN HILLS-LEIMERT COMMUNITY PLAN IMPLEMENTATION OVERLAY (CPIO) DISTRICT, AS SHOWN IN THE PROPOSED CPIO SUBDISTRICT ORDINANCES (EXHIBIT F).</p> <p>4. PURSUANT TO SECTION 12.32 OF THE MUNICIPAL CODE, ADOPT REZONING ACTIONS TO EFFECT CHANGES OF ZONE AS IDENTIFIED ON THE LAND USE CHANGE MAP (EXHIBIT H), LAND USE CHANGE MATRIX (EXHIBIT I) AND PROPOSED ZONING MAP (EXHIBIT Q).</p> <p>5. PURSUANT TO PROCEDURES SET FORTH IN SECTION 11.5.6 OF THE MUNICIPAL CODE AND CITY CHARTER SECTIONS 555 AND 558, AMEND THE HIGHWAYS AND FREEWAYS MAP OF THE TRANSPORTATION ELEMENT OF THE GENERAL PLAN TO RECLASSIFY SELECTED STREETS WITHIN THE WEST ADAMS-BALDWIN HILLS-LEIMERT NEW COMMUNITY PLAN AS SHOWN ON THE STREET REDESIGNATION MATRIX (EXHIBIT J).</p> <p>6. PURSUANT TO PROCEDURES SET FORTH IN SECTION 11.5.6 OF THE MUNICIPAL CODE AND CITY CHARTER SECTIONS 555 AND 558, AMEND THE LONG RANGE LAND USE DIAGRAM OF THE CITYWIDE GENERAL PLAN FRAMEWORK ELEMENT TO REFLECT CHANGES AND MODIFICATIONS TO THE GEOGRAPHY OF NEIGHBORHOOD DISTRICTS, COMMUNITY CENTERS, REGIONAL CENTERS, AND MIXED USE BOULEVARDS AS SHOWN ON THE PROPOSED LON</p>
Case Number:	CPC-1990-346-CA
Required Action(s):	CA-CODE AMENDMENT
Project Descriptions(s):	AMENDMENT TO THE L.A.M.C. TO - DRAFT AN ORDINANCE TO PROHIBIT THE GRANTING OF A CONDITIONAL USE PERMIT FOR THE OFF-SITE SALE OF ALCOHOLIC BEVERAGES (LOURDES GREEN/KAREN HOO)

This report is subject to the terms and conditions as set forth on the website. For more details, please refer to the terms and conditions at [zimas.lacity.org](http://zimas.lacity.org)  
(\*) - APN Area is provided "as is" from the Los Angeles County's Public Works, Flood Control, Benefit Assessment.

Case Number:	CPC-1983-506
Required Action(s):	Data Not Available
Project Descriptions(s):	SPECIFIC PLN ORD FOR INTERIM CONDITIONAL USE APPRVL FOR ESTABLISHMENTS FOR THE SALE OF ALCOHOL WHICH ARE GENERALLY LOCATED IN THE SOUTH CENTRAL AREA OF THE CITY
Case Number:	ENV-2019-4121-ND
Required Action(s):	ND-NEGATIVE DECLARATION
Project Descriptions(s):	RESOLUTION TO TRANSFER THE LAND USE AUTHORITY FROM THE COMMUNITY REDEVELOPMENT AGENCY OF THE CITY OF LOS ANGELES, DESIGNATED LOCAL AUTHORITY (CRA/LA-DLA) TO THE CITY OF LOS ANGELES AND CODE AMENDMENT TO ESTABLISH PROCEDURES FOR THE IMPLEMENTATION OF UNEXPIRED REDEVELOPMENT PLANS AND UPDATE OTHER RELEVANT CODE PROVISIONS IN THE LOS ANGELES MUNICIPAL CODE TO FACILITATE THE TRANSFER OF LAND USE AUTHORITY FROM THE CRA/LA-DLA TO THE CITY OF LOS ANGELES.
Case Number:	ENV-2018-6006-CE
Required Action(s):	CE-CATEGORICAL EXEMPTION
Project Descriptions(s):	RESOLUTION TO TRANSFER THE LAND USE AUTHORITY FROM THE COMMUNITY REDEVELOPMENT AGENCY OF THE CITY OF LOS ANGELES, DESIGNATED LOCAL AUTHORITY (CRA/LA-DLA) TO THE CITY OF LOS ANGELES AND CODE AMENDMENT TO ESTABLISH PROCEDURES FOR THE IMPLEMENTATION OF UNEXPIRED REDEVELOPMENT PLANS AND UPDATE OTHER RELEVANT CODE PROVISIONS IN THE LOS ANGELES MUNICIPAL CODE TO FACILITATE THE TRANSFER OF LAND USE AUTHORITY FROM THE CRA/LA-DLA TO THE CITY OF LOS ANGELES.
Case Number:	ENV-2015-1320-CE
Required Action(s):	CE-CATEGORICAL EXEMPTION
Project Descriptions(s):	THE CRENSHAW BOULEVARD STREETSCAPE PLAN IS A GUIDELINE FOR STREETSCAPE ELEMENTS IN CRENSHAW BOULEVARD'S PUBLIC RIGHT-OF-WAY, BETWEEN I-10 FWY AND 79TH STREET.
Case Number:	ENV-2013-3170-CE
Required Action(s):	CE-CATEGORICAL EXEMPTION
Project Descriptions(s):	THE PROPOSED PROJECT CONSISTS OF: (1) A TECHNICAL MODIFICATION TO SECTIONS 12.03, 12.04, 12.21, 12.22, 12.24, 13.11, 14.5, 16.05 AND 16.11 OF THE LOS ANGELES MUNICIPAL CODE (LAMC) TO REMOVE OR AMEND REFERENCES TO THE FORMER COMMUNITY REDEVELOPMENT AGENCY (CRA); (2) TECHNICAL CORRECTIONS TO CLARIFY EXISTING REGULATIONS IN THE LAMC THAT ARE IMPACTED BY THE TRANSFER OF LAND USE AUTHORITY; AND (3) A RESOLUTION REQUESTING THAT ALL LAND USE RELATED PLANS AND FUNCTIONS OF THE CRA/LA BE TRANSFERRED TO THE DEPARTMENT OF CITY PLANNING
Case Number:	ENV-2010-2279-CE
Required Action(s):	CE-CATEGORICAL EXEMPTION
Project Descriptions(s):	GENERAL PLAN AMENDMENT FOR EXISTING FAST FOOD INTERIM CONTROL ORDINANCE (ICO) TO CREATE A GENERAL PLANT FOOTNOTE FOR THE PROHIBITION OF CERTAIN PROJECTS.
Case Number:	ENV-2008-478-EIR
Required Action(s):	EIR-ENVIRONMENTAL IMPACT REPORT
Project Descriptions(s):	ADDENDUM TO THE WEST ADAMS CPU EIR CHANGE
Case Number:	ENV-2007-3828-CE
Required Action(s):	CE-CATEGORICAL EXEMPTION
Project Descriptions(s):	ESTABLISHMENT OF AN ICO TO TEMPORARILY PROHIBIT THE ISSUANCE OF ALL PERMITS RELATED TO THE ESTABLISHMENT OF NEW FAST-FOOD RESTAURANTS LOCATED IN WHOLE OR IN PART WITHIN THE PROPOSED ICO BOUNDARY.
Case Number:	ND-83-44-HD
Required Action(s):	HD-HEIGHT DISTRICT
Project Descriptions(s):	Data Not Available

## DATA NOT AVAILABLE

ORD-187643  
 ORD-184796-SA1890  
 ORD-184794  
 ORD-180103  
 ORD-171682  
 ORD-171681  
 ORD-162128  
 AFF-55055  
 FG

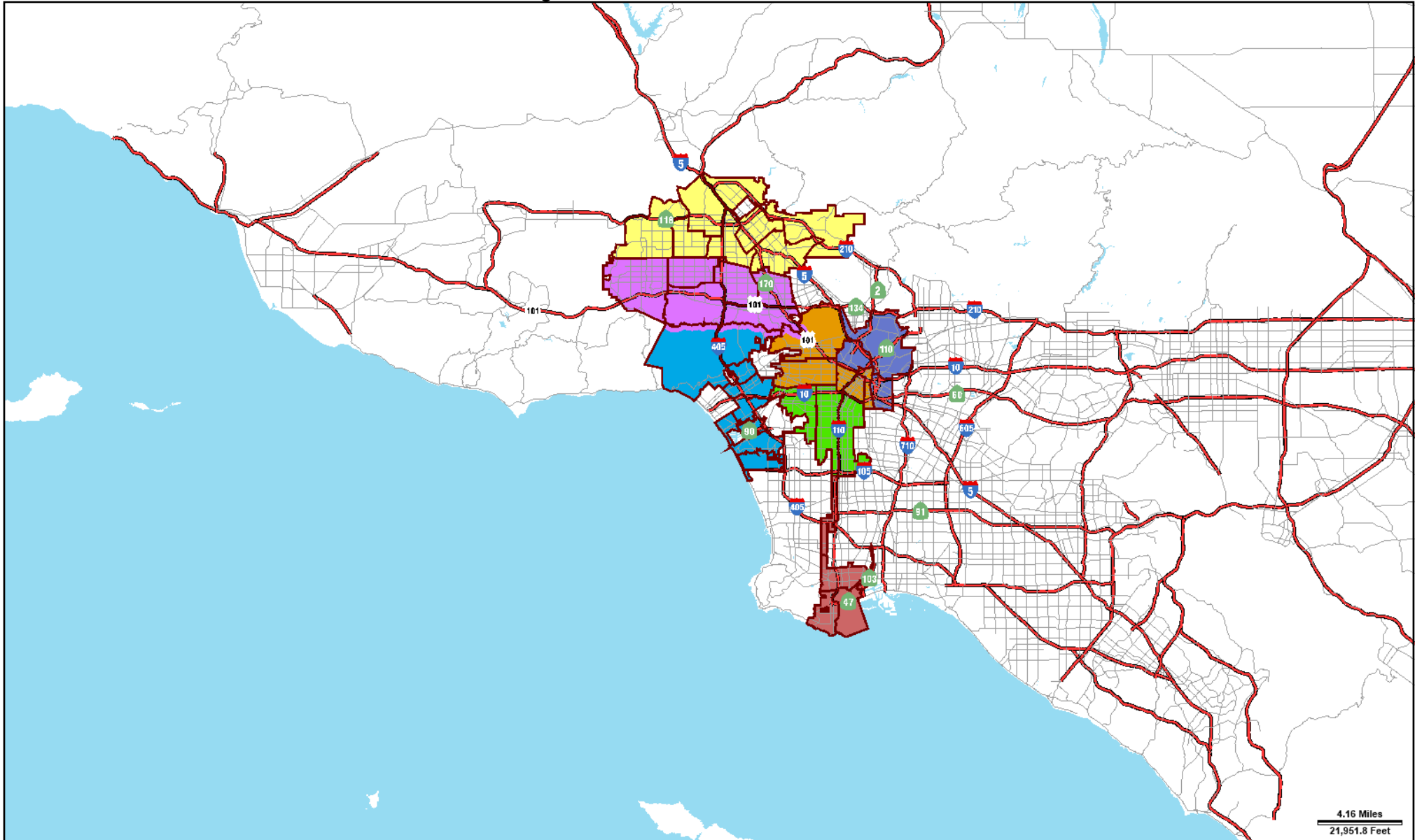

Address: 7872 S CRENSHAW BLVD

APN: 4012009025

PIN #: 099B185 420

Tract: TR 8044

Block: None

Lot: FR 41

Arb: None

Zoning: C2-1VL-CPIO

General Plan: Neighborhood Commercial



# LEGEND

## GENERALIZED ZONING

	OS, GW
	A, RA
	RE, RS, R1, RU, RZ, RW1
	R2, RD, RMP, RW2, R3, RAS, R4, R5, PVSP
	CR, C1, C1.5, C2, C4, C5, CW, WC, ADP, LASED, CEC, USC, PPSP, MU, NMU
	CM, MR, CCS, UV, UI, UC, M1, M2, LAX, M3, SL, HJ, HR, NI
	P, PB
	PF

## GENERAL PLAN LAND USE

### LAND USE

#### RESIDENTIAL

	Minimum Residential
	Very Low / Very Low I Residential
	Very Low II Residential
	Low / Low I Residential
	Low II Residential
	Low Medium / Low Medium I Residential
	Low Medium II Residential
	Medium Residential
	High Medium Residential
	High Density Residential
	Very High Medium Residential

#### COMMERCIAL

	Limited Commercial
	Limited Commercial - Mixed Medium Residential
	Highway Oriented Commercial
	Highway Oriented and Limited Commercial
	Highway Oriented Commercial - Mixed Medium Residential
	Neighborhood Office Commercial
	Community Commercial
	Community Commercial - Mixed High Residential
	Regional Center Commercial

### FRAMEWORK

#### COMMERCIAL

	Neighborhood Commercial
	General Commercial
	Community Commercial
	Regional Mixed Commercial

#### INDUSTRIAL

	Commercial Manufacturing
	Limited Manufacturing
	Light Manufacturing
	Heavy Manufacturing
	Hybrid Industrial



#### PARKING

	Parking Buffer
---	----------------

#### PORT OF LOS ANGELES

	General / Bulk Cargo - Non Hazardous (Industrial / Commercial)
	General / Bulk Cargo - Hazard
	Commercial Fishing
	Recreation and Commercial
	Intermodal Container Transfer Facility Site



#### LOS ANGELES INTERNATIONAL AIRPORT

	Airport Landside / Airport Landside Support
	Airport Airside
	LAX Airport Northside

#### OPEN SPACE / PUBLIC FACILITIES

	Open Space
	Public / Open Space
	Public / Quasi-Public Open Space
	Other Public Open Space
	Public Facilities

#### INDUSTRIAL

	Limited Industrial
	Light Industrial

CIRCULATION

STREET

- Arterial Mountain Road
- Collector Scenic Street
- Collector Street
- Collector Street (Hillside)
- Collector Street (Modified)
- Collector Street (Proposed)
- Country Road
- Divided Major Highway II
- Divided Secondary Scenic Highway
- Local Scenic Road
- Local Street
- Major Highway (Modified)
- Major Highway I
- Major Highway II
- Major Highway II (Modified)

- Major Scenic Highway
- Major Scenic Highway (Modified)
- Major Scenic Highway II
- Mountain Collector Street
- Park Road
- Parkway
- Principal Major Highway
- Private Street
- Scenic Divided Major Highway II
- Scenic Park
- Scenic Parkway
- Secondary Highway
- Secondary Highway (Modified)
- Secondary Scenic Highway
- Special Collector Street
- Super Major Highway

FREEWAYS

- Freeway
- Interchange
- On-Ramp / Off- Ramp
- Railroad
- Scenic Freeway Highway

MISC. LINES



- Airport Boundary
- Bus Line
- Coastal Zone Boundary
- Coastline Boundary
- Collector Scenic Street (Proposed)
- Commercial Areas
- Commercial Center
- Community Redevelopment Project Area
- Country Road
- DWP Power Lines
- Desirable Open Space
- Detached Single Family House
- Endangered Ridgeline
- Equestrian and/or Hiking Trail
- Hiking Trail
- Historical Preservation
- Horsekeeping Area
- Local Street
- MSA Desirable Open Space
- Major Scenic Controls
- Multi-Purpose Trail
- Natural Resource Reserve
- Park Road
- Park Road (Proposed)
- Quasi-Public
- Rapid Transit Line
- Residential Planned Development
- Scenic Highway (Obsolete)
- Secondary Scenic Controls
- Secondary Scenic Highway (Proposed)
- Site Boundary
- Southern California Edison Power
- Special Study Area
- Specific Plan Area
- Stagecoach Line
- Wildlife Corridor

























## POINTS OF INTEREST





 Alternative Youth Hostel (Proposed)	 Horticultural Center	 Public Elementary School
 Animal Shelter	 Hospital	 Public Elementary School (Proposed)
 Area Library	 Hospital (Proposed)	 Public Golf Course
 Area Library (Proposed)	<b>HW</b> House of Worship	 Public Golf Course (Proposed)
 Bridge	<b>e</b> Important Ecological Area	 Public Housing
 Campground	 Important Ecological Area (Proposed)	 Public Housing (Proposed Expansion)
 Campground (Proposed)	 Interpretive Center (Proposed)	 Public Junior High School
 Cemetery	 Junior College	 Public Junior High School (Proposed)
<b>HW</b> Church	 MTA / Metrolink Station	 Public Middle School
 City Hall	 MTA Station	 Public Senior High School
 Community Center	 MTA Stop	 Public Senior High School (Proposed)
 Community Library	<b>MWD</b> MWD Headquarters	 Pumping Station
 Community Library (Proposed Expansion)	 Maintenance Yard	 Pumping Station (Proposed)
 Community Library (Proposed)	 Municipal Office Building	 Refuse Collection Center
 Community Park	<b>P</b> Municipal Parking lot	 Regional Library
 Community Park (Proposed Expansion)	 Neighborhood Park	 Regional Library (Proposed Expansion)
 Community Park (Proposed)	 Neighborhood Park (Proposed Expansion)	 Regional Library (Proposed)
 Community Transit Center	 Neighborhood Park (Proposed)	 Regional Park
 Convalescent Hospital	 Oil Collection Center	 Regional Park (Proposed)
 Correctional Facility	 Parking Enforcement	<b>RPD</b> Residential Plan Development
 Cultural / Historic Site (Proposed)	 Police Headquarters	 Scenic View Site
 Cultural / Historical Site	 Police Station	 Scenic View Site (Proposed)
 Cultural Arts Center	 Police Station (Proposed Expansion)	 School District Headquarters
<b>DMV</b> DMV Office	 Police Station (Proposed)	 School Unspecified Loc/Type (Proposed)
<b>DWP</b> DWP	 Police Training site	 Skill Center
 DWP Pumping Station	<b>PO</b> Post Office	 Social Services
 Equestrian Center	 Power Distribution Station	 Special Feature
 Fire Department Headquarters	 Power Distribution Station (Proposed)	 Special Recreation (a)
 Fire Station	 Power Receiving Station	 Special School Facility
 Fire Station (Proposed Expansion)	 Power Receiving Station (Proposed)	 Special School Facility (Proposed)
 Fire Station (Proposed)	<b>C</b> Private College	 Steam Plant
 Fire Supply & Maintenance	<b>E</b> Private Elementary School	 Surface Mining
 Fire Training Site	 Private Golf Course	 Trail & Assembly Area
 Fireboat Station	 Private Golf Course (Proposed)	 Trail & Assembly Area (Proposed)
 Health Center / Medical Facility	<b>JH</b> Private Junior High School	<b>UTL</b> Utility Yard
 Helistop	<b>PS</b> Private Pre-School	 Water Tank Reservoir
 Historic Monument	 Private Recreation & Cultural Facility	 Wildlife Migration Corridor
 Historical / Cultural Monument	<b>SH</b> Private Senior High School	 Wildlife Preserve Gate
 Horsekeeping Area	<b>SF</b> Private Special School	
 Horsekeeping Area (Proposed)	 Public Elementary (Proposed Expansion)	

SCHOOLS/PARKS WITH 500 FT. BUFFER

-  Existing School/Park Site
-  Planned School/Park Site
-  Inside 500 Ft. Buffer

-  Aquatic Facilities
-  Other Facilities
-  Opportunity School
-  Beaches
-  Park / Recreation Centers
-  Charter School
-  Child Care Centers
-  Parks
-  Elementary School
-  Dog Parks
-  Performing / Visual Arts Centers
-  Span School
-  Golf Course
-  Recreation Centers
-  Special Education School
-  Historic Sites
-  Senior Citizen Centers
-  High School
-  Horticulture/Gardens
-  Middle School
-  Skate Parks
-  Early Education Center

COASTAL ZONE



-  Coastal Commission Permit Area
-  Dual Permit Jurisdiction Area
-  Single Permit Jurisdiction Area
-  Not in Coastal Zone

TRANSIT ORIENTED COMMUNITIES (TOC)





























-  Tier 1
-  Tier 3
-  Tier 2
-  Tier 4

**Note:** TOC Tier designation and map layers are for reference purposes only. Eligible projects shall demonstrate compliance with Tier eligibility standards prior to the issuance of any permits or approvals. As transit service changes, eligible TOC Incentive Areas will be updated.

WAIVER OF DEDICATION OR IMPROVEMENT

-  Public Work Approval (PWA)
-  Waiver of Dedication or Improvement (WDI)

OTHER SYMBOLS

-  Lot Line
-  Tract Line
-  Lot Cut
-  Easement
-  Zone Boundary
-  Building Line
-  Lot Split
-  Community Driveway
-  Building Outlines 2020
-  Building Outlines 2017
-  Airport Hazard Zone
-  Census Tract
-  Coastal Zone
-  Council District
-  LADBS District Office
-  Downtown Parking
-  Fault Zone
-  Fire District No. 1
-  Tract Map
-  Parcel Map
-  Flood Zone
-  Hazardous Waste
-  High Wind Zone
-  Hillside Grading
-  Historic Preservation Overlay Zone
-  Specific Plan Area
-  Very High Fire Hazard Severity Zone
-  Wells - Active
-  Wells - Inactive