

NOTICE OF EXEMPTION

<p>TO:</p> <p><input checked="" type="checkbox"/> Office of Planning and Research P. O. Box 3044, Room 113 Sacramento, CA 95812-3044 <i>Filed electronically</i></p>	<p>FROM: Jurupa Community Services District (Public 11201 Harrel Street Agency) Jurupa Valley, CA 91752</p>
<p style="text-align: center;">Clerk of the Board of Supervisors or</p> <p><input checked="" type="checkbox"/> County Clerk County of: Riverside 2720 Gateway Drive Riverside, CA 92507</p>	
<p>1. Project Title:</p>	<p>JCSD FY 23/24 Annual Waterline and Sewer Replacement Project (44th Street Area) JSCD Project No. C245118</p>
<p>2. Project Applicant:</p>	<p>Jurupa Community Services District</p>
<p>3. Project Location – Identify street address and cross streets or attach a map showing project site (preferably a USGS 15' or 7 1/2' topographical map identified by quadrangle name):</p>	<p>The project is within the Jurupa Community Services District, in the City of Jurupa Valley, County of Riverside and consists of the replacement of several sewer and water pipelines located in 44th Street, 45th Street, Agate Street, Clearview Place, Galena Street, Tammy Lane, Tourmaline Court, and Pedley Road. Refer to attached Figure 1 –Vicinity Map, Figure 2 – Water Pipeline Replacement, and Figure 3 – Sewer Pipeline Replacement.</p> <p>The project site is located within Section 11, Township 2, and Range 6 west, San Bernardino Base and Meridian.</p>
<p>4. (a) Project Location – City:</p>	<p>Jurupa Valley</p>
<p>(b) Project Location – County:</p>	<p>Riverside</p>
<p>5. Description of nature, purpose, and beneficiaries of Project:</p> <div style="border: 1px solid black; padding: 5px; margin-top: 10px;"><p style="text-align: center;">FILED / POSTED</p><p>County of Riverside Peter Aldana Assessor-County Clerk-Recorder</p><p>E-202401034 09/23/2024 10:17 AM Fee: \$ 50.00 Page 1 of 11</p><div style="display: flex; justify-content: space-between; margin-top: 5px;">Removed:By:Deputy</div></div>	<p>The purpose of this project is to replace approximately 11,550 linear feet (LF) of aged pipelines within the City of Jurupa Valley, California.</p> <p>The pipeline replacement project entails the following improvements:</p> <ol style="list-style-type: none">1. 44th Street: Abandon approximately 1,330 LF of existing 6-inch diameter concrete mortar lined wrapped (CML/W) water pipeline in place and replace it with approximately 1,330 LF of 8-inch diameter PVC water pipeline. Remove approximately 550 LF of 8-inch diameter verified clay pipe (VCP) sewer pipeline and replace it with 8-inch diameter PVC pipeline at the same elevation.2. 45th Street: Abandon approximately 1,555 LF of

	<p>existing 8-inch diameter CML/W water pipeline in place and replace it with 1,555 LF of 8-inch diameter PVC water pipeline.</p> <ol style="list-style-type: none"> 3. Agate Street: Abandon approximately 2,710 LF of existing 8-inch diameter CML/W water pipeline in place and replace it with 2,710 LF of 12-inch diameter PVC water pipeline. Remove approximately 845 LF of 8-inch diameter VCP sewer pipeline and replace it with 8-inch diameter PVC sewer pipeline at the same elevation. 4. Clearview Place: Abandon approximately 750 LF of existing 6-inch diameter asbestos concrete pipe (ACP) water line and replace with 750 LF of 8-inch diameter PVC water pipeline. 5. Galena Street: Abandon approximately 1,385 LF of existing 10-inch diameter CML/W water pipeline in place and replace with 1,385 LF of 12-inch diameter PVC water pipeline. Remove approximately 665 feet of 8-inch diameter VCP sewer pipeline and replace it with 665 LF of 8-inch diameter PVC sewer pipeline at the same elevation. 6. Tammy Lane: Abandon approximately 420 LF of existing 2-inch diameter steel water pipeline and replace it with approximately 420 LF of 8-inch diameter PVC water pipeline in a future easement. Remove approximately 405 LF of existing 6-inch diameter VCP sewer pipeline and replace it with 405 LF of 8-inch diameter PVC sewer pipeline at the same elevation. 7. Tourmaline Court: Abandon approximately 930 feet of existing 6-inch diameter water line and replace with approximately 930 feet of 8-inch diameter water line. 8. Pedley Road: Abandon existing 6-inch diameter CML/W water pipeline and move services to adjacent existing 12-inch diameter water pipeline, install 12-inch water connection to existing system. <p>The project consists of trenching, backfill and compaction work to facilitate the replacement of existing sewer and water pipelines and appurtenant structures and connections to the existing sewer system. Restoration of surfaces to their original condition will be performed as well as protection and support of existing above and below grade facilities and utilities.</p> <p>Beneficiaries of the project are Jurupa Community Service District costumers, which include residential and commercial uses.</p>
6. Name of Public Agency approving project:	Jurupa Community Services District

7. Name of Person or Agency undertaking the project, including any person undertaking an activity that receives financial assistance from the Public Agency as part of the activity or the person receiving a lease, permit, license, certificate, or other entitlement of use from the Public Agency as part of the activity:	Jurupa Community Services District
8. Exempt status: (check one)	
(a) Ministerial project.	
(b) Not a project.	
(c) Emergency Project.	
(d) <input checked="" type="checkbox"/> Categorical Exemption. State type and section number:	Class 2 Exemption – Replacement or reconstruction (§15302(c))
(e) Declared Emergency.	
(f) <input type="checkbox"/> Statutory Exemption. State Code section number:	
(g) Other. Explanation:	
9. Reason why project was exempt:	<p>The proposed project is part of JCSD's annual replacement program and will replace existing aged pipelines by replacing approximately 9,085 LF feet of 2-inch, 6-inch, 8-inch, or 12-inch diameter CML/W, ACP, and steel water pipelines with 8-inch and 12-inch diameter PVC water pipelines and approximately 2,465 linear feet of 6-inch and 8-inch diameter VCP sewer lines with 6-inch and 8-inch diameter PVC sewer pipelines in the same locations.</p> <p>The Class 2 Categorical Exemption is for the replacement or reconstruction of existing structures and facilities where the new structure will be located on the same site as the structure replaced and will have substantially the same purpose and capacity as the structure replaced, including but not limited to replacement or reconstruction of existing utility systems and/or facilities involving negligible or no expansion of capacity. (CEQA Guidelines §15302(c)) Although certain water pipelines will be replaced with larger diameter pipelines, these replacements are to replace aged facilities to conform to District standards and would not result in an increase in capacity.</p>
10. Lead Agency Contact Person:	Eddie Rhee, Engineering Manager
Telephone:	(951) 685-7434
11. If filed by applicant: Attach Preliminary Exemption Assessment (Form "A") before filing. ↑ Yes <input checked="" type="checkbox"/> ↑ No <input type="checkbox"/>	
12. Has a Notice of Exemption been filed by the public agency approving the project? ↑ Yes <input checked="" type="checkbox"/> ↑ No <input type="checkbox"/>	

13. Was a public hearing held by the lead agency to consider the exemption? Yes ☐ No ☒

If yes, the date of the public hearing was: _____

Signature: Eddie Rhee
Eddie Rhee

Date: 9/20/2024

Title: Engineering Manager

☒ Signed by Lead Agency

☐ Signed by Applicant

Date Received for Filing: _____

(Clerk Stamp Here)

Authority cited: Sections 21083 and 21100, Public Resources Code. Reference:
Sections 21108, 21152, and 21152.1, Public Resources Code

FIGURE 1

Vicinity Map

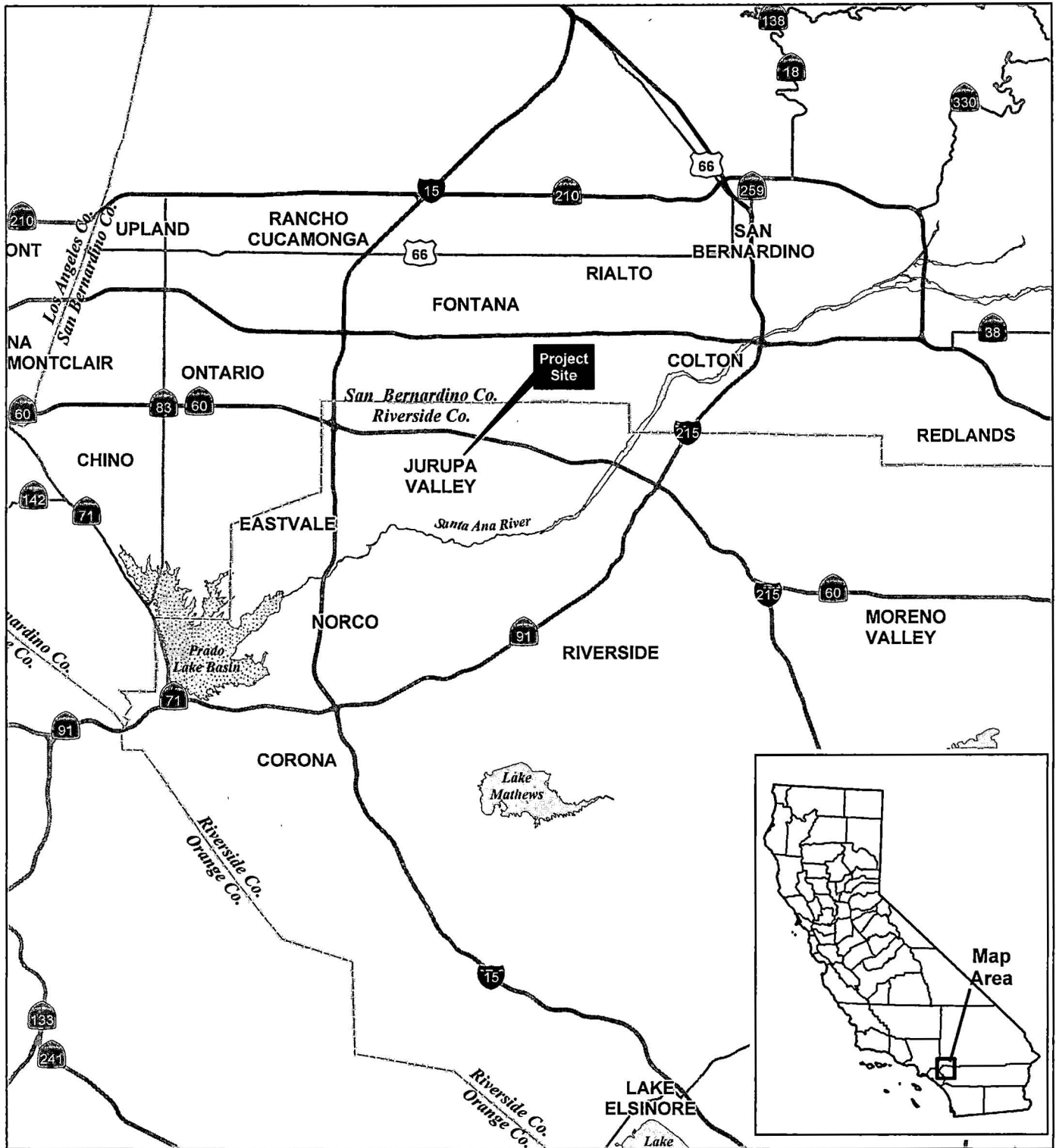

Y:\proj\p01\webb\Jan\WC4\02\23\23-0182\GIS\ES_ProjectLocation.aprx Map created 19 Sep 2024



0 12,500 25,000
ft

FIGURE 2

Water Pipeline Replacement

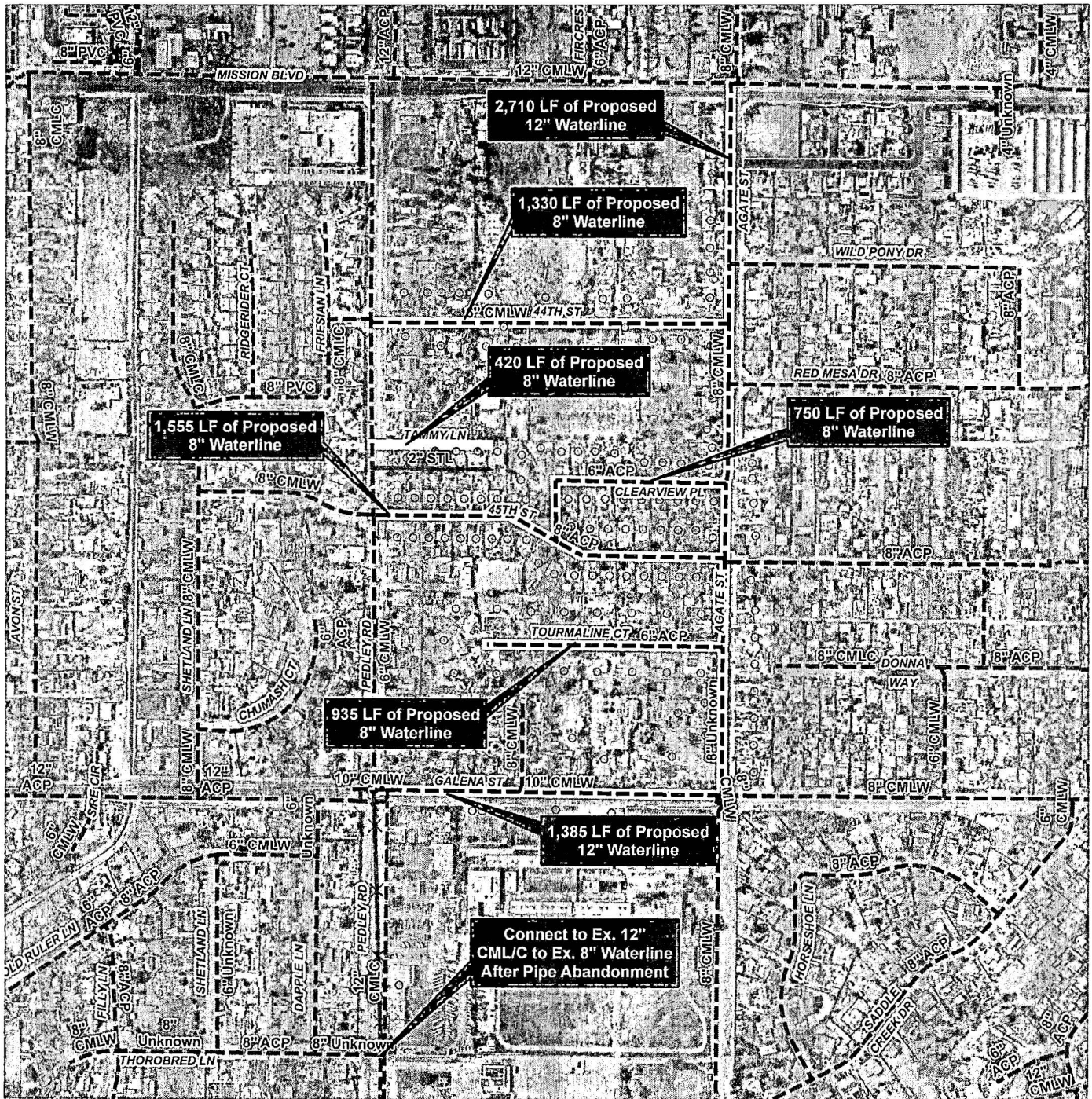

\\brkpan01\webb\lan\WO412023\23-0192\GIS\ES_ProjectLocation.aprx Map created 19 Sep 2024

LEGEND

- Existing Waterline
- Proposed Waterline
- ✕ Abandoned Waterline
- ⊙ Impacted Meters



0 287.5 575 Feet

Sources: JCSD GIS, 2019; NearMap Imagery, 2023.



PRELIMINARY EXEMPTION ASSESSMENT

(Certificate of Determination
When Attached to Notice of Exemption)

1. Name or description of project:	JCSD FY 23/24 Annual Waterline and Sewer Replacement Project (44th Street Area) JCSD Project No. C245118
2. Project Location – Identify street address and cross streets or attach a map showing project site (preferably a USGS 15' or 7 1/2' topographical map identified by quadrangle name):	The project site is located within the Jurupa Community Services District, in the City of Jurupa Valley, County of Riverside and consists of the replacement of several water and sewer pipelines located in, 44 TH Street, 45 th Street, Agate Street, Clearview Place, Galena Street, Tammy Lane, Tourmaline Court, and Pedley Road Refer to attached Figure 1 –Vicinity Map, Figure 2 – Water Pipeline Replacement, and Figure 3 – Sewer Pipeline Replacement. The project site is located within Section 11, Township 2 South, and Range 6 West, San Bernardino Base and Meridian.
3. Entity or person undertaking project:	Jurupa Community Services District 11201 Harrel Street, Jurupa Valley, CA 91752
4. Staff Determination: The Lead Agency's Staff, having undertaken and completed a preliminary review of this project in accordance with the Lead Agency's "Local Guidelines for Implementing the California Environmental Quality Act (CEQA)" has concluded that this project does not require further environmental assessment because:	
a. <input type="checkbox"/>	The proposed action does not constitute a project under CEQA.
b. <input type="checkbox"/>	The project is a Ministerial Project.
c. <input type="checkbox"/>	The project is an Emergency Project.
d. <input type="checkbox"/>	The project constitutes a feasibility or planning study.
e. <input checked="" type="checkbox"/>	The project is categorically exempt.
	Applicable Exemption Class: Class 2 (§15302(c))
f. <input type="checkbox"/>	The project is statutorily exempt.
	Applicable Exemption:
g. <input type="checkbox"/>	The project is otherwise exempt on the following basis:
h. <input type="checkbox"/>	The project involves another public agency which constitutes the Lead Agency.
	Name of Lead Agency:

Date: 9/20/2024

Staff:

Eddie Rhee

Eddie Rhee, Engineering Manager
Jurupa Community Services District

FIGURE 1

Vicinity Map

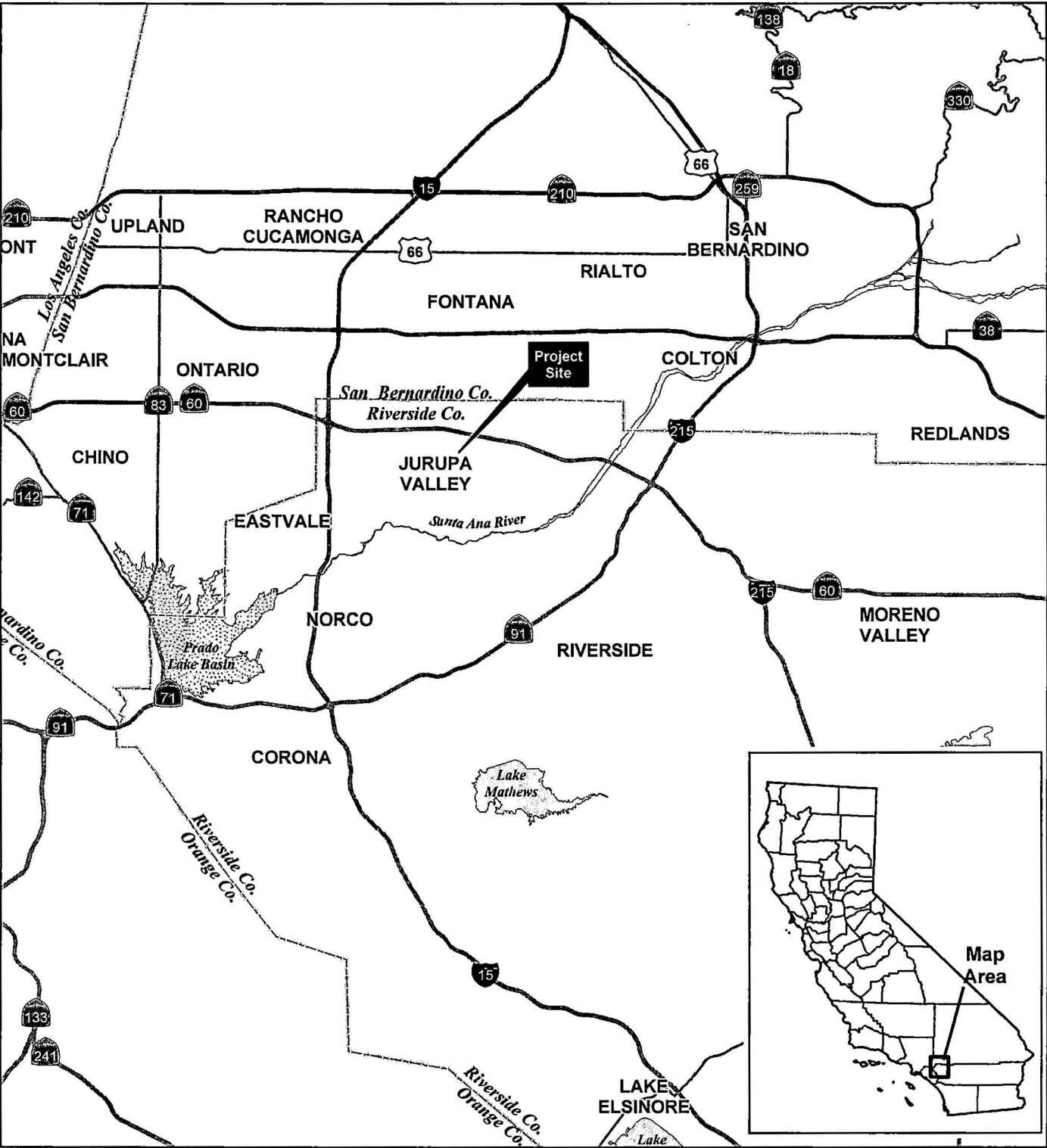

Verikpan01.webb,JanWO4Q2023Q23-0192K315ES_ProjectLocation.aprx Map created 19 Sep 2024



ALBERT A.
WEBB
ASSOCIATES

0 12,500 25,000
Ft

Sources: Riverside Co. 2023

FIGURE 2

Water Pipeline Replacement

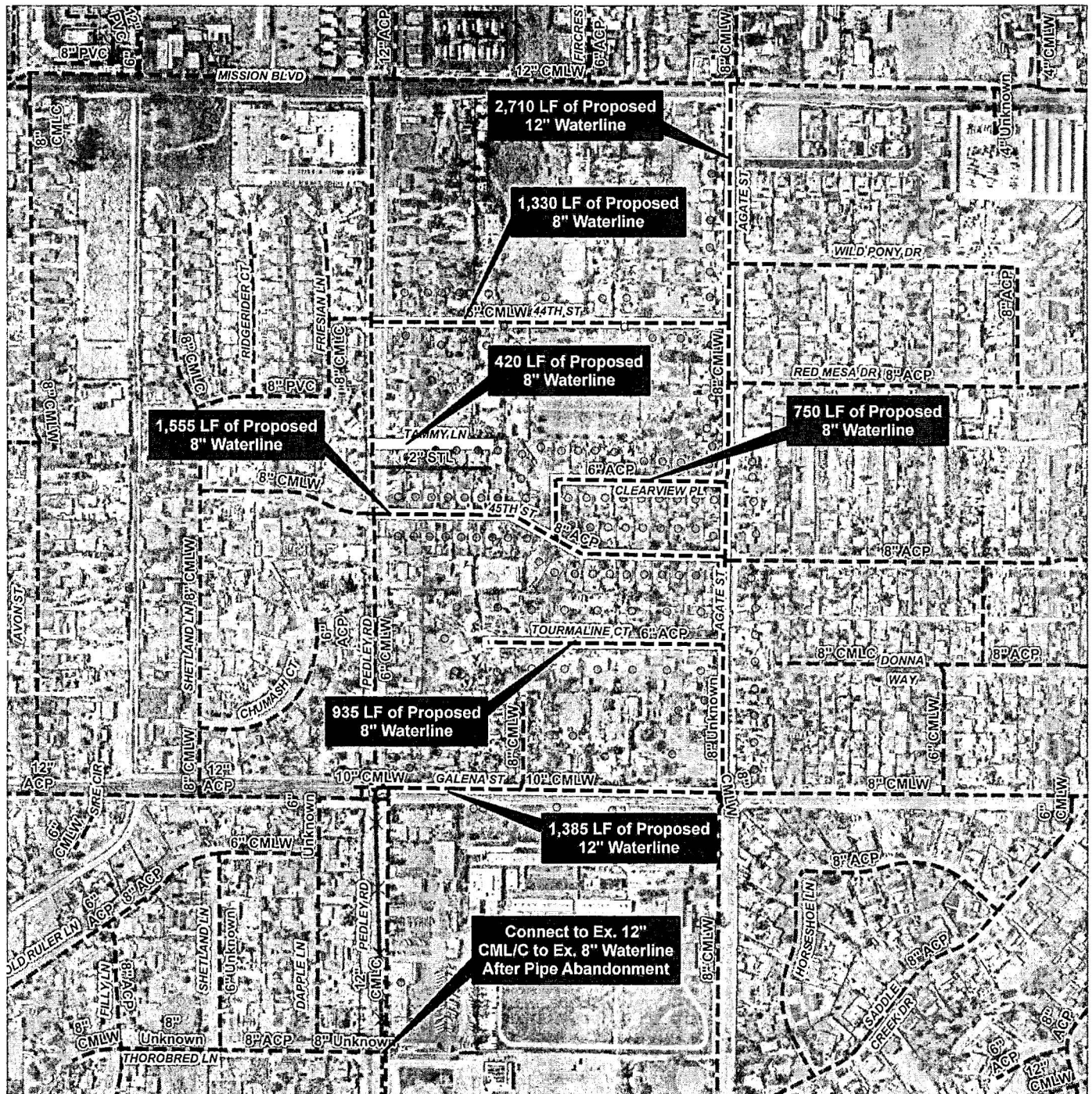

\\brkpan01.webb.lan\WO412023\123-0192\GIS\ES_ProjectLocation.aprx Map created 19 Sep 2024

LEGEND

- Existing Waterline
- Proposed Waterline
- ✕ Abandoned Waterline
- Impacted Meters



0 287.5 575 Feet

Sources: JCSD GIS, 2019; NearMap Imagery, 2023.

LEGEND

- Existing Sewerline
Proposed Sewerline
Proposed Manhole



0 285 570 Feet.

Sources: JCSD GIS, 2019; NearMap Imagery, 2023.