

Upper Salinas-Las Tablas Resource Conservation District

9481 El Camino Real, Atascadero CA 93465 | 805.460.7272 x 4 | www.us-ltrcd.org

Date: October 9th, 2023

To: California Department of Fish & Wildlife
California Regional Water Quality Control Board
San Luis Obispo County Agricultural Commissioner's Office
San Luis Obispo County Planning and Building Department
US Army Corps of Engineers
US Fish and Wildlife Service
Northern Chumash Tribe
Xolon Salinan Tribe
Salinan Tribe of Monterey and San Luis Obispo Counties
Northern Chumash Tribal Council

From: Hailey Leurck, Upper Salinas-Las Tablas Resource Conservation District

The attached Notice of Intent to Adopt a Mitigated Negative Declaration is for your Agency's review and comment. The public review period for this project runs from October 9th 2023 to November 8th, 2023.

Upper Salinas-Las Tablas Resource Conservation District

9481 El Camino Real, Atascadero CA 93465 | 805.460.7272 x 4 | www.us-ltrcd.org

Project Description

Applicant/Owners:	Estate Vineyards, LLC Wonderful Orchards 6801 E. Lerdo Highway Shafter, CA 93263 Agent: C.M. Florence, AICP Oasis Associates, Inc. cmf@oasisassoc.com
Lead Agency:	Upper Salinas- Las Tablas Resource Conservation District 9481 El Camino Real, Atascadero, CA 93465 (805) 460 7272 devin@us-ltrcd.org
Project Title:	Agricultural Road and Site Preparation for Vineyard Planting, Areas 2-4 (AR 22-01)
Project Location:	9320 Chimney Rock Road, Paso Robles, CA 93446 APN(s) 014-311-035 & 014-291-015 AND 9650, 9750, 9880, & 9889 Chimney Rock Road, Paso Robles, CA 93446 APN(s) 014-311-003, -050, -051, & -052
Land Use Category:	Agriculture
Project Description:	Grading for new agricultural roads, erosion control, drainage control, farm safety and site preparation for new vineyards on slopes over 10%. Current land use is agricultural. The Project will impact approximately 146 acres of existing cultivated land and approximately 53 acres of historically cultivated land that is actively managed. The proposed project consists of installation of approximately 2,200 feet of 30-foot-wide agricultural roads within, between and along the perimeter of existing vineyards to improve access to vineyard blocks and to accommodate safe farm practices. One area of grading measuring 30,038 SF will take place on an area characterized by more than 30% slope where the remaining will take place on areas characterized by 10-30% slope.

Upper Salinas-Las Tablas Resource Conservation District

9481 El Camino Real, Atascadero CA 93465 | 805.460.7272 x 4 | www.us-ltrcd.org

Notice of Determination

To: County Clerk, County of San Luis Obispo
 From: Hailey Leurck, US-LT RCD Restoration Technician
 Subject: **Filing of Notice of Determination in Compliance with Section 21152 of the Public Resources Code**

STATE CLEARINGHOUSE #: N/A

Applicant/Owner:	Estate Vineyards, LLC, Wonderful Orchards, 6801 E. Lerdo Highway, Shafter, CA 93263 Agent: C.M. Florence, AICP Oasis Associates, Inc., (805)541-4509
Project Title:	Agricultural Road and Site Preparation for Vineyard Planting, Areas 2-4 (AR 22-01)
Project Location:	9320 Chimney Rock Road, Paso Robles, CA 93446 APN(s) 014-311-035 & 014-291-015 AND 9650, 9750, 9880, & 9889 Chimney Rock Road, Paso Robles, CA 93446 APN(s) 014-311-003, -050, -051, & -052
Project Description:	Grading for new agricultural roads, erosion control, drainage control, farm safety and site preparation for new vineyards on slopes over 10%. Current land use is agricultural. The Project will impact approximately 146 acres of existing cultivated land and approximately 53 acres of historically cultivated land that is actively managed. The proposed project consists of installation of approximately 2,200 feet of 30-foot-wide agricultural roads within, between and along the perimeter of existing vineyards to improve access to vineyard blocks and to accommodate safe farm practices. One area of grading measuring 30,038 SF will take place on an area characterized by more than 30% slope where the remaining will take place on areas characterized by 10-30% slope.

This is to certify the Upper Salinas-Las Tablas Resource Conservation District, the lead/a responsible agency approved the above-described project on October 9th, 2023, and made the following determinations:

1. The project will will not have a significant effect on the environment.
2. An Environmental Impact Report was prepared and certified for this project pursuant to the provisions of CEQA and reflects the independent judgment of the Lead Agency.
 A Negative Declaration was prepared for this project pursuant to the provisions of CEQA and reflects the independent judgment of the Lead Agency.
 A Mitigated Negative Declaration was prepared for this project pursuant to the provisions of CEQA and reflects the independent judgment of the Lead Agency.
3. Mitigation measures were were not made a condition of the approval of the project.
4. A Statement of Overriding Considerations was was not adopted for this project.
5. Findings were were not made pursuant to the provisions of CEQA.
6. The location and custodian of the documents which comprise the record of proceedings for the Mitigated Negative Declaration are specified as follows:

Custodian: Devin Best, Executive Director
 Location: 9481 El Camino Real, Atascadero, CA 93422

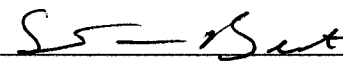
 Devin Best, Executive Director

10/9/23
 Date

Upper Salinas-Las Tablas Resource Conservation District

9481 El Camino Real, Atascadero CA 93465 | 805.460.7272 x 4 | www.us-ltrcd.org

NOTICE OF INTENT TO ADOPT PROPOSED MITIGATED NEGATIVE DECLARATION

NOTICE IS HEREBY GIVEN that the Restoration Technician of the Upper Salinas – Las Tablas Resource District has completed a review of the following project and is proposing the following environmental determination:

Owner:	Estate Vineyards, LLC, Wonderful Orchards, 6801 E. Lerdo Highway, Shafter, CA 93263 Agent: C.M. Florence (805)541-4509
Applicant:	Estate Vineyards, LLC, Wonderful Orchards, 6801 E. Lerdo Highway, Shafter, CA 93263 Agent: C.M. Florence (805)541-4509
Project Title:	Agricultural Road and Site Preparation for Vineyard Planting, Areas 2-4 (AR 22-01)
Project Location:	9320 Chimney Rock Road, Paso Robles, CA 93446 APN(s) 014-311-035 & 014-291-015 AND 9650, 9750, 9880, & 9889 Chimney Rock Road, Paso Robles, CA 93446 APN(s) 014-311-003, -050, -051, & -052
Project Description:	Grading for new agricultural roads, erosion control, drainage control, farm safety and site preparation for new vineyards on slopes over 10%. Current land use is agricultural. The Project will impact approximately 146 acres of existing cultivated land and approximately 53 acres of historically cultivated land that is actively managed. The proposed project consists of installation of approximately 2,200 feet of 30-foot-wide agricultural roads within, between and along the perimeter of existing vineyards to improve access to vineyard blocks and to accommodate safe farm practices. One area of grading measuring 30,038 SF will take place on an area characterized by more than 30% slope where the remaining will take place on areas characterized by 10-30% slope.

Environmental Review Dates:	Begins: August 2023 Ends: October 2023
Proposed Environmental Determination:	Based on the Initial Study prepared for the project, a Mitigated Negative Declaration is proposed. The complete document including the initial study is available for public review at the US-LTRCD office, 9481 El Camino Real, Atascadero, CA, between the hours of 8:30 am to 4:00 pm Monday through Friday.

Any interested person may review the proposed Mitigated Negative Declaration and project files. Questions should be directed to Devin Best, Executive Director, at 805-460-7272 X 4

Devin Best, Executive Director

10/9/23
Date

Upper Salinas-Las Tablas Resource Conservation District

9481 El Camino Real, Atascadero CA 93465 | 805.460.7272 x 4 | www.us-ltrcd.org

Mitigated Negative Declaration
#2023-01

Applicant/Owners:	Estate Vineyards, LLC
Project Title:	Agricultural Road and Site Preparation for Vineyard Planting, Areas 2-4 (AR 22-01)
Project Location:	9320 Chimney Rock Road, Paso Robles, CA 93446 APN(s) 014-311-035 & 014-291-015 AND 9650, 9750, 9880, & 9889 Chimney Rock Road, Paso Robles, CA 93446 APN(s) 014-311-003, -050, -051, & -052
Project Description:	Grading for new agricultural roads, erosion control, drainage control, farm safety and site preparation for new vineyards on slopes over 10%. Current land use is agricultural. The Project will impact approximately 146 acres of existing cultivated land and approximately 53 acres of historically cultivated land that is actively managed. The proposed project consists of installation of approximately 2,200 feet of 30-foot-wide agricultural roads within, between and along the perimeter of existing vineyards to improve access to vineyard blocks and to accommodate safe farm practices. One area of grading measuring 30,038 SF will take place on an area characterized by more than 30% slope where the remaining will take place on areas characterized by 10-30% slope.

Findings:

1. The project does not have the potential to degrade the environment.
2. The project will not achieve short-term to the disadvantage of long-term environmental goals.
3. The project does not have impacts which are individually limited, but cumulatively considerable.
4. The project will not cause substantial adverse effects on human beings either directly or indirectly.

Determination:

Based on the above findings, and the information contained in the initial study 2023-01 (made a part hereof by reference and on file in the US-LT RCD Office), it has been determined that the above project will not have an adverse impact on the environment.

Prepared By: *Hailey Leurck, Restoration Technician, Upper Salinas-Las Tablas RCD*
Date Posted: **October 9th, 2023**
Public Review Ends: **November 8th, 2023**

- Attachments:
- Location Map
 - Biological Constraints Memorandum, Terra Verde Environmental Consulting
 - Site Plan
 - Road Slopes Map
 - Initial Study 2023-01

Upper Salinas-Las Tablas Resource Conservation District

9481 El Camino Real, Atascadero CA 93465 | 805.460.7272 x 4 | www.us-ltrcd.org

ENVIRONMENTAL CHECKLIST FORM

Environmental Review 2023-01

Lead Agency Name and Address:	Upper Salinas-Las Tablas Resource Conservation District 9481 El Camino Real, Atascadero, CA 93422
Contact Person and Phone Number:	Hailey Leurck, Restoration Technician 805-460-7272 x 4
General Plan Designation:	AG (Agriculture)
Zoning:	AG (Agriculture)
Surrounding Land Uses and Setting:	North: Agriculture
	South: Agriculture
	West: Agriculture
	East: Agriculture
Other public agencies whose approval is/may be required (e.g., permits, financing approval, or participation agreement)	Central Coast Regional Water Quality Control Board

Upper Salinas-Las Tablas Resource Conservation District

9481 El Camino Real, Atascadero, CA 93422 | 805.460.7272 | www.us-ltrcd.org

Attachment I

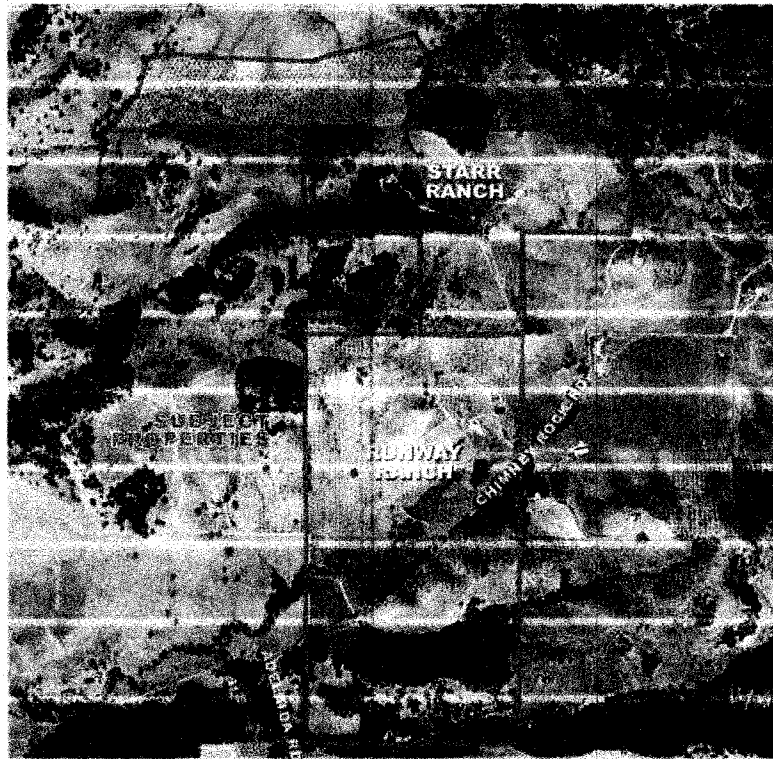
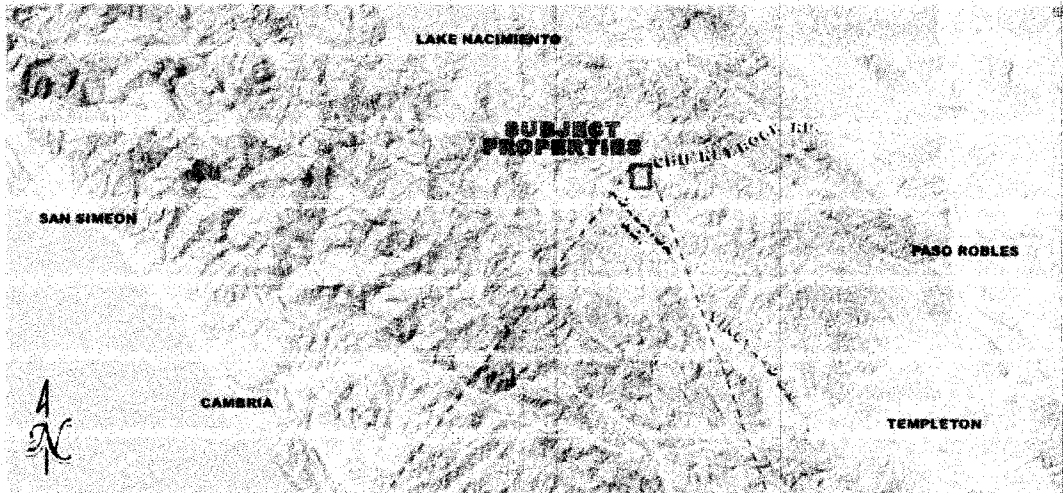

Upper Salinas-Las Tablas Resource Conservation District

9481 El Camino Real, Atascadero, CA 93422 | 805.460.7272 | www.us-ltrcd.org

Attachment 2

Biological Constraints Memorandum, Terra Verde Environmental Consulting

Upper Salinas-Las Tablas Resource Conservation District

9481 El Camino Real, Atascadero, CA 93422 | 805.460.7272 | www.us-ltrcd.org

Attachment 3
Site Plans

Upper Salinas-Las Tablas Resource Conservation District

9481 El Camino Real, Atascadero, CA 93422 | 805.460.7272 | www.us-ltrcd.org

Attachment 4
Road Slopes Map

Upper Salinas-Las Tablas Resource Conservation District

9481 El Camino Real, Atascadero, CA 93422 | 805.460.7272 | www.us-ltrcd.org

Exhibit A Mitigation Monitoring Program Project # AR-22-01 Agricultural Road and Site Preparation for Vineyard Planting, Areas 2-4 Chimney Rock Road, Paso Robles	Timing PC: Pre-Construction IP: Initial Inspection DC: During Construction FI: Final inspection FA: Final Approval	Responsibility /Monitoring A: Applicant RCD: Upper Salinas-Las Tablas RCD C: Contractor	Mitigation Measure
<p>AQ-1: Fugitive PM10 Mitigation Measures: Prior to commencement of construction/grading activities, the applicant will notify the San Luis Obispo Air Pollution Control District, by letter, the following air quality mitigation measures have been applied.</p> <ul style="list-style-type: none"> a) Reduce the amount of the disturbed area where possible; b) Use of water trucks or sprinkler systems in sufficient quantities to prevent airborne dust from leaving the site and from exceeding the APCD's limit of 20% opacity for greater than 3 minutes in any 60 minute period. Increased watering frequency would be required whenever wind speeds exceed 15 mph. Reclaimed (non-potable) water should be used whenever possible. Please note that since water use is a concern due to drought conditions, the contractor or builder shall consider the use of an APCD-approved dust suppressant where feasible to reduce the amount of water used for dust control. For a list of suppressants, see Section 4.3 of the CEQA Air Quality Handbook; c) All dirt stock pile areas should be sprayed daily and covered with tarps or other dust barriers as needed; d) Permanent dust control measures identified in the approved project revegetation and landscape plans should be implemented as soon as possible, following completion of any soil disturbing activities; e) Exposed ground areas that are planned to be reworked at dates greater than one month after initial grading should be sown with a fast germinating, non-invasive grass seed and watered until vegetation is established; f) All disturbed soil areas not subject to revegetation should be stabilized using approved chemical soil binders, jute netting, or other methods approved in advance by the APCD; g) All roadways, driveways, sidewalks, etc. to be paved should be completed as soon as possible. In addition, building pads should be laid as soon as possible after grading unless seeding or soil binders are used; h) Vehicle speed for all construction vehicles shall not exceed 15 mph on any unpaved surface at the construction site; i) All trucks hauling dirt, sand, soil, or other loose materials are to be covered or should maintain at least two feet of freeboard 	<p>PC, DC</p>	<p>A</p>	<p>AQ-1</p>

Upper Salinas-Las Tablas Resource Conservation District

9481 El Camino Real, Atascadero, CA 93422 | 805.460.7272 | www.us-ltrcd.org

Exhibit A Mitigation Monitoring Program Project # AR-22-01 Agricultural Road and Site Preparation for Vineyard Planting, Areas 2-4 Chimney Rock Road, Paso Robles	Timing PC: Pre-Construction IP: Initial Inspection DC: During Construction FI: Final inspection FA: Final Approval	Responsibility /Monitoring A: Applicant RCD: Upper Salinas-Las Tablas RCD C: Contractor	Mitigation Measure
(minimum vertical distance between top of load and top of trailer) in accordance with CVC Section 23114; j) All PM10 mitigation measures required should be shown on grading and building plans; and the contractor or builder shall designate a person or persons to monitor the fugitive dust emissions and enhance the implementation of the measures as necessary to minimize dust complaints and reduce visible emissions below the APCD's limit of 20% opacity for greater than 3 minutes in any 60 minute period. Their duties shall include holidays and weekend periods when work may not be in progress. The name and telephone number of such persons shall be provided to the APCD Compliance Division prior to construction and/or grading permit issuance.			
AQ-2: The following measures shall be implemented to reduce construction emissions from on and off-road construction equipment (nitrogen oxides, reactive organic gases, and diesel particulate matter) and area sources and shown on grading and building plans: a) Maintain all construction equipment in proper tune according to manufacturer's specifications. b) Fuel all off-road and portable diesel-powered equipment with California Air Resources Board (CARB)-certified motor vehicle diesel fuel (non-taxed version suitable for use off-road). c) Heavy-duty (50 horsepower or greater) diesel-fueled construction equipment shall meet, at a minimum, the CARB's Tier 3 certified engines, or cleaner, off-road heavy duty diesel engines; be fitted with diesel exhaust particulate filters in accordance with manufacturer recommendations; and comply with the State Off-Road Regulation. Heavy-duty equipment with Tier 4 engines shall be used to the extent locally available (within 50 miles). Where Tier 3, or cleaner, equipment is not available, incorporate diesel emission control strategies/retrofits, such that emission reductions achieved equal or exceed that of a Tier 3 engine. Installing California Verified Diesel Emission Control Strategies. Verified diesel emissions control strategies can be found at: https://ww2.arb.ca.gov/diesel/verdev/vt/cvt.htm . d) When applicable, portable equipment, 50 horsepower or greater, used during construction activities shall be registered	DC	A	AQ-2

Upper Salinas-Las Tablas Resource Conservation District

9481 El Camino Real, Atascadero, CA 93422 | 805.460.7272 | www.us-ltrcd.org

<p>Exhibit A Mitigation Monitoring Program</p> <p>Project # AR-22-01 Agricultural Road and Site Preparation for Vinyard Planting, Areas 2-4 Chimney Rock Road, Paso Robles</p>	<p>Timing</p> <p>PC: Pre-Construction IP: Initial Inspection DC: During Construction FI: Final inspection FA: Final Approval</p>	<p>Responsibility /Monitoring</p> <p>A: Applicant RCD: Upper Salinas-Las Tablas RCD C: Contractor</p>	<p>Mitigation Measure</p>
<p>with the California statewide portable equipment registration program (issued by the CARB) or be permitted by the San Luis Obispo Air Pollution Control District (SLOAPCD). Such equipment may include power screens, conveyors, internal combustion engines, crushers, portable generators, tub grinders, trammel screens, and portable plants (e.g., aggregate plant, asphalt plant, concrete plant). For more information, contact the SLOAPCD Engineering and Compliance Division at (805) 781-5912.</p> <ul style="list-style-type: none"> e) Use on-road heavy-duty trucks that meet the CARB’s 2007 or cleaner certification standard for on-road heavy- duty diesel engines and comply with the State On-Road Regulation. f) All on- and off-road diesel equipment shall not idle when not in use. Signs shall be posted in the designated queuing areas and or job sites to remind drivers and operators of the 5-minute idling limit. g) Construction equipment staging areas shall be located at the farthest reasonable distance possible from nearby sensitive land uses, or at a minimum distance of 300 feet. h) Stationary noise sources such as generators, pumps, and pavement crushers shall be located at the farthest distance possible from noise-sensitive uses, or at a minimum distance of 300 feet. i) To the extent locally available, electrified or alternatively powered construction equipment shall be used. Substitute gasoline-powered in place of diesel-powered equipment, where possible. 			
<p>Bio-1: Prior to construction activities, an environmental awareness training shall be presented to all Project personnel by a qualified biologist. The training shall include color photographs and a description of the ecology of all special-status species known or determined to have potential to occur, as well as other sensitive resources requiring avoidance near Project impact areas. The training shall also include a description of protection measures required by the Project’s discretionary permits, an overview of the federal Endangered Species Act, the California Endangered Species Act, and implications of noncompliance with these regulations, as well as an overview of the required avoidance and minimization measures. A sign-in sheet with the</p>	<p>PC</p>	<p>A</p>	<p>Bio-1</p>

“Your partners in local, productive & sustainable land management since 1951”

Initial Study

Upper Salinas-Las Tablas Resource Conservation District

9481 El Camino Real, Atascadero, CA 93422 | 805.460.7272 | www.us-ltrcd.org

Exhibit A Mitigation Monitoring Program Project # AR-22-01 Agricultural Road and Site Preparation for Vineyard Planting, Areas 2-4 Chimney Rock Road, Paso Robles	Timing PC: Pre-Construction IP: Initial Inspection DC: During Construction FI: Final inspection FA: Final Approval	Responsibility /Monitoring A: Applicant RCD: Upper Salinas-Las Tablas RCD C: Contractor	Mitigation Measure
name and signature of the qualified biologist who presented the training, and the names and signatures of the trainees will be kept and provided to the Resources Conservation District, if requested. If new project personnel join the project after the initial training period, they will receive the environmental awareness training from a designated crew member on site before beginning work. A qualified biologist will provide refresher trainings during site visits or other monitoring events.			
Bio-2: A qualified biologist shall complete a pre-construction survey for special-status small mammal species (e.g., Monterey Dusky-footed woodrat) no more than two weeks prior to the start of initial Project activities to determine if special-status small mammal species are present within proposed work areas. The survey will include mapping of all potentially active special-status small mammal burrows within the proposed work areas, access routes, and staging areas, plus a 50-foot buffer. <ol style="list-style-type: none"> 1. All potentially active special-status small mammal burrows will be mapped and flagged, and a 50-foot exclusion zone shall be established around the burrows. The exclusion zone shall encircle the burrows and have a radius of 50 feet from the burrow entrance or the outside border of a cluster of burrows (e.g. precinct). All foot and vehicle traffic, as well as all Project activities, including storage of supplies and equipment, shall remain outside of exclusion zones. Exclusion zones shall be maintained until all Project-related disturbances have been terminated, and then shall be removed. 2. If avoidance of the burrows by 50 feet is not feasible and the species using the burrow is unknown, the burrows will be monitored for 3 days and 3 nights with an infra-red, motion-triggered camera. If it is determined that no special-status species are using the burrow, no avoidance of the burrow is required. <p>If two weeks lapse between project phases (e.g., vegetation trimming and the start of grading), during which no or minimal work activity occurs, the small mammal burrow survey shall be repeated.</p>	PC	A	Bio-2
Bio-3: Prior to initiation of any site preparation/construction activities, if work is planned to occur between February 1 and September 15, a	PC, DC	A	Bio-3

"Your partners in local, productive & sustainable land management since 1951"

Initial Study

Upper Salinas-Las Tablas Resource Conservation District

9481 El Camino Real, Atascadero, CA 93422 | 805.460.7272 | www.us-ltrcd.org

Exhibit A Mitigation Monitoring Program Project # AR-22-01 Agricultural Road and Site Preparation for Vineyard Planting, Areas 2-4 Chimney Rock Road, Paso Robles	Timing PC: Pre-Construction IP: Initial Inspection DC: During Construction FI: Final inspection FA: Final Approval	Responsibility /Monitoring A: Applicant RCD: Upper Salinas-Las Tablas RCD C: Contractor	Mitigation Measure
<p>qualified biologist shall survey the area for nesting birds within 1 week prior to initial Project activity beginning, including ground disturbance and/or vegetation removal/trimming. If nesting birds are located on or near the area of disturbance, they shall be avoided until they have successfully fledged, or the nest is no longer deemed active, as detailed below.</p> <ol style="list-style-type: none"> 1. A 50-foot exclusion zone shall be established around non-listed, passerine species, and a 250-foot exclusion zone shall be established for raptor species. Each exclusion zone shall encircle the nest and have a radius of 50 feet (non-listed passerine species) or 250 feet (raptor species). All Project activities, including foot and vehicle traffic and storage of supplies and equipment, are prohibited inside exclusion zones. Exclusion zones shall be maintained until all exterior construction activities have been terminated, or it has been determined by a qualified biologist that the young have fledged or that proposed project activities would not cause adverse impacts to the nest, adults, eggs, or young. 2. If special-status avian species are identified and nesting within the work area, no work shall begin until an appropriate exclusion zone is determined in consultation with the Resource Conservation District and any relevant resource agencies. <p>The results of the survey shall be provided to the Resource Conservation District prior to commencement of initial Project activities. The results shall detail appropriate fencing or flagging of exclusion zones and include recommendations for additional monitoring requirements. A map of the Project site and nest locations shall be included with the results. The qualified biologist conducting the nesting survey shall have the authority to reduce or increase the recommended exclusion zone depending on site conditions and species (if non-listed).</p> <p>If 2 weeks lapse between different phases of Project activities (e.g., vegetation trimming, the start of grading), during which no or minimal work activity occurs, the nesting bird survey shall be repeated, and a separate survey report shall be prepared and submitted to the Resources Conservation District.</p>			

Upper Salinas-Las Tablas Resource Conservation District

9481 El Camino Real, Atascadero, CA 93422 | 805.460.7272 | www.us-ltrcd.org

<p>Exhibit A Mitigation Monitoring Program</p> <p>Project # AR-22-01 Agricultural Road and Site Preparation for Vineyard Planting, Areas 2-4 Chimney Rock Road, Paso Robles</p>	<p>Timing</p> <p>PC: Pre-Construction IP: Initial Inspection DC: During Construction FI: Final inspection FA: Final Approval</p>	<p>Responsibility /Monitoring</p> <p>A: Applicant RCD: Upper Salinas-Las Tablas RCD C: Contractor</p>	<p>Mitigation Measure</p>
<p>Bio-4: A qualified biologist shall conduct a pre-construction survey for special-status reptile and amphibia species immediately prior to initial project activities (i.e., the morning of the commencement of project activities) within 50 feet of suitable habitat. Construction monitoring shall also be conducted by a qualified biologist during all initial ground disturbing and vegetation removal activities (e.g., grading, grubbing, vegetation trimming, vegetation removal including tree removal, etc.) within suitable habitat. If any special status reptile or amphibian species are discovered during surveys or monitoring, they will be allowed to leave on their own or will be hand-captured by a qualified biologist and relocated to suitable habitat outside the area of impact. If any additional ground- or vegetation-disturbing activities occur on the project site, the above surveys and monitoring shall be repeated. A monitoring report summarizing results of the monitoring shall be submitted to the Resources Conservation District within one week of completing monitoring work for this species.</p>	<p>PC, DC</p>	<p>A</p>	<p>Bio-4</p>
<p>Bio-5: The following measures are required to minimize impacts during active construction and ongoing operations. All measures applicable during construction shall be included on the plans.</p> <ol style="list-style-type: none"> 1. The use of heavy equipment and vehicles shall be limited to the Project limits and defined staging areas/access points. The boundaries of each work area shall be clearly defined. 2. Project plans, drawings, and specifications shall show the boundaries of all work areas on site and the location of erosion and sediment controls, limit delineation, and other pertinent measures to ensure the protection of sensitive habitat areas and associated resources. 3. Staging of equipment and materials shall occur in designated areas at least 100 feet from aquatic habitat (e.g., swales, drainages, ponds, vernal pools, if identified on site). Secondary containment such as drip pans shall be used to prevent leaks and spills of potential contaminants. Refueling and maintenance of equipment shall occur only in designated areas. Sandbags and/or absorbent pads shall be available to prevent water and/or spilled fuel from leaving the site. Equipment shall be inspected by the operator daily to ensure that equipment is in good working order and no fuel or lubricant leaks are present. 	<p>DC</p>	<p>A</p>	<p>Bio-5</p>

Upper Salinas-Las Tablas Resource Conservation District

9481 El Camino Real, Atascadero, CA 93422 | 805.460.7272 | www.us-ltrcd.org

Exhibit A Mitigation Monitoring Program Project # AR-22-01 Agricultural Road and Site Preparation for Vineyard Planting, Areas 2-4 Chimney Rock Road, Paso Robles	Timing PC: Pre-Construction IP: Initial Inspection DC: During Construction FI: Final inspection FA: Final Approval	Responsibility /Monitoring A: Applicant RCD: Upper Salinas-Las Tablas RCD C: Contractor	Mitigation Measure
4. A maximum of 25 mph speed limit shall be required at the project site during project activities. Speed limit signs shall be installed on the project site prior to the start of all work. 5. All project activities shall cease at dusk and not start before dawn. 6. All food-related trash items such as wrappers, cans, bottles, and food scraps shall be disposed of in animal-proof closed containers only and regularly removed from the site. No deliberate feeding of wildlife shall be allowed.			
Bio-6: The use of herbicides, rodenticides, pesticides, and fertilizers shall be limited to those approved by the US Environmental Protection Agency and the California Department of Pesticide Regulation and shall be used in compliance with all local, state, and federal regulations so as to avoid primary or secondary poisoning of endangered species and the depletion of prey upon which such species depend.	DC	A	Bio-6
Bio-7: Prior to commencing construction activities within the proximity of jurisdictional waters, all required permits from the agencies with jurisdiction over the drainages, wetland, and ponds on site (e.g., California Department of Fish and Wildlife Lake, the Regional Water Quality Control Board) shall be obtained. Any additional measures required by these agencies shall be implemented as necessary throughout the Project and all relevant regulations complied with. As part of these permitting processes, the Project shall be designed, and measures will be implemented in a manner that avoids and minimizes impacts on aquatic resources and meets the permitting agencies' requirements.	PC	A	Bio-7
Bio-8: Construction activities within jurisdictional areas will be conducted during the dry season (June 1 through October 31) to the extent feasible.	DC	A	Bio-8
CR-1: An archaeologist will provide a pre-construction archaeological briefing to all construction crews prior to initiating ground disturbing activities. The briefing will provide guidance on archaeological and paleontological resources and appropriate procedures to follow if such finds are inadvertently exposed during the Project.	PC	A	CR-1
CR-2: In the event archaeological or paleontological resources are unearthed or discovered during construction, grading activities shall cease and San Luis Obispo County Planning and Building Department and US-LT RCD shall be notified so that the extent and location of	DC	A	CR-2

Upper Salinas-Las Tablas Resource Conservation District

9481 El Camino Real, Atascadero, CA 93422 | 805.460.7272 | www.us-ltrcd.org

Exhibit A Mitigation Monitoring Program Project # AR-22-01 Agricultural Road and Site Preparation for Vineyard Planting, Areas 2-4 Chimney Rock Road, Paso Robles	Timing PC: Pre-Construction IP: Initial Inspection DC: During Construction FI: Final inspection FA: Final Approval	Responsibility /Monitoring A: Applicant RCD: Upper Salinas-Las Tablas RCD C: Contractor	Mitigation Measure
discovered materials may be recorded by a qualified archeologist, and disposition of artifacts may be accomplished in accordance with state and federal law.			
CR-3: In accordance with the California Health and Safety Code, if human remains are discovered during ground disturbing activities, the project contractor(s) shall immediately halt potentially damaging activities in the area of the burial and notify the SLO County Coroner and a qualified professional archaeologist to determine the nature and significance of the remains. The coroner is required to examine all discoveries of human remains within 48 hours of receiving notice of a discovery on private or state lands (Health and Safety Code Section 7050[c]). Following the coroner’s findings, the archaeologist and the Most Likely Descendent (designated by the Native American Heritage Commission) shall determine the ultimate treatment and disposition of the remains and take appropriate steps to ensure that additional human interments are not disturbed. The responsibilities of SLO County and US-LT RCD to act upon notification of a discovery of Native American human remains are identified in PRC § 5097.	DC	A	CR-3

Upper Salinas-Las Tablas Resource Conservation District

9481 El Camino Real, Atascadero, CA 93422 | 805.460.7272 | www.us-ltrcd.org

Exhibit A Mitigation Monitoring Program Project # AR-22-01 Agricultural Road and Site Preparation for Vineyard Planting, Areas 2-4 Chimney Rock Road, Paso Robles	Timing PC: Pre-Construction IP: Initial Inspection DC: During Construction FI: Final inspection FA: Final Approval	Responsibility /Monitoring A: Applicant RCD: Upper Salinas-Las Tablas RCD C: Contractor	Mitigation Measure
<p>GS-1: The following measures shall be taken during project construction and prior to permit final to ensure that proper erosion control measures are implemented during all phases of the project:</p> <ol style="list-style-type: none"> 1. The owner shall monitor the weather forecast all year. Erosion and sediment control measures shall be installed and working properly from October 15th to April 15th and prior to any impending projected rainstorm of a projected rainfall of ¼ inch per hour or greater, pursuant to the approved plans. 2. Work shall be performed so that it can be completed at least 48-hours prior to any forecasted rain event. The US-LT RCD recommends that work be started and completed after the rainy season has ended. 3. Permanent erosion control measures shall be applied to denuded areas within 5 days after final grade is reached on any portion of the site. 4. All earth fills and denuded areas that are not at final grade shall be mulched, maintained or equally protected at the end of each day to ensure sediment does not leave the construction site. 5. All mulching shall provide the equivalent protection as that resulting from the application of at least 1,500 lb. of straw mulch per one acre of surface area (or as otherwise provided in the Erosion Control Plan). 6. Site inspections and appropriate maintenance of all erosion control measures shall be conducted and documented at all times during construction. 7. The owner, grading contractor, manager or engineer of record is to provide written verification to the US-LT RCD the erosion and sedimentation control devices are properly installed and are being monitored before and after each storm, unless otherwise required. 8. Additional erosion control measures shall be installed at the discretion of the engineer of work or the US-LT RCD inspector. 9. In the event of a failure and/or lack of performance by the owner and/or contractor to correct erosion control related problems, the US-LT RCD may revoke all active permits and recommend County Code Enforcement provide a written notice or stop work order in accordance with Section 22.52.140 [23.10] of the Land Use Ordinance. 	<p align="center">PC/DC/FI</p>	<p align="center">A</p>	<p align="center">GS-1</p>

Upper Salinas-Las Tablas Resource Conservation District

9481 El Camino Real, Atascadero, CA 93422 | 805.460.7272 | www.us-ltrcd.org

Exhibit A Mitigation Monitoring Program Project # AR-22-01 Agricultural Road and Site Preparation for Vineyard Planting, Areas 2-4 Chimney Rock Road, Paso Robles	Timing PC: Pre-Construction IP: Initial Inspection DC: During Construction FI: Final inspection FA: Final Approval	Responsibility /Monitoring A: Applicant RCD: Upper Salinas-Las Tablas RCD C: Contractor	Mitigation Measure
GS-2: The owner shall contact the RCD and request an inspection of the erosion and sediment control measures a minimum of 10 calendar days prior to October 15 th , or, in the event of a projected rainstorm of a projected rainfall of ¼ inch per hour or greater, the owner shall contact the RCD to arrange a site inspection of the erosion control measures a minimum of 3 working days prior to the day of projected rain.	DC	A	GS-2
GS-3: The US-LT RCD and/or its representative shall conduct a post construction inspection prior to the start of the following rainy season up to 1-year following the final of the permit to ensure that all erosion control measures are implemented and maintained per plan.	FI/FA	RCD	GS-3

ENVIRONMENTAL FACTORS POTENTIALLY AFFECTED:

The environmental factors checked below would be potentially affected by this project, involving at least one impact that is a "Potentially Significant Impact" as indicated by the checklist on the following pages.

- | | | |
|--|---|--|
| <input type="checkbox"/> Aesthetics | <input type="checkbox"/> Agriculture Resources | <input checked="" type="checkbox"/> Air Quality |
| <input checked="" type="checkbox"/> Biological Resources | <input checked="" type="checkbox"/> Cultural Resources | <input checked="" type="checkbox"/> Geology /Soils |
| <input type="checkbox"/> Hazards & Hazardous Materials | <input type="checkbox"/> Hydrology / Water Quality | <input type="checkbox"/> Land Use / Planning |
| <input type="checkbox"/> Mineral Resources | <input type="checkbox"/> Noise | <input type="checkbox"/> Population / Housing |
| <input type="checkbox"/> Public Services | <input type="checkbox"/> Recreation | <input type="checkbox"/> Transportation/Traffic |
| <input type="checkbox"/> Utilities / Service Systems | <input type="checkbox"/> Mandatory Findings of Significance | |

On the basis of this initial evaluation:

- I find that the proposed project COULD NOT have a significant effect on the environment, and a NEGATIVE DECLARATION will be prepared.
- I find that although the proposed project could have a significant effect on the environment, there will not be a significant effect in this case because the mitigation measures described on an attached sheet have been added to the

Upper Salinas-Las Tablas Resource Conservation District

9481 El Camino Real, Atascadero, CA 93422 | 805.460.7272 | www.us-ltrcd.org

project. A MITIGATED NEGATIVE DECLARATION will be prepared.

I find that the proposed project MAY have a significant effect on the environment, and an ENVIRONMENTAL IMPACT REPORT is required.

I find that the proposed project MAY have a "potentially significant effect" or "potentially significant unless mitigated" impact on the environment, but at least one effect 1) has been adequately analyzed in an earlier document pursuant to applicable legal standards, and 2) has been addressed by mitigation measures based on the earlier analysis as described on attached sheets. An ENVIRONMENTAL IMPACT REPORT is required, but it must analyze only the effects that remain to be addressed.

I find that although the proposed project could have a significant effect on the environment, there WILL NOT be a significant effect in this case because all potentially significant effects (a) have been analyzed adequately in an earlier EIR or NEGATIVE DECLARATION pursuant to applicable standards and (b) have been avoided or mitigated pursuant to that earlier EIR or NEGATIVE DECLARATION, including revisions or mitigation measures that are imposed upon the proposed project.

Devin Best

Devin Best, Executive Director

10/9/23

Date

EVALUATION OF ENVIRONMENTAL IMPACTS:

- 1) A brief explanation is required for all answers except "No Impact" answers that are adequately supported by the information sources a Lead Agency cites following each question. A "No Impact" answer is adequately supported if the referenced information sources show that the impact simply does not apply to projects like the one involved (e.g. the project falls outside a fault rupture zone). A "No Impact" answer should be explained where it is based on project-specific factors as well as general standards (e.g. the project will not expose sensitive receptors to pollutants, based on a project-specific screening analysis).
- 2) All answers must take account of the whole action involved, including off-site as well as on-site, cumulative as well as project-level, indirect as well as direct, and construction as well as operational impacts.
- 3) "Potentially Significant Impact" is appropriate if there is substantial evidence that an effect is significant. If there are one or more "Potentially Significant Impact" entries when the determination is made, an EIR is required.
- 4) "Potentially Significant Unless Mitigation Incorporated" applies where the incorporation of mitigation measures has reduced an effect from "Potentially Significant Impact" to a "Less than Significant Impact." The Lead Agency must describe the mitigation measures, and briefly explain how they reduce the effect to a less than significant level (mitigation measures from Section XVII, "Earlier Analyses," may be cross-referenced).
- 5) Earlier analyses may be used where, pursuant to the tiering, program EIR, or other CEQA process, an effect has been adequately analyzed in an earlier EIR or negative declaration. Section 15063(c)(3)(D). Earlier analyses are discussed in Section XVII at the end of the checklist.
- 6) Lead Agencies are encouraged to incorporate into the checklist references information sources for potential impacts (e.g. general plans, zoning ordinances). Reference to a previously prepared or outside document should, where appropriate, include a reference to the page or pages where the statement is substantiated. A source list should be attached. Other sources used or individuals contacted should be cited in the discussion.