

INITIAL STUDY/NEGATIVE DECLARATION

[Pursuant to Public Resources Code Section 21080(c) and California Code of Regulations, Title 14, Sections 15070-15071]

LEAD AGENCY: San Joaquin County Community Development Department

PROJECT APPLICANT: Maher El Louhaiby

PROJECT TITLE/FILE NUMBER(S): PA-2100027

PROJECT DESCRIPTION: A Site Approval application for leisure vehicle storage to include a maximum of 12 storage spaces for boats and motor homes on a 0.66-acre parcel. The project includes the construction of a 216-square-foot office building, a 260-square-foot, 2-story caretaker residence, a 96-square-foot storage shed, a 144-square-foot RV shade structure, and grading for a total of 6 storage spaces. The storage facility will utilize an onsite well and septic system. A retention pond will be constructed for storm water drainage. The site is accessed from 1 driveway from the N. State Route 99 E. Frontage Road, Stockton. (Use Type: Equipment Sales, Repair, and Storage – Storage, Leisure)

The project site is located on the east side of N. State Route 99 E. Frontage Road, 0.7 miles south of E. Eight Mile Road, Stockton.

ASSESSORS PARCEL NO(S): 086-070-36

ACRES: 0.66 acres

GENERAL PLAN: Community Commercial C/C

ZONING: Community Commercial C-C

POTENTIAL POPULATION, NUMBER OF DWELLING UNITS, OR SQUARE FOOTAGE OF USE(S):
716 square feet of structures and 0.66 acre for leisure vehicle storage.

SURROUNDING LAND USES:

NORTH: Commercial; Residential; Agriculture

SOUTH: Residential; Mosher Creek

EAST: Residential; Community of Morada

WEST: State Route 99; City of Stockton; Urban Agriculture zoning with scattered residences

REFERENCES AND SOURCES FOR DETERMINING ENVIRONMENTAL IMPACTS:

Original source materials and maps on file in the Community Development Department including: all County and City general plans and community plans; assessor parcel books; various local and FEMA flood zone maps; service district maps; maps of geologic instability; maps and reports on endangered species such as the Natural Diversity Data Base; noise contour maps; specific roadway plans; maps and/or records of archeological/historic resources; soil reports and maps; etc.

Many of these original source materials have been collected from other public agencies or from previously prepared EIR's and other technical studies. Additional standard sources which should be specifically cited below include on-site visits by staff (note date); staff knowledge or experience; and independent environmental studies submitted to the County as part of the project application (Enter report name, date, and consultant.). Copies of these reports can be found by contacting the Community Development Department.

TRIBAL CULTURAL RESOURCES:

Have California Native American tribes traditionally and culturally affiliated with the project area requested consultation pursuant to Public Resources Code section 21080.3.1? If so, is there a plan for consultation that includes, for example, the determination of significance of impacts to tribal cultural resources, procedures regarding confidentiality, etc.?

No

GENERAL CONSIDERATIONS:

1. Does it appear that any environmental feature of the project will generate significant public concern or controversy?

☐

Yes

☒

No

Nature of concern(s): Enter concern(s).

2. Will the project require approval or permits by agencies other than the County?

☐

Yes

☒

No

Agency name(s): Enter agency name(s).

3. Is the project within the Sphere of Influence, or within two miles, of any city?

☒

Yes

☐

No

City: City of Stockton

ENVIRONMENTAL FACTORS POTENTIALLY AFFECTED:

The environmental factors checked below would be potentially affected by this project, involving at least one impact that is a "**Potentially Significant Impact**" as indicated by the checklist on the following pages.

<input type="checkbox"/> Aesthetics	<input type="checkbox"/> Agriculture and Forestry Resources	<input type="checkbox"/> Air Quality
<input type="checkbox"/> Biological Resources	<input type="checkbox"/> Cultural Resources	<input type="checkbox"/> Energy
<input type="checkbox"/> Geology / Soils	<input type="checkbox"/> Greenhouse Gas Emissions	<input type="checkbox"/> Hazards & Hazardous Materials
<input type="checkbox"/> Hydrology / Water Quality	<input type="checkbox"/> Land Use / Planning	<input type="checkbox"/> Mineral Resources
<input type="checkbox"/> Noise	<input type="checkbox"/> Population / Housing	<input type="checkbox"/> Public Services
<input type="checkbox"/> Recreation	<input type="checkbox"/> Transportation	<input type="checkbox"/> Tribal Cultural Resources
<input type="checkbox"/> Utilities / Service Systems	<input type="checkbox"/> Wildfire	<input type="checkbox"/> Mandatory Findings of Significance

DETERMINATION: (To be completed by the Lead Agency) On the basis of this initial evaluation:

- ☐ I find that the proposed project **COULD NOT** have a significant effect on the environment, and a **NEGATIVE DECLARATION** will be prepared.
- ☒ I find that although the proposed project could have a significant effect on the environment, there will not be a significant effect in this case because revisions in the project have been made by or agreed to by the project proponent. A **MITIGATED NEGATIVE DECLARATION** will be prepared.
- ☐ I find that the proposed project MAY have a significant effect on the environment, and an **ENVIRONMENTAL IMPACT REPORT** is required.
- ☐ I find that the proposed project **MAY** have a "potentially significant impact" or "potentially significant unless mitigated" impact on the environment, but at least one effect 1) has been adequately analyzed in an earlier document pursuant to applicable legal standards, and 2) has been addressed by mitigation measures based on the earlier analysis as described on attached sheets. An **ENVIRONMENTAL IMPACT REPORT** is required, but it must analyze only the effects that remain to be addressed.
- ☐ I find that although the proposed project could have a significant effect on the environment, because all potentially significant effects (a) have been analyzed adequately in an earlier **EIR** or **NEGATIVE DECLARATION** pursuant to applicable standards, and (b) have been avoided or mitigated pursuant to that earlier **EIR** or **NEGATIVE DECLARATION**, including revisions or mitigation measures that are imposed upon the proposed project, nothing further is required.

Alisa Goulet
Signature

10-13-2023
Date

EVALUATION OF ENVIRONMENTAL IMPACTS:

- 1) A brief explanation is required for all answers except "No Impact" answers that are adequately supported by the information sources a lead agency cites in the parentheses following each question. A "No Impact" answer is adequately supported if the referenced information sources show that the impact simply does not apply to projects like the one involved (e.g., the project falls outside a fault rupture zone). A "No Impact" answer should be explained where it is based on project-specific factors as well as general standards (e.g., the project will not expose sensitive receptors to pollutants, based on a project-specific screening analysis).
- 2) All answers must take account of the whole action involved, including off-site as well as on-site, cumulative as well as project-level, indirect as well as direct, and construction as well as operational impacts.
- 3) Once the lead agency has determined that a particular physical impact may occur, then the checklist answers must indicate whether the impact is potentially significant, less than significant with mitigation, or less than significant. "Potentially Significant Impact" is appropriate if there is substantial evidence that an effect may be significant. If there are one or more "Potentially Significant Impact" entries when the determination is made, an EIR is required.
- 4) "Negative Declaration: Less Than Significant With Mitigation Incorporated" applies where the incorporation of mitigation measures has reduced an effect from "Potentially Significant Impact" to a "Less Than Significant Impact." The lead agency must describe the mitigation measures, and briefly explain how they reduce the effect to a less than significant level (mitigation measures from "Earlier Analyses," as described in (5) below, may be cross-referenced).
- 5) Earlier analyses may be used where, pursuant to the tiering, program EIR, or other CEQA process, an effect has been adequately analyzed in an earlier EIR or negative declaration. Section 15063(c)(3)(D). In this case, a brief discussion should identify the following:
 - a) Earlier Analysis Used. Identify and state where they are available for review.
 - b) Impacts Adequately Addressed. Identify which effects from the above checklist were within the scope of and adequately analyzed in an earlier document pursuant to applicable legal standards, and state whether such effects were addressed by mitigation measures based on the earlier analysis.
 - c) Mitigation Measures. For effects that are "Less than Significant with Mitigation Measures Incorporated," describe the mitigation measures which were incorporated or refined from the earlier document and the extent to which they address site-specific conditions for the project.
- 6) Lead agencies are encouraged to incorporate into the checklist references to information sources for potential impacts (e.g., general plans, zoning ordinances). Reference to a previously prepared or outside document should, where appropriate, include a reference to the page or pages where the statement is substantiated.
- 7) Supporting Information Sources: A source list should be attached, and other sources used or individuals contacted should be cited in the discussion.
- 8) This is only a suggested form, and lead agencies are free to use different formats; however, lead agencies should normally address the questions from this checklist that are relevant to a project's environmental effects in whatever format is selected.
- 9) The explanation of each issue should identify:
 - a) the significance criteria or threshold, if any, used to evaluate each question; and
 - b) the mitigation measure identified, if any, to reduce the impact to less than significance.

Potentially Significant Impact	Less Than Significant with Mitigation Incorporated	Less Than Significant Impact	No Impact	Analyzed In The Prior EIR
--------------------------------------	---	------------------------------------	--------------	---------------------------------

I. AESTHETICS.

Except as provided in Public Resources Code Section 21099, would the project:

a) Have a substantial adverse effect on a scenic vista?	<input type="checkbox"/>	<input type="checkbox"/>	<input checked="" type="checkbox"/>	<input type="checkbox"/>	<input type="checkbox"/>
b) Substantially damage scenic resources, including, but not limited to, trees, rock outcroppings, and historic buildings within a state scenic highway?	<input type="checkbox"/>	<input type="checkbox"/>	<input checked="" type="checkbox"/>	<input type="checkbox"/>	<input type="checkbox"/>
c) In non-urbanized areas, substantially degrade the existing visual character or quality of public views of the site and its surroundings? (Public views are those that are experienced from publically accessible vantage points). If the project is in an urbanized area, would the project conflict with applicable zoning and other regulations governing scenic quality?	<input type="checkbox"/>	<input type="checkbox"/>	<input checked="" type="checkbox"/>	<input type="checkbox"/>	<input type="checkbox"/>
d) Create a new source of substantial light or glare which would adversely affect day or nighttime views in the area?	<input type="checkbox"/>	<input type="checkbox"/>	<input checked="" type="checkbox"/>	<input type="checkbox"/>	<input type="checkbox"/>

Impact Discussion:

- a-c) The project parcel is located on N. State Route 99 E. Frontage Road, northeast of the City of Stockton. Pursuant to San Joaquin County General Plan 2035 Natural and Cultural Resources Element Figure NCR-1 (page 3.4-13), this section of N. State Route 99 E. Frontage Road is not designated as a Scenic Route. The area is a mix of commercial development to the north and south, and residential parcels to the east. State Route 99 borders the west side of the property. Bordering on the north side is a 7-acre self-storage facility; a religious assembly is to the south. Therefore, any impact on a scenic vista or resource is expected to be less than significant and the project will not have a substantial, adverse effect on a scenic vista or scenic resource, nor will it degrade the visual character or quality of public views of the site and its surroundings.
- d) New lighting for the project would include outdoor building lighting and parking lot lighting. Parking lot lighting standards stipulate that all lighting be designed to confine direct rays to the premises, with no spillover beyond the property line except onto public thoroughfares, provided that such light does not cause a hazard to motorists (Development Title Section 9-406.060). Therefore, the project is expected to have a less than significant impact from new sources of light or glare on day or nighttime views in the area.

Potentially Significant Impact	Less Than Significant with Mitigation Incorporated	Less Than Significant Impact	No Impact	Analyzed In The Prior EIR
--------------------------------------	---	------------------------------------	--------------	---------------------------------

II. AGRICULTURE AND FORESTRY RESOURCES.

In determining whether impacts to agricultural resources are significant environmental effects, lead agencies may refer to the California Agricultural Land Evaluation and Site Assessment Model (1997) prepared by the California Dept. of Conservation as an optional model to use in assessing impacts on agriculture and farmland. In determining whether impacts to forest resources, including timberland, are significant environmental effects, lead agencies may refer to information compiled by the California Department of Forestry and Fire Protection regarding the state's inventory of forest land, including the Forest and Range Assessment Project and the Forest Legacy Assessment project; and forest carbon measurement methodology provided in Forest Protocols adopted by the California Air Resources Board. -- Would the project:

- | | | | | | |
|--|--------------------------|--------------------------|--------------------------|-------------------------------------|--------------------------|
| a) Convert Prime Farmland, Unique Farmland, or Farmland of Statewide Importance (Farmland), as shown on the maps prepared pursuant to the Farmland Mapping and Monitoring Program of the California Resources Agency, to a nonagricultural use? | <input type="checkbox"/> | <input type="checkbox"/> | <input type="checkbox"/> | <input checked="" type="checkbox"/> | <input type="checkbox"/> |
| b) Conflict with existing zoning for agricultural use, or a Williamson Act contract? | <input type="checkbox"/> | <input type="checkbox"/> | <input type="checkbox"/> | <input checked="" type="checkbox"/> | <input type="checkbox"/> |
| c) Conflict with existing zoning for, or cause rezoning of, forest land (as defined in Public Resources Code section 12220(g)), timberland (as defined by Public Resources Code section 4526), or timberland zoned Timberland Production (as defined by Government Code section 51104(g))? | <input type="checkbox"/> | <input type="checkbox"/> | <input type="checkbox"/> | <input checked="" type="checkbox"/> | <input type="checkbox"/> |
| d) Result in the loss of forest land or conversion of forest land to non-forest use? | <input type="checkbox"/> | <input type="checkbox"/> | <input type="checkbox"/> | <input checked="" type="checkbox"/> | <input type="checkbox"/> |
| e) Involve other changes in the existing environment which, due to their location or nature, could result in conversion of Farmland, to non-agricultural use or conversion of forest land to non-forest use? | <input type="checkbox"/> | <input type="checkbox"/> | <input type="checkbox"/> | <input checked="" type="checkbox"/> | <input type="checkbox"/> |

Impact Discussion:

- a) The project is a proposed storage facility for leisure vehicles on a parcel zoned Community Commercial (C-C). The parcel is not classified as Prime Farmland and Unique Farmland on maps provided by the California Department of Conservation's Farmland Mapping and Monitoring Program. The parcels have the classification of Urban or Built-Up Land (D). Therefore, the impact of the project's conversion of Prime Farmland, Unique Farmland, or Farmland of State Importance to a nonagricultural use will be less than significant.
- b) The parcels are not under a Williamson Act contract nor are they zoned for agriculture, therefore they would be ineligible for a Williamson Act contract. Therefore, the project will not conflict with existing zoning for agricultural use, nor will it conflict with a Williamson Act contract.

c-d) There are no forest resources or zoning for forestlands or timberland, as defined by Public Resources Code and

Government Code, located on or near the project site, therefore, the project will have no impact on corresponding zoning or conversion of such land.

e) See answer a).

Potentially Significant Impact	Less Than Significant with Mitigation Incorporated	Less Than Significant Impact	No Impact	Analyzed In The Prior EIR
--------------------------------------	---	------------------------------------	--------------	---------------------------------

III. AIR QUALITY.

Where available, the significance criteria established by the applicable air quality management or air pollution control district may be relied upon to make the following determinations. Would the project:

a) Conflict with or obstruct implementation of the applicable air quality plan?	<input type="checkbox"/>	<input type="checkbox"/>	<input checked="" type="checkbox"/>	<input type="checkbox"/>	<input type="checkbox"/>
b) Result in a cumulatively considerable net increase of any criteria pollutant for which the project region is non-attainment under an applicable federal or state ambient air quality standard?	<input type="checkbox"/>	<input type="checkbox"/>	<input checked="" type="checkbox"/>	<input type="checkbox"/>	<input type="checkbox"/>
c) Expose sensitive receptors to substantial pollutant concentrations?	<input type="checkbox"/>	<input type="checkbox"/>	<input checked="" type="checkbox"/>	<input type="checkbox"/>	<input type="checkbox"/>
d) Result in substantial emissions (such as those leading to odors) adversely affecting a substantial number of people?	<input type="checkbox"/>	<input type="checkbox"/>	<input checked="" type="checkbox"/>	<input type="checkbox"/>	<input type="checkbox"/>

Impact Discussion:

- a-d) The proposed project is a small storage lot for leisure vehicles. The San Joaquin Valley Air Pollution Control District (APCD) has been established by the State in an effort to control and minimize air pollution. The project was referred to the APCD for review on March 12, 2021, and on June 20, 2023. The applicant will be required to meet existing requirements for emissions and dust control as established by SJVAPCD. Therefore, any impacts to air quality are expected to be reduced to less than significant.

Potentially Significant Impact	Less Than Significant with Mitigation Incorporated	Less Than Significant Impact	No Impact	Analyzed In The Prior EIR
--------------------------------------	---	------------------------------------	--------------	---------------------------------

IV. BIOLOGICAL RESOURCES.

Would the project:

a) Have a substantial adverse effect, either directly or through habitat modifications, on any species identified as a candidate, sensitive, or special status species in local or regional plans, policies, or regulations, or by the California Department of Fish and Game or U.S. Fish and Wildlife Service?	<input type="checkbox"/>	<input checked="" type="checkbox"/>	<input type="checkbox"/>	<input type="checkbox"/>	<input type="checkbox"/>
b) Have a substantial adverse effect on any riparian habitat or other sensitive natural community identified in local or regional plans, policies, regulations or by the California Department of Fish and Game or US Fish and Wildlife Service?	<input type="checkbox"/>	<input type="checkbox"/>	<input type="checkbox"/>	<input checked="" type="checkbox"/>	<input type="checkbox"/>
c) Have a substantial adverse effect on state or federally protected wetlands (including, but not limited to, marsh, vernal pool, coastal, etc.) through direct removal, filling, hydrological interruption, or other means?	<input type="checkbox"/>	<input type="checkbox"/>	<input type="checkbox"/>	<input checked="" type="checkbox"/>	<input type="checkbox"/>
d) Interfere substantially with the movement of any native resident or migratory fish or wildlife species or with established native resident or migratory wildlife corridors, or impede the use of native wildlife nursery sites?	<input type="checkbox"/>	<input checked="" type="checkbox"/>	<input type="checkbox"/>	<input type="checkbox"/>	<input type="checkbox"/>
e) Conflict with any local policies or ordinances protecting biological resources, such as a tree preservation policy or ordinance?	<input type="checkbox"/>	<input checked="" type="checkbox"/>	<input type="checkbox"/>	<input type="checkbox"/>	<input type="checkbox"/>
f) Conflict with the provisions of an adopted Habitat Conservation Plan, Natural Community Conservation Plan, or other approved local, regional, or state habitat conservation plan?	<input type="checkbox"/>	<input checked="" type="checkbox"/>	<input type="checkbox"/>	<input type="checkbox"/>	<input type="checkbox"/>

Impact Discussion:

- a-f) The California Department of Fish and Wildlife Natural Diversity Database lists *Branchinecta messorhynchus* (Midvalley Fairy Shrimp), *Lepidurus packardii* (Vernal Pool Tadpole Shrimp), *Athene cunicularia* (burrowing owl), and *Buteo swainsoni* (Swainson's hawk) as rare, endangered, or threatened species or habitat located on or near the site for the proposed project. Referrals have been sent to the San Joaquin Council of Governments (SJCOC), the agency responsible for verifying the correct implementation of the *San Joaquin County Multi-Species Habitat Conservation and Open Space Plan* (SJMSCP), which provides compensation for the conversion of Open Space to non-Open Space uses which affect the plant, fish and wildlife species covered by the Plan. Pursuant to the Final EIR/EIS for SJMSCP, dated November 15, 2000, and certified by SJCOC on December 7, 2000, implementation of the SJMSCP is expected to reduce impacts to biological resources resulting from the proposed project to a level of less-than-significant.

SJCOC responded to this project referral in a letter dated November 8, 2022, that the project is subject to the SJMSCP. The applicant has confirmed that he will participate in SJMSCP. With the applicant's participation, the proposed project is consistent with the SJMSCP and any impacts to biological resources resulting from the proposed project will be reduced to a level of less-than-significant.

Potentially Significant Impact	Less Than Significant with Mitigation Incorporated	Less Than Significant Impact	No Impact	Analyzed In The Prior EIR
--------------------------------------	---	------------------------------------	--------------	---------------------------------

V. CULTURAL RESOURCES.

Would the project:

- a) Cause a substantial adverse change in the significance of a historical resource pursuant to § 15064.5?
- b) Cause a substantial adverse change in the significance of an archaeological resource pursuant to § 15064.5?
- c) Disturb any human remains, including those interred outside of dedicated cemeteries?

<input type="checkbox"/>	<input type="checkbox"/>	<input checked="" type="checkbox"/>	<input type="checkbox"/>	<input type="checkbox"/>
<input type="checkbox"/>	<input type="checkbox"/>	<input checked="" type="checkbox"/>	<input type="checkbox"/>	<input type="checkbox"/>
<input type="checkbox"/>	<input type="checkbox"/>	<input checked="" type="checkbox"/>	<input type="checkbox"/>	<input type="checkbox"/>

Impact Discussion:

- a-b) The proposed project is expected to have a less than significant impact on Cultural Resources as there are no resources on the project site that are listed or are eligible for listing on a local register, the California Register of Historic Places, or National Register of Historic Places.
- c) In the event human remains are encountered during any portion of the project, California state law requires that there shall be no further excavation or disturbance of the site or any nearby area reasonably suspected to overlie adjacent remains until the coroner of the county has determined manner and cause of death, and the recommendations concerning the treatment and disposition of the human remains have been made to the person responsible for the excavation (California Health and Safety Code - Section 7050.5). In this way, any disturbance to human remains will be reduced to less than significant.

Potentially Significant Impact	Less Than Significant with Mitigation Incorporated	Less Than Significant Impact	No Impact	Analyzed In The Prior EIR
--------------------------------------	---	------------------------------------	--------------	---------------------------------

VI. ENERGY.

Would the project:

a) Result in a potentially significant environmental impact due to wasteful, inefficient, or unnecessary consumption of energy, or wasteful use of energy resources, during project construction or operation?	<input type="checkbox"/>	<input type="checkbox"/>	<input checked="" type="checkbox"/>	<input type="checkbox"/>	<input type="checkbox"/>
b) Conflict with or obstruct a state or local plan for renewable energy or energy efficiency?	<input type="checkbox"/>	<input type="checkbox"/>	<input checked="" type="checkbox"/>	<input type="checkbox"/>	<input type="checkbox"/>

Impact Discussion:

- a-b) The California Energy Code (also titled The Energy Efficiency Standards for Residential and Non-residential Buildings) was created by the California Building Standards Commission in response to a legislative mandate to reduce California's energy consumption. The code's purpose is to advance the state's energy policy, develop renewable energy sources and prepare for energy emergencies. The code includes energy conservation standards applicable to most buildings throughout California. These requirements will be applicable to the proposed project ensuring that any impact to the environment due to wasteful, inefficient, or unnecessary consumption of energy will be less than significant and preventing any conflict with state or local plans for energy efficiency and renewable energy.

Potentially Significant Impact	Less Than Significant with Mitigation Incorporated	Less Than Significant Impact	No Impact	Analyzed In The Prior EIR
--------------------------------------	---	------------------------------------	--------------	---------------------------------

VII. GEOLOGY AND SOILS.

Would the project:

a) Directly or indirectly cause potential substantial adverse effects, including the risk of loss, injury, or death involving:	<input type="checkbox"/>	<input type="checkbox"/>	<input checked="" type="checkbox"/>	<input type="checkbox"/>	<input type="checkbox"/>
i) Rupture of a known earthquake fault, as delineated on the most recent Alquist-Priolo Earthquake Fault Zoning Map issued by the State Geologist for the area or based on other substantial evidence of a known fault? Refer to Division of Mines and Geology Special Publication 42.	<input type="checkbox"/>	<input type="checkbox"/>	<input checked="" type="checkbox"/>	<input type="checkbox"/>	<input type="checkbox"/>
ii) Strong seismic ground shaking?	<input type="checkbox"/>	<input type="checkbox"/>	<input checked="" type="checkbox"/>	<input type="checkbox"/>	<input type="checkbox"/>
iii) Seismic-related ground failure, including liquefaction?	<input type="checkbox"/>	<input type="checkbox"/>	<input checked="" type="checkbox"/>	<input type="checkbox"/>	<input type="checkbox"/>
iv) Landslides?	<input type="checkbox"/>	<input type="checkbox"/>	<input checked="" type="checkbox"/>	<input type="checkbox"/>	<input type="checkbox"/>
b) Result in substantial soil erosion or the loss of topsoil?	<input type="checkbox"/>	<input type="checkbox"/>	<input checked="" type="checkbox"/>	<input type="checkbox"/>	<input type="checkbox"/>
c) Be located on a geologic unit or soil that is unstable, or that would become unstable as a result of the project, and potentially result in on- or off-site landslide, lateral spreading, subsidence, liquefaction or collapse?	<input type="checkbox"/>	<input type="checkbox"/>	<input checked="" type="checkbox"/>	<input type="checkbox"/>	<input type="checkbox"/>
d) Be located on expansive soil and create direct or indirect risks to life or property?	<input type="checkbox"/>	<input type="checkbox"/>	<input checked="" type="checkbox"/>	<input type="checkbox"/>	<input type="checkbox"/>
e) Have soils incapable of adequately supporting the use of septic tanks or alternative waste water disposal systems where sewers are not available for the disposal of waste water?	<input type="checkbox"/>	<input type="checkbox"/>	<input checked="" type="checkbox"/>	<input type="checkbox"/>	<input type="checkbox"/>
f) Directly or indirectly destroy a unique paleontological resource or site or unique geologic feature?	<input type="checkbox"/>	<input type="checkbox"/>	<input checked="" type="checkbox"/>	<input type="checkbox"/>	<input type="checkbox"/>

Impact Discussion:

- a) The project will have to comply with the California Building Code (CBC) which includes provisions for soils reports for grading and foundations as well as design criteria for seismic loading and other geologic hazards based on fault and seismic hazard mapping. All recommendations from a soils report must be incorporated into the construction plans. Therefore, impacts to seismic-related (or other) landslide hazards will be less than significant.
- b) The project, grading of a 0.66-acre parcel, will not result in substantial soil erosion or the loss of topsoil because grading for the project requires compliance with the CBC grading provisions under permit from the county Building Department. As a result, impacts to soil erosion or loss of topsoil will be less than significant.
- c-d) The project site is relatively flat terrain where landslides have not historically been an issue. A soils report will be required for foundations and all recommendations from a soils report must be incorporated into the construction plans. Therefore,

any risks resulting from being located on an unstable unit will be reduced to less than significant.

- e) The project will be served by a new onsite wastewater disposal system for the disposal of wastewater. The system must comply with current onsite wastewater treatment systems standards of San Joaquin County. With these standards in place, only soils capable of adequately supporting the use of septic tanks will be approved for the septic system.
- f) The project area has not been determined to contain significant historic or prehistoric archeological artifacts that could be disturbed by project construction, therefore, damage to unique paleontological resources or sites or geologic features is anticipated to be less than significant.

Potentially Significant Impact	Less Than Significant with Mitigation Incorporated	Less Than Significant Impact	No Impact	Analyzed In The Prior EIR
--------------------------------------	---	------------------------------------	--------------	---------------------------------

VIII. GREENHOUSE GAS EMISSIONS.

Would the project:

a) Generate greenhouse gas emissions, either directly or indirectly, that may have a significant impact on the environment?

☐
☐
☒
☐
☐

b) Conflict with an applicable plan, policy or regulation adopted for the purpose of reducing the emissions of greenhouse gases?

☐
☐
☒
☐
☐

Impact Discussion:

- a-b) Emissions of GHGs contributing to global climate change are attributable in large part to human activities associated with the industrial/manufacturing, utility, transportation, residential, and agricultural sectors. Therefore, the cumulative global emissions of GHGs contributing to global climate change can be attributed to every nation, region, and city, and virtually every individual on earth. An individual project's GHG emissions are at a micro-scale level relative to global emissions and effects to global climate change; however, an individual project could result in a cumulatively considerable incremental contribution to a significant cumulative macro-scale impact. As such, impacts related to emissions of GHG are inherently considered cumulative impacts.

Implementation of the proposed project would cumulatively contribute to increases of GHG emissions. Estimated GHG emissions attributable to future development would be primarily associated with increases of carbon dioxide (CO₂) and, to a lesser extent, other GHG pollutants, such as methane (CH₄) and nitrous oxide (N₂O) associated with area sources, mobile sources or vehicles, utilities (electricity and natural gas), water usage, wastewater generation, and the generation of solid waste. The primary source of GHG emissions for the project would be mobile source emissions. The common unit of measurement for GHG is expressed in terms of annual metric tons of CO₂ equivalents (MTCO₂e/yr).

As noted previously, the proposed project will be subject to the rules and regulations of the SJVAPCD. The SJVAPCD has adopted the *Guidance for Valley Land-use Agencies in Addressing GHG Emission Impacts for New Projects under CEQA* and the *District Policy – Addressing GHG Emission Impacts for Stationary Source Projects Under CEQA When Serving as the Lead Agency*.¹¹ The guidance and policy rely on the use of performance-based standards, otherwise known as Best Performance Standards (BPS) to assess significance of project specific greenhouse gas emissions on global climate change during the environmental review process, as required by CEQA. To be determined to have a less-than-significant individual and cumulative impact with regard to GHG emissions, projects must include BPS sufficient to reduce GHG emissions by 29 percent when compared to Business As Usual (BAU) GHG emissions. Per the SJVAPCD, BAU is defined as projected emissions for the 2002-2004 baseline period. Projects which do not achieve a 29 percent reduction from BAU levels with BPS alone are required to quantify additional project-specific reductions demonstrating a combined reduction of 29 percent. Potential mitigation measures may include, but not limited to: on-site renewable energy (e.g. solar photovoltaic systems), electric vehicle charging stations, the use of alternative-fueled vehicles, exceeding Title 24 energy efficiency standards, the installation of energy-efficient lighting and control systems, the installation of energy-efficient mechanical systems, the installation of drought-tolerant landscaping, efficient irrigation systems, and the use of low-flow plumbing fixtures.

It should be noted that neither the SJVAPCD nor the County provide project-level thresholds for construction-related GHG emissions. Construction GHG emissions are a one-time release and are, therefore, not typically expected to generate a significant contribution to global climate change. As such, the analysis herein is limited to discussion of long-term operational GHG emissions.

¹¹ San Joaquin Valley Air Pollution Control District. *Guidance for Valley Land-use Agencies in Addressing GHG Emission Impacts for New Projects under CEQA*. December 17, 2009. San Joaquin Valley Air Pollution Control District. *District Policy Addressing GHG Emission Impacts for Stationary Source Projects Under CEQA When Serving as the Lead Agency*. December 17, 2009.

Potentially Significant Impact	Less Than Significant with Mitigation Incorporated	Less Than Significant Impact	No Impact	Analyzed In The Prior EIR
--------------------------------------	---	------------------------------------	--------------	---------------------------------

IX. HAZARDS AND HAZARDOUS MATERIALS.

Would the project:

- | | | | | | |
|---|--------------------------|--------------------------|-------------------------------------|-------------------------------------|--------------------------|
| a) Create a significant hazard to the public or the environment through the routine transport, use, or disposal of hazardous materials? | <input type="checkbox"/> | <input type="checkbox"/> | <input checked="" type="checkbox"/> | <input type="checkbox"/> | <input type="checkbox"/> |
| b) Create a significant hazard to the public or the environment through reasonably foreseeable upset and accident conditions involving the release of hazardous materials into the environment? | <input type="checkbox"/> | <input type="checkbox"/> | <input checked="" type="checkbox"/> | <input type="checkbox"/> | <input type="checkbox"/> |
| c) Emit hazardous emissions or handle hazardous or acutely hazardous materials, substances, or waste within one-quarter mile of an existing or proposed school? | <input type="checkbox"/> | <input type="checkbox"/> | <input checked="" type="checkbox"/> | <input type="checkbox"/> | <input type="checkbox"/> |
| d) Be located on a site which is included on a list of hazardous materials sites compiled pursuant to Government Code Section 65962.5 and, as a result, would it create a significant hazard to the public or the environment? | <input type="checkbox"/> | <input type="checkbox"/> | <input type="checkbox"/> | <input checked="" type="checkbox"/> | <input type="checkbox"/> |
| e) For a project located within an airport land use plan or, where such a plan has not been adopted, within two miles of a public airport or public use airport, would the project result in a safety hazard or excessive noise for people residing or working in the project area? | <input type="checkbox"/> | <input type="checkbox"/> | <input type="checkbox"/> | <input checked="" type="checkbox"/> | <input type="checkbox"/> |
| f) Impair implementation of or physically interfere with an adopted emergency response plan or emergency evacuation plan? | <input type="checkbox"/> | <input type="checkbox"/> | <input checked="" type="checkbox"/> | <input type="checkbox"/> | <input type="checkbox"/> |
| g) Expose people or structures, either directly or indirectly, to a significant risk of loss, injury or death involving wildland fires, including where wildlands are adjacent to urbanized areas or where residences are intermixed with wildlands? | <input type="checkbox"/> | <input type="checkbox"/> | <input checked="" type="checkbox"/> | <input type="checkbox"/> | <input type="checkbox"/> |

Impact Discussion:

- a-c) The proposed project is a 0.66-acre storage lot for leisure vehicles. Pursuant to the Hazardous Materials Disclosure Survey submitted with the application, there will not be any storage of hazardous materials on site. Regulations related to the storage of hazardous materials require the owner/operator to report the use or storage of these hazardous materials to the California Environmental Reporting System (CERS) and must comply with all applicable federal, state, and local regulations pertaining to the storage of hazardous materials. In this way, impacts related to the use, transport, or disposal of hazardous materials are expected to be less than significant.
- d) The project site is not listed as a hazardous materials site on the California Department of Toxic Substances Control EnviroStor database map, compiled pursuant to Government Code 65962.5 and, therefore, will not result in creating a significant hazard to the public or the environment.
- e) The project site is not located within an airport land use plan or within two (2) miles of an airport. The nearest airport is the Kindgon Airpark located 3.75 miles southeast of the project site. Therefore, impacts resulting from airport noise levels to people in the project area are expected to be less than significant.

- f) The County of San Joaquin Emergency Operations Plan is an all-hazards document describing the County's incident management structure, compliance with relevant legal statutes and other relevant guidelines, whole community engagement, continuity of government focus, and critical components of the incident management structure. According to the Emergency Operations Plan, a possible evacuation route in the event of an emergency would be State Route 99, which is adjacent to the project. The Project would not affect this route, and moreover, the Project would not affect the County's ability to implement its Emergency Operations Plan in the event of an emergency. Notwithstanding, the Project would not impede access to any public route that might be needed as an evacuation route. As a result, the Project's impact on emergency response or evacuation activities is expected to be less than significant.
- e) The project location is in the Urban community of Morada. The location is not identified as a Community at Risk from Wildfire by Cal Fire's "Fire Risk Assessment Program". Communities at Risk from Wildfire are those places within 1.5 miles of areas of High or Very High wildfire threat as determined from CDF-FRAP fuels and hazard data. Therefore, the impact of wildfires on the project are expected to be less than significant.

Potentially Significant Impact	Less Than Significant with Mitigation Incorporated	Less Than Significant Impact	No Impact	Analyzed In The Prior EIR
--------------------------------------	---	------------------------------------	--------------	---------------------------------

X. HYDROLOGY AND WATER QUALITY.

Would the project:

a) Violate any water quality standards or waste discharge requirements or otherwise substantially degrade surface or ground water quality?	<input type="checkbox"/>	<input type="checkbox"/>	<input checked="" type="checkbox"/>	<input type="checkbox"/>	<input type="checkbox"/>
b) Substantially decrease groundwater supplies or interfere substantially with groundwater recharge such that the project may impede sustainable groundwater management of the basin?	<input type="checkbox"/>	<input checked="" type="checkbox"/>	<input type="checkbox"/>	<input type="checkbox"/>	<input type="checkbox"/>
c) Substantially alter the existing drainage pattern of the site or area, including through the alteration of the course of a stream or river or through the addition of impervious surfaces, in a manner which would:	<input type="checkbox"/>	<input type="checkbox"/>	<input checked="" type="checkbox"/>	<input type="checkbox"/>	<input type="checkbox"/>
i) result in substantial erosion or siltation on- or off-site;	<input type="checkbox"/>	<input type="checkbox"/>	<input checked="" type="checkbox"/>	<input type="checkbox"/>	<input type="checkbox"/>
ii) substantially increase the rate or amount of surface runoff in a manner which would result in flooding on- or off-site;	<input type="checkbox"/>	<input type="checkbox"/>	<input checked="" type="checkbox"/>	<input type="checkbox"/>	<input type="checkbox"/>
iii) create or contribute runoff water which would exceed the capacity of existing or planned stormwater drainage systems or provide substantial additional sources of polluted runoff; or	<input type="checkbox"/>	<input type="checkbox"/>	<input checked="" type="checkbox"/>	<input type="checkbox"/>	<input type="checkbox"/>
iv) impede or redirect flood flows?	<input type="checkbox"/>	<input type="checkbox"/>	<input checked="" type="checkbox"/>	<input type="checkbox"/>	<input type="checkbox"/>
d) In flood hazard, tsunami, or seiche zones, risk release of pollutants due to project inundation?	<input type="checkbox"/>	<input type="checkbox"/>	<input checked="" type="checkbox"/>	<input type="checkbox"/>	<input type="checkbox"/>
e) Conflict with or obstruct implementation of a water quality control plan or sustainable groundwater management plan?	<input type="checkbox"/>	<input checked="" type="checkbox"/>	<input type="checkbox"/>	<input type="checkbox"/>	<input type="checkbox"/>

Impact Discussion:

- a-b) The proposed project is a 0.66-acre storage lot for leisure vehicles. The project will be served by a new onsite wastewater treatment system (OWTS). Prior to issuance of a building permit for an OWTS, a soil suitability and nitrate loading study incorporating proposed staff and customer use must be submitted to the Environmental Health Department, indicating that the area is suitable for septic system usage. All onsite wastewater treatment systems are required to be constructed according to, and comply with, the Onsite Wastewater Treatment Systems standards of San Joaquin County to prevent violations that could degrade surface and groundwater.

The proposed project, a 0.66-acre storage lot for leisure vehicles, will receive water from a new onsite well. Permits from the Environmental Health Department and, if required, the California State Water Resources Control Board Division of Drinking Water, will be required to construct the private well.

Although the project will result in an increase in impervious surface area on the project site, the planned use of gravel for storage areas will allow more impervious surface area to remain despite the construction project. Therefore, the project's impact on the depletion of sustainable groundwater is expected to be less than significant.

Additionally, the applicant must file a Notice of Intent (NOI) with the State Water Resources Control Board (SWRCB) and comply with the State "General Permit for Storm Water Discharges Associated with Construction Activity." Therefore, compliance with the rules and regulations of the Environmental Health Department and the State Water Resources Control Board will ensure any impacts to surface or groundwater quality from sewage disposal are reduced to less than significant.

- c) The construction of the proposed project would result in grading and soil-disturbing activities and the installation of new impervious surfaces. A grading permit will be required which requires plans and grading calculations, including a statement of the estimated quantities of excavation and fill, prepared by a Registered Design Professional. The grading plan must show the existing grade and finished grade in contour intervals of sufficient clarity to indicate the nature and extent of the work and show in detail that it complies with the requirements of the California Building Code (CBC). The plans must also show the existing grade on adjoining properties in sufficient detail to identify how grade changes will conform to the requirements of the CDC. A drainage plan must be submitted for review and approval, prior to release of a building permit. In this way, any impacts to the existing drainage pattern of the site will be less than significant.
- d) The project site is not in a tsunami or seiche zone and the site is located in an area that has been determined to be protected by levees from the 1% annual chance (100-year) flood. Therefore, the risk of release of pollutants due to inundation is less than significant.
- e) The project will receive water from a new onsite well. applicant will be required to comply with the San Joaquin County 2021 Storm Water Quality Control Criteria Plan (SWQCCP) to protect surface and groundwater on site and to ensure that the project doesn't conflict or obstruct a water quality control plan or sustainable groundwater management plan.

Potentially Significant Impact	Less Than Significant with Mitigation Incorporated	Less Than Significant Impact	No Impact	Analyzed In The Prior EIR
--------------------------------------	---	------------------------------------	--------------	---------------------------------

XI. LAND USE AND PLANNING.

Would the project:

- | | | | | | |
|--|--------------------------|--------------------------|-------------------------------------|--------------------------|--------------------------|
| a) Physically divide an established community? | <input type="checkbox"/> | <input type="checkbox"/> | <input checked="" type="checkbox"/> | <input type="checkbox"/> | <input type="checkbox"/> |
| b) Cause a significant environmental impact due to a conflict with any land use plan, policy, or regulation adopted for the purpose of avoiding or mitigating an environmental effect? | <input type="checkbox"/> | <input type="checkbox"/> | <input checked="" type="checkbox"/> | <input type="checkbox"/> | <input type="checkbox"/> |

Impact Discussion:

- a) This proposed project is a 0.66-acre storage lot for leisure vehicles. All improvements will be located on the parcel and the expansion will not construct any barriers that would result in physically dividing an established community. It is the property owner's responsibility to know the location and use of all easements on the property and to develop the property in a way that does not impact those easements.
- b) The project parcel is zoned Community Commercial (C-C). The use type proposed by the applicant, Equipment Sales, Repair, and Storage – Storage, Leisure, is a permitted uses in the C-C zone with an approved Site Approval application. The proposed project is consistent with all land use policies and regulations of the County Development Code and 2035 General Plan, therefore, the project's impact on the environment due to land use conflict is expected to be less than significant.

Potentially Significant Impact	Less Than Significant with Mitigation Incorporated	Less Than Significant Impact	No Impact	Analyzed In The Prior EIR
--------------------------------------	---	------------------------------------	--------------	---------------------------------

XII. MINERAL RESOURCES.

Would the project:

- a) Result in the loss of availability of a known mineral resource that would be of value to the region and the residents of the state?
- b) Result in the loss of availability of a locally- important mineral resource recovery site delineated on a local general plan, specific plan or other land use plan?

☐
☐
☒
☐
☐
☐
☐
☒
☐
☐

Impact Discussion:

a-b) Pursuant to the San Joaquin County General Plan Background Report, Chapter 10-Mineral Resources, the primary extractive resource in San Joaquin County is sand and gravel, with the principal areas of sand and gravel extraction located in the southwestern part of the county and along the Mokelumne, Calaveras, and Stanislaus rivers in the eastern portion of the county. The project site is located in the central part of the county and is 2.7 miles north of the Calaveras River. Pursuant to information collected and categorized by the State Mining and Geology Board (SMGB), the project site is in a designated MRZ1 area. MRZ1 areas are defined as areas where adequate geologic information indicates that no significant mineral deposits are present, or where it is judged that little likelihood exists for their presence. This zone is applied where well developed lines of reasoning, based on economic-geologic principles and adequate data, indicate that the likelihood for occurrence of significant mineral deposits is nil or slight. Therefore, the project's impact on the loss of mineral resources or mineral resource recovery sites within the region is expected to be less than significant.

Potentially Significant Impact	Less Than Significant with Mitigation Incorporated	Less Than Significant Impact	No Impact	Analyzed In The Prior EIR
--------------------------------------	---	------------------------------------	--------------	---------------------------------

XIII. NOISE.

Would the project result in:

- a) Generation of a substantial temporary or permanent increase in ambient noise levels in the vicinity of the project in excess of standards established in the local general plan or noise ordinance, or applicable standards of other agencies?
- b) Generation of excessive groundborne vibration or groundborne noise levels?
- c) For a project within the vicinity of a private airstrip or an airport land use plan, or where such a plan has not been adopted, within two miles of a public airport or public use airport, would the project expose people residing or working in the project area to excessive noise levels?

<input type="checkbox"/>	<input type="checkbox"/>	<input checked="" type="checkbox"/>	<input type="checkbox"/>	<input type="checkbox"/>
<input type="checkbox"/>	<input type="checkbox"/>	<input checked="" type="checkbox"/>	<input type="checkbox"/>	<input type="checkbox"/>
<input type="checkbox"/>	<input type="checkbox"/>	<input checked="" type="checkbox"/>	<input type="checkbox"/>	<input type="checkbox"/>

Impact Discussion:

- a) The project is a 0.66-acre storage lot for a maximum of 12 leisure vehicles. The site is located on the east side of State Route 99, in the urban community of Morada. The entire site lies within the sixty-five decibel (65 dB) noise contour of State Route 99. The nearest residence is located adjacent to the east side of the project site and is approximately 50 feet from the property line, however, the east half of the residential parcel is also located within the sixty-five decibel (65 dB) noise contour of State Route 99. Because this is a commercial project that is adjacent to a residential zone, the applicant will be required to construct a screening 6 to 8 feet in height along the share property line. Therefore, due to the existing noise level from traffic on State Route 99, the project's addition to the existing ambient noise level will be less than significant.

The proposed storage lot will operate Monday through Saturday, from 7:00 a.m. to 6:00 p.m. Therefore, the use must comply with the county noise ordinance for daytime hours. Operating within the regulations of the ordinance will result in a less than significant increase in ambient noise.

- b) The project does not include any operations that would result in excessive ground-borne vibrations or other noise levels. The equipment utilized in grading and paving of the site will temporarily increase the area's ambient noise levels. Restrictions on the hours of construction will reduce the noise impacts to a less than significant level, therefore, the project will not have any impact on vibrations or other noise levels.
- c) The project site is not located in the vicinity of a private airstrip or an airport land use plan, therefore the project will not expose people residing or working in the project area to excessive noise levels.

Potentially Significant Impact	Less Than Significant with Mitigation Incorporated	Less Than Significant Impact	No Impact	Analyzed In The Prior EIR
--------------------------------------	---	------------------------------------	--------------	---------------------------------

XIV. POPULATION AND HOUSING.

Would the project:

a) Induce substantial unplanned population growth in an area, either directly (for example, by proposing new homes and businesses) or indirectly (for example, through extension of roads or other infrastructure)?	<input type="checkbox"/>	<input type="checkbox"/>	<input checked="" type="checkbox"/>	<input type="checkbox"/>	<input type="checkbox"/>
b) Displace substantial numbers of existing people or housing, necessitating the construction of replacement housing elsewhere?	<input type="checkbox"/>	<input type="checkbox"/>	<input checked="" type="checkbox"/>	<input type="checkbox"/>	<input type="checkbox"/>

Impact Discussion:

- a-b) The proposed project is a 0.66-acre storage lot for leisure vehicles. The project will not induce substantial population growth in the area either directly or indirectly because the project is not anticipated to result in an increase in the number of jobs available. The proposed project would not displace substantial numbers of people or existing housing, necessitating the construction of replacement housing elsewhere, and the zoning will remain the same if the project is approved. Therefore, the project's impact on population and housing is expected to be less than significant.

Potentially Significant Impact	Less Than Significant with Mitigation Incorporated	Less Than Significant Impact	No Impact	Analyzed In The Prior EIR
--------------------------------------	---	------------------------------------	--------------	---------------------------------

XV. PUBLIC SERVICES.

a) Would the project result in substantial adverse physical impacts associated with the provision of new or physically altered governmental facilities, need for new or physically altered governmental facilities, the construction of which could cause significant environmental impacts, in order to maintain acceptable service ratios, response times or other performance objectives for any of the public services:

Fire protection?	<input type="checkbox"/>	<input type="checkbox"/>	<input checked="" type="checkbox"/>	<input type="checkbox"/>	<input type="checkbox"/>
Police protection?	<input type="checkbox"/>	<input type="checkbox"/>	<input checked="" type="checkbox"/>	<input type="checkbox"/>	<input type="checkbox"/>
Schools?	<input type="checkbox"/>	<input type="checkbox"/>	<input checked="" type="checkbox"/>	<input type="checkbox"/>	<input type="checkbox"/>
Parks?	<input type="checkbox"/>	<input type="checkbox"/>	<input checked="" type="checkbox"/>	<input type="checkbox"/>	<input type="checkbox"/>
Other public facilities?	<input type="checkbox"/>	<input type="checkbox"/>	<input checked="" type="checkbox"/>	<input type="checkbox"/>	<input type="checkbox"/>

Impact Discussion:

- a) The project site is located in the urban community of Morada. The area is serviced by the Waterloo-Morada Fire Protection District, the San Joaquin County Sheriff, and is located in the Lodi Unified School District. The Waterloo-Morada Fire Protection District protects an area that is approximately 36 square miles and home to nearly 12,000 residents. The District operates out of two fire stations and has an average call volume of 3,000 service calls per year. Police protection services are provided to the project site by the San Joaquin County Sheriff's Office. The Sheriff's Office employs over 800 sworn and support personnel. The Lodi Unified School District serves 26,966 students in Lodi, Stockton, and surrounding county areas. There are no public parks near the project site.

The public service agencies listed above were provided with the project proposal and invited to respond with any project concerns or conditions. The agencies did not voice any concerns regarding significant impacts resulting from the project.

As mentioned prior, the project is not expected to generate jobs or a need for housing, therefore the project is not likely to have a significant impact on, or will not significantly affect, the ability of these service providers to maintain current levels of service.

Potentially Significant Impact	Less Than Significant with Mitigation Incorporated	Less Than Significant Impact	No Impact	Analyzed In The Prior EIR
--------------------------------------	---	------------------------------------	--------------	---------------------------------

XVI. RECREATION.

a) Would the project increase the use of existing neighborhood and regional parks or other recreational facilities such that substantial physical deterioration of the facility would occur or be accelerated?

☐
☐
☒
☐
☐

b) Does the project include recreational facilities or require the construction or expansion of recreational facilities which might have an adverse physical effect on the environment?

☐
☐
☒
☐
☐

Impact Discussion:

a-b) The proposed project will not increase the use of existing neighborhood and regional parks or other recreational facilities such that substantial physical deterioration of the facility would occur or be accelerated, because the project will not generate any new residential units and the project, an expansion of an existing warehouse, is not expected to result in an increased demand for recreational facilities. Therefore, the project will have no impact on recreation facilities.

Potentially Significant Impact	Less Than Significant with Mitigation Incorporated	Less Than Significant Impact	No Impact	Analyzed In The Prior EIR
--------------------------------------	---	------------------------------------	--------------	---------------------------------

XVII. TRANSPORTATION.

Would the project:

a) Conflict with a program plan, ordinance, or policy addressing the circulation system, including transit, roadways, bicycle, and pedestrian facilities?	<input type="checkbox"/>	<input type="checkbox"/>	<input checked="" type="checkbox"/>	<input type="checkbox"/>	<input type="checkbox"/>
b) Would the project conflict or be inconsistent with CEQA Guidelines section 15064.3, subdivision (b)?	<input type="checkbox"/>	<input type="checkbox"/>	<input type="checkbox"/>	<input checked="" type="checkbox"/>	<input type="checkbox"/>
c) Substantially increase hazards due to a geometric design feature (e.g., sharp curves or dangerous intersections) or incompatible uses (e.g., farm equipment)?	<input type="checkbox"/>	<input type="checkbox"/>	<input checked="" type="checkbox"/>	<input type="checkbox"/>	<input type="checkbox"/>
d) Result in inadequate emergency access?	<input type="checkbox"/>	<input type="checkbox"/>	<input checked="" type="checkbox"/>	<input type="checkbox"/>	<input type="checkbox"/>

Impact Discussion:

- a-c) It was determined that this project will generate less than 110 automobile trips per day and, therefore, is considered a small project according to the Technical Advisory on Evaluating Transportation Impacts in CEQA, as published by the California Office of Planning and Research (OPR) in December 2018. According to this OPR guidance, a small project that generates or attracts "fewer than 110 trips per day generally may be assumed to cause a less-than-significant transportation impact" with regards to Vehicle Miles Traveled (VMT)."
- d) The proposed project has adequate access from N. State Route 99 E. Frontage Road that will provide for adequate access for emergency equipment. The depth of the parcel is 571 feet, therefore the applicant will be required to provide adequate emergency access to all areas of the parcel with a fire access road that complies with the requirements of the California Fire Code.

Potentially Significant Impact	Less Than Significant with Mitigation Incorporated	Less Than Significant Impact	No Impact	Analyzed In The Prior EIR
--------------------------------------	---	------------------------------------	--------------	---------------------------------

XVIII. TRIBAL CULTURAL RESOURCES.

a) Would the project cause a substantial adverse change in the significance of a tribal cultural resource, defined in Public Resources Code section 21074 as either a site, feature, place, cultural landscape that is geographically defined in terms of the size and scope of the landscape, sacred place, or object with cultural value to a California Native American tribe, and that is:

i) Listed or eligible for listing in the California Register of Historical Resources, or in a local register of historical resources as defined in Public Resources Code section 5020.1(k), or

☐
☐
☒
☐
☐

ii) A resource determined by the lead agency, in its discretion and supported by substantial evidence, to be significant pursuant to criteria set forth in subdivision (c) of Public Resources Code Section 5024.1. In applying the criteria set forth in subdivision (c) of Public Resource Code Section 5024.1, the lead agency shall consider the significance of the resource to a California Native American tribe.

☐
☐
☒
☐
☐

Impact Discussion:

a) The project site is located approximately 2.6 miles north of the Calaveras River on a site that was previously a private access road. Written notification was sent November 8, 2022 and June 20, 2023 to all listed tribes on the Native American Heritage Commission's list for San Joaquin County. A response was received from the Buena Vista Rancheria of Me-Wuk Indians, dated December 12, 2022, stating that the BVR had no object to the project. With this request and having received no other responses or requests for consult as a result of the referral, any possible disruption to a potential site is expected to be less than significant.

At the time project development, if potential tribal cultural resources are discovered in the course of construction activities, work is to cease in the immediate vicinity and a qualified cultural resources specialist will assess the significance of the find and make recommendations for further evaluation and treatment as necessary. If Human burials are found to be of Native American origin, the developer shall follow the procedures pursuant to Title 14, Division 6, Chapter 3, Article 5, Section 15064.5(e) of the California State Code of Regulations. If human remains are encountered, all work shall halt in the vicinity and the County Coroner shall be notified immediately. At the same time, a qualified archaeologist shall be contacted to evaluate the finds. If Human burials are found to be of Native American origin, steps shall be taken pursuant to Section 15064.5(e) of Guidelines for California Environmental Quality Act.

Potentially Significant Impact	Less Than Significant with Mitigation Incorporated	Less Than Significant Impact	No Impact	Analyzed In The Prior EIR
--------------------------------------	---	------------------------------------	--------------	---------------------------------

XIX. UTILITIES AND SERVICE SYSTEMS.

Would the project:

a) Require or result in the relocation or construction of new or expanded water, wastewater treatment, or storm water drainage, electric power, natural gas, or telecommunications facilities, the construction or relocation of which could cause significant environmental effects?	<input type="checkbox"/>	<input type="checkbox"/>	<input checked="" type="checkbox"/>	<input type="checkbox"/>	<input type="checkbox"/>
b) Have sufficient water supplies available to serve the project and reasonably foreseeable future development during normal, dry and multiple dry years?	<input type="checkbox"/>	<input type="checkbox"/>	<input checked="" type="checkbox"/>	<input type="checkbox"/>	<input type="checkbox"/>
c) Result in a determination by the wastewater treatment provider which serves or may serve the project that it has adequate capacity to serve the project's projected demand in addition to the provider's existing commitments?	<input type="checkbox"/>	<input type="checkbox"/>	<input checked="" type="checkbox"/>	<input type="checkbox"/>	<input type="checkbox"/>
d) Generate solid waste in excess of State or local standards, or in excess of the capacity of local infrastructure, or otherwise impair the attainment of solid waste reduction goals?	<input type="checkbox"/>	<input type="checkbox"/>	<input checked="" type="checkbox"/>	<input type="checkbox"/>	<input type="checkbox"/>
e) Comply with federal, state, and local management and reduction statutes and regulations related to solid waste?	<input type="checkbox"/>	<input type="checkbox"/>	<input checked="" type="checkbox"/>	<input type="checkbox"/>	<input type="checkbox"/>

Impact Discussion:

- The proposed project will utilize an onsite well and septic system. Therefore, the project will be served by private services and will not result in the need for relocation of existing facilities or require new facilities.
- The project is a 0.66-acre storage site for leisure vehicles. It is not a development that will require large quantities of water, therefore, water use for this project will have a less than significant effect on water supply.
- The project will utilize an Onsite Sewage Disposal System constructed under permit from the Environmental Health Department and subject to the onsite wastewater treatment system regulations that will comply with the standards of San Joaquin County. Therefore, there is no sewage treatment provider.
- The proposed project is a 0.66-acre storage lot for leisure vehicles. As proposed, the project is not anticipated to generate solid waste in excess of State and local standards and will be able to comply with all regulations related to solid waste.

Potentially Significant Impact	Less Than Significant with Mitigation Incorporated	Less Than Significant Impact	No Impact	Analyzed In The Prior EIR
--------------------------------------	---	------------------------------------	--------------	---------------------------------

XX. WILDFIRE.

If located in or near state responsibility areas or lands classified as very high fire hazard severity zones, would the project:

a) Substantially impair an adopted emergency response plan or emergency evacuation plan?	<input type="checkbox"/>	<input type="checkbox"/>	<input checked="" type="checkbox"/>	<input type="checkbox"/>	<input type="checkbox"/>
b) Due to slope, prevailing winds, and other factors, exacerbate wildfire risks, and thereby expose project occupants to pollutant concentrations from a wildfire or the uncontrolled spread of a wildfire?	<input type="checkbox"/>	<input type="checkbox"/>	<input checked="" type="checkbox"/>	<input type="checkbox"/>	<input type="checkbox"/>
c) Require the installation or maintenance of associated infrastructure (such as roads, fuel breaks, emergency water sources, power lines or other utilities) that may exacerbate fire risk or that may result in temporary or ongoing impacts to the environment?	<input type="checkbox"/>	<input type="checkbox"/>	<input checked="" type="checkbox"/>	<input type="checkbox"/>	<input type="checkbox"/>
d) Expose people or structures to significant risks, including downslope or downstream flooding or landslides, as a result of runoff, post-fire slope instability, or drainage changes?	<input type="checkbox"/>	<input type="checkbox"/>	<input checked="" type="checkbox"/>	<input type="checkbox"/>	<input type="checkbox"/>

Impact Discussion:

- a-d) The project location is in the Urban community of Morada, which is not identified as a Community at Risk from Wildfire by Cal Fire's "Fire Risk Assessment Program". Communities at Risk from Wildfire are those places within 1.5 miles of areas of High or Very High wildfire threat as determined from CDF-FRAP fuels and hazard data. Therefore, the impact of wildfires on the project are expected to be less than significant.

Potentially Significant Impact	Less Than Significant with Mitigation Incorporated	Less Than Significant Impact	No Impact	Analyzed In The Prior EIR
--------------------------------------	---	------------------------------------	--------------	---------------------------------

XXI. MANDATORY FINDINGS OF SIGNIFICANCE.

a) Does the project have the potential to substantially degrade the quality of the environment, substantially reduce the habitat of a fish or wildlife species, cause a fish or wildlife population to drop below self-sustaining levels, threaten to eliminate a plant or animal community, substantially reduce the number or restrict the range of a rare or endangered plant or animal or eliminate important examples of the major periods of California history or prehistory?

☐
☐
☒
☐
☐

b) Does the project have impacts that are individually limited, but cumulatively considerable? ("Cumulatively considerable" means that the incremental effects of a project are considerable when viewed in connection with the effects of past projects, the effects of other current projects, and the effects of probable future projects)?

☐
☐
☒
☐
☐

c) Does the project have environmental effects which will cause substantial adverse effects on human beings, either directly or indirectly?

☐
☐
☒
☐
☐

Impact Discussion:

- a-c) Review of this project has not indicated any features which might significantly impact the environmental quality of the site and/or surrounding area. Mitigation measures have been identified in areas where a potentially significant impact has been identified and these measures, included as conditions of approval, will reduce these impacts to a less than significant level.

ATTACHMENT: (MAP[S] OR PROJECT SITE PLAN[S])

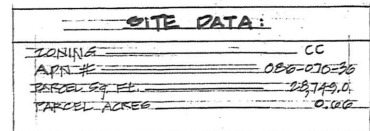
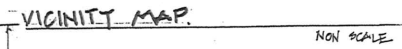

PROPOSED STRUCTURES - PARKING							
STRUCTURE - LETTER	PROPOSED - NAME	AREA - SQ. FT.	OVERALL HEIGHT	REQUIRED PARKING	RVS PARKING	MOTOR HOME PARKING	N/C/ PARKING
A	OFFICE	316	13'	TWO			
B	AS BUILT CANNERY RESIDENCE	1324130 10041260	21'				
C	WOOD STORAGE	36	15'				
D	RV COVER	149	12'		10' X 20' THIRTEEN		
E	BEST 110 TANK	1600 GAL	12' LONG 6" WIDE 2' H				
F	MOTOR HOME	1890				SIXTY FOOT 10' X 20'	
G	RV COVER	4705		N/A	10' X 20'		
H	CONCRETE PARKING	720		3			
I	TRASH DISPOSURE	106	6'				
J	RETENTION POND	BEST EST	6' DEPTH				



SITE APPROVAL FOR:
MR. EL LOUHAIBY MAHER
10150 N. ST. RT 99 E.
FRONTAGE ROAD, STOCKTON CA, 95212

Date	2/27/2021
Scale	1" = 20'
Drawn by	J. J. S.
Job	
Sheet	1
Of 095 Sheets	